

FINAL SURVEY	SURVEYED	DATE
NOTE BOOK	PLOTTED	BY
NO.	TEMPLATE	
	AREAS CHECKED	

ORIGINAL SURVEY	SURVEYED	DATE
NOTE BOOK	PLOTTED	BY
NO.	TEMPLATE	
	AREAS CHECKED	

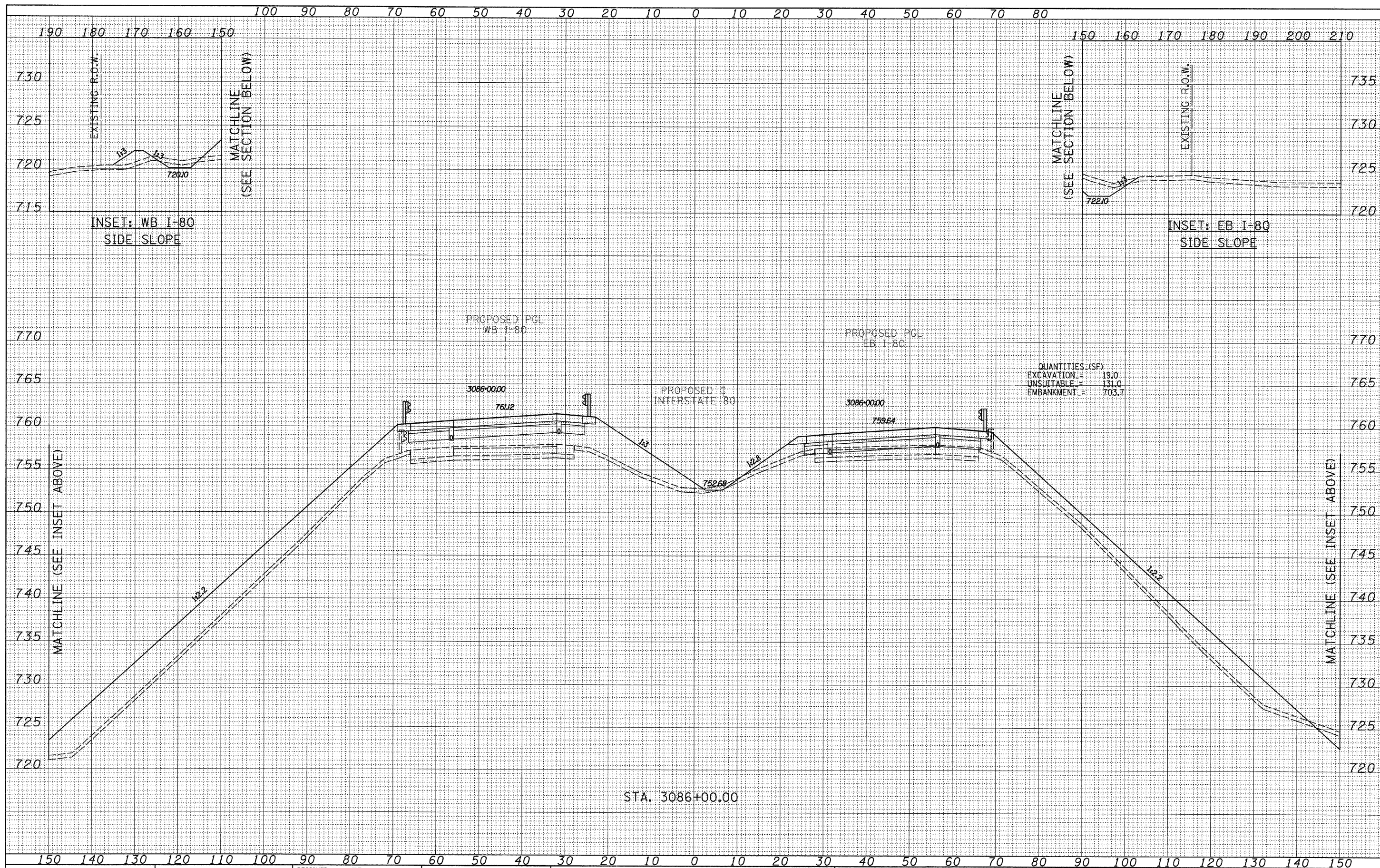

TYLINT INTERNATIONAL

USER NAME =	DESIGNED - JDF	REVISED -
PLOT SCALE =	DRAWN - JDF	REVISED -
PLOT DATE =	CHECKED - JPM	REVISED -
	DATE - 9/7/2011	REVISED -

**STATE OF ILLINOIS
DEPARTMENT OF TRANSPORTATION**

**F.A.I. ROUTE 80 (I-80)
PROPOSED CROSS SECTIONS**

F.A.I. RTE.	SECTION	COUNTY	TOTAL SHEETS	SHEET NO.
80	[(06-5)HBR-1,VBR(06-6)RS-3&I	BUREAU	249	233
FED. ROAD DIST. NO. [ILLINOIS] FED. AID PROJECT			CONTRACT NO. 66686	

P:\602429\I-80\Road\602429.10_A\366686-sht-xssh.dgn

SCALE: 1" = 10' SHEET NO. OF SHEETS STA. 3086+00.00 TO STA. 3086+00.00

QUANTITIES (SF):
EXCAVATION 19.0
UNSUITABLE 131.0
EMBANKMENT 703.7