

BENCHMARK #10

CUT "□" TOP OF NORTHEAST WINGWALL OF NB I-57 BRIDGE.
 STA 1357+01.48, 67.86' LT
 ELEV 703.901

PLAN	SURVEYED	BY	DATE
	PLOTTED		
	NOTED		
	REVISIONS		
	NO.		

- NOTES:
1. PLACE EROSION CONTROL FENCE AROUND THE PERIMETER OF WORK OUTSIDE OF THE CONSTRUCTION LIMITS
 2. SEE MOT PLANS FOR LIMITS OF HMA SHOULDER REMOVAL DURING STAGE 1A
 3. SEE HWY. STD. 630301 FOR SHOULDER WIDENING DETAILS AND 630201 FOR RESURFACING DETAIL FOR LIMITS OF HMA STABILIZATION

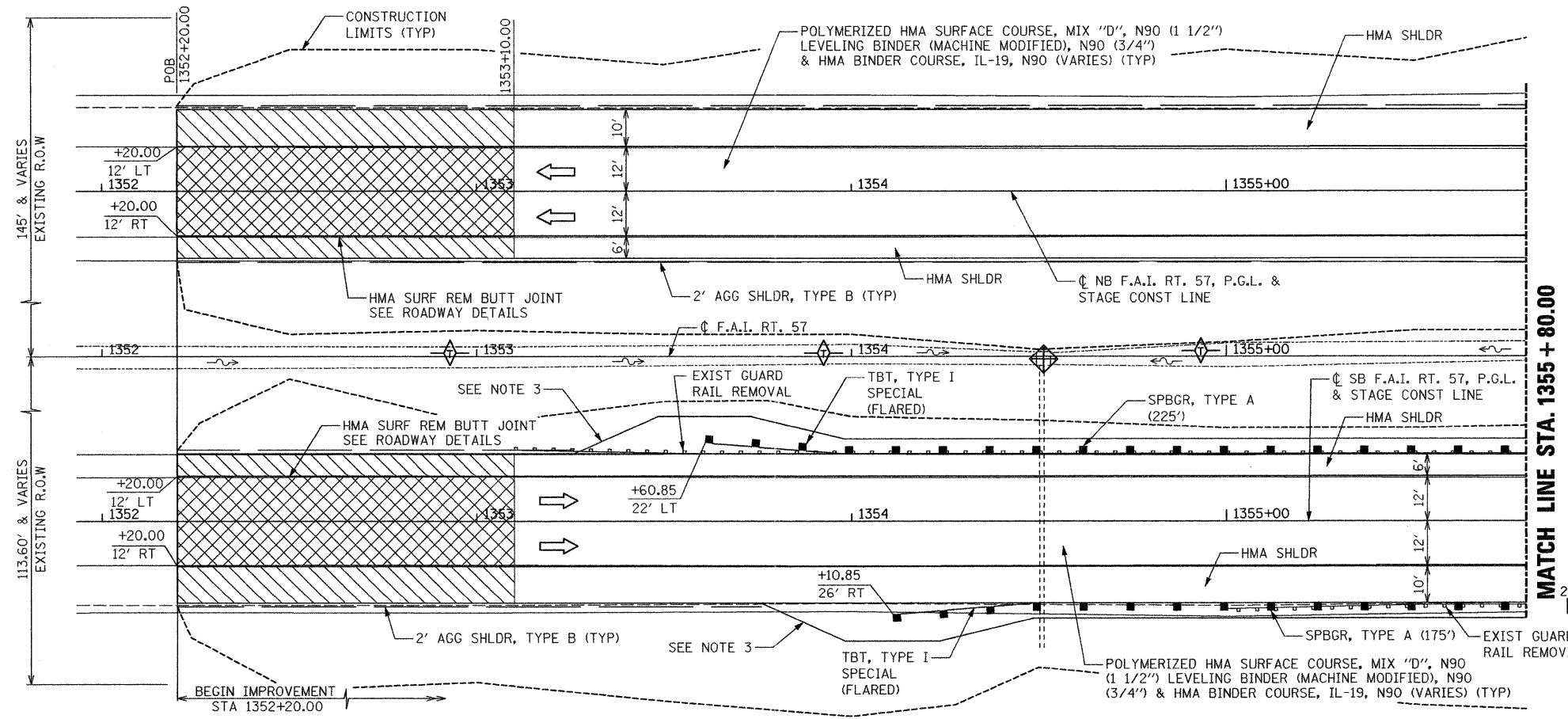

LEGEND

- PAVEMENT REMOVAL AND REPLACEMENT (SEE NOTE 2)
- PAVED SHOULDER REMOVAL
- HMA BUTT JOINT
- INLET & PIPE PROTECTION
- TEMPORARY DITCH CHECK
- PROPOSED DITCH FLOW LINE
- EXISTING DITCH FLOW LINE
- DIRECTION OF TRAFFIC
- CONSTRUCTION LIMITS
- EXISTING INLET

SCALE IN FEET

FILE	SURVEYED	BY	DATE
	PLOTTED		
	NOTED		
	REVISIONS		
	NO.		

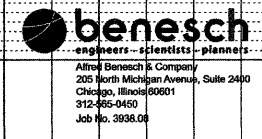
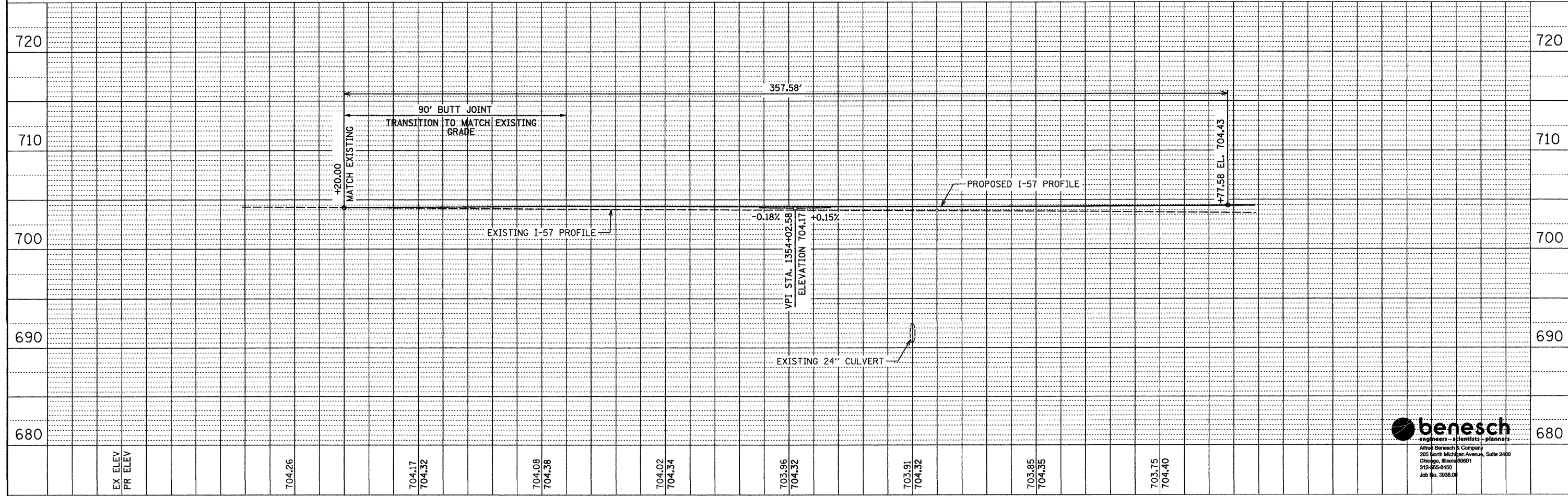

FILE NAME =	USER NAME = kholz	DESIGNED - JDC	REVISED -	STATE OF ILLINOIS DEPARTMENT OF TRANSPORTATION	PLAN AND PROFILE	F.A.I. RTE.	SECTION	COUNTY	TOTAL SHEETS	SHEET NO.	
...\\fina1\0366948-ah-pplan@1.dgn	PLOT SCALE = #SCALE#	DRAWN - PRT	REVISED -			57	(38-8) BR & BR-1	IROQUOIS	73	9	
PLOT DATE = 8/22/2011	DATE - 08/19/2011	CHECKED - JMS	REVISED -			CONTRACT NO. 66948					
		DATE - 08/19/2011	REVISED -			FED. ROAD DIST. NO. ILLINOIS FED. AID PROJECT					