

B.M. #50 R.R. Spike in R.P. Sta. 1369+17  
108' Rt. Elev. 699.65

STATE OF ILLINOIS  
DEPARTMENT OF PUBLIC WORKS & BUILDINGS  
DIVISION OF HIGHWAYS

PROJECT	SECTION	COUNTY	TOTAL SHEETS	SHEET NO.
1-57	38-8B	IROQUOIS	113	27
SHEETS				

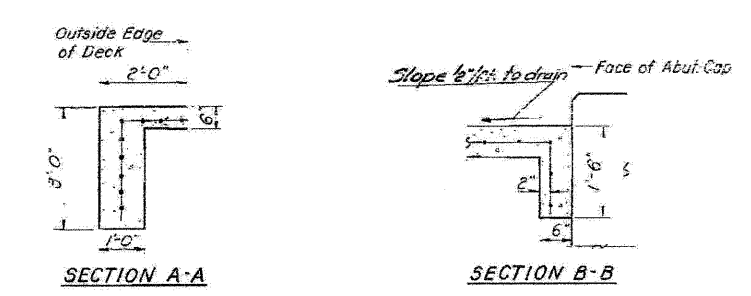
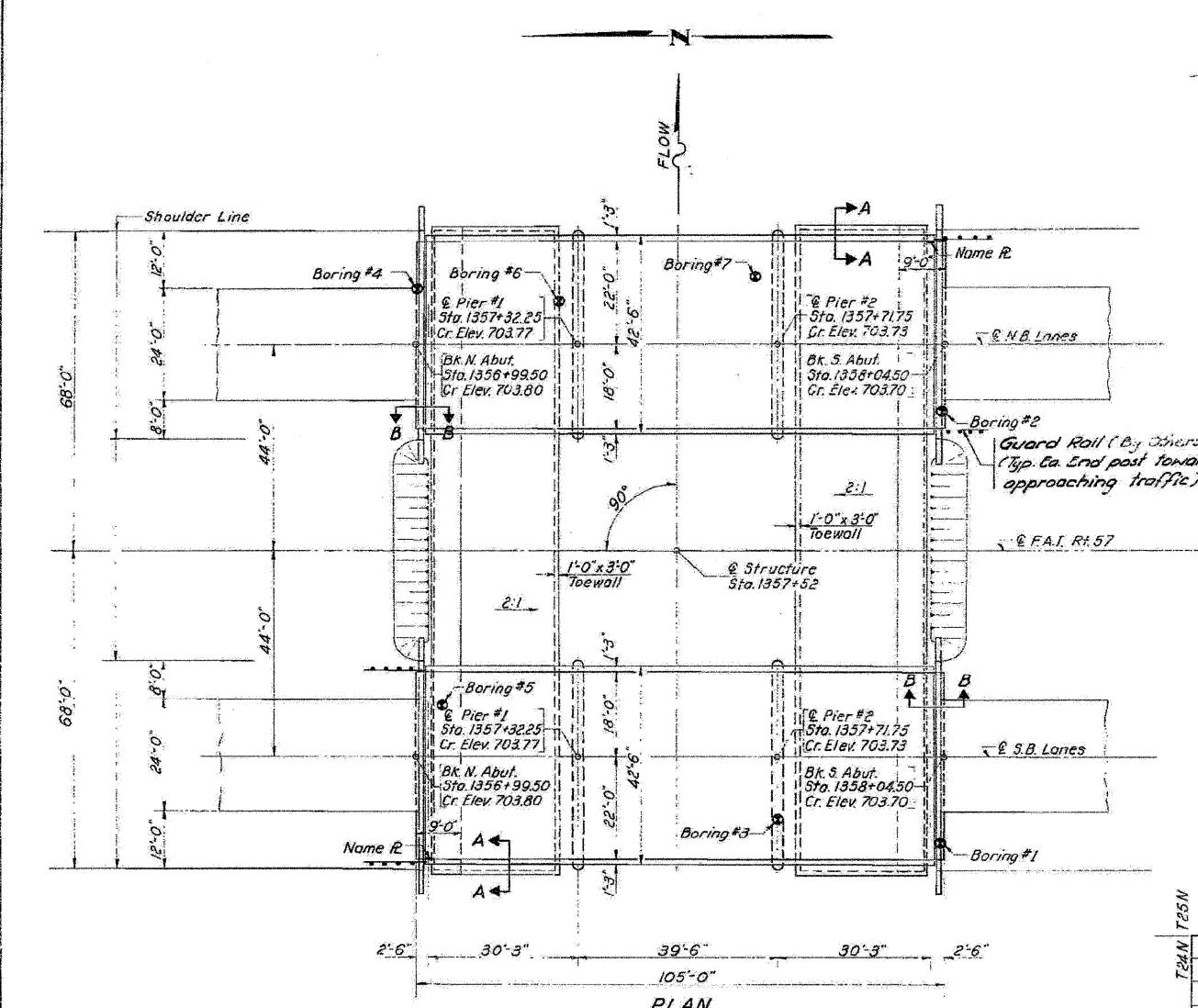
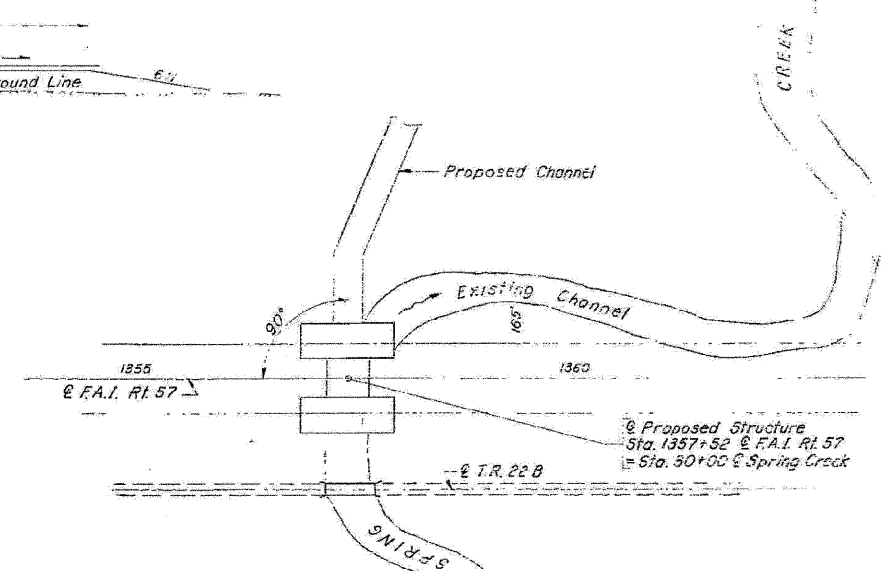
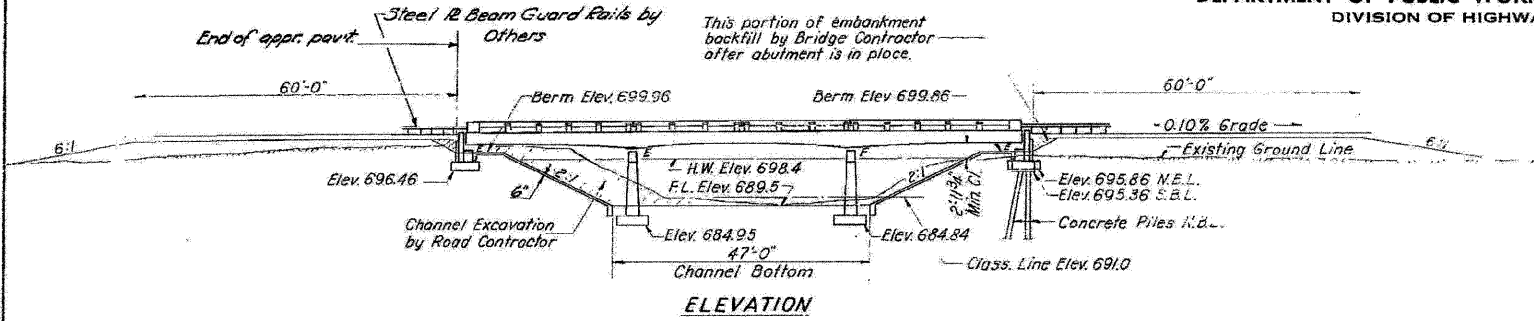

**WATERWAY INFORMATION**  
 Drainage Area 18,500 Acres  
 Character Level & Cultivated  
 Required Opening (50 Yr. Fl.) 540 Sq. Ft.  
 Proposed Opening 540 Sq. Ft.  
 Ordinary Water Elev. 692.5  
 Low Water Elev. 690.0  
 Design frequency discharge, Q50 = 2700 cfs.

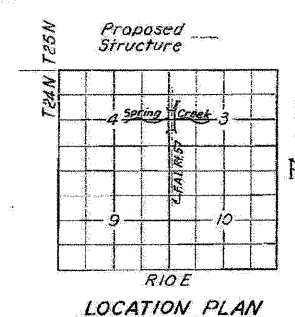

DESIGNED *J. Kaspar*  
 CHECKED *J. B. N.*  
 DRAWN *J. L. Armstrong*  
 CHECKED *J. B. N.*  
 EXAMINED *[Signature]*  
 PASSED *[Signature]*  
 APPROVED *[Signature]*  
 June 7 1965

Rev. 4/10/66 JBN/J.K.

**GENERAL NOTES**  
 Coarse aggregate to be used in wing walls must be free of dirt, flint, limestone, lignite and soft sandstone.  
 The concrete floor slab shall be finished in accordance with Article 61.19 of the Standard Specifications.  
 Slope walls shall be reinforced with welded wire fabric 6"x6" mesh, weighing 52# per 100 Sq. Ft.  
 Layout of slope walls may be varied to suit ground conditions in the field as directed by the Engineer.  
 The honorific concrete in the full cost and taking shall be counted in separate operations.  
 All reinforcement bars shall be spaced 20 diameters unless otherwise shown.  
 The exposed surfaces of the expansion joints shall be given two shop coats of red lead paint. The contact surfaces shall be given one coat of red lead paint. Anchor studs shall not be coated.  
 All structural steel shall conform to ASTM Specifications Designation A-36.  
 Expansion joints are included in quantity of structural steel.  
 Estimated weight = 4400 lbs.  
 Structural steel shall receive one shop coat of red lead paint and two field coats of aluminum paint.  
 The Contractor shall drive one concrete test pile in a permanent location at the S. Abut. N. Bound Structure, as directed by the Engineer before ordering the remainder of the piles.  
 Permanent forms will not be permitted in forming the concrete slab.

STATION 1357+52  
 BUILT 195 BY  
 STATE OF ILLINOIS  
 F.A.I. RT. 57 SEC. 38-8B  
 F.A. PROJ. I-16-57-6(53)  
 LOADING HS 20 & ALI  
**NAME PLATE LETTERING**  
 See Standard B113-1

**TOTAL BILL OF MATERIAL**

Item	Qty	Super	Sub	Sub
Class A Excavation for Structures	Sq. Yds.	390	250	
Class B Excavation for Structures	Sq. Yds.	340	240	
Structural Steel	Lbs.	19,840		19,840
Handrail Concrete	Sq. Yds.	18.5		18.5
Class X Concrete	Sq. Yds.	564.6	182.7	424.8
Class A Concrete	Sq. Yds.		246.8	246.8
Reinforcement Bars	Lbs.	122700	22,670	45370
Concrete Piles	Lin. Ft.		240	240
Test Piles Concrete	Each			
Name Plates	Each	2		2
Slope 4:1 (6')	Sq. Yds.		1040	1040
Bridge Seat Sealant	Lump Sum		0.5	0.5

**FOR INFORMATION ONLY**  
**GENERAL PLAN & ELEVATION**  
**F.A.I. RT. 57 OVER SPRING CREEK**  
**F.A.I. RT. 57 SEC. 38-8B**  
**IROQUOIS COUNTY**  
**STA. 1357+52**

**benesch**  
 engineers - scientists - planners  
 Alfred Benesch & Company  
 205 North Michigan Avenue, Suite 2400  
 Chicago, Illinois 60601  
 312-565-0450 Job No. 3938.09

FILE NAME =	USER NAME = rgrmm	DESIGNED - JLS	REVISED -
8380222&0223.66948.833.Exist.Plan.1.dgn		CHECKED - AAY	REVISED -
		DRAWN - RMG	REVISED -
		CHECKED - KJN	REVISED -

STATE OF ILLINOIS  
 DEPARTMENT OF TRANSPORTATION

EXISTING PLAN INFORMATION (1 OF 9)  
 STRUCTURE NO. 038-0222/0223  
 SHEET NO. 533 OF 541 SHEETS

F.A.I. RTE.	SECTION	COUNTY	TOTAL SHEETS	SHEET NO.
57	(38-8) BR & BR-1	IROQUOIS	73	48
CONTRACT NO. 66948				
ILLINOIS FED. AID PROJECT				

x:\3900s\3938\structures\1-57 over spring creek\final\plans\0380222&0223.66948.833.Exist.Plan.1.dgn  
 08:51:32