

DATE	
BY	
FINISHED SURVEY	
PLOTTED	
NOTE BOOK	
AREAS CHECKED	

DATE	
BY	
ORIGINAL SURVEY	
PLOTTED	
NOTE BOOK	
AREAS CHECKED	

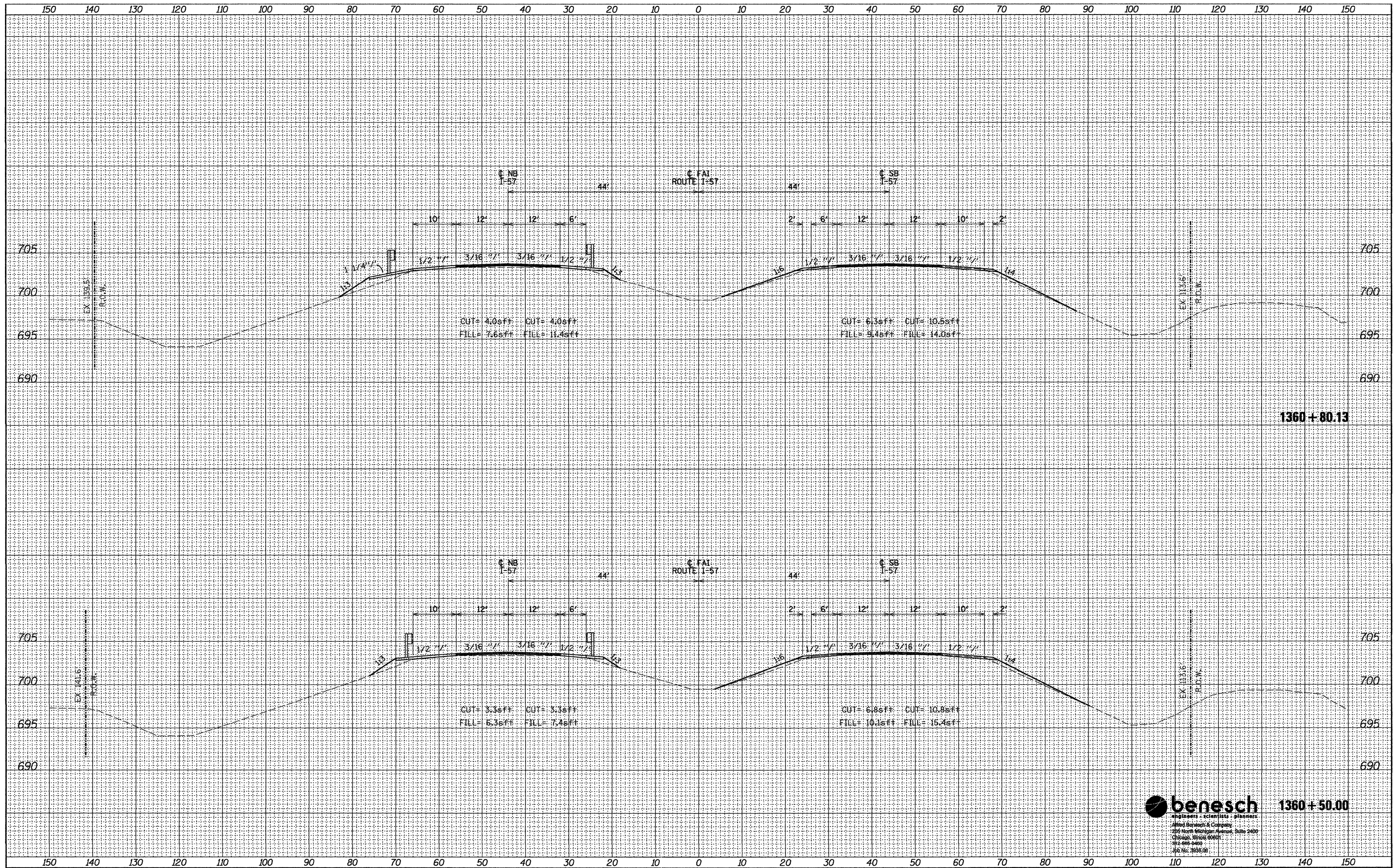

benesch 1360+50.00
 engineers - scientists - planners
 Alfred Benesch & Company
 235 North Michigan Avenue, Suite 2400
 Chicago, Illinois 60601
 312-666-0469
 362 No. 3936.08

FILE NAME = ...\\fina\066948-ah-ssht.dgn

USER NAME = kholz	DESIGNED - JDC	REVISED -
PLOT SCALE = #SCALE#	DRAWN - MDW	REVISED -
PLOT DATE = 03/15/2011	CHECKED - JMS	REVISED -
	DATE - 8/19/2011	REVISED -

**STATE OF ILLINOIS
 DEPARTMENT OF TRANSPORTATION**

CROSS SECTIONS

SCALE: 1"=10'H/5'V SHEET NO. 10 OF 15 SHEETS STA. 1360+50.00 TO STA. 1360+80.13

F.A.T. RTE.	SECTION	COUNTY	TOTAL SHEETS	SHEET NO.
57	(38-8) BR & BR-1	IROQUOIS	73	68
CONTRACT NO. 66948			ILLINOIS FED. AID PROJECT	