

DATE	
BY	
SURVEYED	
PLOTTED	
TEMPLATE	
NOTE BOOK	
AREAS CHECKED	
NO.	

DATE	
BY	
SURVEYED	
PLOTTED	
TEMPLATE	
NOTE BOOK	
AREAS CHECKED	
NO.	

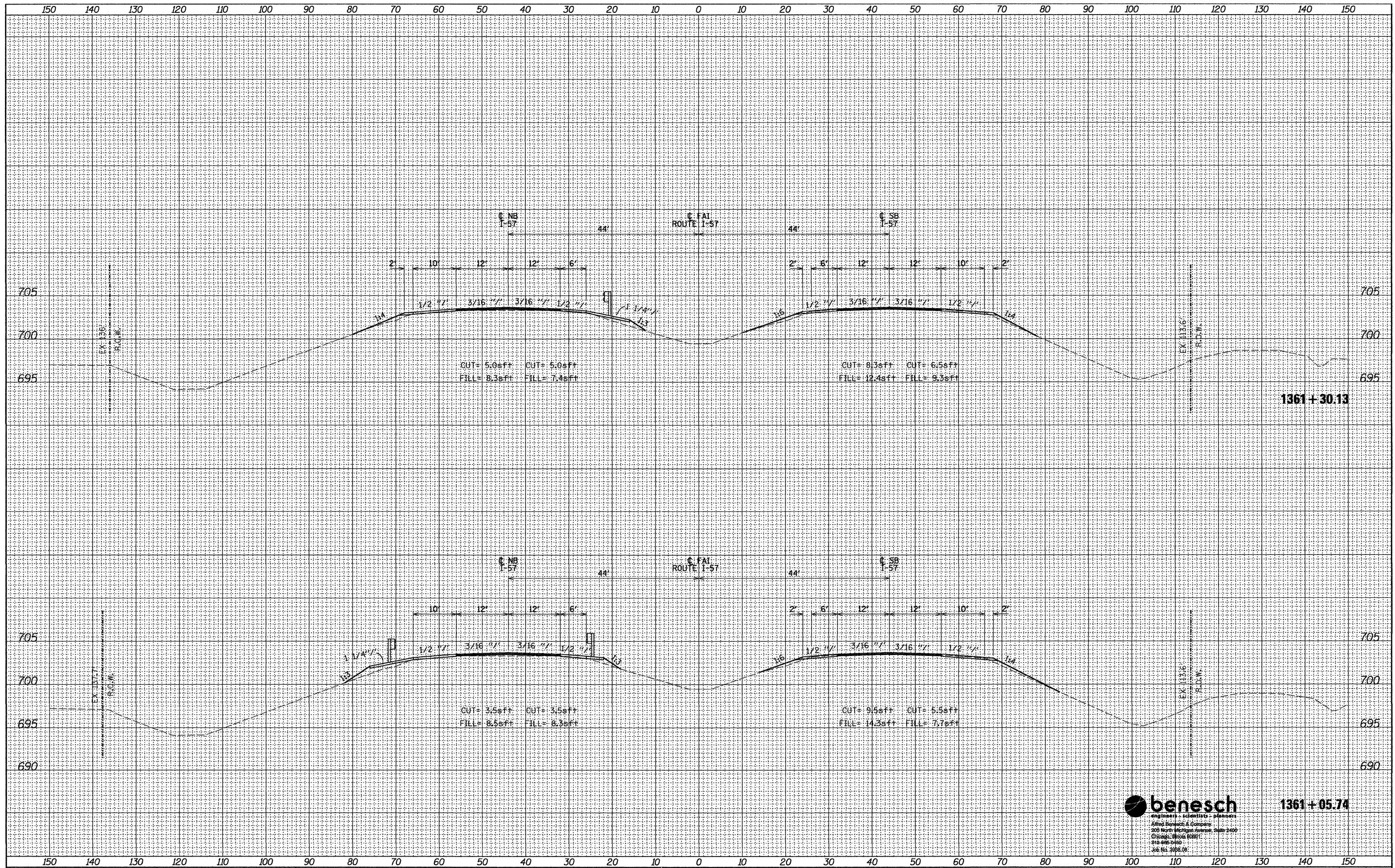

benesch
 engineers - scientists - planners
 Alfred Benesch & Company
 208 North Michigan Avenue, Suite 2400
 Chicago, Illinois 60601
 312-865-0400
 Fax: 312-865-0800

FILE NAME =
 ...\\fina\066948-ah-t-xsh.t.dgn

USER NAME = kholz
 DESIGNED - JDC
 DRAWN - MDW
 CHECKED - JMS
 DATE - 8/19/2011

REVISED -
 REVISED -
 REVISED -
 REVISED -

**STATE OF ILLINOIS
 DEPARTMENT OF TRANSPORTATION**

CROSS SECTIONS

SCALE: 1"=10'H/5'V SHEET NO. 12 OF 15 SHEETS STA. 1361+05.74 TO STA. 1361+30.13

F.A.T. RTE.	SECTION	COUNTY	TOTAL SHEETS	SHEET NO.
57	(38-8) BR & BR-1	IROQUOIS	73	70
CONTRACT NO. 66948			ILLINOIS FED. AID PROJECT	