

STAGE 2

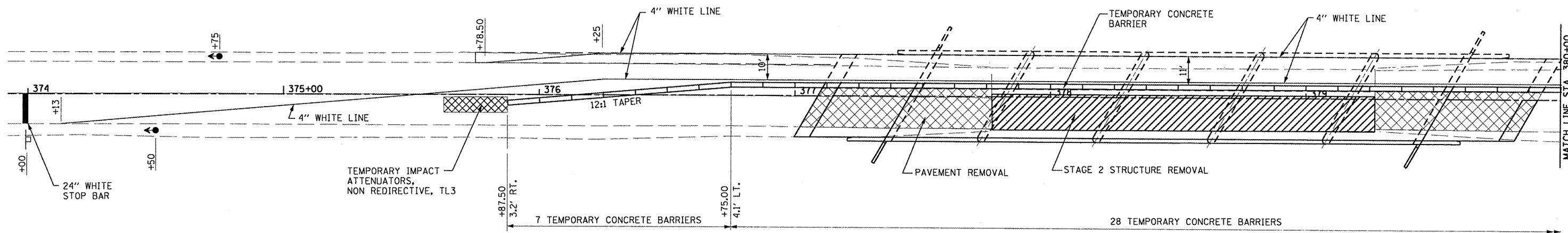

STAGE 2 CONSTRUCTION OF EAST SIDE

1. RELOCATE TEMPORARY CONCRETE BARRIERS, TEMPORARY IMPACT ATTENUATORS AND TEMPORARY MARKINGS AS DETAILED ON TRAFFIC CONTROL AND PROTECTION STANDARD 701321.
2. REMOVE GUARDRAIL, APPROACH PAVEMENT AND REMAINING STRUCTURE FOR EAST SIDE, INCLUDING SECTIONS OF TEMPORARY SOIL RETENTION SYSTEM DESIGNATED TO BE REMOVED AFTER STAGE 1 CONSTRUCTION.
3. CONSTRUCT PROPOSED STRUCTURE, APPROACH PAVEMENT, APPROACH PAVEMENT CONNECTORS, GUARDRAIL AND ALL OTHER COLLATERAL WORK FOR EAST SIDE OF ROADWAY AS SHOWN.
4. REMOVE TRAFFIC CONTROL PAVEMENT MARKINGS, TEMPORARY CONCRETE BARRIERS AND TEMPORARY SIGNALS. COST IS INCLUDED IN TRAFFIC CONTROL AND PROTECTION STANDARD 701321.
5. PAVEMENT MARKINGS WILL BE PLACED AFTER COMPLETION OF STAGE 2.

NOTES:

1. PLACE TRAFFIC CONTROL SIGNS AND DEVICES AS SHOWN IN STANDARD 701321.
2. ALL TEMPORARY BRIDGE TRAFFIC SIGNALS FOR STAGE 1 AND STAGE 2 SHALL BE CONSIDERED AS ONE EACH.
3. BARRIER OFFSETS ARE FROM THE CENTER OF THE BARRIER.
4. TEMPORARY PAVEMENT MARKINGS INCLUDED IN COST OF TRAFFIC CONTROL AND PROTECTION 701321.

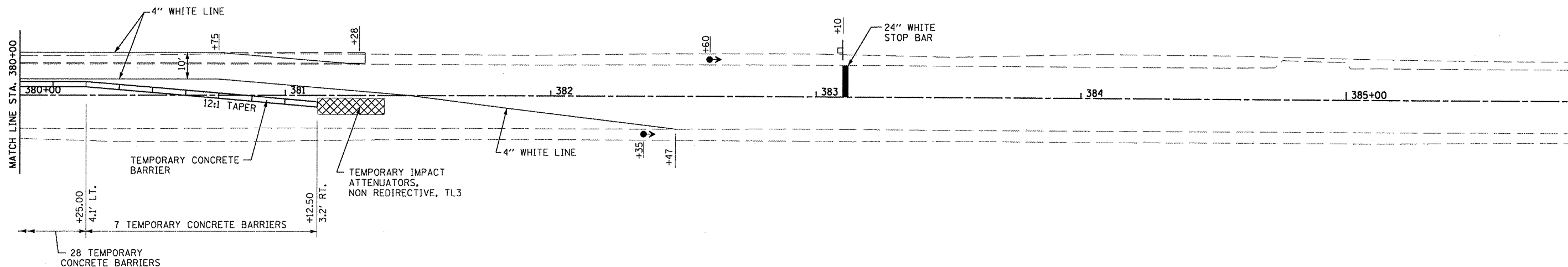
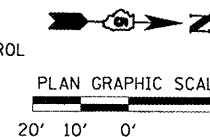

DATE	
BY	
REVISIONS	
NO.	
DATE	
BY	
REVISIONS	
NO.	
DATE	
BY	
REVISIONS	
NO.	
DATE	
BY	
REVISIONS	
NO.	

DATE	
BY	
REVISIONS	
NO.	
DATE	
BY	
REVISIONS	
NO.	
DATE	
BY	
REVISIONS	
NO.	

HURST-ROSCHKE ENGINEERS, INC.
HILLSBORO, ILLINOIS 62049
(217)332-3959 FAX (217)532-3212



FILE NAME =	USER NAME = HURST-ROSCHKE	DESIGNED - JJC	REVISED -
t:\198-1785-wo*7_honey_creek\dgn\0468298-ht-staging-2.dgn		DRAWN - UJ	REVISED -
		CHECKED - MAR	REVISED -
		DATE - 2-26-11	REVISED -

STATE OF ILLINOIS
DEPARTMENT OF TRANSPORTATION

STAGE 2 CONSTRUCTION PLAN

SCALE: 1"=20' SHEET NO. 2 OF 2 SHEETS STA. 374+00 TO STA. 384+00

F.A.P. RTE.	SECTION	COUNTY	TOTAL SHEETS	SHEET NO.
522	(14-1-B)BR	HENDERSON	70	11
CONTRACT NO. 68298				
FED. ROAD DIST. NO. 4 [ILLINOIS] FED. AID PROJECT				