

NOTES:

1. LOCATIONS OF EXISTING LIGHTING FACILITIES SHOWN ARE APPROXIMATE. CONTRACTOR SHALL FIELD VERIFY EXISTING CONDITIONS.
2. CONTRACTOR SHALL FURNISH AND INSTALL A 30 AMP, 240V, 2-POLE BREAKER IN THE EXISTING LIGHTING CONTROLLER #1 AS NEEDED. THE COST OF THIS WORK SHALL BE INCLUDED IN THE "TEMPORARY LIGHTING SYSTEM" PAY ITEM.

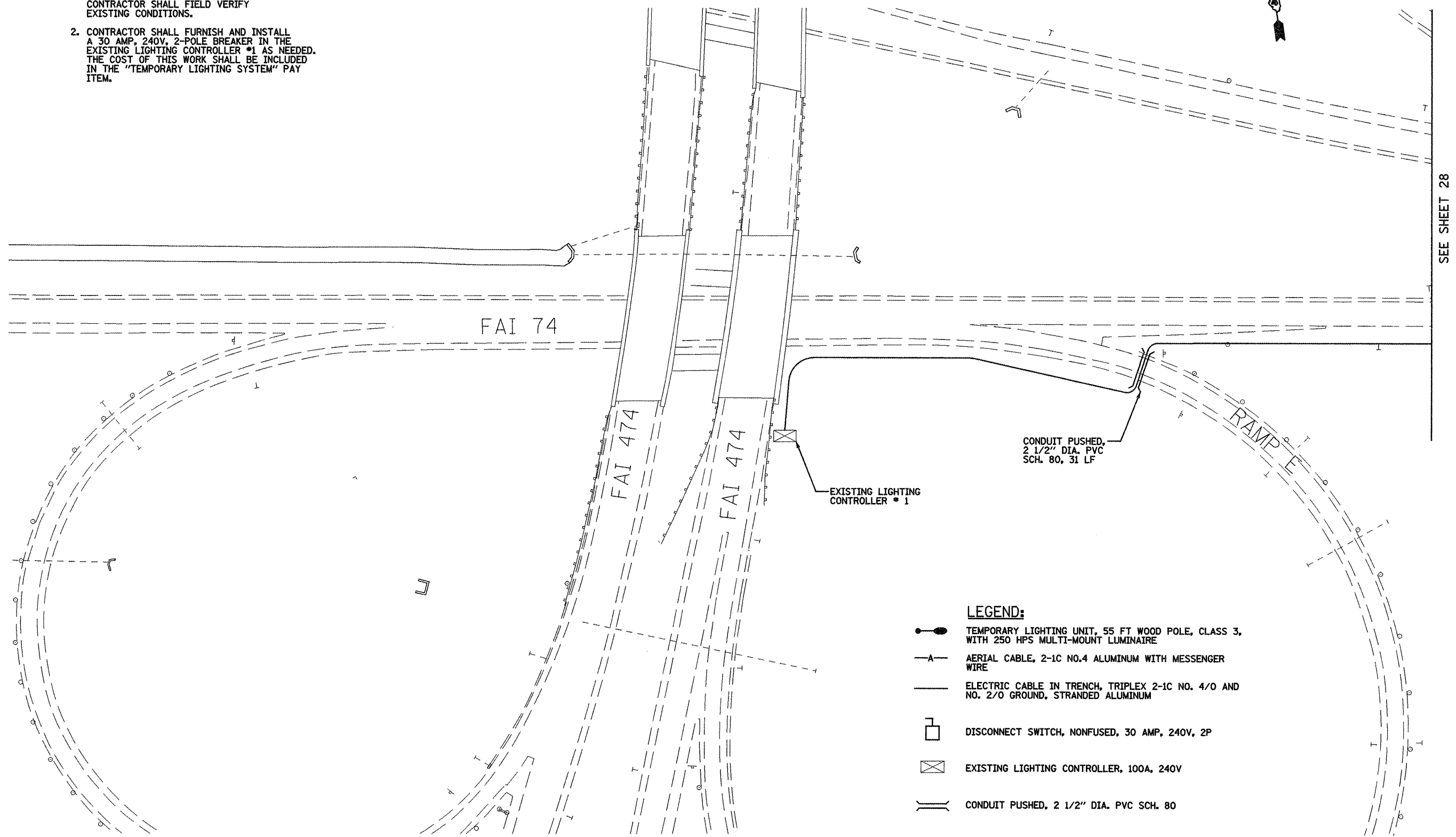

- LEGEND:**
- TEMPORARY LIGHTING UNIT, 55 FT WOOD POLE, CLASS 3, WITH 250 HPS MULTI-MOUNT LUMINAIRE
 - AERIAL CABLE, 2-1C NO.4 ALUMINUM WITH MESSENGER WIRE
 - ELECTRIC CABLE IN TRENCH, TRIPLEX 2-1C NO. 4/0 AND NO. 2/0 GROUND, STRANDED ALUMINUM
 - DISCONNECT SWITCH, NONFUSED, 30 AMP, 240V, 2P
 - EXISTING LIGHTING CONTROLLER, 100A, 240V
 - CONDUIT PUSHED, 2 1/2" DIA. PVC SCH. 80

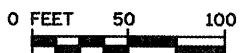

SEE SHEET 28

FILE NAME = D468874-topo.dgn

USER NAME = johnsantv
 PLOT SCALE = 100.4566' / 1" / 31.6
 PLOT DATE = 8/25/2011

DESIGNED -	REVISED -
DRAWN -	REVISED -
CHECKED -	REVISED -
DATE -	REVISED -

**STATE OF ILLINOIS
 DEPARTMENT OF TRANSPORTATION**

**TEMPORARY ROADWAY
 LIGHTING**

SCALE: SHEET NO. 1 OF 4 SHEETS STA. TO STA.

F.A.I. RTE.	SECTION	COUNTY	TOTAL SHEETS	SHEET NO.
74	72(6VB)BYJ	PEORIA	133	27
CONTRACT NO. 68874			ILLINOIS FED. AID PROJECT	