

NORTH CURB LINE/NORTH FACE OF PARAPET

Location	Station	Offset	Theoretical Grade Elevations
W. End of Appr. Slab	346+24.91	-6.42	603.83
A	346+34.91	-6.42	603.78
B	346+44.87	-6.00	603.75
E. End of Appr. Slab	346+54.87	-6.00	603.70

NORTH EDGE OF PAVEMENT/P.G.L.

Location	Station	Offset	Theoretical Grade Elevations
W. End of Appr. Slab	346+24.27	0.00	603.96
A	346+34.27	0.00	603.92
B	346+44.27	0.00	603.87
E. End of Appr. Slab	346+54.27	0.00	603.82

☉ ROADWAY

Location	Station	Offset	Theoretical Grade Elevations
W. End of Appr. Slab	346+23.07	12.00	604.15
A	346+33.07	12.00	604.10
B	346+43.07	12.00	604.05
E. End of Appr. Slab	346+53.07	12.00	604.01

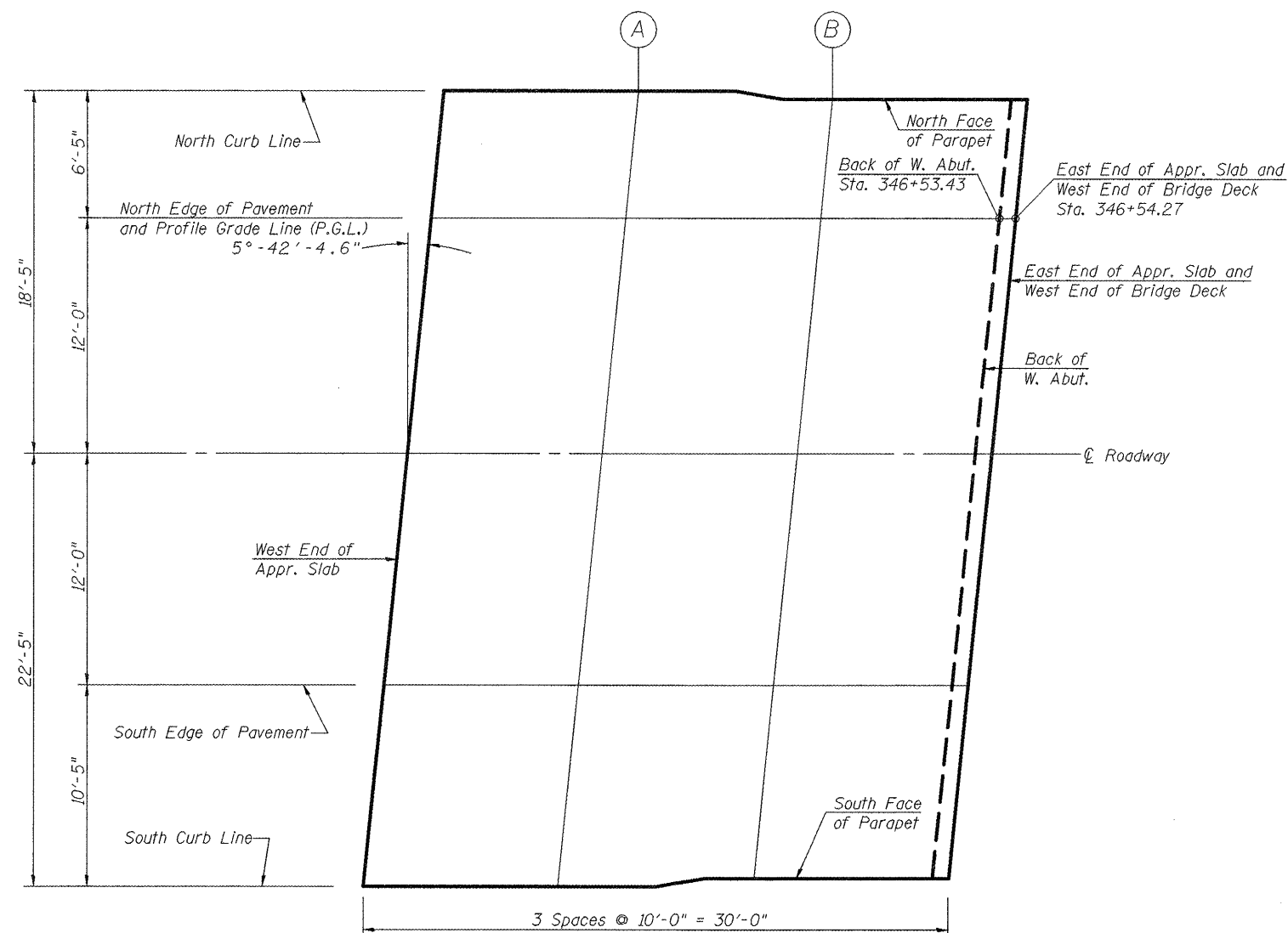

PLAN

SOUTH EDGE OF PAVEMENT

Location	Station	Offset	Theoretical Grade Elevations
W. End of Appr. Slab	346+21.87	24.00	603.97
A	346+31.87	24.00	603.93
B	346+41.87	24.00	603.88
E. End of Appr. Slab	346+51.87	24.00	603.83

SOUTH CURB LINE/SOUTH FACE OF PARAPET

Location	Station	Offset	Theoretical Grade Elevations
W. End of Appr. Slab	346+20.83	34.42	603.77
A	346+30.83	34.42	603.72
B	346+40.88	34.00	603.68
E. End of Appr. Slab	346+50.88	34.00	603.64

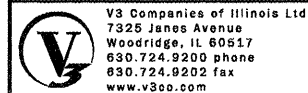

V8 Companies of Illinois Ltd.
7328 James Avenue
Woodridge, IL 60517
830.724.9200 phone
830.724.9202 fax
www.v8co.com

DESIGNED: B. Vegrzyn
CHECKED: Coombe-Bloxdorf
DRAWN: B. Vegrzyn
CHECKED: Coombe-Bloxdorf

REVISÉD -
REVISÉD -
REVISÉD -
REVISÉD -

**STATE OF ILLINOIS
DEPARTMENT OF TRANSPORTATION**

**TOP OF W. APPROACH SLAB ELEVATIONS - EASTBOUND
STRUCTURE NO. 072-0001 & 072-0002**

SHEET NO. 8 OF 34 SHEETS

F.A.I. RTE.	SECTION	COUNTY	TOTAL SHEETS	SHEET NO.
74	72-6VB	PEORIA	133	51
CONTRACT NO. 68874				

ILLINOIS FED. AID PROJECT