

**STATE OF ILLINOIS**  
**DEPARTMENT OF TRANSPORTATION**  
**DIVISION OF HIGHWAYS**  
**RIGHT OF WAY PLANS**  
**FOR PROPOSED**  
**FEDERAL AID HIGHWAY**

FAP ROUTE 315 (U.S. 136)  
SECTION 121 BR-2  
JOB R-95-075-10  
McLEAN COUNTY

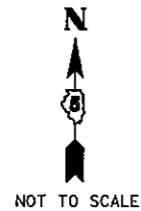

ROUTE	SECTION	COUNTY	TOTAL SHEETS	SHEET NO.
FAP 315 (US 136)	121 BR-2	McLEAN	2	1
F.H.W.A. REG.		ILLINOIS	PROJECT	

CONTRACT NO. 70552

REGION 3 / DISTRICT 5

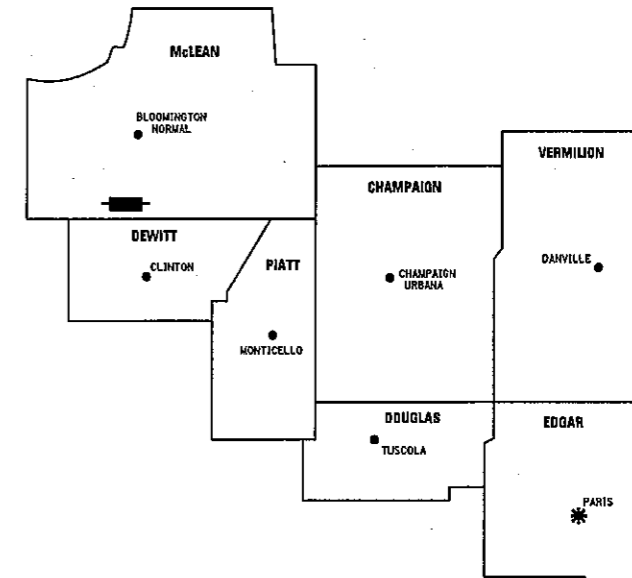

\* DISTRICT HEADQUARTERS  
**█** PROJECT LOCATION

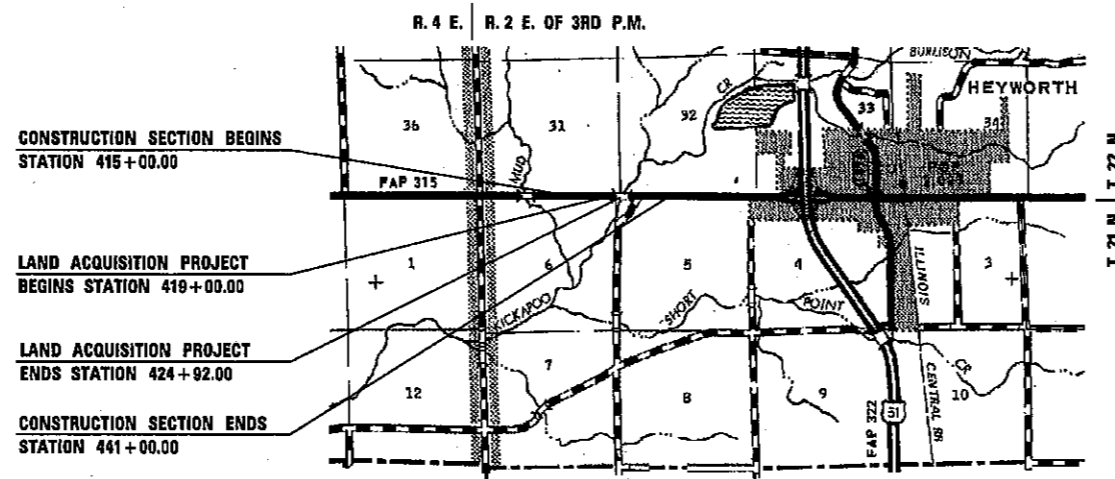

LENGTH OF LAND ACQUISITION PROJECT = 592 LIN. FT. = 0.112 MILE



THIS IS TO CERTIFY THAT THIS IS A TRUE AND CORRECT SET OF RIGHT OF WAY PLANS MADE UNDER MY DIRECTION FOR THE DIVISION OF HIGHWAYS, STATE OF ILLINOIS.

*Kenneth W. Hackney* 8/15/11  
ILLINOIS PROFESSIONAL LAND SURVEYOR NO. 3135 DATE  
LICENSE EXPIRES 11/30/12

**STATE OF ILLINOIS**  
**DEPARTMENT OF TRANSPORTATION**  
**DIVISION OF HIGHWAYS**

SUBMITTED 8/15 2011  
*Joseph E. Crowe*  
JOSEPH E. CROWE, P.E.  
DEPUTY DIRECTOR OF HIGHWAYS  
REGION 3 ENGINEER

EXAMINED August 15 2011  
*Kenneth W. Hackney*  
DISTRICT CHIEF OF PLATS & PLANS

PASSED August 15 2011  
*David L. Paulin*  
DISTRICT LAND ACQUISITION ENGINEER