

S.N. 057-0129
 STRUCTURE OMISSION:
 STA. 1126+47.10 TO
 STA. 1128+14.80

SEC. 10, T. 22 N., R. 3 E., 3RD P.M.

STA. 1127+12.92
 S.N. 057-0129
 P.P.C. I-BEAMS W/
 SEMI-INTREGAL ABUTMENTS
 SKEW= 21° LT.

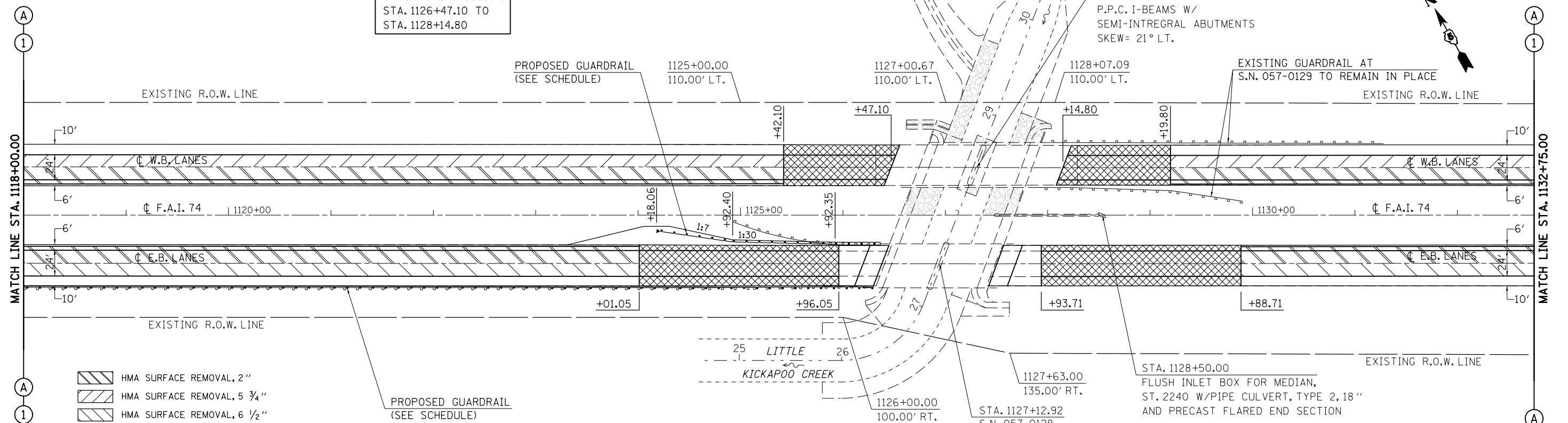

- HMA SURFACE REMOVAL, 2"
- HMA SURFACE REMOVAL, 5 3/4"
- HMA SURFACE REMOVAL, 6 1/2"
- HMA SURFACE REMOVAL, BUTT JOINT

SEC. 9, T. 22 N., R. 3 E., 3RD P.M.

STA. 1127+12.92
 S.N. 057-0128
 P.P.C. GIRDER BEAMS, SKEW: 21° LT.
 FOR PROPOSED STRUCTURE IMPROVEMENTS,
 (SEE DETAILS FOR S.N. 057-0128, SHEETS 75-89)

SEC. 10, T. 22 N., R. 3 E., 3RD P.M.

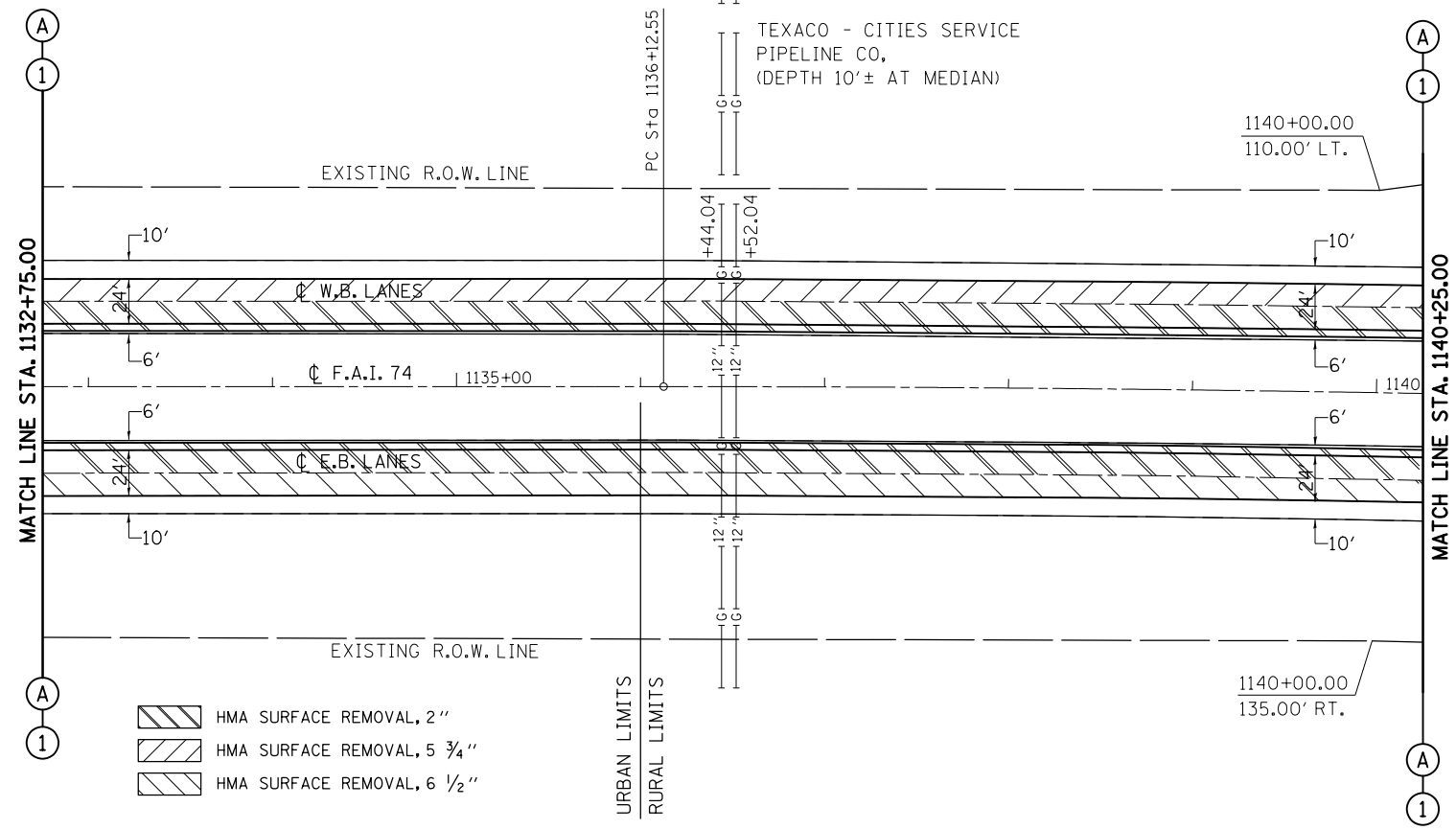

- HMA SURFACE REMOVAL, 2"
- HMA SURFACE REMOVAL, 5 3/4"
- HMA SURFACE REMOVAL, 6 1/2"

FILE NAME =	USER NAME = ppersonbr	DESIGNED - GAE	REVISED -
c:\pwork\pwork\personbr\d0184863\0570648-sh1-plan.dgn		DRAWN - BBP	REVISED -
	PLOT SCALE = 100.0000' / 1" =	CHECKED -	REVISED -
	PLOT DATE = 8/25/2011	DATE - 08/26/10	REVISED -

STATE OF ILLINOIS
 DEPARTMENT OF TRANSPORTATION

SCALE: 1" = 50'		SHEET NO. 2 OF 15 SHEETS		STA. 1118+00.00 TO STA. 1140+25.00	
-----------------	--	--------------------------	--	------------------------------------	--

F.A.I. RTE.	SECTION	COUNTY	TOTAL SHEETS	SHEET NO.
74	(57-23,57-24)RS-1	MCLEAN	175	40
CONTRACT NO. 70648				
ILLINOIS FED. AID PROJECT				