

SEC. 20, T. 22 N., R. 4 E., 3rd P.M.

SEC. 28, T. 22 N., R. 4 E., 3rd P.M.

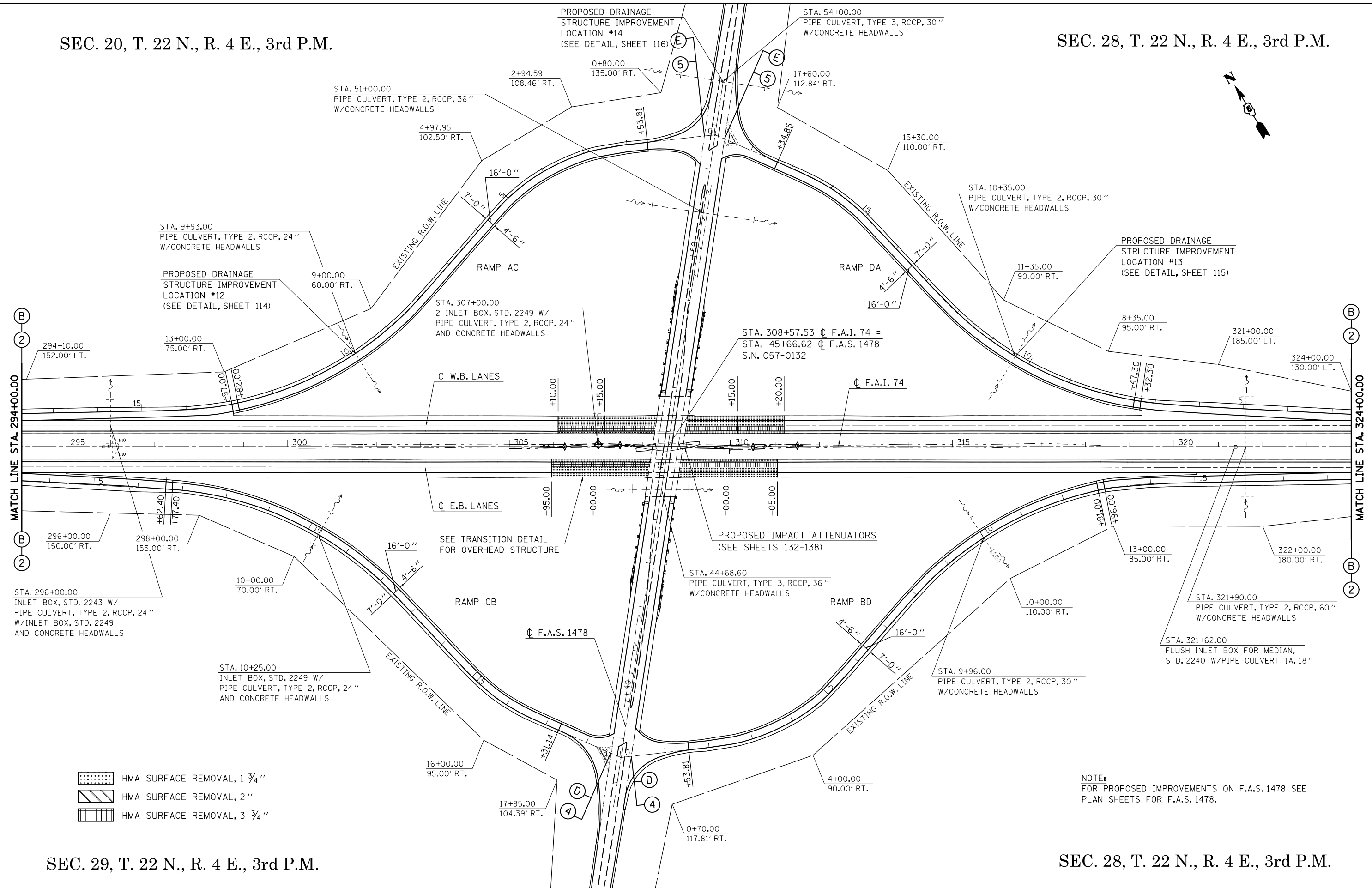

- HMA SURFACE REMOVAL, 1 3/4"
- HMA SURFACE REMOVAL, 2"
- HMA SURFACE REMOVAL, 3 3/4"

NOTE:
FOR PROPOSED IMPROVEMENTS ON F.A.S. 1478 SEE
PLAN SHEETS FOR F.A.S. 1478.

SEC. 29, T. 22 N., R. 4 E., 3rd P.M.

SEC. 28, T. 22 N., R. 4 E., 3rd P.M.

FILE NAME =	USER NAME = piersonbr	DESIGNED - GAE	REVISED -	STATE OF ILLINOIS DEPARTMENT OF TRANSPORTATION	F.A.I. 74 (I-74) PLAN SHEETS	F.A.I. RTE. 74	SECTION (57-23,57-24)RS-1	COUNTY MCLEAN	TOTAL SHEETS 175	SHEET NO. 51	
ei:\pw\work\p\midot\piersonbr\d0184863\0570648-sh1-plan.dgn	PLOT SCALE = 200.0000' / in.	DRAWN - BBP	REVISED -			SCALE: 1" = 100' SHEET NO. 13 OF 15 SHEETS STA. 294+00.00 TO STA. 324+00.00					
	PLOT DATE = 8/25/2011	CHECKED -	REVISED -			CONTRACT NO. 70648					
		DATE - 08/26/10	REVISED -			ILLINOIS FED. AID PROJECT					