

AS-BUILT PLANS - S.N. 057-0132 FOR INFORMATION ONLY

STATE OF ILLINOIS
DEPARTMENT OF PUBLIC WORKS & BUILDINGS
DIVISION OF HIGHWAYS

ROUTE NO.	SECTION	COUNTY	TOTAL SHEETS	SHEET NO.	SHEET NO. / SHEETS 12
FAI-74	57-23HB	McLEAN	53	23	
ILLINOIS FEDERAL PROJECT					

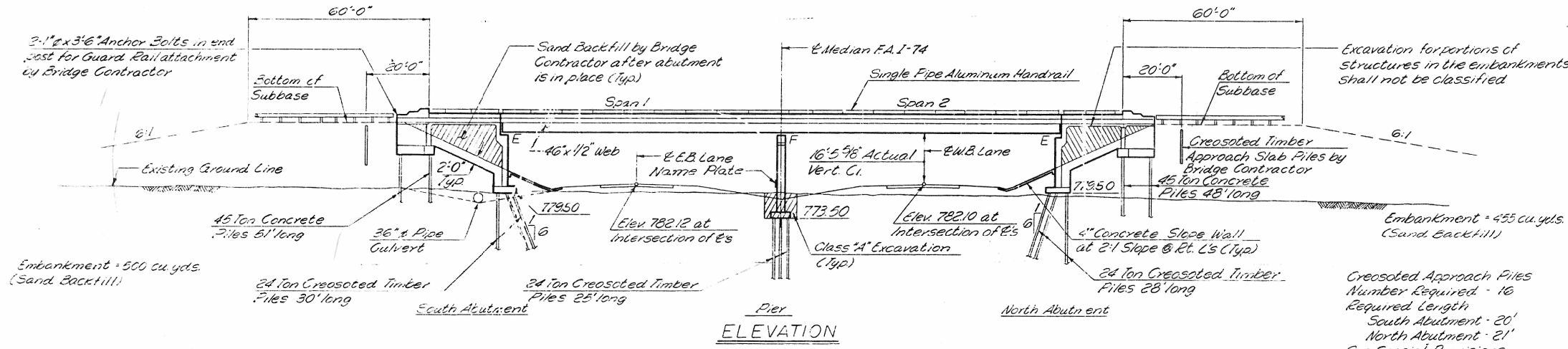

STATION 308+57.53
BUILT 196 BY
STATE OF ILLINOIS
F.A.I. RT. 74 SEC. 57-23 HB-1
FA. PROJ. I74-5 () 147
LOADING HS 20-44

NAME PLATE
See Std. 2113-1

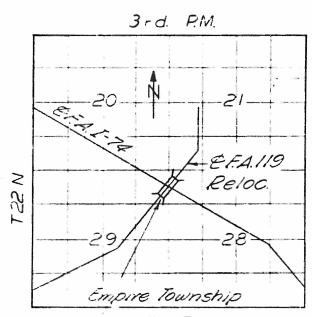

LOCATION SKETCH

NOTE:
Relocated FA.119
Class C Road
1988 D.H.V. 521
M.P.H. = 60

DESIGN STRESSES

- $f_c = 1200$ psi. (Deck)
- $f_c = 1000$ psi. (Closed abuts. & W.W.)
- $f_c = 1400$ psi. (Pier, curb & parapet)
- $f_s = 20,000$ psi. (Reinforcement)
- $f_s = 20,000$ psi. (Structural Steel - A 36)
- $n = 10$
- $V = 75$ psi. (Footings)
- LL Defl. = $L/1000$ (Comp)
- LL Defl. = $L/1000$ (Non Comp)
- Loading: HS 20-44

NOTE:
Deck load designed to include 2" future deck slab resurfacing.
For Boring hole locations see Sheet No. 12.
For Sections A-A and B-B see Sheet No. 2.

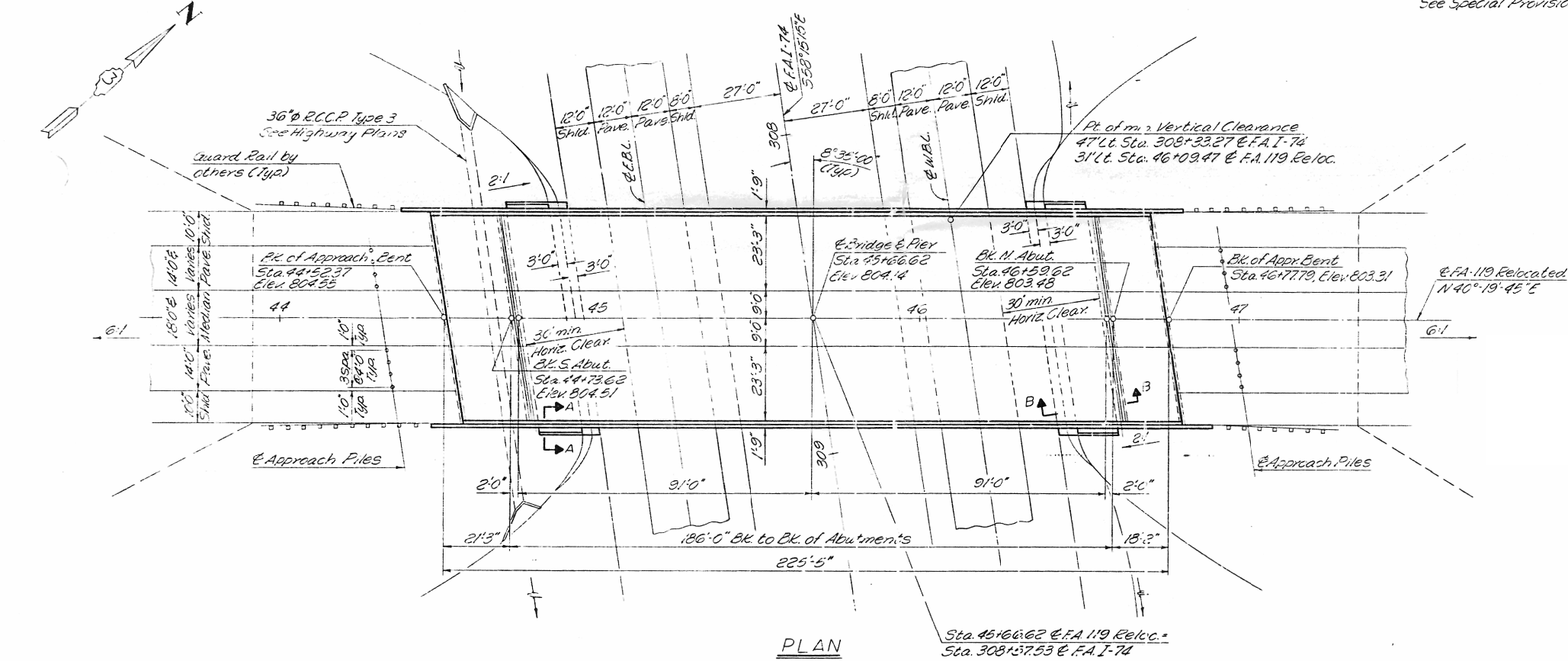

PLAN

DESIGNED J. C. FARRE	19
CHECKED S. J. SHAH	EXAMINED
DRAWN L. R. SKUDERA	PASSED
CHECKED R. M. GARCIA	APPROVED

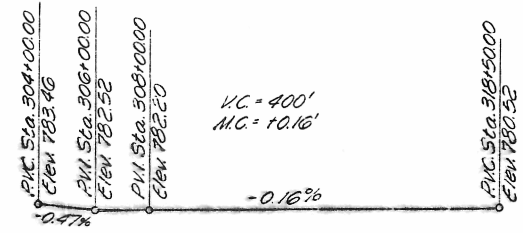

PROFILE FA. I-74

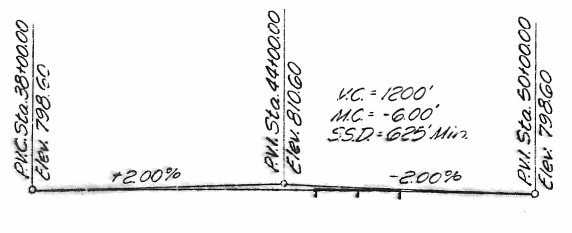

V.C. DATA FA. 119 RELOCATED

GENERAL PLAN & ELEVATION

RELOCATED FA.119 OVER FAI-74
SECTION 57-23 HB-1
McLEAN COUNTY
STA. 308+57.53 @ FAI-74