

MATCH LINE (SEE ST. CLAIR AVENUE SHEETS)

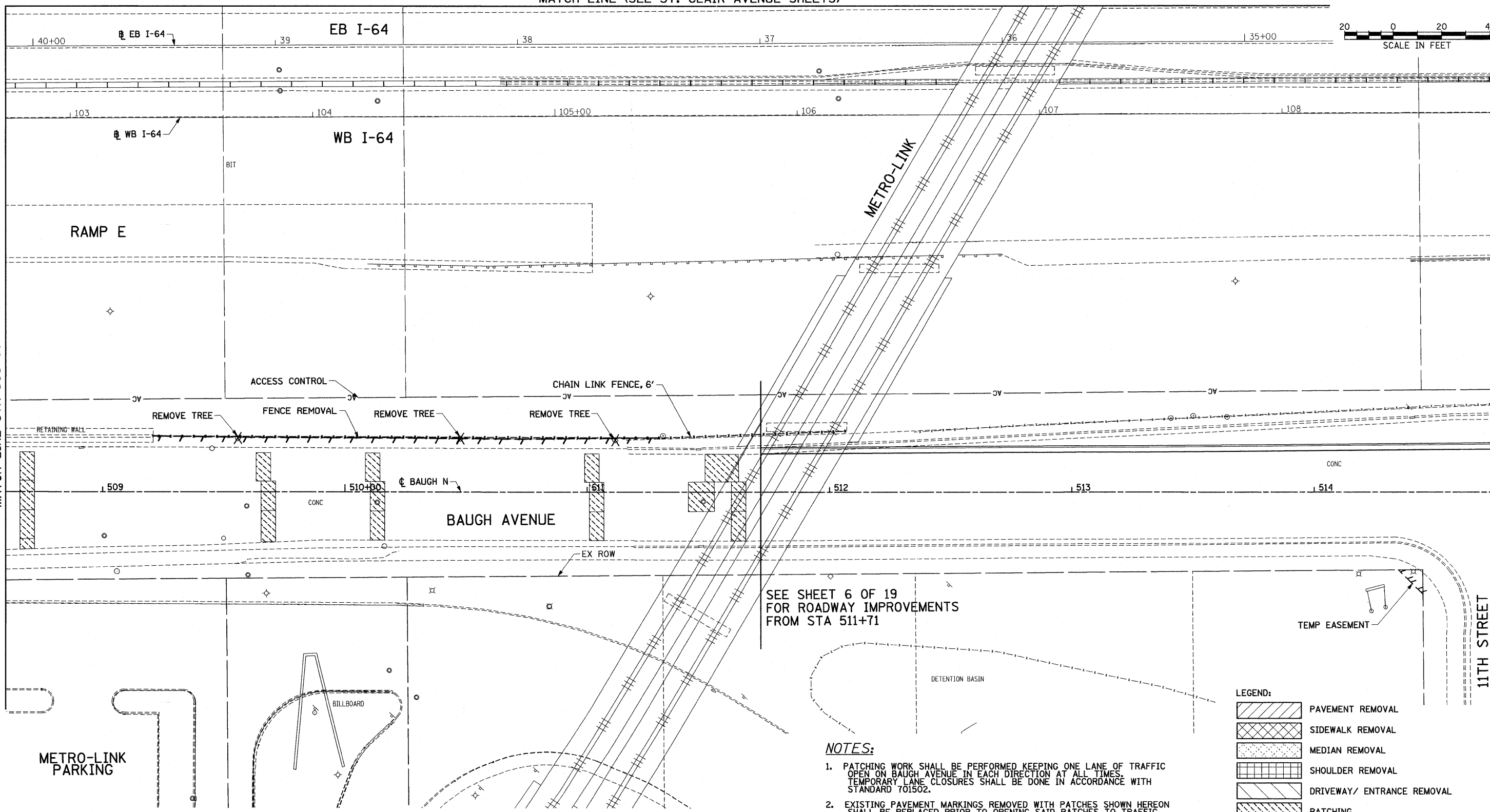

MATCH LINE STA 508+60 SEE SHEET 4 OF 19



SEE SHEET 6 OF 19 FOR ROADWAY IMPROVEMENTS FROM STA 511+71

NOTES:

- PATCHING WORK SHALL BE PERFORMED KEEPING ONE LANE OF TRAFFIC OPEN ON BAUGH AVENUE IN EACH DIRECTION AT ALL TIMES. TEMPORARY LANE CLOSURES SHALL BE DONE IN ACCORDANCE WITH STANDARD 701502.
- EXISTING PAVEMENT MARKINGS REMOVED WITH PATCHES SHOWN HEREON SHALL BE REPLACED PRIOR TO OPENING SAID PATCHES TO TRAFFIC. PAYMENT FOR REPLACEMENT OF EXISTING PAVEMENT MARKINGS SHALL CORRESPOND WITH THOSE QUANTITIES TABULATED IN THE "PAVEMENT MARKING AND SIGNING SCHEDULE" SHEETS.
- PERFORMED PLASTIC PAVEMENT MARKING IS TO BE "TYPE B INLAID" ON HMA SURFACES AND "TYPE B" WITH "GROOVING FOR RECESSED PAVEMENT MARKING" ON PCC SURFACES.

LEGEND:

	PAVEMENT REMOVAL
	SIDEWALK REMOVAL
	MEDIAN REMOVAL
	SHOULDER REMOVAL
	DRIVEWAY/ ENTRANCE REMOVAL
	PATCHING
	PAVEMENT REMOVAL (BRIDGE APPROACH)
	LINEAR REMOVAL
	TREE REMOVAL (UNITS)

FILE NAME = N:\E00037 CTE - I-70 Tr-1-Level Connection	USER NAME = .USER	DESIGNED - TTB	REVISED -
MODEL NAME = #MODELNAME	MODEL NAME = #MODELNAME	DRAWN - GDO	REVISED -
PLOT SCALE = 40.000' / IN.		CHECKED - JAH	REVISED -
PLOT DATE = 4/12/2011		DATE - 03/31/11	REVISED -

**STATE OF ILLINOIS
DEPARTMENT OF TRANSPORTATION**

ROADWAY PLAN - BAUGH AVENUE

SCALE: 1"=20' SHEET NO. 5 OF 19 SHEETS STA. TO STA.

F.A.U. RTE.	SECTION	COUNTY	TOTAL SHEETS	SHEET NO.
• 9166/9180/9213/9214	82-1-3HB, 82-2N, 82-1-12RS	ST. CLAIR	352	39
FED. ROAD DIST. NO. ILLINOIS FED. AID PROJECT			CONTRACT NO. 76C51	

4/12/2011 8:11:45 AM