

SHEET	STATION	TO STATION	FOOT	FOOT	SQFT	EACH	EACH
I-55 NB / 55N64E							
76	BEGIN	TO 59+00.00	1,495	-	486	32	-
77	59+00.00	TO 69+00/24+00	2,377	1,150	708	16	2
I-64 WB / I-64 EB							
78	69+00/24+00	TO 38+00.00	6,219	1,763	1,944	-	3
79	38+00.00	TO 52+50.00	1,007	-	401	-	-
80	52+50.00	TO END	-	-	-	-	-

<b>TOTALS</b>	<b>11,098</b>	<b>2,913</b>	<b>3,539</b>	<b>48</b>	<b>5</b>
---------------	---------------	--------------	--------------	-----------	----------

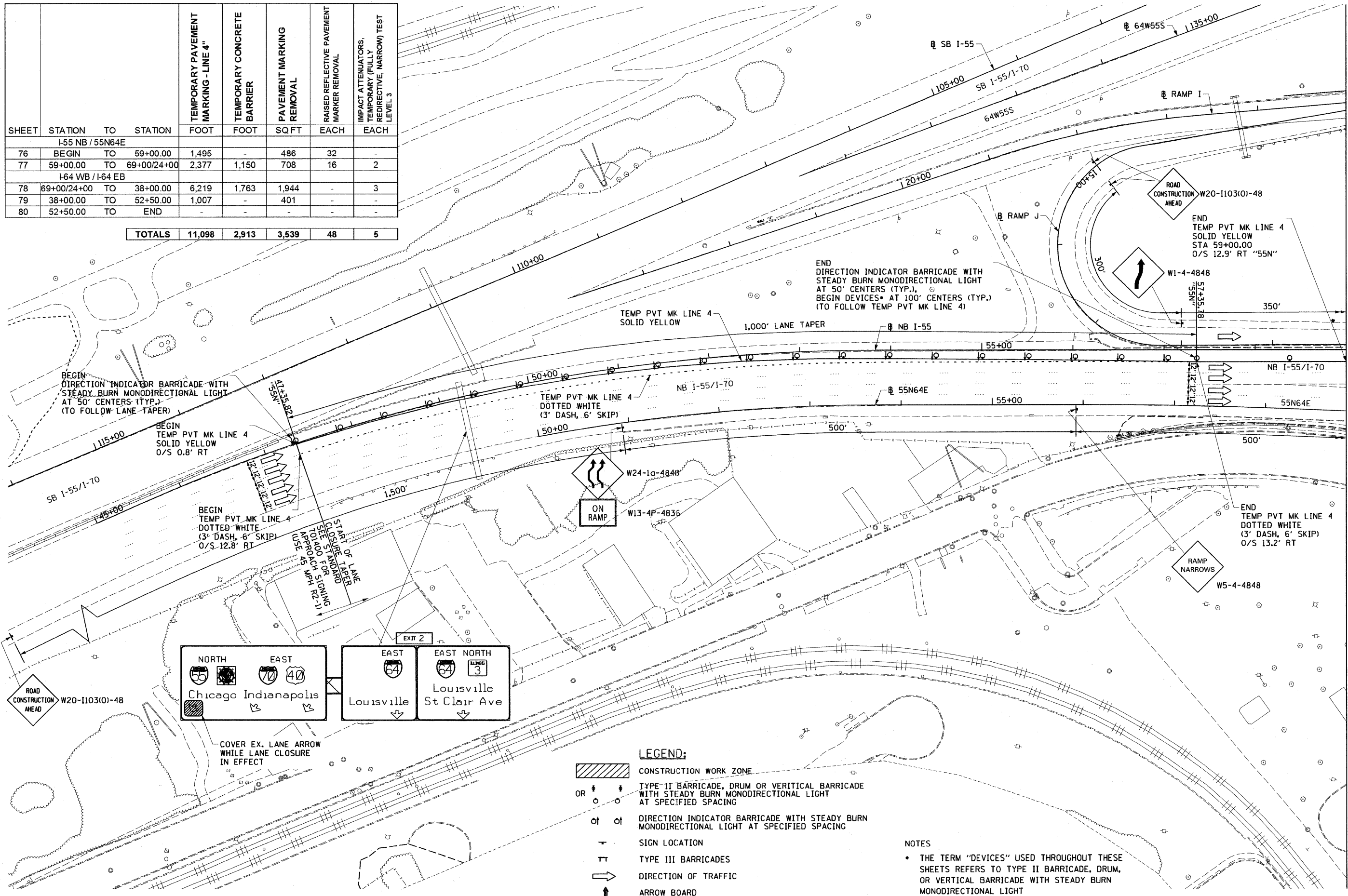

MATCHLINE STA 59+00 (R 55N)

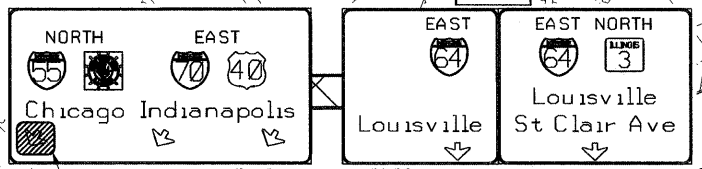

- LEGEND:**
- CONSTRUCTION WORK ZONE
  - TYPE II BARRICADE, DRUM OR VERTICAL BARRICADE WITH STEADY BURN MONODIRECTIONAL LIGHT AT SPECIFIED SPACING
  - DIRECTION INDICATOR BARRICADE WITH STEADY BURN MONODIRECTIONAL LIGHT AT SPECIFIED SPACING
  - SIGN LOCATION
  - TYPE III BARRICADES
  - DIRECTION OF TRAFFIC
  - ARROW BOARD

**NOTES**

- THE TERM "DEVICES" USED THROUGHOUT THESE SHEETS REFERS TO TYPE II BARRICADE, DRUM, OR VERTICAL BARRICADE WITH STEADY BURN MONODIRECTIONAL LIGHT

FILE NAME = DBTR1-76C51-sht-Mainline MOTI-2 Staging	USER NAME = maronsk	DESIGNED KM	REVISED -	<b>STATE OF ILLINOIS DEPARTMENT OF TRANSPORTATION</b>	<b>MAINLINE - SUGGESTED STAGES OF CONSTRUCTION AND TRAFFIC CONTROL - STAGE 1 &amp; 2</b>	F.A. RTE.	SECTION	COUNTY	TOTAL SHEETS	SHEET NO.
PLOT SCALE = 100.0000' / in.	CHECKED OP	DRAWN KM	REVISED -			82-1-3HB, 82-2N, 82-1-12RS	ST. CLAIR	352	76	
PLOT DATE = MAR. 31, 2011	DATE 03/31/2011	CHECKED OP	REVISED -			9166/9180/9213/9214	CONTRACT NO. 76C51			
		DATE 03/31/2011	REVISED -			FED. ROAD DIST. NO.	ILLINOIS FED. AID PROJECT			

SCALE: 1"=50' SHEET NO. 1 OF 5 SHEETS STA. TO STA.