

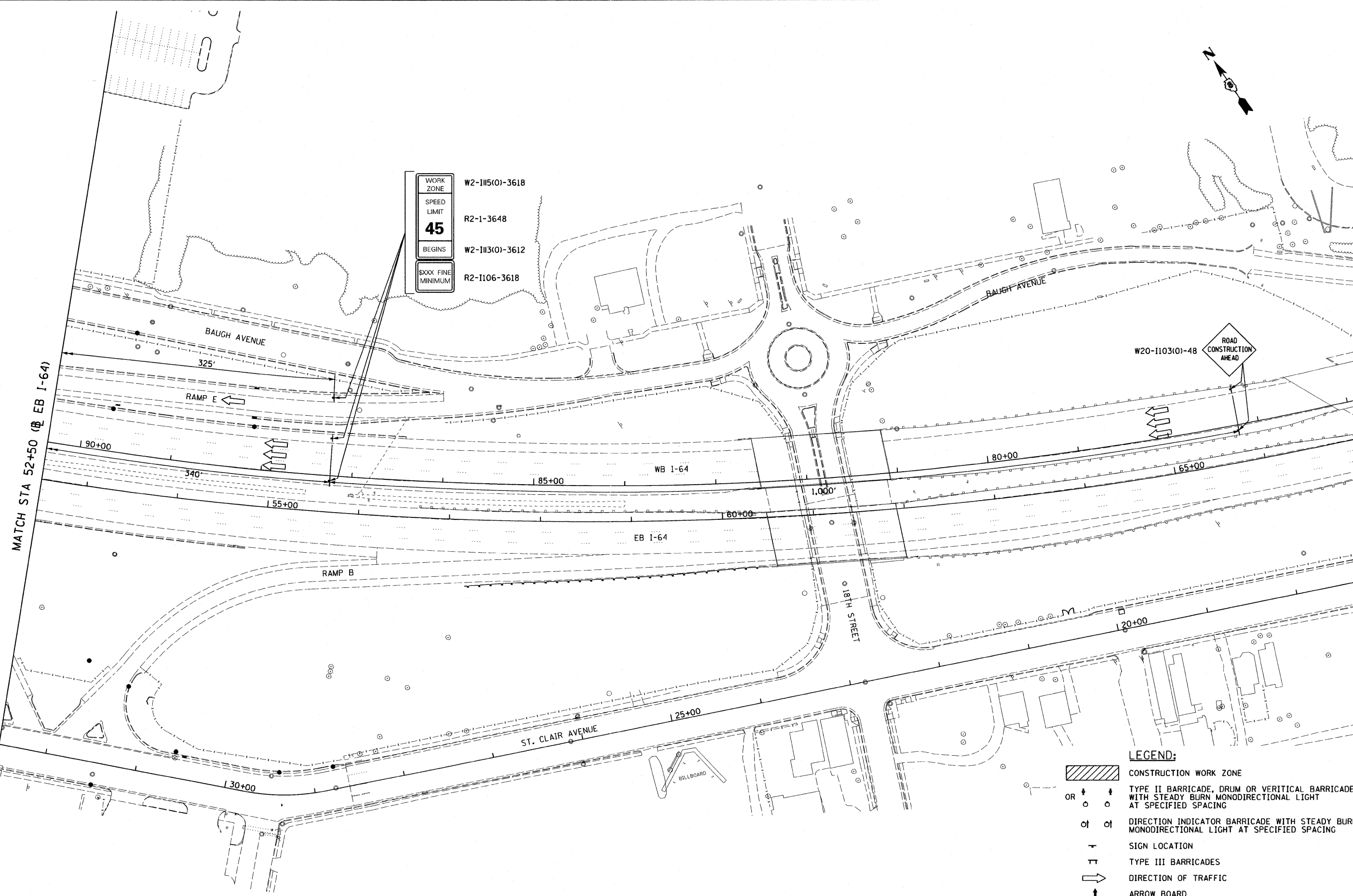

WORK ZONE	W2-1115(0)-3618
SPEED LIMIT	R2-1-3648
<b>45</b>	
BEGINS	W2-1113(0)-3612
XXXX FINE MINIMUM	R2-1106-3618

MATCH STA 52+50 (EB I-64)



W20-1103(0)-48  
ROAD CONSTRUCTION AHEAD

- LEGEND:**
- CONSTRUCTION WORK ZONE
  - OR TYPE II BARRICADE, DRUM OR VERTICAL BARRICADE WITH STEADY BURN MONODIRECTIONAL LIGHT AT SPECIFIED SPACING
  - DIRECTION INDICATOR BARRICADE WITH STEADY BURN MONODIRECTIONAL LIGHT AT SPECIFIED SPACING
  - SIGN LOCATION
  - TYPE III BARRICADES
  - DIRECTION OF TRAFFIC
  - ARROW BOARD

FILE NAME =	USER NAME = moransk	DESIGNED KM	REVISED -
D8TR1-76C51-sht-MainLine MOTI-2 Staging	5.dgn	DRAWN KM	REVISED -
	PLOT SCALE = 100.0000' / in.	CHECKED OP	REVISED -
	PLOT DATE = MAR. 31, 2011	DATE 03/31/2011	REVISED -

**STATE OF ILLINOIS  
DEPARTMENT OF TRANSPORTATION**

**MAINLINE - SUGGESTED STAGES OF CONSTRUCTION  
AND TRAFFIC CONTROL - STAGE 1 & 2**

SCALE: 1"=50' SHEET NO. 5 OF 5 SHEETS STA. TO STA.

F.A. RTE.	SECTION	COUNTY	TOTAL SHEETS	SHEET NO.
•	B2-1-3HB, B2-2N, B2-1-12RS	ST. CLAIR	352	80
•	9166/9180/9213/9214			CONTRACT NO. 76C51
FED. ROAD DIST. NO.	ILLINOIS FED. AID PROJECT			