

MATCH LINE STA. 69+00 SEE SHEET 6 OF 6

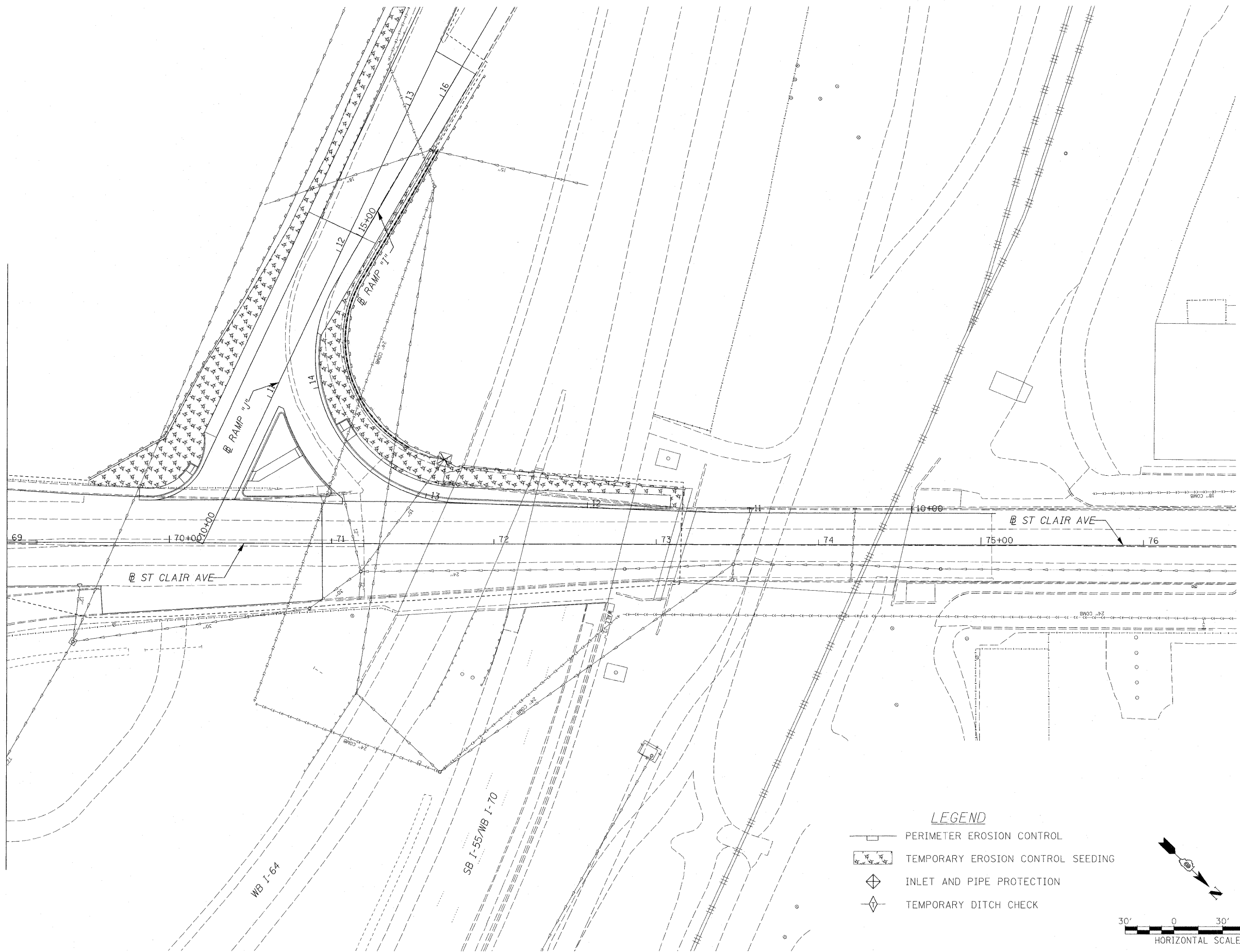

LEGEND

- PERIMETER EROSION CONTROL
- TEMPORARY EROSION CONTROL SEEDING
- INLET AND PIPE PROTECTION
- TEMPORARY DITCH CHECK

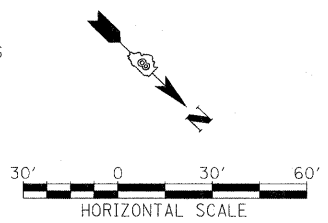

FILE NAME = D8-TRI-76C51-sht-eros-01-05.dgn	USER NAME = moransk	DESIGNED KM	REVISED -	STATE OF ILLINOIS DEPARTMENT OF TRANSPORTATION	EROSION CONTROL PLAN			F.A. RTE.	SECTION	COUNTY	TOTAL SHEETS	SHEET NO.
	PLOT SCALE = 30.0000' / in.	CHECKED DBM	REVISED -					• 82-1-3HB, 82-2N, 82-1-12RS	ST. CLAIR	352	91	
	PLOT DATE = MAR. 31, 2011	DATE 08/18/2011	REVISED -					• 9166/9180/9213/9214	CONTRACT NO. 76C51			
				SCALE: 1"=30'	SHEET NO. 6 OF 6 SHEETS	STA. 61+50.00 TO STA. 75+38.00	FED. ROAD DIST. NO. ILLINOIS FED. AID PROJECT					