

W4-8L
LOCATE SIGN
AT RAMP I
STA 18+00, 16' R

SIGN LEGEND

- YIELD
R1-2
36"
- NORTH
M3-1
12" X 24"
- SOUTH
M3-3
12" X 24"
- SOUTH
M3-3 (INTERSTATE)
12" X 24"
- EAST
M3-2 (INTERSTATE)
12" X 24"
- WEST
M3-4 (INTERSTATE)
12" X 24"
- STATE ROUTE
M1-1100
24" X 24"
- INTERSTATE ROUTE
M1-1
24" X 24"
- LEFT DIAGONAL ARROW PLAQUE
W16-7PL
12" X 24"
- ADDED LANE
W4-8L
36" X 36"
- DIRECTIONAL ARROW AUXILIARY
M6-3
15" X 21"
- DIRECTIONAL ARROW AUXILIARY
M6-3 (INTERSTATE)
15" X 21"
- DIRECTIONAL ARROW AUXILIARY
M6-1L
16" X 21"
- DIRECTIONAL ARROW AUXILIARY
M6-1R (INTERSTATE)
15" X 21"
- CASINO
D11-1101
24" X 24"
- MANDATORY MOVEMENT LANE CONTROL
R3-5R
30" X 36"
- TO AUXILIARY
M4-5 (INTERSTATE)
12" X 24"
- U.S. ROUTE MARKER
M1-4
24" X 24"
- PEDESTRIAN CROSSING
W11-2
36" X 36"

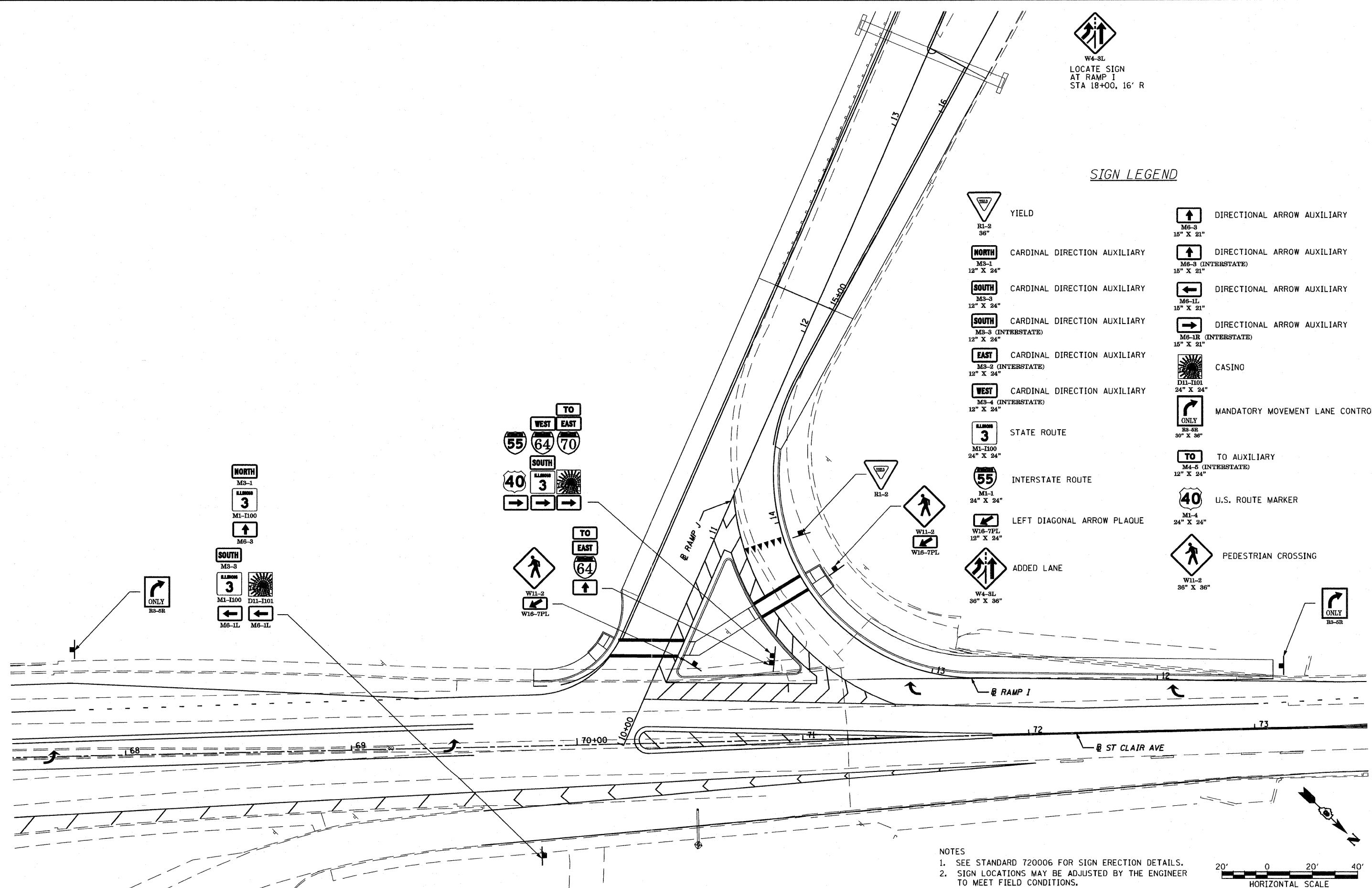

NOTES
1. SEE STANDARD 720006 FOR SIGN ERECTION DETAILS.
2. SIGN LOCATIONS MAY BE ADJUSTED BY THE ENGINEER TO MEET FIELD CONDITIONS.

FILE NAME = DBTRI-76C51-sht-signs-01-06.dgn USER NAME = jlt MODEL NAME = DBTRI-76C51-sht-signs-05 PLOT SCALE = 1:40 PLOT DATE = 6/8/2011	DESIGNED - LDT DRAWN - MBB CHECKED - GEB DATE - 03/31/11	REVISED - REVISED - REVISED - REVISED -	STATE OF ILLINOIS DEPARTMENT OF TRANSPORTATION	SIGNING PLAN AND DETAILS	F.A.J. RTE. SECTION COUNTY TOTAL SHEETS SHEET NO. • 82-1-3HB, 82-2N, 82-1-12RS ST. CLAIR 352 166 • FAI 64/9166/9180 CONTRACT NO. 76C51 FED. ROAD DIST. NO. ILLINOIS FED. AID PROJECT
SCALE: 1"=20' SHEET NO. 6 OF 7 SHEETS STA. ----- TO STA. -----					

6/8/2011 11:00:18 AM

P:\08-0030_CTE_TRL\LEVEL\900_CAD\901_DRAWINGS\08_CONTRACT\SHEET\CVL\SIGNING_PVT\MARKING\DBTRI-76C51-SHT-SIGNS-01-06.DGN