

DATE	
BY	
FINAL SURVEY	
PLOTTED	
NOTE BOOK	
NO.	
AREAS CHECKED	

DATE	
BY	
ORIGINAL SURVEY	
PLOTTED	
NOTE BOOK	
NO.	
AREAS CHECKED	

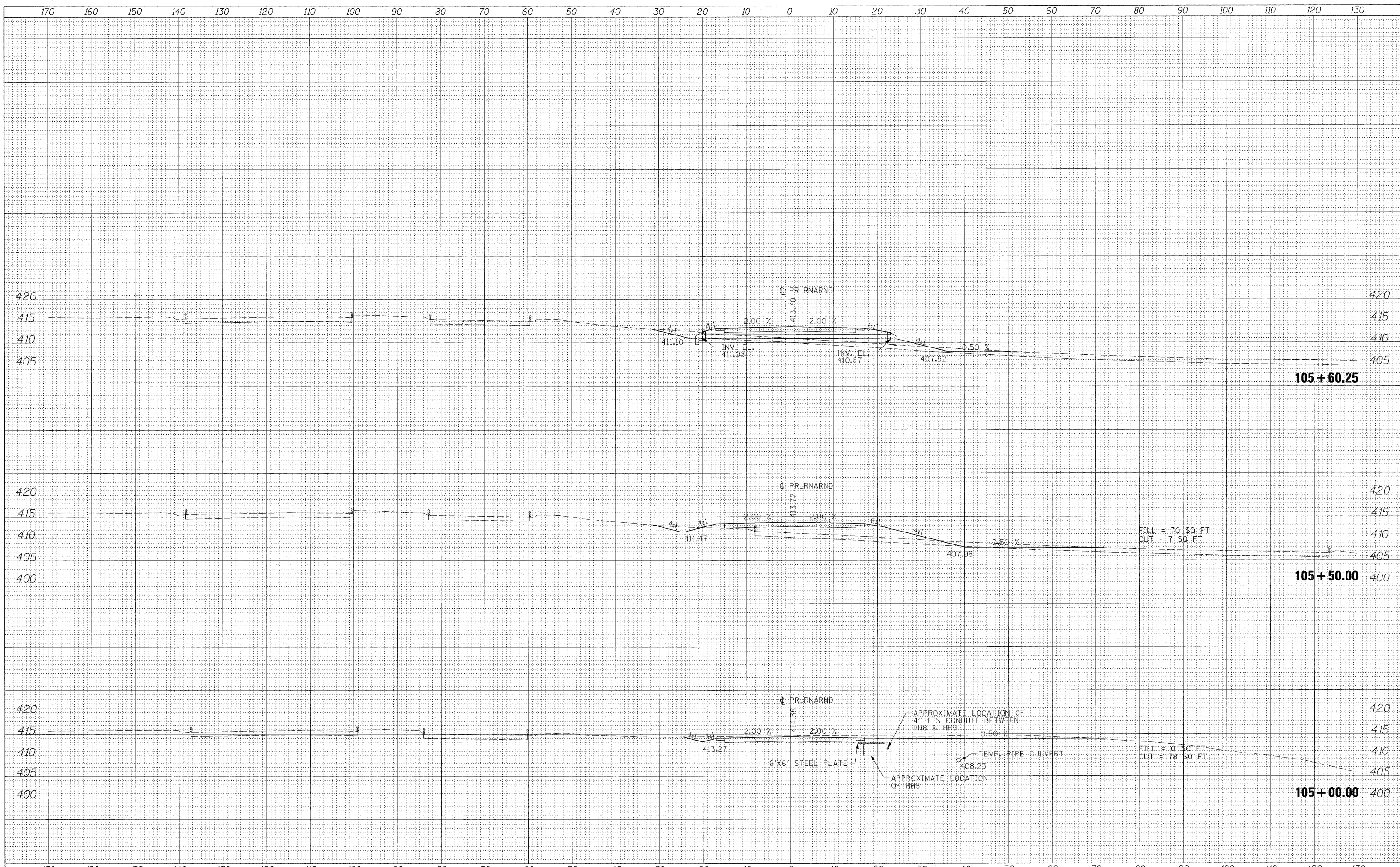

FILE NAME = D8TRI-76C52-XS-SHT-RNARND.dgn

USER NAME = moransk  
 PLOT SCALE = 10.0000' / in.  
 PLOT DATE = MAR. 31, 2011

DESIGNED - KM	REVISED -
DRAWN - KM	REVISED -
CHECKED - DBM	REVISED -
DATE - 08/18/2011	REVISED -

**STATE OF ILLINOIS  
 DEPARTMENT OF TRANSPORTATION**

**RUNAROUND CROSS SECTIONS**  
 SCALE: 1"=10'  
 SHEET NO. 278 OF 27 SHEETS  
 STA. 105+00.00 TO STA. 105+60.25

F.A. RTE.	SECTION	COUNTY	TOTAL SHEETS	SHEET NO.
	82-1-3HB, 82-2N, 82-1-12RS	ST. CLAIR	352	329B
	9166/9180/9213/9214.			CONTRACT NO. 76C51
ILLINOIS FED. AID PROJECT				