

STATE OF ILLINOIS  
DEPARTMENT OF TRANSPORTATION  
DIVISION OF HIGHWAYS

DATE OF SHEET	DATE OF SHEET	DATE OF SHEET	DATE OF SHEET	DATE OF SHEET
11/8/2011	11/8/2011	11/8/2011	11/8/2011	11/8/2011

E.M.: "E"-chiseled Square on N.W. Wingwall of Bridge over Buckhart Creek on S.A. Rte. 4, Elev. 551.55  
Existing structure @ Sta. 212+90 built in 1935 as S.A. Rte. 4 Sec. 14B-150 Existing R.C.C.G. superstructure to be replaced & widened as shown utilizing stage construction so as to maintain traffic over the bridge at all times Existing abutments & Piers to be widened to accommodate the new location of the superstructure.

GENERAL NOTES

All reinforcement bars shall be lapped 24 diameters unless otherwise shown.  
It shall be the responsibility of the contractor to verify all dimensions and conditions existing in the field prior to construction and ordering of materials.  
Protective Coat shall not be applied to surfaces to which Waterproofing Membrane System is applied.  
Expansion bolts shall consist of self-drilling expansion anchors and 3/8" hooked bolts. Hooked bolts shall extend a minimum of 12" into new concrete unless otherwise shown.  
Shoulder transition to wingwall shall be chaped with broken concrete. 3:1 incidental.

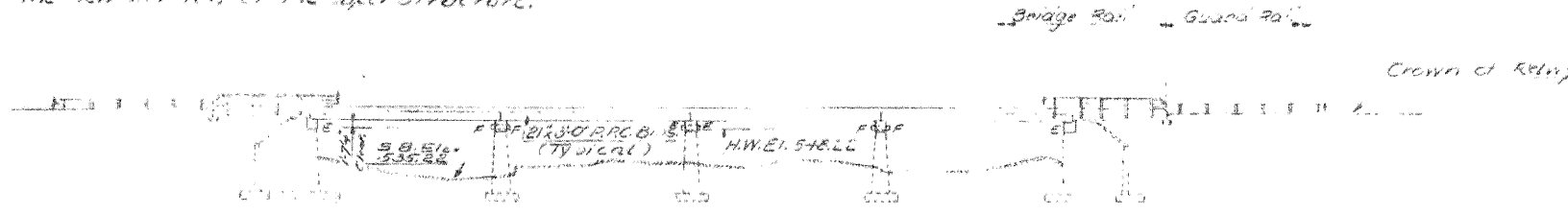

ELEVATION

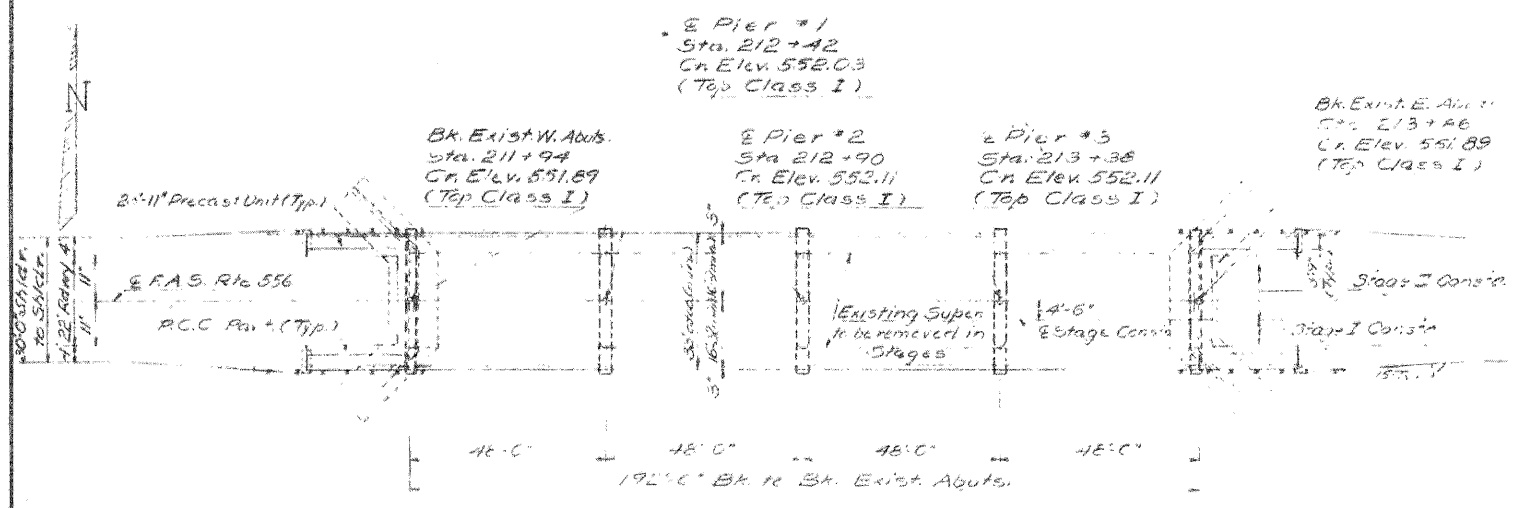

PLAN

TOTAL BILL OF MATERIAL

Item	Unit	Super	Sub	Total
Bituminous Concrete Surface Course, Class I	Tons	85		85
Portland Cement Concrete Pavement (10")	Sq. Yds.	51		51
Pavement Fabric	Sq. Yds.	51		51
Concrete Removal	Cu. Yds.		21	21
Expansion Bolts (3/8")	Each	60	132	192
Class X Concrete	Cu. Yds.	20.4	53.1	73.5
Precast Concrete Bridge Slab	Sq. Ft.	359		359
Precast Prestressed Concrete Deck Beams (27)	Sq. Ft.	630.4		630.4
Steel Railing, Type I	Lin. Ft.	192		192
Reinforcement Bars	Lbs.	1070	7480	8550
Pavement Removal R.C.C. Replacement, Type I (10")	Sq. Yds.	9		9
Removal of Existing Superstructures	Each	1		1
Waterproofing Membrane System	Sq. Yds.	658		658
Turn Plates	Each		1	1
Preformed Joint Sealer 2 1/2	Lin. Ft.	99		99
Temporary Guard Rail	Lin. Ft.	192		192
Protective Coat Structures, Steel	Sq. Yds.	30		30
	Lbs.	6990		6990

\* 5/2 to 5/2 Existing Abutments  
\*\* See Special Provisions.

Structure # 0080

STATION 212+90.00  
BUCKHART CREEK  
REBUILT '19  
F.A.S. RTE. 556 SEC. 14BR  
LOADING H320

NAME PLATE  
399 3rd 213

DESIGNED: [Signature]  
CHECKED: [Signature]  
DRAWN: [Signature]  
CHECKED: [Signature]

WATERWAY INFORMATION

Drainage Area: 151.70 Sq. Mi.  
Channel: [unclear] [unclear]  
Required Channel: [unclear] [unclear]  
Proposed Channel: [unclear] [unclear]  
[unclear] [unclear]

DESIGN STRESS

PRECAST PRESTR. UNITS PRECAST UNITS  
f'c = 5000 psi f'c = 4500 psi  
f'ci = 4000 psi f'ci = 3500 psi  
f'ps = 270000 psi (70% stressed) f'ps = 250000 psi (70% stressed)  
f'ps = 144700 psi (70% stressed) f'ps = 135000 psi (70% stressed)

FIELD UNIT

f'c = 4000 psi  
f'ci = 3000 psi  
f'ps = 10

SANGAMON County Sec 73-00119-00NR

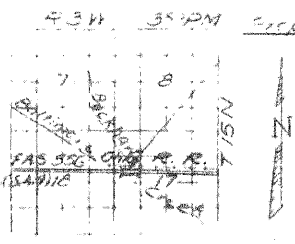

LOCATION SKETCH

GENERAL PLAN & ELEVATION  
F.A.S. RTE. 556 (SARTE 4) OVER  
BUCKHART CREEK  
F.A.S. RTE. 556 SECTION 14BR  
SANGAMON COUNTY  
STA. 212+90.00

Revised 9-17-78 W.H. (Updating)