

FILE PATH = p:\1\388035-p\mt\aecon\line\local\p\AECD000\Documents\01_Americas\Transportation\60269938_Circle\Phase\I\000_CAD\006_Roadway\Sheets\60X62_Contract\0160X62-Sht-ATB-04.dgn

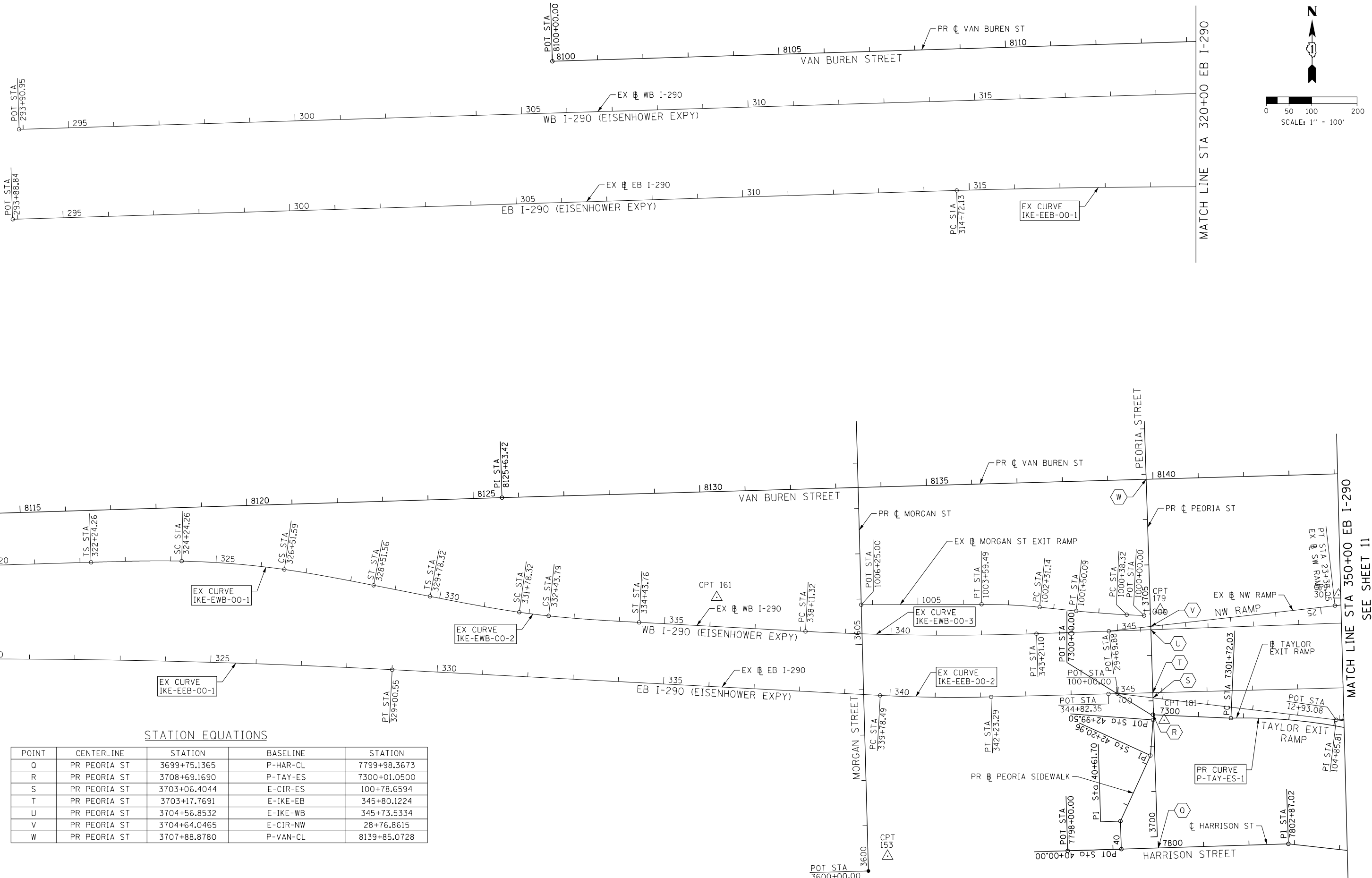

STATION EQUATIONS

POINT	CENTERLINE	STATION	BASELINE	STATION
Q	PR PEORIA ST	3699+75.1365	P-HAR-CL	7799+98.3673
R	PR PEORIA ST	3708+69.1690	P-TAY-ES	7300+01.0500
S	PR PEORIA ST	3703+06.4044	E-CIR-ES	100+78.6594
T	PR PEORIA ST	3703+17.7691	E-IKE-EB	345+80.1224
U	PR PEORIA ST	3704+56.8532	E-IKE-WB	345+73.5334
V	PR PEORIA ST	3704+64.0465	E-CIR-NW	28+76.8615
W	PR PEORIA ST	3707+88.8780	P-VAN-CL	8139+85.0728



D:\60X62-Sht-ATB-04.dgn
 USER NAME = BAW:tor t
 PLOT SCALE = 200.0000' / in.
 PLOT DATE = 8/19/2014

DESIGNED - JLV
 DRAWN - BAW
 CHECKED - JMG
 DATE - 8/20/2014

STATE OF ILLINOIS
DEPARTMENT OF TRANSPORTATION

ALIGNMENT, TIES AND BENCHMARKS
 SCALE: 1" = 100'
 SHEET 4 OF 9 SHEETS
 STA. 293+88.84 TO STA. 350+00

F.A.I. RTE.	SECTION	COUNTY	TOTAL SHEETS	SHEET NO.
90/94/290	2013-0741	COOK	58	13
CONTRACT NO. 60X62				
ILLINOIS FED. AID PROJECT				

SEE SHEET 11