

FILE PATH = p:\388035\pmt\lsc\comon\me\local\p\AECD\00\Documents\01_Americas\Transportation\60269938_Circle\Phase_1\1\000_CAD\006_Roadway_Sheets\60X62_Contract\0160X62-Sht-Sign-01.dgn

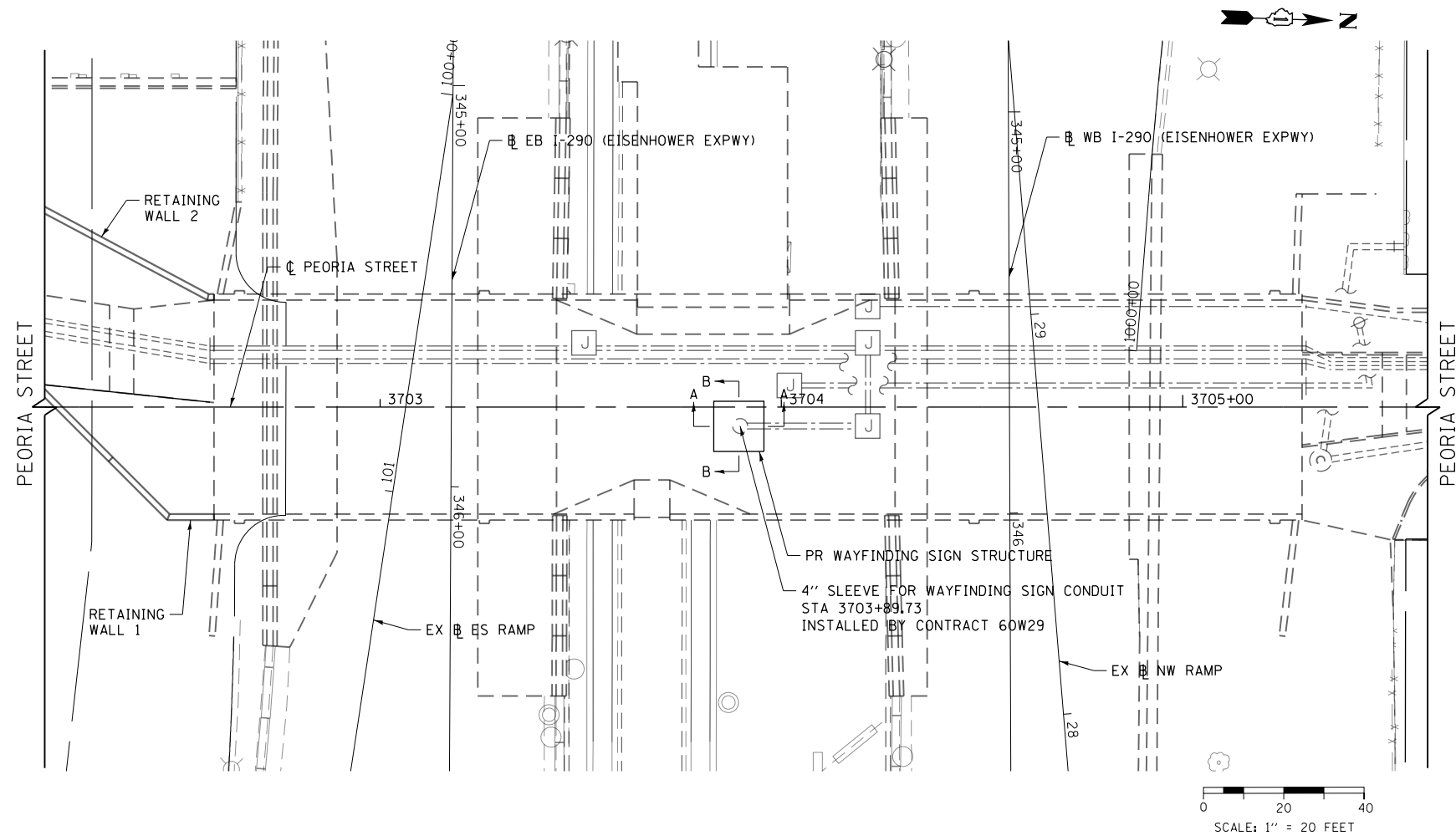

NOTES

1. PROPOSED WAYFINDING STRUCTURE TO BE FABRICATED BY THIS CONTRACT. WORK SHALL BE PAID FOR AS WAYFINDING SIGN, SPECIAL. ALL COMPONENTS OTHER THAN THE STRUCTURAL STEEL, SIGN STRUCTURE BASE AND OTHER APPURTENANCES WHICH MAKE UP THE ENCLOSURE AND SUPPORTS OF THE SIGN WILL BE FABRICATED AND INSTALLED BY THE UNIVERSITY OF ILLINOIS AT CHICAGO BY IDOT PERMIT AT A FUTURE DATE.
2. THE WAYFINDING SIGN STRUCTURE SHOP DRAWINGS SHALL BE SUBMITTED TO THE UNIVERSITY OF ILLINOIS AT CHICAGO FOR APPROVAL.

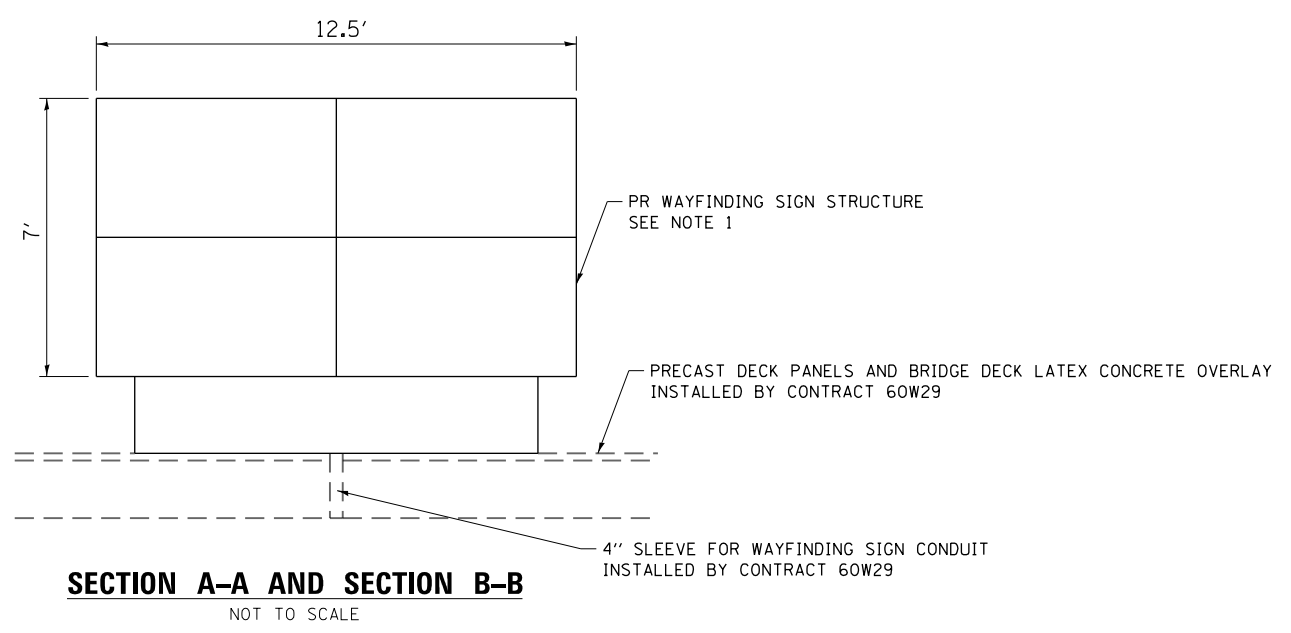
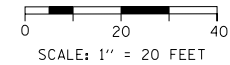

SECTION A-A AND SECTION B-B
NOT TO SCALE



DI60X62-Sht-Sign-01.dgn	DESIGNED - JLV	REVISED -
USER NAME = BAWtor1	DRAWN - BAW	REVISED -
PLOT SCALE = 40.0000' / in.	CHECKED - JMG	REVISED -
PLOT DATE = 8/19/2014	DATE - 8/20/2014	REVISED -

STATE OF ILLINOIS
DEPARTMENT OF TRANSPORTATION

WAYFINDING SIGN PLAN

SCALE: 1"=20' SHEET 1 OF 1 SHEETS STA. TO STA.

F.A.I. RTE.	SECTION	COUNTY	TOTAL SHEETS	SHEET NO.
90/94/290	2013-0741	COOK	58	47
CONTRACT NO. 60X62				
ILLINOIS FED. AID PROJECT				