

WEST EDGE OF SHOULDER

Location	Station	Offset	Theoretical Grade Elevations
S. End South Appr. Slab	631+17.83	-41.45	646.42
A1	631+27.83	-41.45	646.50
A2	631+37.83	-41.45	646.58
W. End South Appr. Slab	631+47.83	-41.45	646.64

WEST EDGE OF SOUTHBOUND PAVEMENT

Location	Station	Offset	Theoretical Grade Elevations
S. End South Appr. Slab	631+35.59	-31.45	646.76
A1	631+45.59	-31.45	646.83
A2	631+55.59	-31.45	646.89
W. End South Appr. Slab	631+65.59	-31.45	646.95

SOUTHBOUND PGL

Location	Station	Offset	Theoretical Grade Elevations
S. End South Appr. Slab	631+56.90	-19.45	647.14
A1	631+66.90	-19.45	647.19
A2	631+76.90	-19.45	647.24
W. End South Appr. Slab	631+86.90	-19.45	647.28

EAST EDGE OF SOUTHBOUND PAVEMENT

Location	Station	Offset	Theoretical Grade Elevations
S. End South Appr. Slab	631+78.22	-7.45	647.49
A1	631+88.22	-7.45	647.53
A2	631+98.22	-7.45	647.56
W. End South Appr. Slab	632+08.22	-7.45	647.59

CENTERLINE OF ROADWAY

Location	Station	Offset	Theoretical Grade Elevations
S. End South Appr. Slab	631+91.45	0.00	647.69
A1	632+01.45	0.00	647.72
A2	632+11.45	0.00	647.75
W. End South Appr. Slab	632+21.45	0.00	647.76

CENTERLINE OF STRUCTURE /  
STAGE CONSTRUCTION LINE

Location	Station	Offset	Theoretical Grade Elevations
S. End South Appr. Slab	631+97.75	3.55	647.78
A1	632+07.75	3.55	647.81
A2	632+17.75	3.55	647.83
W. End South Appr. Slab	632+27.75	3.55	647.84

WEST EDGE OF NORTHBOUND PAVEMENT

Location	Station	Offset	Theoretical Grade Elevations
S. End South Appr. Slab	632+17.29	14.55	647.61
A1	632+27.29	14.55	647.62
A2	632+37.29	14.55	647.63
W. End South Appr. Slab	632+47.29	14.55	647.63

NORTHBOUND PGL

Location	Station	Offset	Theoretical Grade Elevations
S. End South Appr. Slab	632+38.60	26.55	647.39
A1	632+48.60	26.55	647.39
A2	632+58.60	26.55	647.39
W. End South Appr. Slab	632+68.60	26.55	647.38

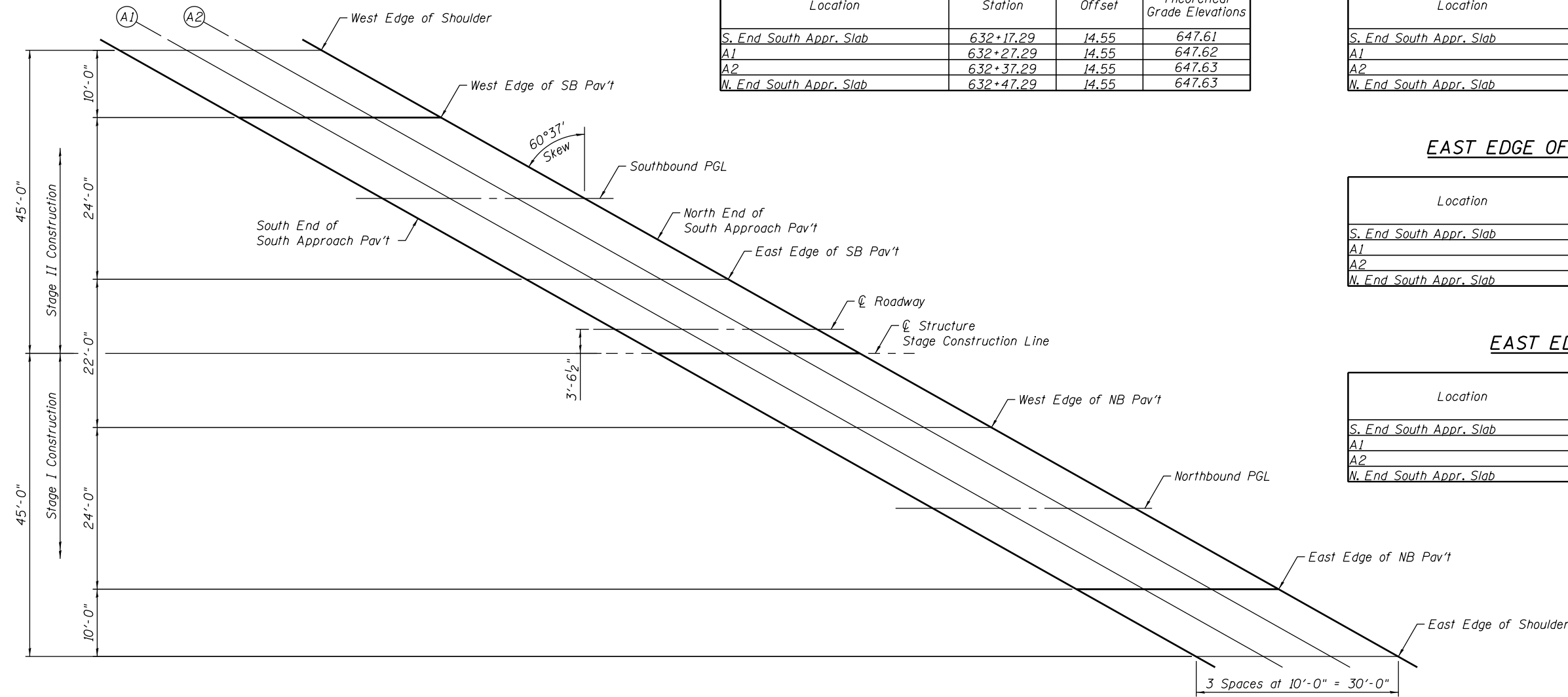

EAST EDGE OF NORTHBOUND PAVEMENT

Location	Station	Offset	Theoretical Grade Elevations
S. End South Appr. Slab	632+59.91	38.55	647.15
A1	632+69.91	38.55	647.14
A2	632+79.91	38.55	647.12
W. End South Appr. Slab	632+89.91	38.55	647.09

EAST EDGE OF SHOULDER

Location	Station	Offset	Theoretical Grade Elevations
S. End South Appr. Slab	632+77.67	48.55	646.92
A1	632+87.67	48.55	646.90
A2	632+97.67	48.55	646.87
W. End South Appr. Slab	633+07.67	48.55	646.83

**PLAN**  
South Approach



FILE NAME = s:\p\16380--6395\6346\025\macro\Sh\Structural\Plans\0980015-64C17-005-ASE.dgn

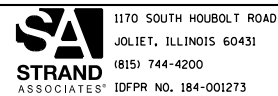

1170 SOUTH HOUBOLT ROAD  
JOLIET, ILLINOIS 60431  
(815) 744-4200  
IDFPR NO. 184-001273

USER NAME = briantf  
DESIGNED - RRD  
CHECKED - AJS  
DRAWN - BJF  
CHECKED - RRD  
PLOT SCALE =  
PLOT DATE = 8/14/2014

REVISED  
REVISED  
REVISED  
REVISED

**STATE OF ILLINOIS  
DEPARTMENT OF TRANSPORTATION**

**TOP OF SOUTH APPROACH SLAB ELEVATIONS  
STRUCTURE NO. 098-0015**  
SHEET NO. 9 OF 35 SHEETS

F.A.P. RTE.	SECTION	COUNTY	TOTAL SHEETS	SHEET NO.
646	101 BR-3	WHITESIDE	130	68
CONTRACT NO. 64C17				

ILLINOIS FED. AID PROJECT