

WEST EDGE OF SHOULDER

Location	Station	Offset	Theoretical Grade Elevations
S. End North Appr. Slab	632+25.11	-41.45	646.94
A3	632+35.11	-41.45	646.95
A4	632+45.11	-41.45	646.95
W. End North Appr. Slab	632+55.11	-41.45	646.95

WEST EDGE OF SOUTHBOUND PAVEMENT

Location	Station	Offset	Theoretical Grade Elevations
S. End North Appr. Slab	632+42.86	-31.45	647.15
A3	632+52.86	-31.45	647.15
A4	632+62.86	-31.45	647.14
W. End North Appr. Slab	632+72.86	-31.45	647.13

SOUTHBOUND PGL

Location	Station	Offset	Theoretical Grade Elevations
S. End North Appr. Slab	632+64.18	-19.45	647.38
A3	632+74.18	-19.45	647.37
A4	632+84.18	-19.45	647.35
W. End North Appr. Slab	632+94.18	-19.45	647.32

EAST EDGE OF SOUTHBOUND PAVEMENT

Location	Station	Offset	Theoretical Grade Elevations
S. End North Appr. Slab	632+85.49	-7.45	647.58
A3	632+95.49	-7.45	647.55
A4	633+05.49	-7.45	647.52
W. End North Appr. Slab	633+15.49	-7.45	647.48

CENTERLINE OF ROADWAY

Location	Station	Offset	Theoretical Grade Elevations
S. End North Appr. Slab	632+98.72	0.00	647.69
A3	633+08.72	0.00	647.65
A4	633+18.72	0.00	647.61
W. End North Appr. Slab	633+28.72	0.00	647.56

CENTERLINE OF STRUCTURE /
STAGE CONSTRUCTION LINE

Location	Station	Offset	Theoretical Grade Elevations
S. End North Appr. Slab	633+05.02	3.55	647.74
A3	633+15.02	3.55	647.70
A4	633+25.02	3.55	647.65
W. End North Appr. Slab	633+35.02	3.55	647.59

WEST EDGE OF NORTHBOUND PAVEMENT

Location	Station	Offset	Theoretical Grade Elevations
S. End North Appr. Slab	633+24.56	14.55	647.43
A3	633+34.56	14.55	647.38
A4	633+44.56	14.55	647.32
W. End North Appr. Slab	633+54.56	14.55	647.25

NORTHBOUND PGL

Location	Station	Offset	Theoretical Grade Elevations
S. End North Appr. Slab	633+45.87	26.55	647.07
A3	633+55.87	26.55	647.00
A4	633+65.87	26.55	646.92
W. End North Appr. Slab	633+75.87	26.55	646.84

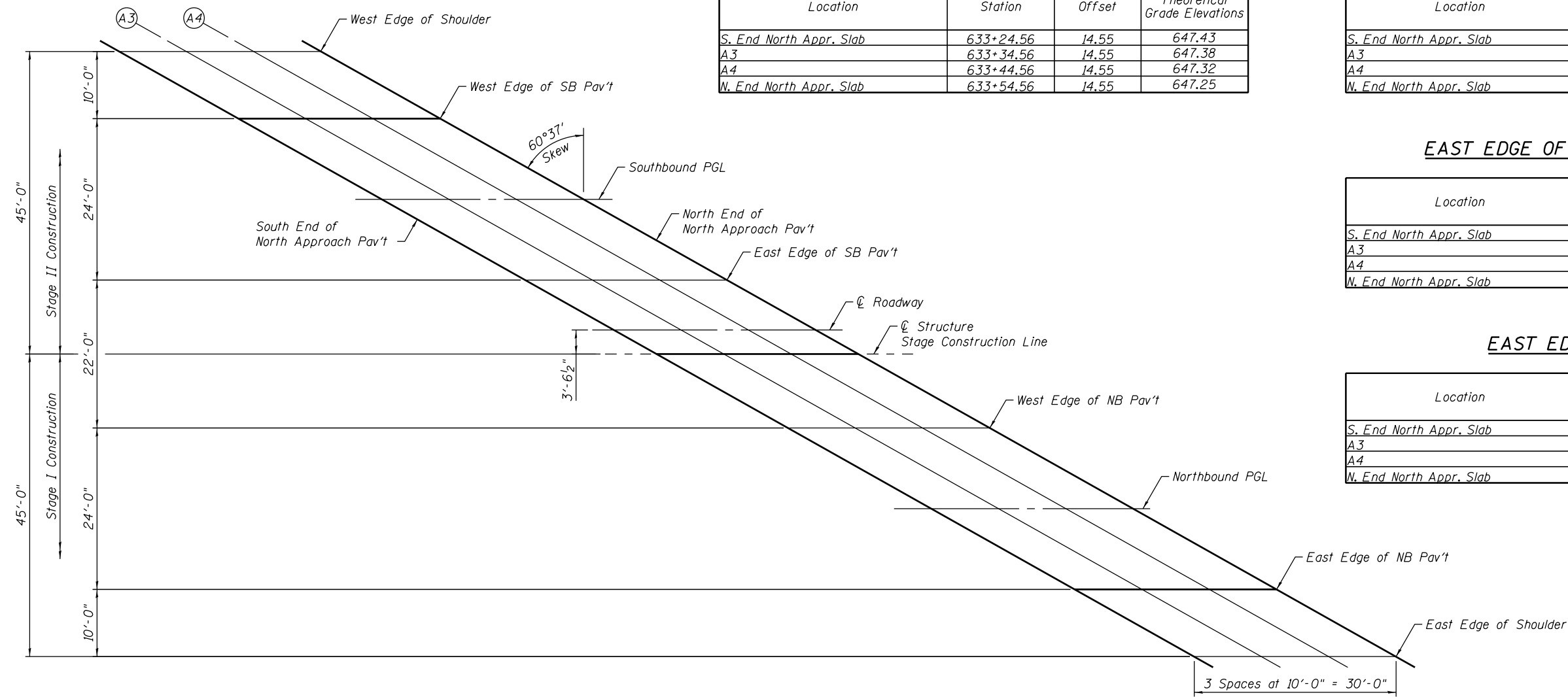

EAST EDGE OF NORTHBOUND PAVEMENT

Location	Station	Offset	Theoretical Grade Elevations
S. End North Appr. Slab	633+67.18	38.55	646.67
A3	633+77.18	38.55	646.59
A4	633+87.18	38.55	646.50
W. End North Appr. Slab	633+97.18	38.55	646.41

EAST EDGE OF SHOULDER

Location	Station	Offset	Theoretical Grade Elevations
S. End North Appr. Slab	633+84.94	48.55	646.32
A3	633+94.94	48.55	646.23
A4	634+04.94	48.55	646.13
W. End North Appr. Slab	634+14.94	48.55	646.02

PLAN
North Approach

FILE NAME = s:\p\16300--6395\6346\025\macro\Sh\Structural\Plans\0980015-64C17-005-ASE.dgn

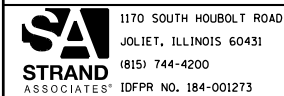

1170 SOUTH HOUBOLT ROAD JOLIET, ILLINOIS 60431 (815) 744-4200 IDFPR NO. 184-001273	USER NAME = briantf	DESIGNED - RRD	REVISIONS
	PLOT SCALE =	CHECKED - AJS	REVISIONS
	PLOT DATE = 8/14/2014	DRAWN - BJF	REVISIONS
		CHECKED - RRD	REVISIONS

**STATE OF ILLINOIS
DEPARTMENT OF TRANSPORTATION**

**TOP OF NORTH APPROACH SLAB ELEVATIONS
STRUCTURE NO. 098-0015**

F.A.P. RTE. 646	SECTION 101 BR-3	COUNTY WHITESIDE	TOTAL SHEETS 130	SHEET NO. 69
CONTRACT NO. 64C17				ILLINOIS FED. AID PROJECT