

PLAN	SURVEYED	DATE
	PLOTTED	BY
	GRADES CHECKED	
	STRUCTURE NOTATIONS CHECKED	
	NO. _____	

PROFILE	SURVEYED	DATE
	PLOTTED	BY
	GRADES CHECKED	
	STRUCTURE NOTATIONS CHECKED	
	NO. _____	

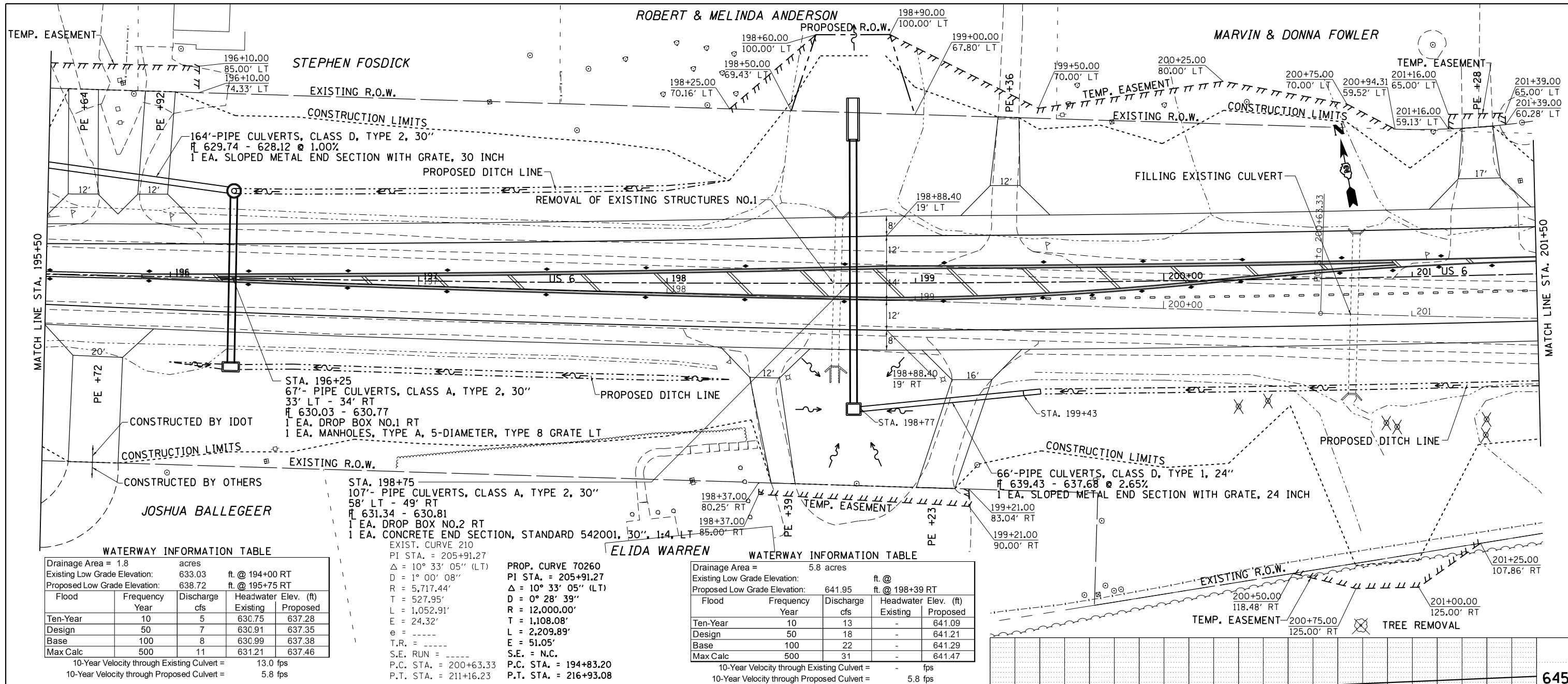

WATERWAY INFORMATION TABLE

Drainage Area = 1.8 acres
 Existing Low Grade Elevation: 633.03 ft. @ 194+00 RT
 Proposed Low Grade Elevation: 638.72 ft. @ 195+75 RT

Flood Year	Frequency	Discharge cfs	Headwater Elev. (ft)	
			Existing	Proposed
Ten-Year	10	5	630.75	637.28
Design	50	7	630.91	637.35
Base	100	8	630.99	637.38
Max Calc	500	11	631.21	637.46

10-Year Velocity through Existing Culvert = 13.0 fps
 10-Year Velocity through Proposed Culvert = 5.8 fps

WATERWAY INFORMATION TABLE

Drainage Area = 5.8 acres
 Existing Low Grade Elevation: 641.95 ft. @ 198+39 RT
 Proposed Low Grade Elevation: 641.95 ft. @ 198+39 RT

Flood Year	Frequency	Discharge cfs	Headwater Elev. (ft)	
			Existing	Proposed
Ten-Year	10	13	-	641.09
Design	50	18	-	641.21
Base	100	22	-	641.29
Max Calc	500	31	-	641.47

10-Year Velocity through Existing Culvert = - fps
 10-Year Velocity through Proposed Culvert = 5.8 fps

WATERWAY INFORMATION TABLE

Drainage Area = 5.8 acres
 Existing Low Grade Elevation: 641.95 ft. @ 198+39 RT
 Proposed Low Grade Elevation: 641.95 ft. @ 198+39 RT

Flood Year	Frequency	Discharge cfs	Headwater Elev. (ft)	
			Existing	Proposed
Ten-Year	10	13	-	641.09
Design	50	18	-	641.21
Base	100	22	-	641.29
Max Calc	500	31	-	641.47

10-Year Velocity through Existing Culvert = - fps
 10-Year Velocity through Proposed Culvert = 5.8 fps

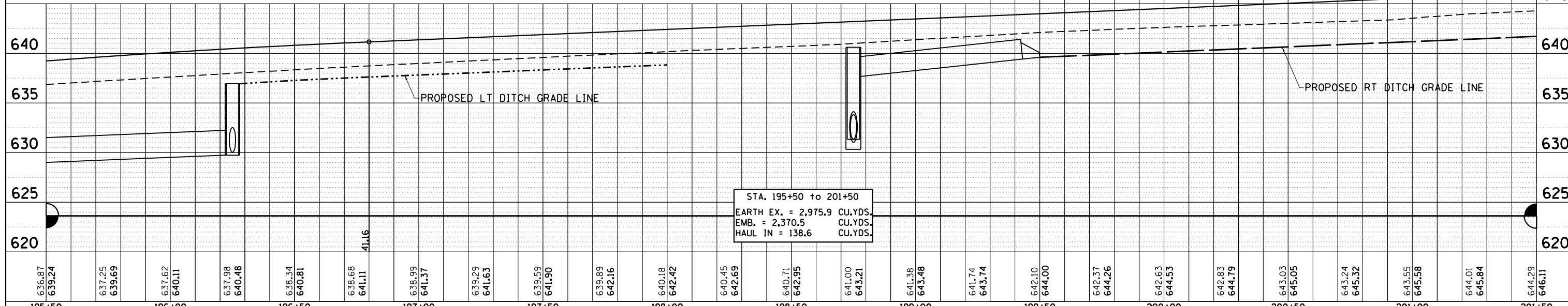

FILE NAME =	USER NAME = cushmanbw	DESIGNED -	REVISED -	STATE OF ILLINOIS DEPARTMENT OF TRANSPORTATION	US 6 PLAN & PROFILE	F.A.U. R.T.E.	SECTION	COUNTY	TOTAL SHEETS	SHEET NO.	
Default	PLOT SCALE = 40.0000' / in.	DRAWN -	REVISED -			*	2R-1	HENRY	235	35	
	PLOT DATE = Fri Aug 01 11:16:13 2014	CHECKED -	REVISED -			CONTRACT NO. 64J43					
		DATE -	REVISED -			ILLINOIS FED. AID PROJECT					