

PLAN	SURVEYED	BY	DATE
	PLOTTED		
	ALIGNED		
	CHECKED		
	FILED		
NOTE BOOK NO.	FILE NAME		

PROFILE	SURVEYED	BY	DATE
	PLOTTED		
	GRADES CHECKED		
	STRUCTURE NOTATIONS CHECKED		
NOTE BOOK NO.	NOTATION CHPKD		

EXIST. CURVE 70320  
 PI STA. = 1005+80.88  
 $\Delta = 14^\circ 16' 33''$  (RT)  
 $D = 11^\circ 27' 33''$   
 $R = 500.00'$   
 $T = 62.61'$   
 $L = 124.58'$   
 $E = 3.91'$   
 $e = \text{---}$   
 $T.R. = \text{---}$   
 $S.E. \text{ RUN} = \text{---}$   
 $P.C. \text{ STA.} = 1005+18.26$   
 $P.T. \text{ STA.} = 1006+42.85$

PROP. CURVE 72220  
 PI STA. = 1005+81.25  
 $\Delta = 14^\circ 21' 41''$  (RT)  
 $D = 11^\circ 27' 33''$   
 $R = 500.00'$   
 $T = 62.99'$   
 $L = 125.33'$   
 $E = 3.95'$   
 $S.E. = 4.0\%$   
 $T.R. = N/A$   
 $S.E. \text{ RUN} = N/A$   
 $P.C. \text{ STA.} = 1005+18.26$   
 $P.C.C. \text{ STA.} = 1006+43.59$

PROP. CURVE 72230  
 PI STA. = 1007+28.73  
 $\Delta = 57^\circ 33' 29''$  (RT)  
 $D = 36^\circ 57' 54''$   
 $R = 155.00'$   
 $T = 85.14'$   
 $L = 155.71'$   
 $E = 21.84'$   
 $S.E. = 4.0\%$   
 $T.R. = N/A$   
 $S.E. \text{ RUN} = N/A$   
 $P.C.C. \text{ STA.} = 1006+43.59$   
 $P.C.C. \text{ STA.} = 1007+99.30$

PROP. CURVE 72240  
 PI STA. = 1008+48.09  
 $\Delta = 11^\circ 08' 47''$  (RT)  
 $D = 11^\circ 27' 33''$   
 $R = 500.00'$   
 $T = 48.79'$   
 $L = 97.27'$   
 $E = 2.37'$   
 $S.E. = 4.0\% \& \text{ VAR.}$   
 $T.R. = N/A$   
 $S.E. \text{ RUN} = \text{SEE DIMENSION NOTES}$   
 $P.C.C. \text{ STA.} = 1007+99.30$   
 $P.T. \text{ STA.} = 1008+96.57$

EXIST. CURVE 70330  
 PI STA. = 1007+33.96  
 $\Delta = 60^\circ 53' 42''$  (RT)  
 $D = 36^\circ 57' 54''$   
 $R = 155.00'$   
 $T = 91.11'$   
 $L = 164.74'$   
 $E = 24.79'$   
 $e = \text{---}$   
 $T.R. = \text{---}$   
 $S.E. \text{ RUN} = \text{---}$   
 $P.C. \text{ STA.} = 1006+42.85$   
 $P.T. \text{ STA.} = 1008+07.58$

EXIST. CURVE 70340  
 PI STA. = 1008+68.22  
 $\Delta = 13^\circ 49' 43''$  (RT)  
 $D = 11^\circ 27' 33''$   
 $R = 500.00'$   
 $T = 60.63'$   
 $L = 120.68'$   
 $E = 3.66'$   
 $e = \text{---}$   
 $T.R. = \text{---}$   
 $S.E. \text{ RUN} = \text{---}$   
 $P.C. \text{ STA.} = 1008+07.58$   
 $P.T. \text{ STA.} = 1009+28.26$

⊗ TREE REMOVAL

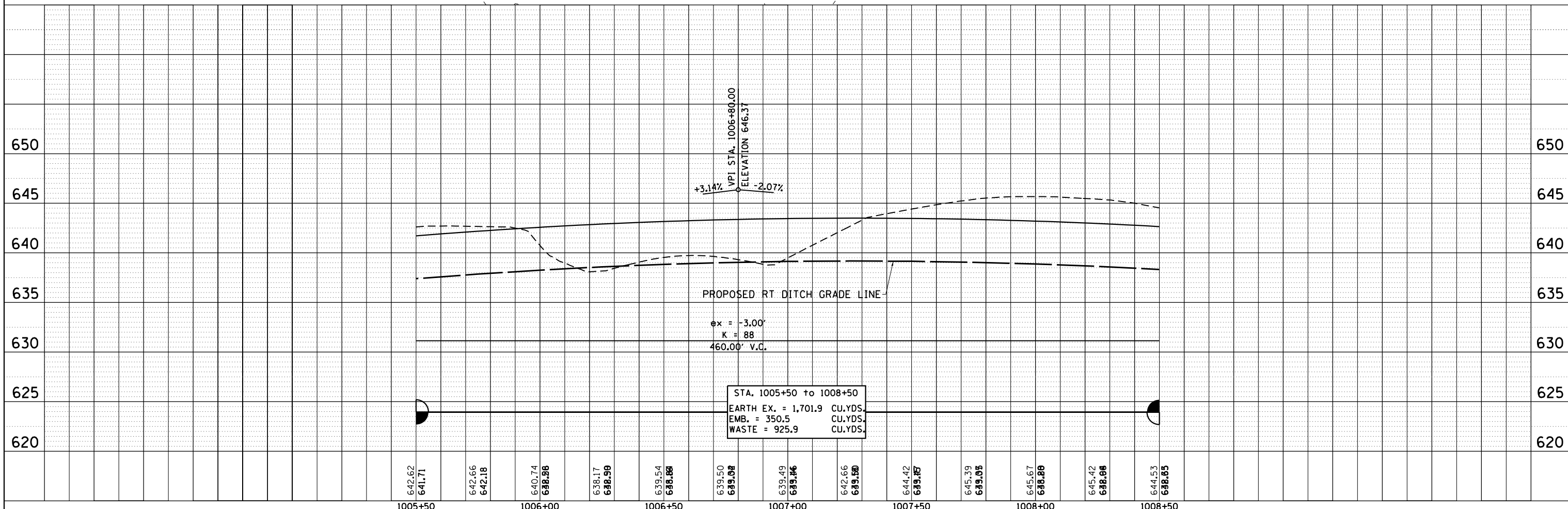

FILE NAME =	USER NAME = cushmanbw	DESIGNED -	REVISED -	<b>STATE OF ILLINOIS</b> <b>DEPARTMENT OF TRANSPORTATION</b>				<b>SLIP RAMP</b> <b>PLAN &amp; PROFILE</b>				F.A.U. RT.E.	SECTION	COUNTY	TOTAL SHEETS	SHEET NO.
c:\pwork\pwork\cushmanbw\d0333009\F201709-sht-pln1.dgn		DRAWN -	REVISED -									*	2R-1	HENRY	235	46
Default		CHECKED -	REVISED -									CONTRACT NO. 64J43				
		DATE -	REVISED -									ILLINOIS FED. AID PROJECT				