

TRAFFIC CONTROL PLAN FOR SN 081-0127

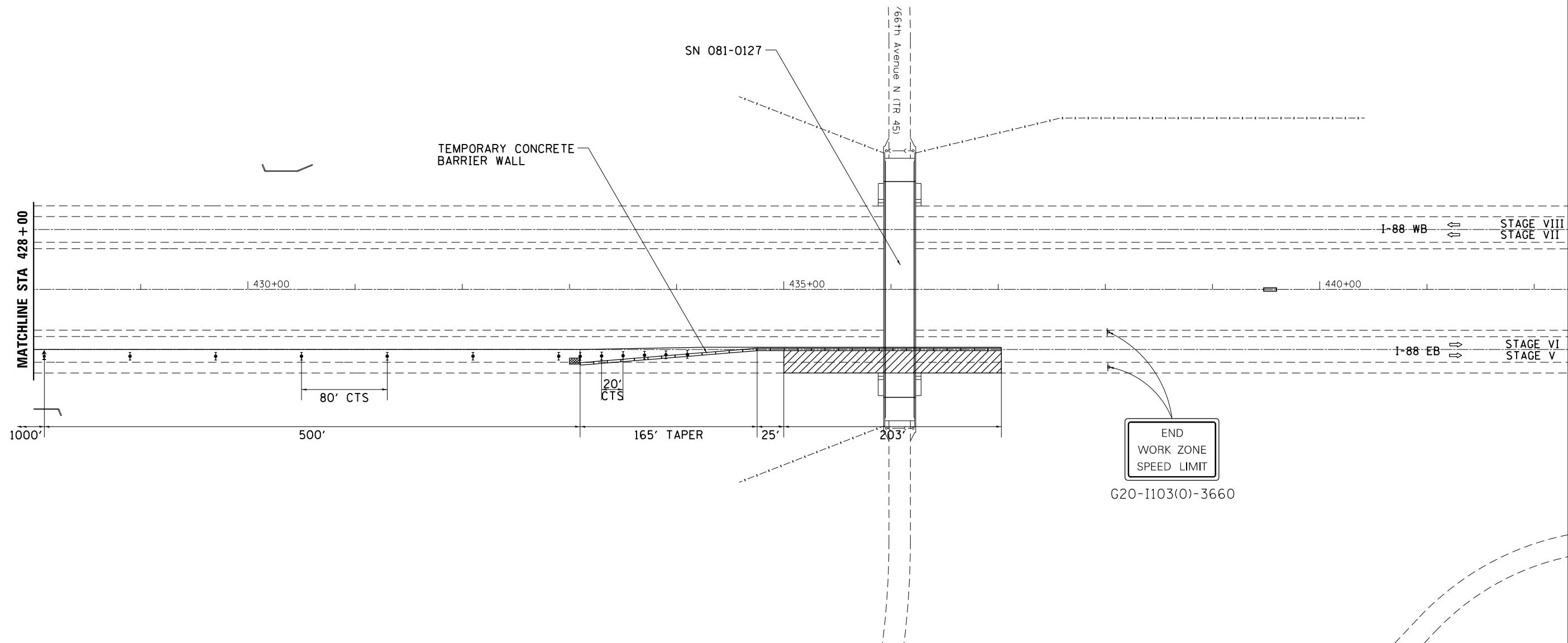

END
WORK ZONE
SPEED LIMIT
G20-I103(O)-3660

SYMBOLS

- ↑ Arrow board
- ▨ Work area
- ♣ Sign
- ↕ Direction indicator barricade with steady burn monodirectional light
- ⦿ Type II barricade or drum with steady burn monodirectional light
- Temporary concrete barrier
- ◁ Monodirectional barrier wall/guardrail marker
- ▣ Impact attenuator
- Drums with steady burning monodirectional light

NOTES

- ① Refer to State Standards 701400, 701401, 701402 and 704001.
- ② ReflectORIZED temporary pavement marking shall be placed throughout the taper and along-side the work area. The edge line shall be white for right lane closure and yellow for left lane closures.

FILE NAME =	USER NAME = dossed	DESIGNED - _____	REVISED - 8-18-2014 DD	STATE OF ILLINOIS DEPARTMENT OF TRANSPORTATION	TRAFFIC CONTROL PLAN FOR SN 081-0127 STAGES V, VI, VII, VIII	F.A.I. RTE.	SECTION	COUNTY	TOTAL SHEETS	SHEET NO.	
Default	Painting SN 081-0120 & 0127\CADD\02-sht-cover	DRAWN - _____	REVISED - _____			88	D2 BRIDGE PAINTING 2015-I	ROCK ISLAND	17	7	
	PLOT SCALE = 100.0000' / in.	CHECKED - _____	REVISED - _____			SCALE: _____ SHEET ____ OF ____ SHEETS STA. _____ TO STA. _____		CONTRACT NO. 64K16		ILLINOIS FED. AID PROJECT	
	PLOT DATE = Mon Aug 18 10:39:51 2014	DATE - _____	REVISED - _____								