

Benchmark: BM#6 - Chiseled "□" top S.E. corner of east abutment, Sta 968+35.34, 18.11' Rt. Elev. 665.21
 BM#5-R.O.W. Marker, south side of U.S. Rte. 6/34, House No. 5732, east edge of yard, Sta 965+00.00, 45.60' Rt. Elev. 663.24

Existing Structure:
 S.N. 006-0140 Built in 1981 and rehabilitated in 1994 as F.A.S. Rte 2246, Section 8D-BR and Section 8D-BR-M at Station 30+93.5 as a 3-span P.P.C. deck beam (21" depth) bridge 130'-1 1/2" Bk. To Bk. of abutments with 33'-0" clear width and 36'-0" o.-o. The substructure consists of open pile bent abutments and piers supported on concrete piles. Existing PPC deck beam superstructure to be removed and replaced with cast in place concrete deck on steel wide flange beam superstructure. Traffic to be maintained under stage construction, subject to currently posted load limits. Temporary Steel Bracing Contract 66A53 installed in 2011. Steel wide flange beams anchored to existing substructure units to support PPC Deck beams. Temporary steel bracing to be removed with existing superstructure.

No Salvage

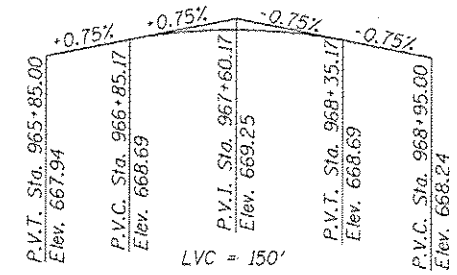
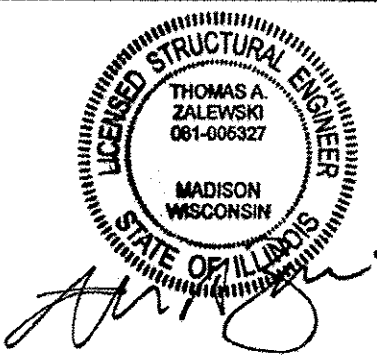

STATION 967+60.05
 RE-BUILT 2014 BY
 STATE OF ILLINOIS
 F.A.P. RTE. 613 SEC. (8D-BR) BR
 LOADING HL-93
 STRUCTURE NO. 006-0140

NAME PLATE
 See Std. 515001

Existing Name Plate shall be cleaned and relocated next to new Name Plate. Cost included with Name Plates.

APPROVED
 For Structural Adequacy Only
De Carl Krueger
 Engineer of Bridges & Structures

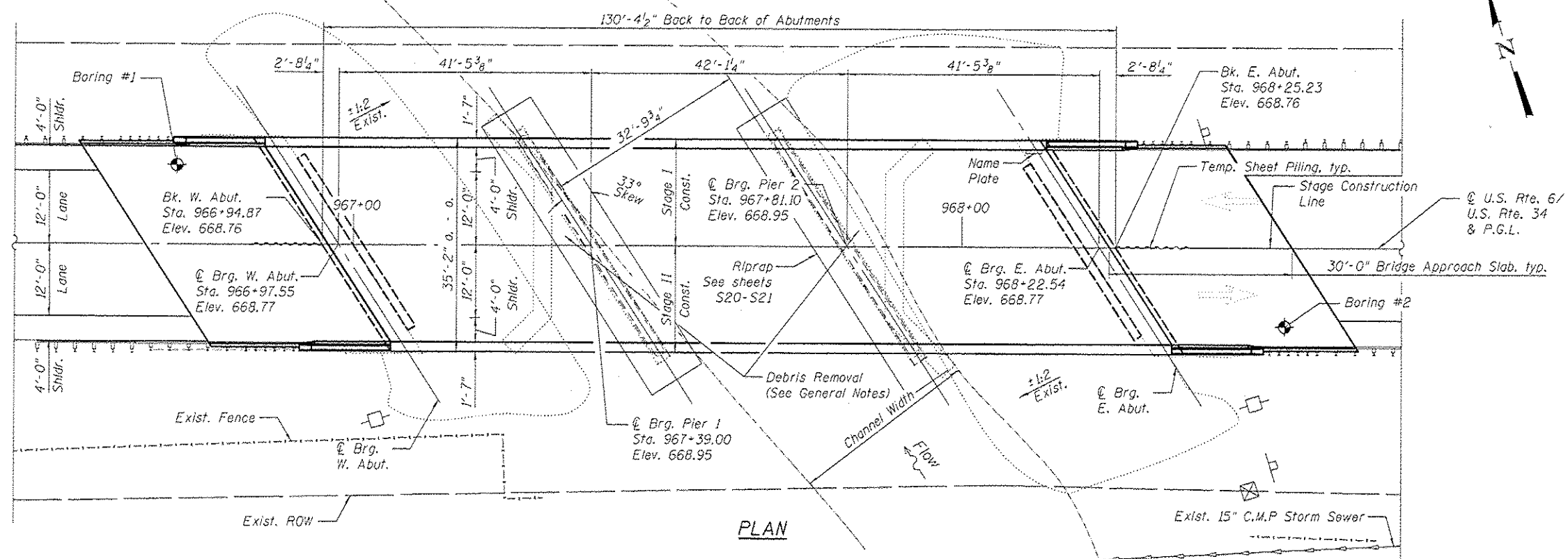
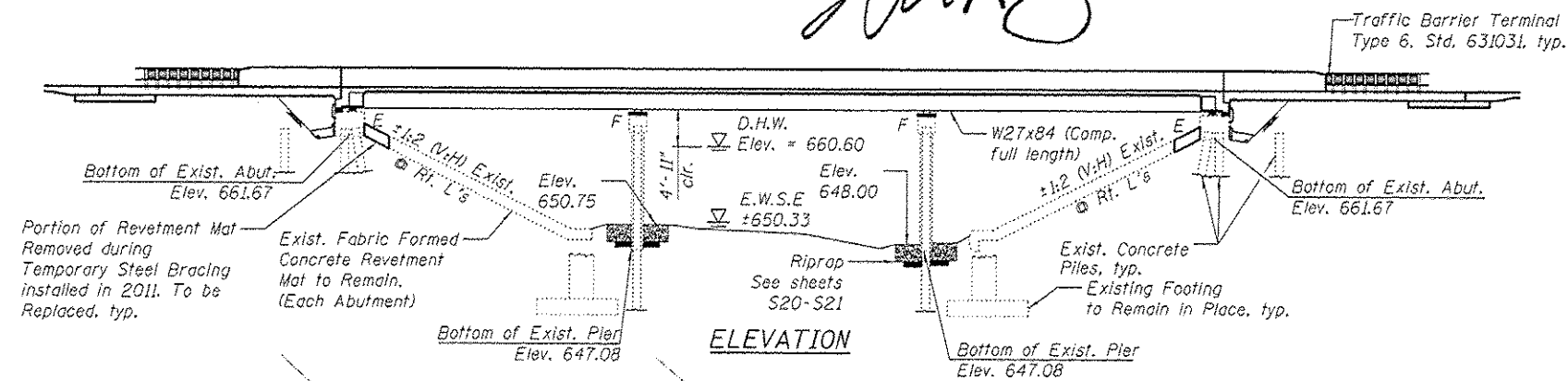

WATERWAY INFORMATION

Drainage Area = 24.5 sq. mi. Exist. Low Grade Elev. 667.20** @ Sta. 968+63
 Prop. Low Grade Elev. 667.24** @ Sta. 965+00

Flood	Freq. Yr.	Q	Opening Sq. Ft.		H.W.E.		Headwater El.		
			Exist.	Prop.	Exist.	Prop.	Exist.	Prop.	
Design	50	4,520	679	679	660.6	0.5	0.5	661.1	661.1
Base	100	5,250	758	758	661.5	0.5	0.5	662.0	662.0
Max. Calc.	500	7,000	967	967	663.7	0.4	0.4	664.1	664.1

10 year velocity through existing bridge = 7.1 fps
 10 year velocity through proposed bridge = 7.1 fps
 ** At Edge of Pavement at Local Sag

DESIGN SCOUR ELEVATION TABLE

Design Scour Elevation (ft.)	W. Abut.	Pier 1	Pier 2	E. Abut.
	661.67*	646.45	646.45	661.67*

* Bottom of Existing Abutments

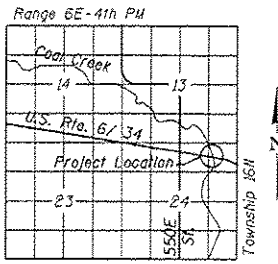

GENERAL PLAN AND ELEVATION
 U.S. ROUTE 6/ U.S. ROUTE 34 OVER
 COAL CREEK
 F.A.P. RTE. 613 SEC. (8D-BR) BR
 BUREAU COUNTY
 STATION 967+60.05
 STRUCTURE NO. 006-0140

	USER NAME = bmettas	DESIGNED - BCM	REVISED	STATE OF ILLINOIS DEPARTMENT OF TRANSPORTATION	GENERAL PLAN & ELEVATION STRUCTURE NO. 006-0140	F.A.P. RTE. 613	SECTION (8D-BR) BR	COUNTY BUREAU	TOTAL SHEETS 63	SHEET NO. 23
	PLOT SCALE = N/A	DRAWN - BCM	REVISED			SHEET NO. 51 OF 526 SHEETS	CONTRACT NO. 66A17		ILLINOIS FED. AID PROJECT	
	PLOT DATE = 9/11/2014	CHECKED - 7/24/2012	REVISED							