

DATE	
BY	
PROJECT NO.	
DATE OF DESIGN	
DATE OF AS-BUILT	
DATE OF REVISION	
NO.	

DATE	
BY	
PROJECT NO.	
DATE OF DESIGN	
DATE OF AS-BUILT	
DATE OF REVISION	
NO.	

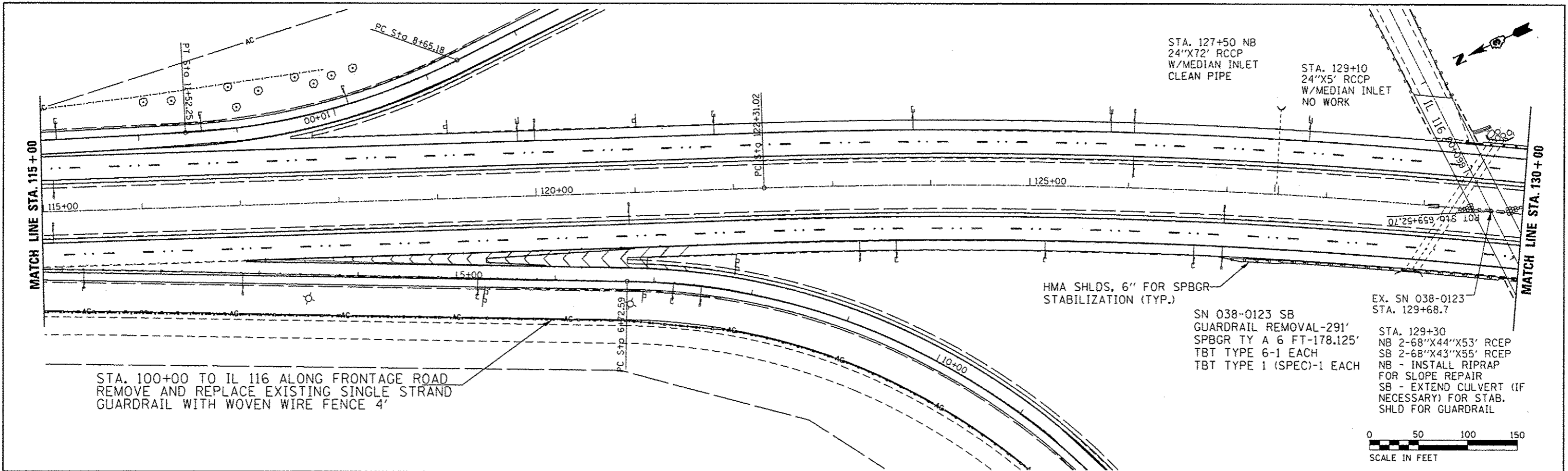

STA. 127+50 NB
24"x72" RCCP
W/MEDIAN INLET
CLEAN PIPE

STA. 129+10
24"x5' RCCP
W/MEDIAN INLET
NO WORK

HMA SHLDS, 6" FOR SPBGR
STABILIZATION (TYP.)

SN 038-0123 SB
GUARDRAIL REMOVAL-291'
SPBGR TY A 6 FT-178.125'
TBT TYPE 6-1 EACH
TBT TYPE 1 (SPEC)-1 EACH

EX. SN 038-0123
STA. 129+68.7
STA. 129+30
NB 2-68"x44"x53' RCEP
SB 2-68"x43"x55' RCEP
NB - INSTALL RIPRAP
FOR SLOPE REPAIR
SB - EXTEND CULVERT (IF
NECESSARY) FOR STAB.
SHLD FOR GUARDRAIL

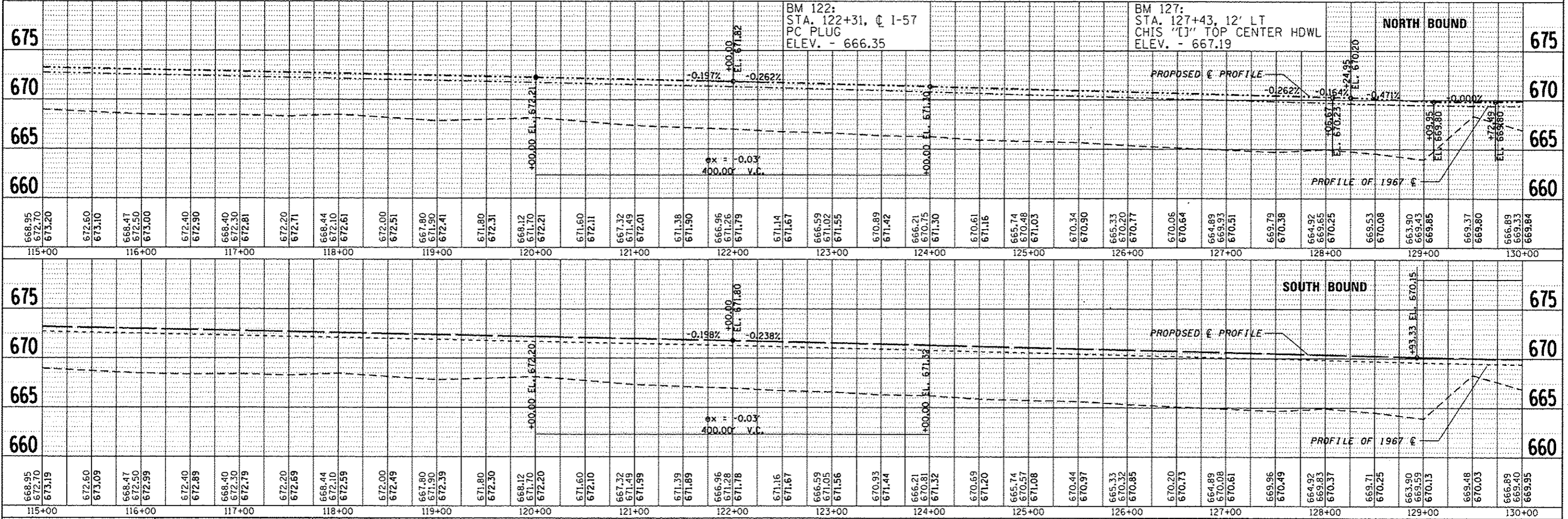

FILE NAME :	USER NAME : dunoanbd	DESIGNED -	REVISED -	F.A.I. RTE.	SECTION	COUNTY	TOTAL SHEETS	SHEET NO.
c:\p\work\p10\dot\dunoanbd\0315942\0366023-plansheets.dgn		CHECKED -	REVISED -	57	(38-3RS-2)	ILLINOIS	186	25
PLOT SCALE = 1/8"=1'-0"		DRAWN -	REVISED -	CONTRACT NO. 66C53		FED. ROAD DIST. NO. ILLINOIS FED. AID PROJECT		
PLOT DATE = 6/10/2014		CHECKED -	REVISED -	SCALE: 1"=50'		SHEET NO. 3 OF 31 SHEETS		STA. 115+00 TO STA. 130+00

STATE OF ILLINOIS
DEPARTMENT OF TRANSPORTATION

PLAN AND PROFILE