

F.A.I. SITE	SECTION	COUNTY	TOTAL SHEETS	SHEET NO.
80	32,47-4)RA-2	GRUNDY	19	11
FED. ROAD DIST. NO.		ILLINOIS	STATE AID PROJECT	

NOTE:
CONNECT PROPOSED D.I. W.M. 8"
TO EXISTING 8" WATERMAIN WITH
D.I. W.M. FITTING 45° ELBOW

FOR INFORMATION ONLY

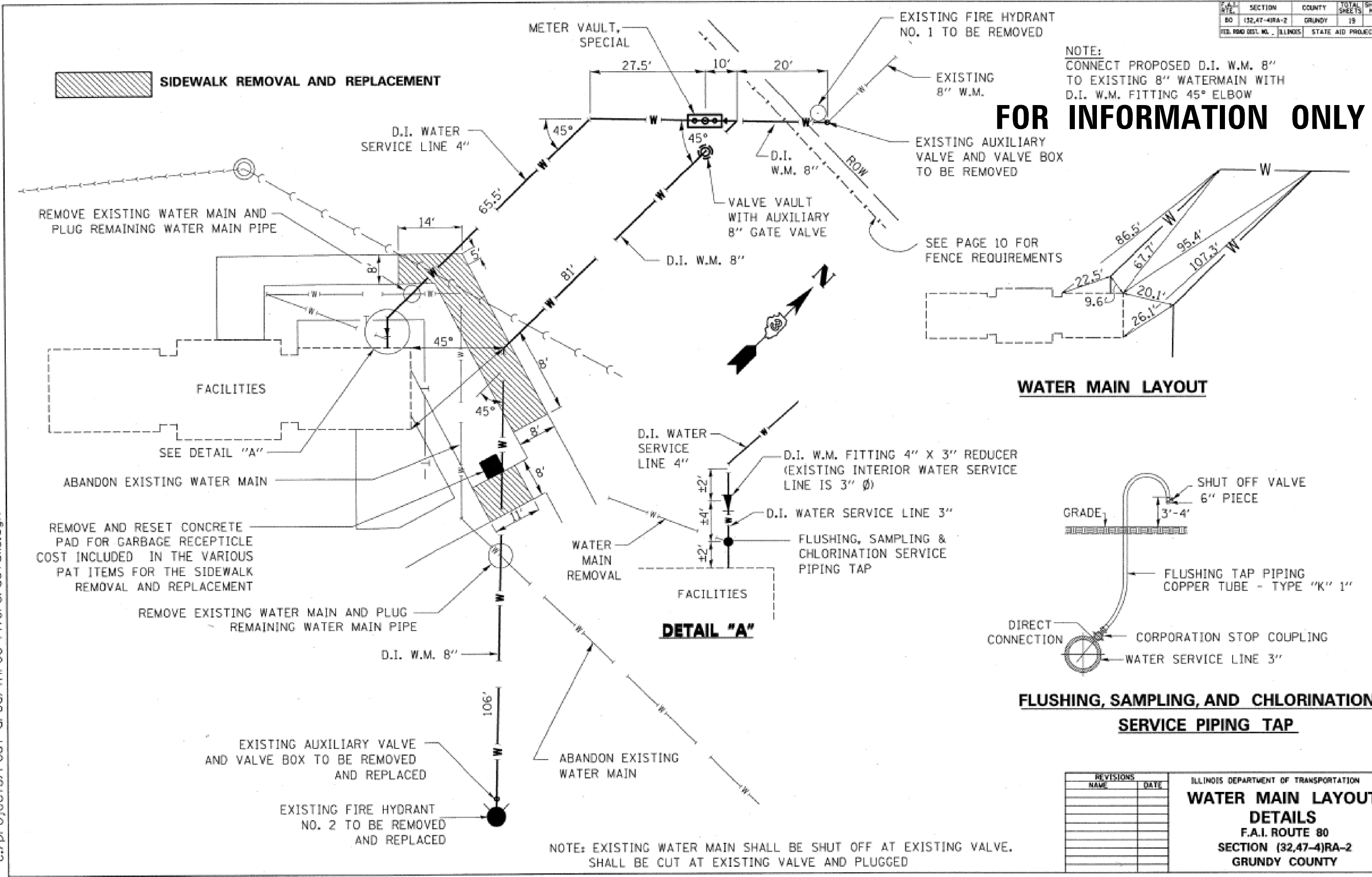

WATER MAIN LAYOUT

DETAIL "A"

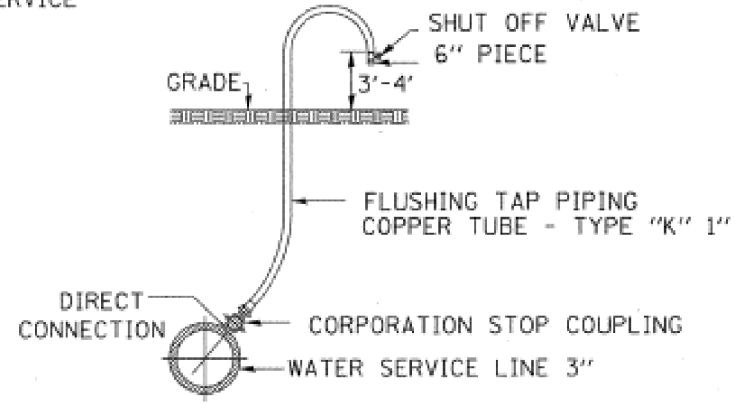

FLUSHING, SAMPLING, AND CHLORINATION SERVICE PIPING TAP

REVISIONS		ILLINOIS DEPARTMENT OF TRANSPORTATION WATER MAIN LAYOUT DETAILS F.A.I. ROUTE 80 SECTION (32,47-4)RA-2 GRUNDY COUNTY
NAME	DATE	

NOTE: EXISTING WATER MAIN SHALL BE SHUT OFF AT EXISTING VALVE.
SHALL BE CUT AT EXISTING VALVE AND PLUGGED

GRUNDY COUNTY SECTION (32,47-4)RA-2 FAI 80 (1-80)

DATE: 10/12/2006
C:/projects/rest area/three rivers/details.dgn