

FOR INFORMATION ONLY

F.A.I. NO.	SECTION	COUNTY	TOTAL SHEETS	SHEET NO.
55	*	LIVINGSTON	22	4
STA.	TO STA.			
F.I.L. NO. (SCALE)	NUMBER	FIELD PROJECT		

* 53-6 & 53-5 RA-L

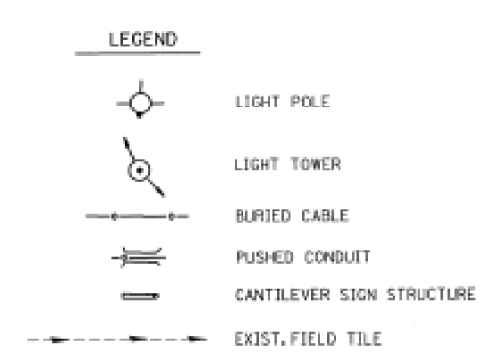
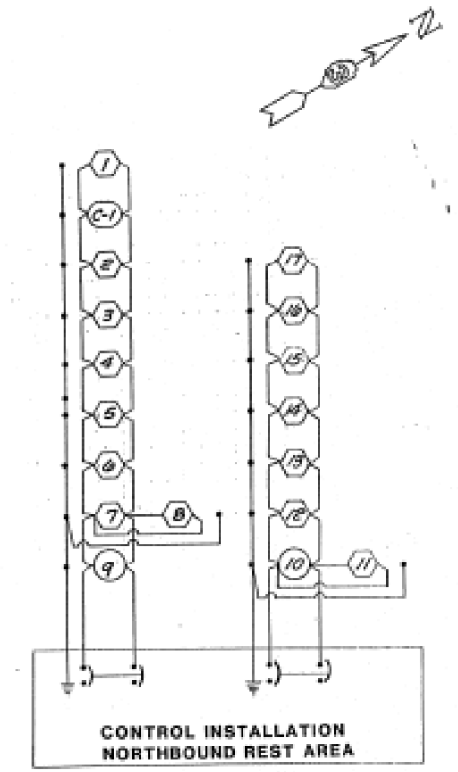
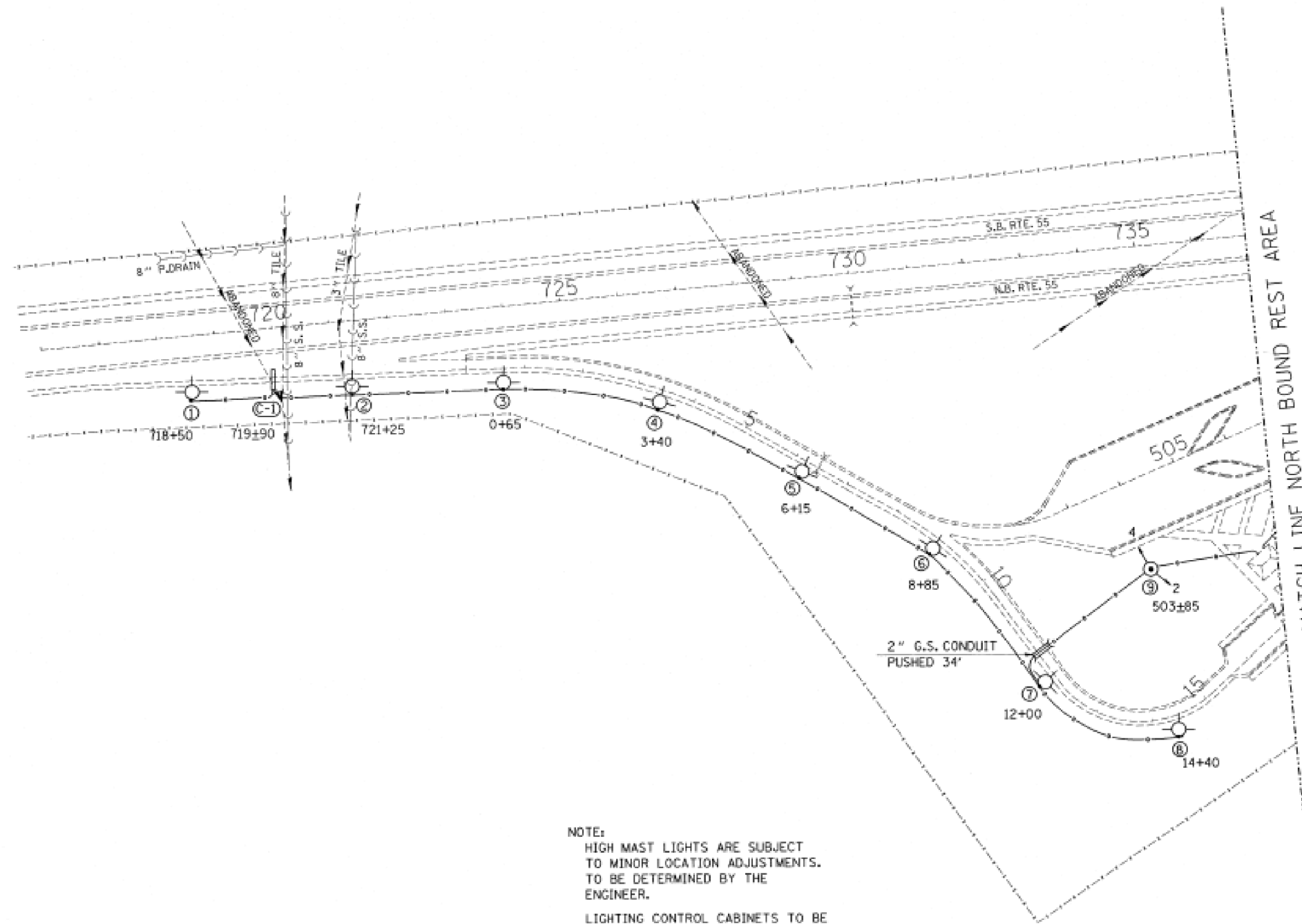

NOTE:
 HIGH MAST LIGHTS ARE SUBJECT TO MINOR LOCATION ADJUSTMENTS. TO BE DETERMINED BY THE ENGINEER.
 LIGHTING CONTROL CABINETS TO BE LOCATED INSIDE MAIN REST AREA BUILDING.

REVISIONS		
NAME	DATE	
LMT	1-3-89	

ILLINOIS DEPARTMENT OF TRANSPORTATION
 DRAWN BY C.A.P.D.
NORTH BOUND REST AREA LIGHTING LOCATIONS
 DRAWN BY L.M.T.
 DATE 12-30-88
 CHECKED BY

FILE NAME =	USER NAME = Schwankerg	DESIGNED -	REVISED -
c:\pwork\pwork\schwankerg\d0410675\066E29-shr-details.dgn		DRAWN -	REVISED -
\$MODELNAME\$	PLOT SCALE = 116.6000' / in.	CHECKED -	REVISED -
	PLOT DATE = 8/22/2014	DATE -	REVISED -

**STATE OF ILLINOIS
 DEPARTMENT OF TRANSPORTATION**

LIMESTONE NORTHBOUND REST AREA	
SCALE:	SHEET OF SHEETS STA. TO STA.

F.A.I. RTE.	SECTION	COUNTY	TOTAL SHEETS	SHEET NO.
80&55	*	GRUNDY/LIV.	20	17
CONTRACT NO. 66E29			ILLINOIS FED. AID PROJECT	

*2015-1 TREE REMOVAL FOR EAB CONTROL