

INSIDE ELEVATION OF EAST PARAPET - UNIT 1
(Looking East)

*See Section thru parapet on Sheet No. 17 of 62

MINIMUM BAR LAP
(Parapet)
#4 bar = 2'-0"
#8 bar = 5'-2"

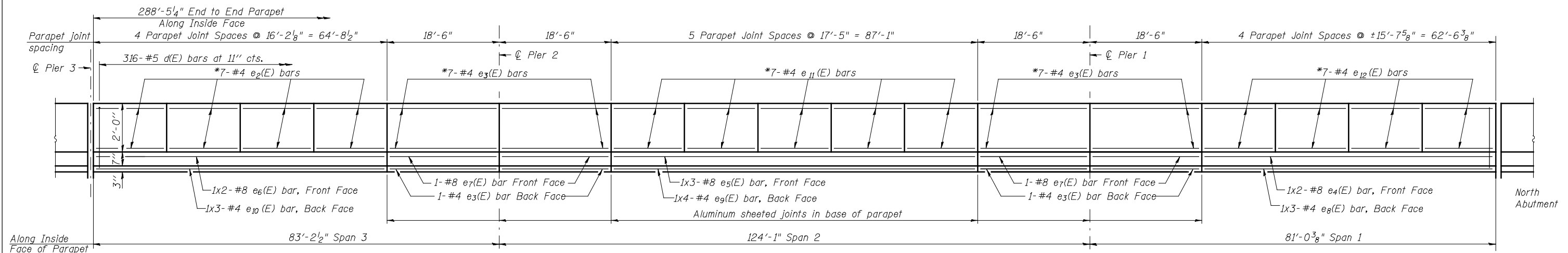

INSIDE ELEVATION OF WEST PARAPET - UNIT 1
(Looking West)

*See Section thru parapet on Sheet No. 17 of 62

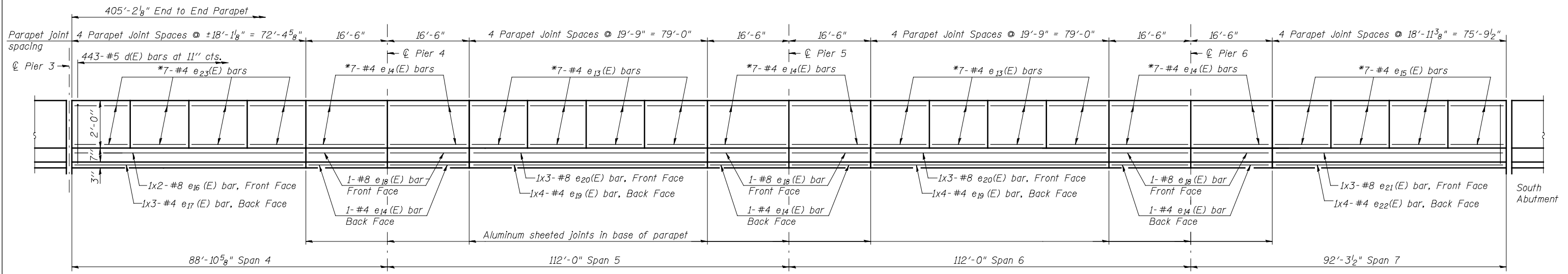

INSIDE ELEVATION OF PARAPET - UNIT 2
(East Parapet shown, West Parapet, opposite hand)

*See Section thru parapet on Sheet No. 17 of 62