

LEG "C" ALIGNMENT



EXIST. CURVE 2
 PI STA. = 16+44.97
 $\Delta = 18^\circ 07' 37''$ (RT)
 $D = 8^\circ 06' 49''$
 $R = 706.17'$
 $T = 112.65'$
 $L = 223.41'$
 $E = 8.93'$
 $e = \text{-----}$
 $T.R. = \text{-----}$
 $S.E. RUN = \text{-----}$
 $P.C. STA. = 15+32.33$
 $P.T. STA. = 17+55.74$

EXIST. CURVE 206
 PI STA. = 17+71.79
 $\Delta = 18^\circ 01' 40''$ (RT)
 $D = 8^\circ 18' 31''$
 $R = 689.58'$
 $T = 109.39'$
 $L = 216.97'$
 $E = 8.62'$
 $e = \text{-----}$
 $T.R. = \text{-----}$
 $S.E. RUN = \text{-----}$
 $P.C. STA. = 16+62.40$
 $P.T. STA. = 18+79.37$

EXIST. CURVE 6
 PI STA. = 38+00.01
 $\Delta = 0^\circ 39' 42''$ (LT)
 $D = 0^\circ 03' 58''$
 $R = 86,574.40'$
 $T = 500.00'$
 $L = 999.99'$
 $E = 1.44'$
 $e = \text{-----}$
 $T.R. = \text{-----}$
 $S.E. RUN = \text{-----}$
 $P.C. STA. = 33+00.01$
 $P.T. STA. = 43+00.00$

EXIST. CURVE 96
 PI STA. = 17+43.50
 $\Delta = 12^\circ 36' 04''$ (RT)
 $D = 8^\circ 11' 07''$
 $R = 699.99'$
 $T = 77.29'$
 $L = 153.95'$
 $E = 4.25'$
 $e = \text{-----}$
 $T.R. = \text{-----}$
 $S.E. RUN = \text{-----}$
 $P.C. STA. = 16+66.22$
 $P.T. STA. = 18+20.17$

EXIST. CURVE 1
 PI STA. = 18+36.59
 $\Delta = 12^\circ 46' 31''$ (RT)
 $D = 8^\circ 16' 47''$
 $R = 692.01'$
 $T = 77.47'$
 $L = 154.30'$
 $E = 4.32'$
 $e = \text{-----}$
 $T.R. = \text{-----}$
 $S.E. RUN = \text{-----}$
 $P.C. STA. = 17+59.12$
 $P.T. STA. = 19+13.42$

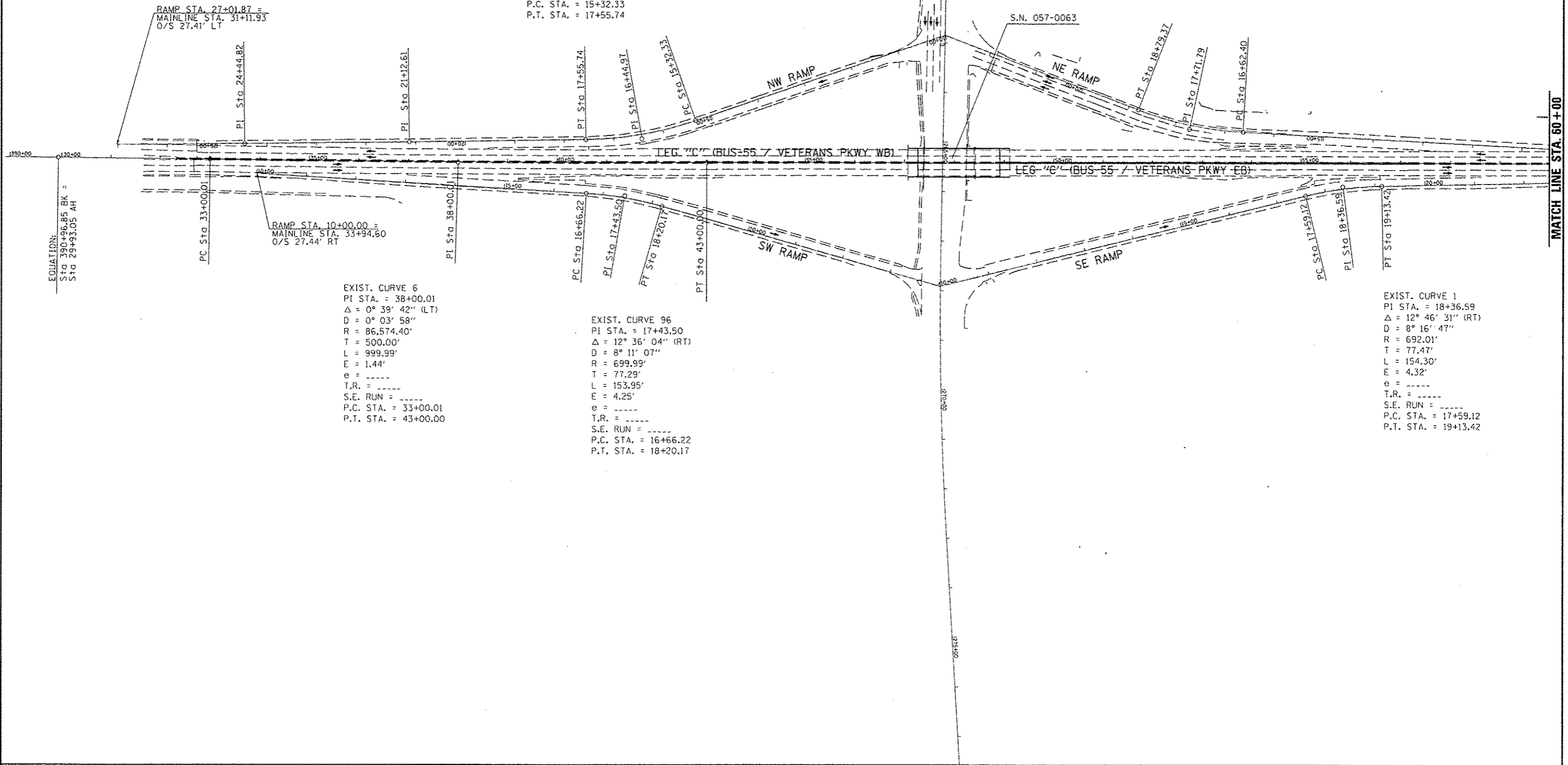

FILE NAME =	USER NAME = dodgema	DESIGNED -	REVISED -	STATE OF ILLINOIS DEPARTMENT OF TRANSPORTATION	BUS 55 PLAN SHEET - ALIGNMENT	F.A.P. RTE.	SECTION	COUNTY	TOTAL SHEETS	SHEET NO.
cr:\pwork\pwork\dodgema\20767571\057838-shc-ATB.dgn	PLDT SCALE = 200,0000 ' / in.	CHECKED -	REVISED -			704	(57-7)RS-1&RS-3	McLean	273	46
	PLDT DATE = 6/11/2014	DATE -	REVISED -			SCALE: 1" = 200' SHEET 3 OF 5 SHEETS STA. 390+00.00 TO STA. 60+00.00		CONTRACT NO. 70838		
ILLINOIS FED. AID PROJECT										