

CLASS SI CONCRETE (OUTLET) DETAIL

GENERAL NOTES

1. CLASS SI CONCRETE SHALL BE USED THROUGHOUT.
2. WELDED WIRE FABRIC WEIGHING NOT LESS THAN 58 LBS./ 100 SQ. FT. SHALL BE USED THROUGHOUT.
3. TIE BARS SHALL BE PLACED AND TIED TO THE SHOULDER IN ACCORDANCE WITH DETAILS FOR LONGITUDINAL CONSTRUCTION JOINT SHOWN ON STD. 420001.
4. NO TIE BARS ARE REQUIRED WHEN NEXT TO FULL-DEPTH FLEXIBLE SHOULDER.
5. TIE BARS WILL NOT BE PAID FOR SEPARATELY BUT SHALL BE CONSIDERED TO BE INCLUDED IN THE COST OF THE PAY ITEM "CLASS SI CONCRETE (OUTLET)".
6. THIS WORK WILL BE PAID FOR AT THE CONTRACT UNIT PRICE PER CUBIC YARD FOR CLASS SI CONCRETE (OUTLET).

DETAIL LOCATIONS:

LEG "C" EB STA 62+85.60
 LEG "C" EB STA 89+35.79
 LEG "C" WB STA 89+37.79

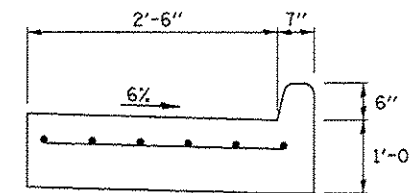
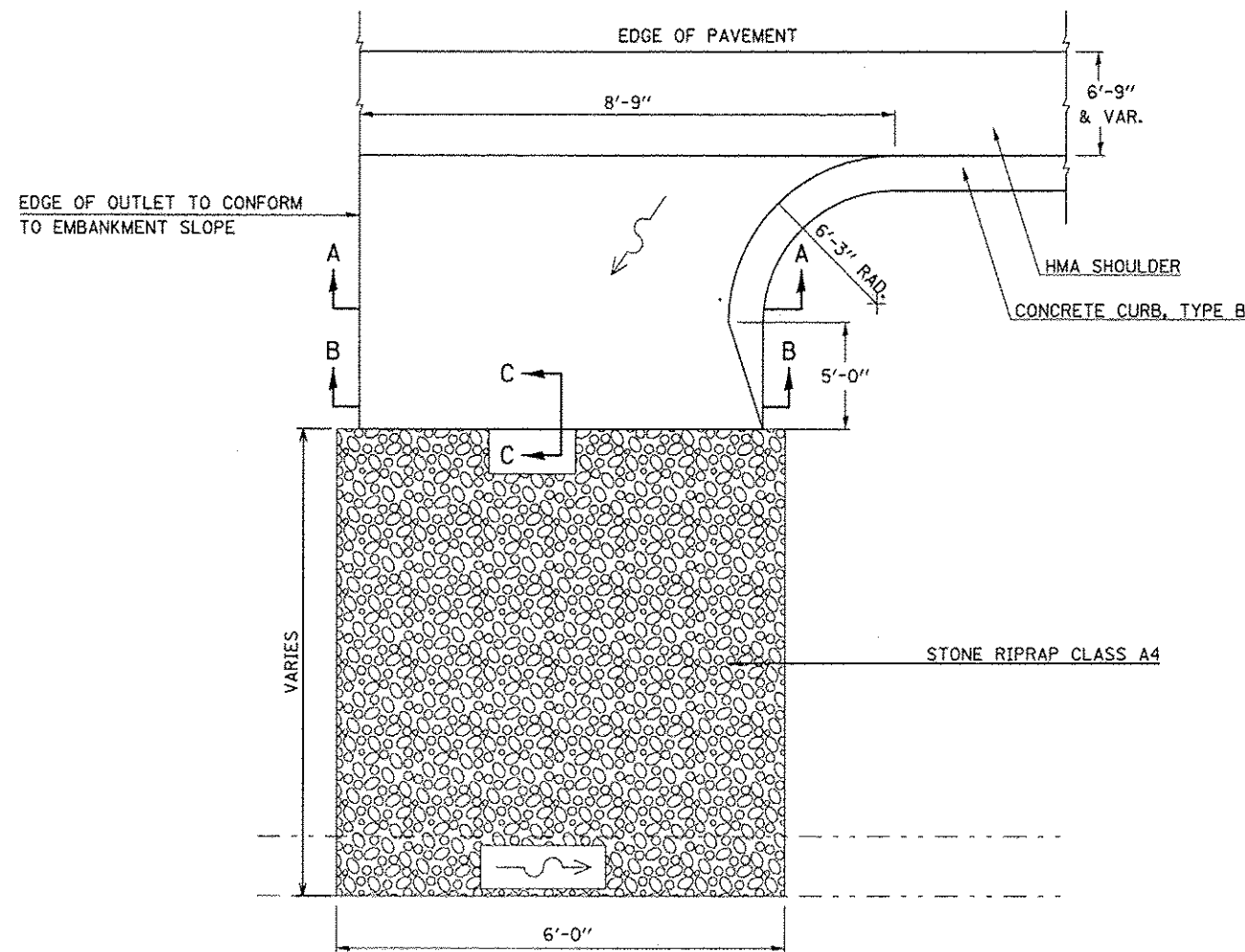

SECTION A-A

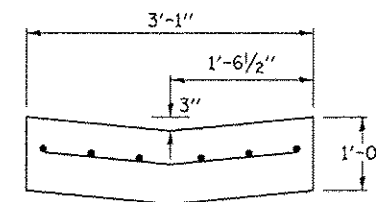

SECTION B-B

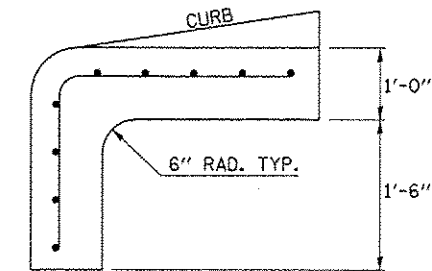

SECTION C-C

FILE NAME	USER NAME = dodgema	DESIGNED - BJM	REVISED -	STATE OF ILLINOIS DEPARTMENT OF TRANSPORTATION	CLASS SI CONCRETE (OUTLET) DETAIL	F.A.P. RTE.	SECTION	COUNTY	TOTAL SHEETS	SHEET NO.	
c:\pwork\pwork\dodgema\0267571\0570338-shr-details.dgn	DRAWN - BJH	REVIS	REVIS			704	(57-7)RS-1 & IRS-3	McLean	273	142	
MODELNAME*	PLT SCALE = 48,0000 1/16"	CHECKED - BJH	REVIS			CONTRACT NO. 70838					
	PLT DATE = 5/11/2014	DATE - 11/5/2012	REVIS			ILLINOIS FED. AID PROJECT					
SCALE:		SHEET 1 OF 1 SHEETS		STA.	TO STA.						