

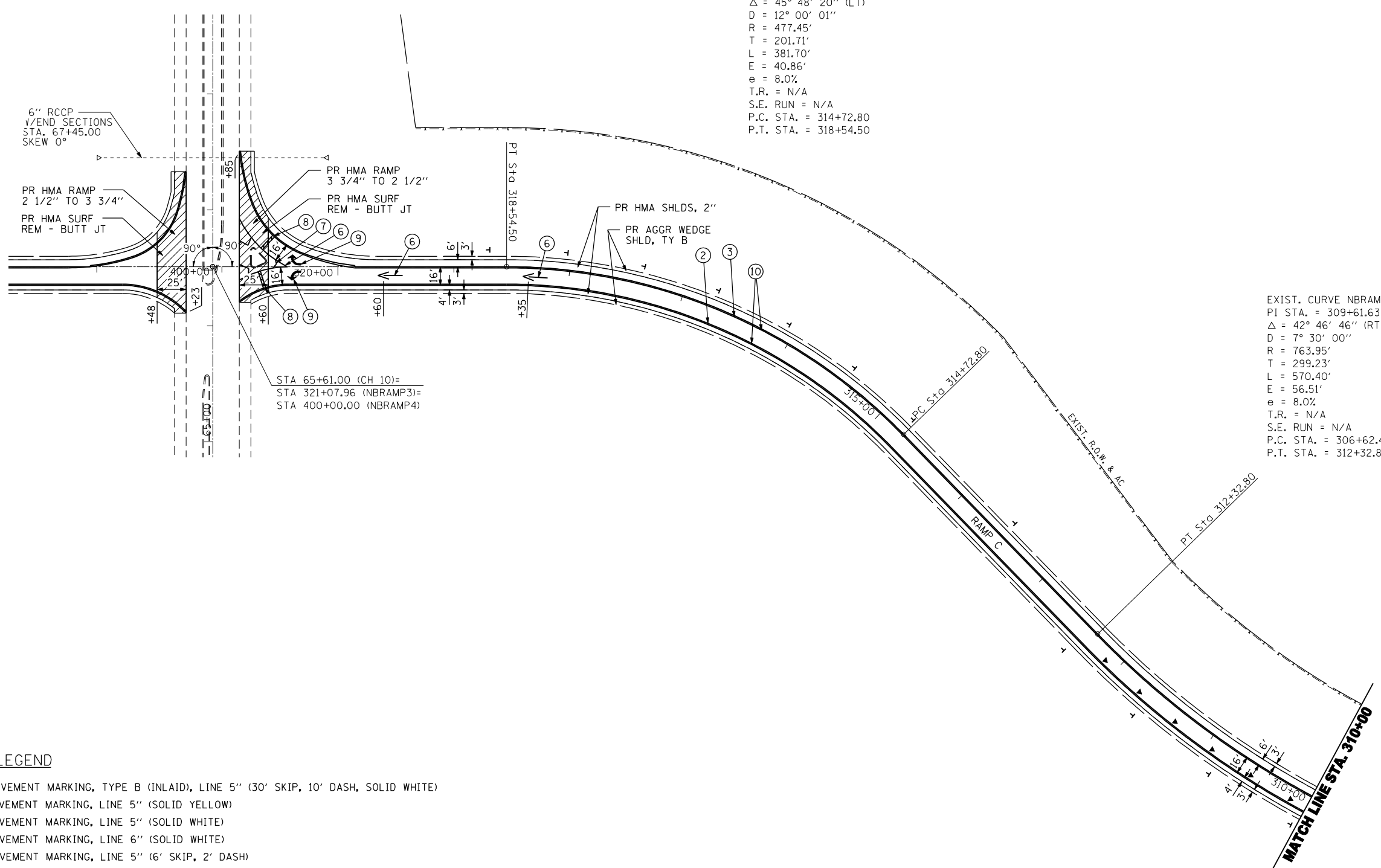

EXIST. CURVE NBRAMPC2
 PI STA. = 316+74.51
 $\Delta = 45^\circ 48' 20''$ (LT)
 D = 12° 00' 01"
 R = 477.45'
 T = 201.71'
 L = 381.70'
 E = 40.86'
 e = 8.0%
 T.R. = N/A
 S.E. RUN = N/A
 P.C. STA. = 314+72.80
 P.T. STA. = 318+54.50

EXIST. CURVE NBRAMPC1
 PI STA. = 309+61.63
 $\Delta = 42^\circ 46' 46''$ (RT)
 D = 7° 30' 00"
 R = 763.95'
 T = 299.23'
 L = 570.40'
 E = 56.51'
 e = 8.0%
 T.R. = N/A
 S.E. RUN = N/A
 P.C. STA. = 306+62.40
 P.T. STA. = 312+32.80



PAVEMENT MARKING LEGEND

- ① PR PREFORMED PLASTIC PAVEMENT MARKING, TYPE B (INLAID), LINE 5" (30' SKIP, 10' DASH, SOLID WHITE)
- ② PR MODIFIED URETHANE PAVEMENT MARKING, LINE 5" (SOLID YELLOW)
- ③ PR MODIFIED URETHANE PAVEMENT MARKING, LINE 5" (SOLID WHITE)
- ④ PR MODIFIED URETHANE PAVEMENT MARKING, LINE 6" (SOLID WHITE)
- ⑤ PR MODIFIED URETHANE PAVEMENT MARKING, LINE 5" (6' SKIP, 2' DASH)
- ⑥ PR MODIFIED URETHANE PAVEMENT MARKING, LINE 8" (SOLID WHITE)
- ⑦ PR MODIFIED URETHANE PAVEMENT MARKING, LINE 12" (SOLID WHITE)
- ⑧ PR PREFORMED PLASTIC PAVEMENT MARKING, TYPE B (INLAID), LINE 24" (SOLID WHITE)
- ⑨ PR PREFORMED PLASTIC PAVEMENT MARKING, TYPE B (INLAID), LETTERS & SYMBOLS (SOLID WHITE)
- ⑩ PR GROOVING FOR RECESSED PAVEMENT MARKING 6"
- ◁ PR RAISED REFLECTIVE PAVEMENT MARKER, WHITE (SEE STANDARD 781001-03)
- ◄ PR RAISED REFLECTIVE PAVEMENT MARKER, AMBER (SEE STANDARD 781001-03)
- || PR DELINEATOR, TWO REFLECTORS (SEE STANDARD 635001-01)
- | PR DELINEATOR, SINGLE REFLECTOR (SEE STANDARD 635001-01)

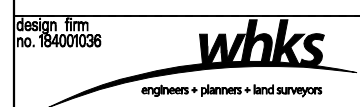
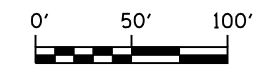

USER NAME = gjameson	DESIGNED -	REVISED
FILE NAME = D672854.pln sht 07.dgn	CHECKED -	REVISED
PLOT SCALE = 100.0000' / IN.	DRAWN -	REVISED
PLOT DATE = 8/25/2014	CHECKED -	REVISED

**STATE OF ILLINOIS
 DEPARTMENT OF TRANSPORTATION**

PLAN SHEET

SCALE: 1" = 50' SHEET NO. 7 OF 62 SHEETS STA. 310+00.00 TO STA. 320+84.96

F.A.I. RTE.	SECTION	COUNTY	TOTAL SHEETS	SHEET NO.
72		SANGAMON	163	37
•(84-9-2&3)RS-2&MISC STRUC REP			CONTRACT NO. 72B54	
ILLINOIS FED. AID PROJECT				