

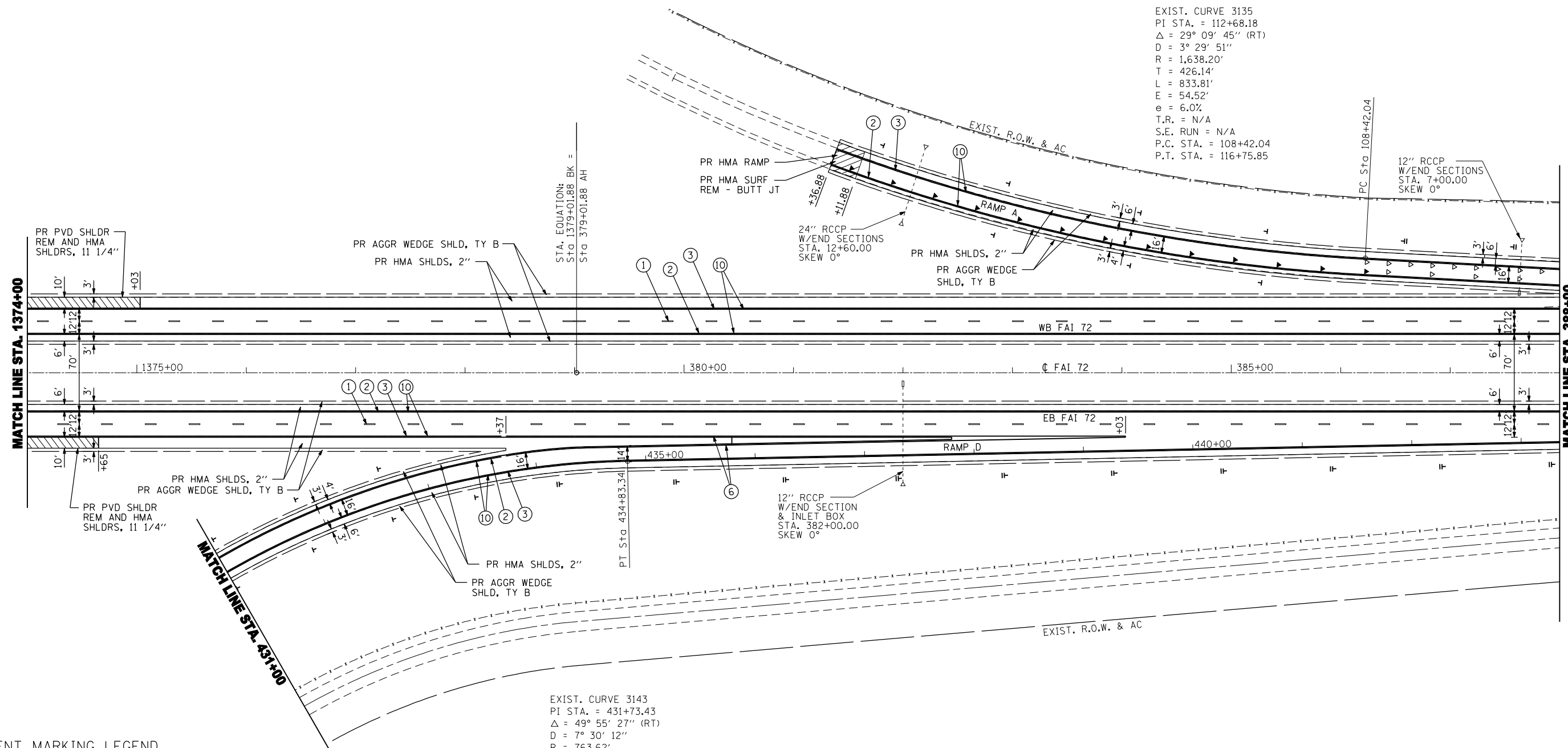

EXIST. CURVE 3135
 PI STA. = 112+68.18
 Δ = 29° 09' 45" (RT)
 D = 3° 29' 51"
 R = 1,638.20'
 T = 426.14'
 L = 833.81'
 E = 54.52'
 e = 6.0%
 T.R. = N/A
 S.E. RUN = N/A
 P.C. STA. = 108+42.04
 P.T. STA. = 116+75.85



EXIST. CURVE 3143
 PI STA. = 431+73.43
 Δ = 49° 55' 27" (RT)
 D = 7° 30' 12"
 R = 763.62'
 T = 355.46'
 L = 665.37'
 E = 78.68'
 e = 8.0%
 T.R. = N/A
 S.E. RUN = N/A
 P.C. STA. = 428+17.97
 P.T. STA. = 434+83.34

PAVEMENT MARKING LEGEND

- ① PR PREFORMED PLASTIC PAVEMENT MARKING, TYPE B (INLAID), LINE 5" (30' SKIP, 10' DASH, SOLID WHITE)
- ② PR MODIFIED URETHANE PAVEMENT MARKING, LINE 5" (SOLID YELLOW)
- ③ PR MODIFIED URETHANE PAVEMENT MARKING, LINE 5" (SOLID WHITE)
- ④ PR MODIFIED URETHANE PAVEMENT MARKING, LINE 6" (SOLID WHITE)
- ⑤ PR MODIFIED URETHANE PAVEMENT MARKING, LINE 5" (6' SKIP, 2' DASH)
- ⑥ PR MODIFIED URETHANE PAVEMENT MARKING, LINE 8" (SOLID WHITE)
- ⑦ PR MODIFIED URETHANE PAVEMENT MARKING, LINE 12" (SOLID WHITE)
- ⑧ PR PREFORMED PLASTIC PAVEMENT MARKING, TYPE B (INLAID), LINE 24" (SOLID WHITE)
- ⑨ PR PREFORMED PLASTIC PAVEMENT MARKING, TYPE B (INLAID), LETTERS & SYMBOLS (SOLID WHITE)
- ⑩ PR GROOVING FOR RECESSED PAVEMENT MARKING 6"
- ◁ PR RAISED REFLECTIVE PAVEMENT MARKER, WHITE (SEE STANDARD 781001-03)
- ▲ PR RAISED REFLECTIVE PAVEMENT MARKER, AMBER (SEE STANDARD 781001-03)
- || PR DELINEATOR, TWO REFLECTORS (SEE STANDARD 635001-01)
- | PR DELINEATOR, SINGLE REFLECTOR (SEE STANDARD 635001-01)

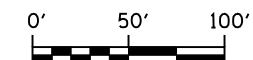

USER NAME = gjameson	DESIGNED -	REVISED
FILE NAME = D672854 pln sht 43.dgn	CHECKED -	REVISED
PLOT SCALE = 100.0000 "/>		

**STATE OF ILLINOIS
 DEPARTMENT OF TRANSPORTATION**

PLAN SHEET

SCALE: 1" = 50' SHEET NO. 43 OF 62 SHEETS STA. 1374+00.00 TO STA. 388+00.00

F.A.I. RTE.	SECTION	COUNTY	TOTAL SHEETS	SHEET NO.
72		SANGAMON	163	73
•(84-9-2&3)RS-2&MISC STRUC REP			CONTRACT NO. 72B54	
ILLINOIS FED. AID PROJECT				