

NOTE: EXISTING BRIDGE APPROACH SHOULDER PAVEMENTS AND DRAINS AT THE BRIDGES HAVE BEEN OVERLAID WITH HMA. THESE EXISTING BRIDGE APPROACH SHOULDER PAVEMENTS AND DRAINS ARE TO REMAIN IN PLACE AND ARE NOT INCLUDED IN PAVED SHOULDER REMOVAL.

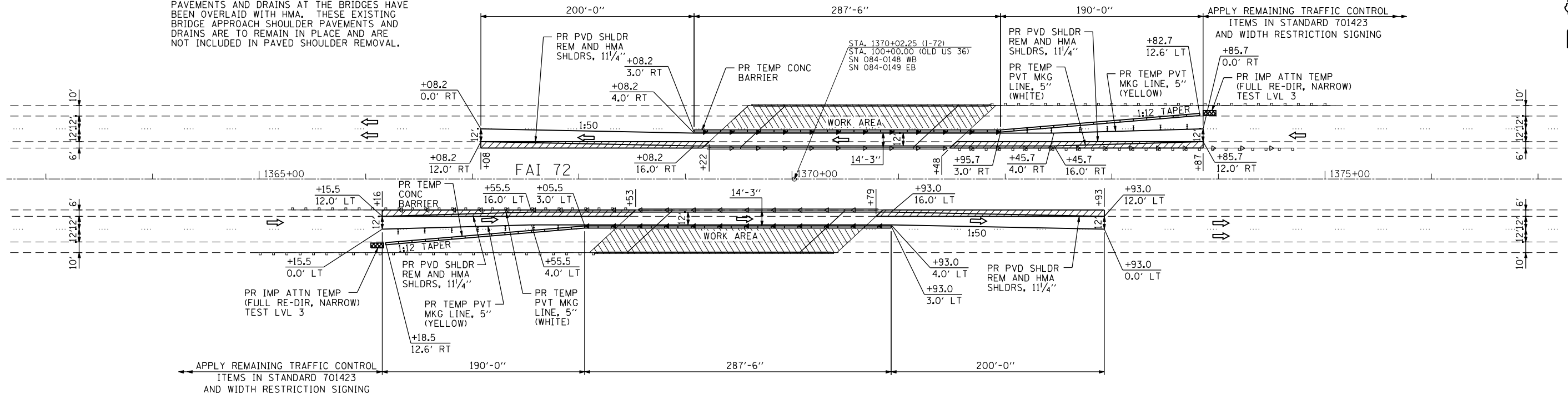

STAGE I

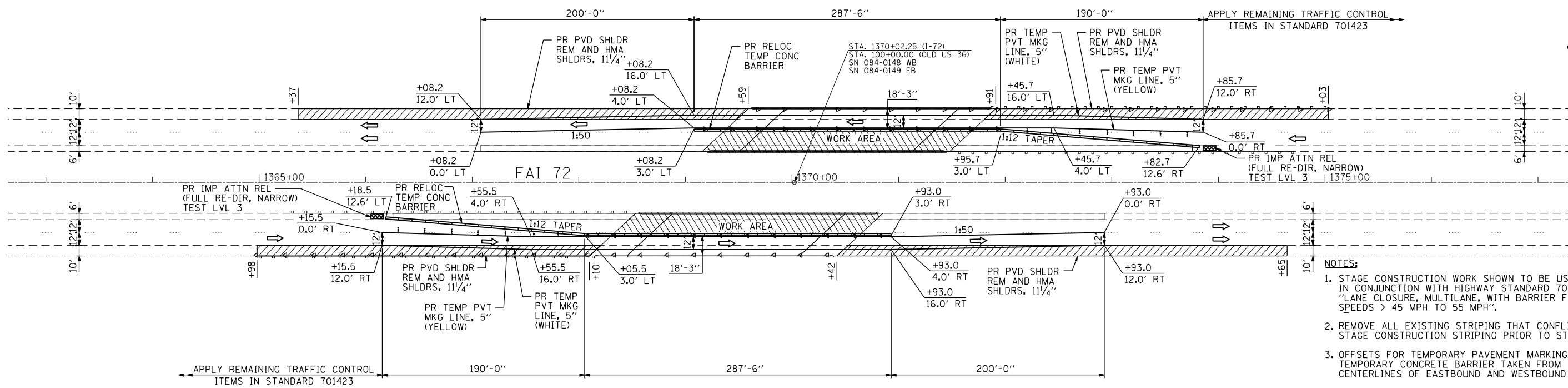

STAGE II

- NOTES:
1. STAGE CONSTRUCTION WORK SHOWN TO BE USED IN CONJUNCTION WITH HIGHWAY STANDARD 701423, "LANE CLOSURE, MULTILANE, WITH BARRIER FOR SPEEDS > 45 MPH TO 55 MPH".
 2. REMOVE ALL EXISTING STRIPING THAT CONFLICTS WITH STAGE CONSTRUCTION STRIPING PRIOR TO STAGING.
 3. OFFSETS FOR TEMPORARY PAVEMENT MARKING AND TEMPORARY CONCRETE BARRIER TAKEN FROM CENTERLINES OF EASTBOUND AND WESTBOUND LANES.
 4. REMOVE AND REPLACE HMA SHOULDERS PRIOR TO STAGING WORK ON STRUCTURES.
 5. COST OF SHORT-TERM PAVEMENT MARKING INCLUDED IN COST FOR HIGHWAY STANDARD 701423.

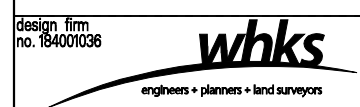
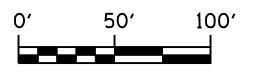

USER NAME = gjameson	DESIGNED -	REVISED
FILE NAME = D672854-sh1-traf-cont	CHECKED -	REVISED
PLOT SCALE = 100.0000 "/> IN.	DRAWN -	REVISED
PLOT DATE = 8/25/2014	CHECKED -	REVISED

STATE OF ILLINOIS
DEPARTMENT OF TRANSPORTATION

STAGE I AND STAGE II MAINTENANCE OF TRAFFIC PLAN
SN 084-0148 WB & SN 084-0149 EB
FAI 72 OVER WABASH AVE.

F.A.I. RTE. 72	SECTION	COUNTY SANGAMON	TOTAL SHEETS 163	SHEET NO. 98
•(84-9-2&3)RS-2&MISC STRUC REP		CONTRACT NO. 72B54		
ILLINOIS FED. AID PROJECT				

SCALE: 1" = 50' SHEET NO. 1 OF 2 SHEETS STA. 1266+25.50 TO STA. 1373+75.70