

NOTES:

1. THE TRAFFIC CONTROL DETAILS ABOVE SHALL BE WORKED IN CONJUNCTION WITH TRAFFIC CONTROL AND PROTECTION STANDARD 701321, "LANE CLOSURE, 2L, 2W, BRIDGE REPAIR WITH BARRIER".
2. REMOVE ALL EXISTING STRIPING THAT CONFLICTS WITH STAGE CONSTRUCTION STRIPING PRIOR TO STAGING.
3. OFFSETS FOR TEMPORARY PAVEMENT MARKING AND TEMPORARY CONCRETE BARRIER TAKEN FROM CENTERLINE.
4. REMOVE AND REPLACE HMA SHOULDERS PRIOR TO STAGING WORK ON STRUCTURES.
5. COST OF TEMP PAVEMENT MARKING INCLUDED IN COST FOR HIGHWAY STANDARD 701321.
6. CONSTRUCTION LANE WIDTHS LESS THAN 16' WILL REQUIRE WIDTH RESTRICTION SIGNING AS NOTED IN SECTION 701.06 OF THE STANDARD SPECIFICATIONS FOR ROAD AND BRIDGE CONSTRUCTION.

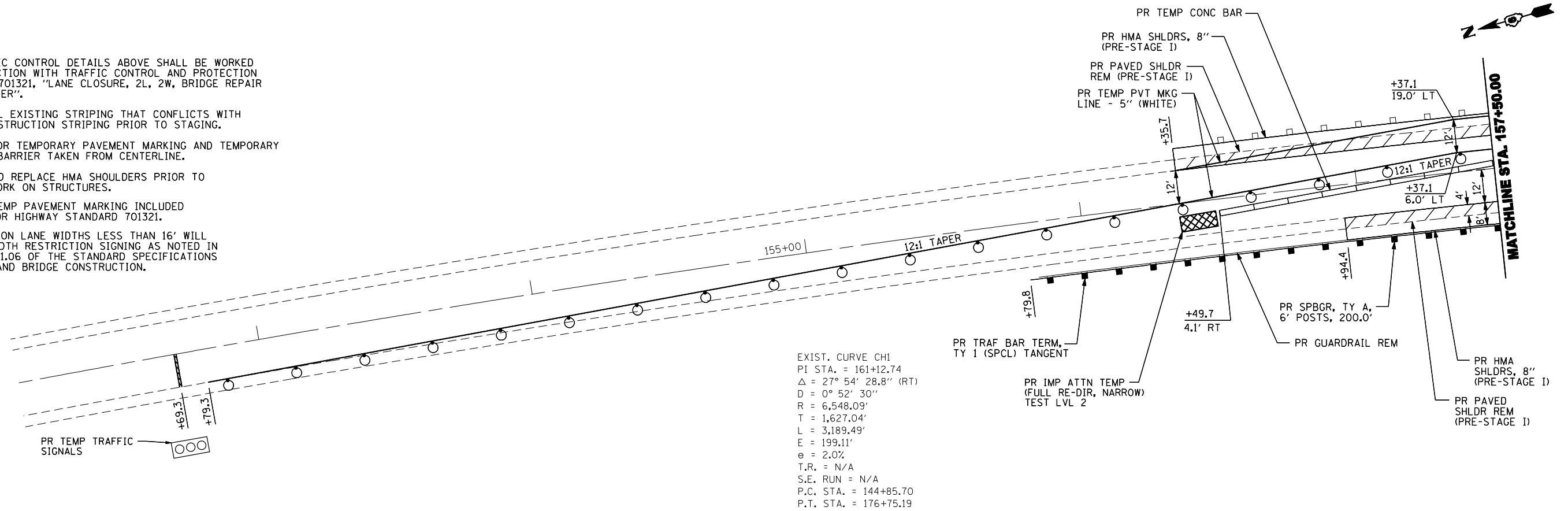

EXIST. CURVE CHI
 PI STA. = 161+12.74
 $\Delta = 27^\circ 54' 28.8''$ (RT)
 $D = 0^\circ 52' 30''$
 $R = 6,548.09'$
 $T = 1,627.04'$
 $L = 3,189.49'$
 $E = 199.11'$
 $e = 2.0\%$
 $T.R. = N/A$
 $S.E. RUN = N/A$
 $P.C. STA. = 144+85.70$
 $P.T. STA. = 176+75.19$

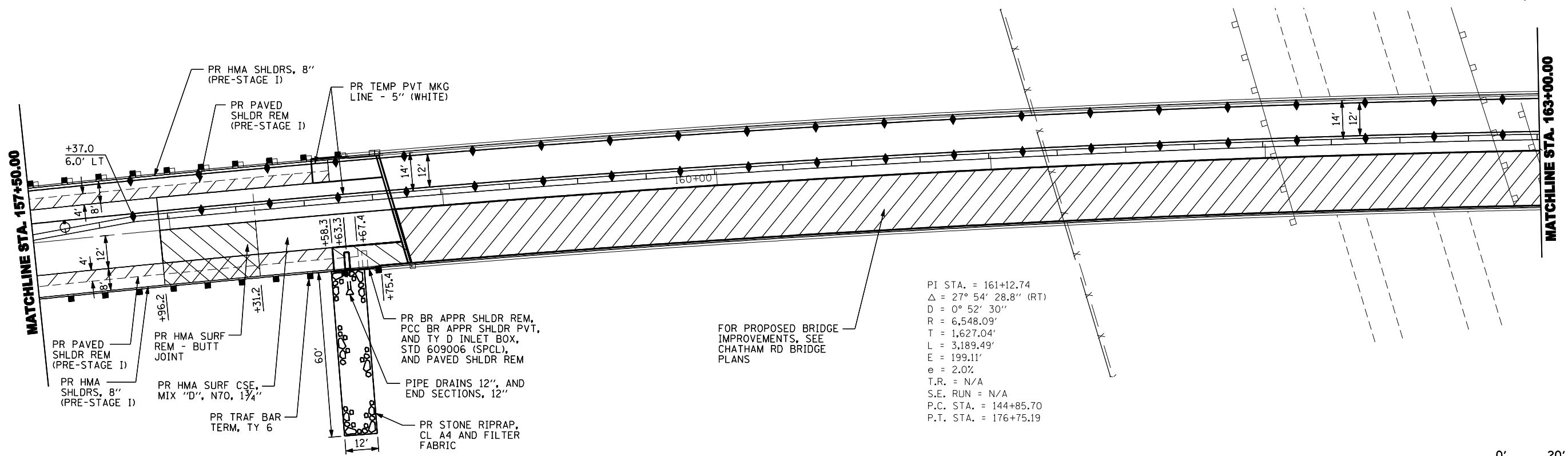

PI STA. = 161+12.74
 $\Delta = 27^\circ 54' 28.8''$ (RT)
 $D = 0^\circ 52' 30''$
 $R = 6,548.09'$
 $T = 1,627.04'$
 $L = 3,189.49'$
 $E = 199.11'$
 $e = 2.0\%$
 $T.R. = N/A$
 $S.E. RUN = N/A$
 $P.C. STA. = 144+85.70$
 $P.T. STA. = 176+75.19$

FOR PROPOSED BRIDGE IMPROVEMENTS, SEE CHATHAM RD BRIDGE PLANS

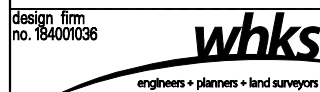
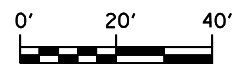

| | | |
|-------------------------------------|------------|-----------|
| USER NAME = gjameson | DESIGNED - | REVISED - |
| FILE NAME = D672854.pln sht chatham | CHEKED - | REVISED - |
| PLOT SCALE = 40.0000' / IN. | DRAWN - | REVISED - |
| PLOT DATE = 8/25/2014 | CHECKED - | REVISED - |

**STATE OF ILLINOIS
 DEPARTMENT OF TRANSPORTATION**

STAGE I TRAFFIC CONTROL CHATHAM RD.

SCALE: 1" = 20' SHEET NO. 1 OF 5 SHEETS STA. 152+00.00 TO STA. 163+00.00

| F.A.I. RTE. | SECTION | COUNTY | TOTAL SHEETS | SHEET NO. |
|--------------------------------|---------|----------|--------------------|-----------|
| 72 | | SANGAMON | 163 | 100 |
| •(84-9-2&3)RS-2&MISC STRUC REP | | | CONTRACT NO. 72B54 | |
| ILLINOIS FED. AID PROJECT | | | | |