

B.M. - #9A R.R. Spike in telephone pole 135'  
Rt. Sta. 460+05 Elev. 606.82

STATE OF ILLINOIS  
DEPARTMENT OF PUBLIC WORKS & BUILDINGS  
DIVISION OF HIGHWAYS

ROUTE NO.	SECTION	COUNTY	TOTAL SHEETS	SHEET NO.
196	1HB	SANGAMON	55	12
F.A. PROJ. F-277(14)		SHEET NO. 12 SHEETS		

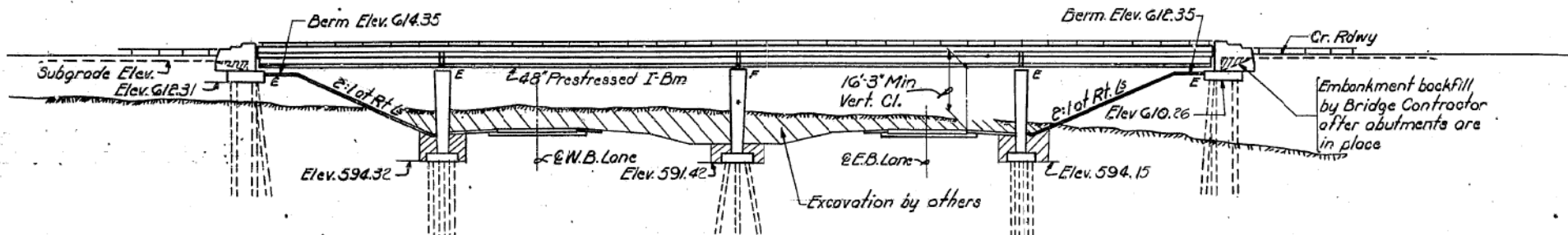

All Piles Steel  
**ELEVATION**

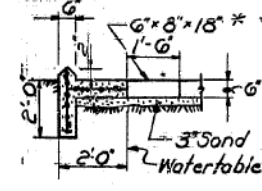

**SECTION A-A**

\* Concrete masonry block  
Welded wire fabric shown in Sections A-A & B-B shall be 6"x6" mesh, weighing 38# per 100 Sq. Ft.

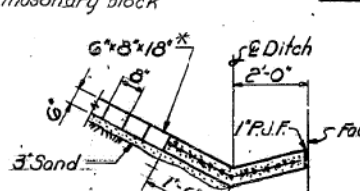

**SECTION B-B**

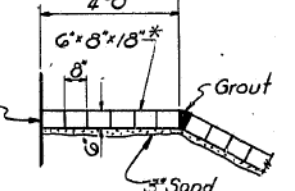

**SECTION C-C**

STATION 460+31.13  
BUILT 196 BY  
STATE OF ILLINOIS  
F.A. RT. 196 SEC. 1HB  
F.A. PROJ. F-277(14)  
LOADING HS-15

**NAME PLATE**  
See Std 2113-1

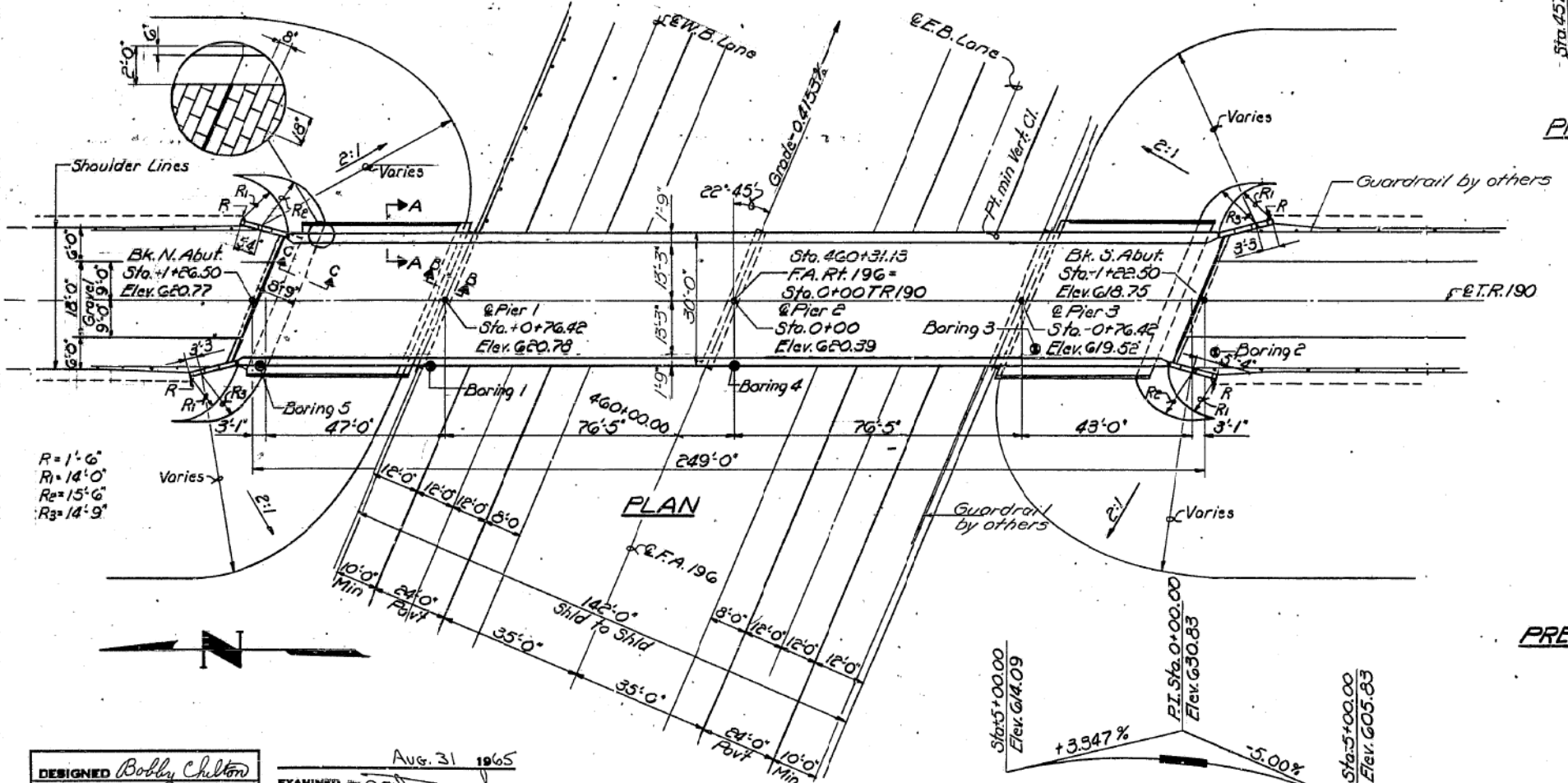

**PLAN**

**PROPOSED PROFILE T.R.190**

**FOR INFORMATION ONLY**

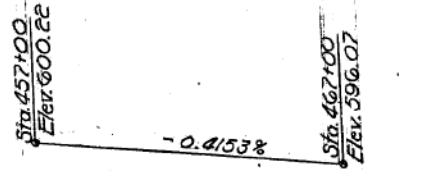

**PROPOSED PROFILE FA.196**

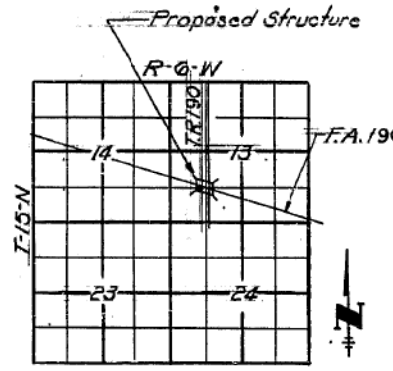

**LOCATION SKETCH**

**DESIGN STRESSES  
PRESTRESSED PRECAST UNITS**

$f'_c = 5000 \text{ psi}$   
 $f'_t = 4000 \text{ psi}$   
 $f_c = 2000 \text{ psi after losses}$   
 $f_s = 248,000 \text{ psi}$   
 $f'_s = 173,600 \text{ psi}$

**DESIGN STRESSES**

$f_c = 1400 \text{ psi Super \& Sub}$   
 $v_c = 75 \text{ psi Ftgs}$   
 $f_s = 20,000 \text{ psi Reinf.}$   
 $n = 10$   
**LOADING HS15-44**

**GENERAL NOTES**

Coarse aggregate to be used in parapet handrails and end post must be free of chert, flint, limonite, lignite and soft sandstone. The concrete floor slab shall be finished in accordance with Art. 51.19 of the Standard Specifications. Permanent forms will not be permitted in forming the concrete floor. For item precast prestressed conc. I-beams, see supplemental specifications. For Slope Wall (Special) see Special Provisions.

All reinforcement bars shall be lapped 20 diameters unless otherwise shown. All structural steel shall conform to A.S.T.M. Designation A-36. Exposed surfaces of the expansion devices, inaccessible after erection, shall receive two shop coats of red lead paint. All other surfaces shall be given one shop coat of red lead paint. Anchor studs shall not be painted. Expansion devices are included in the quantity of structural steel. Est. weight = 840 Lbs. Except as otherwise provided, all structural steel shall receive one shop coat of red lead paint and two field coats of aluminum paint.

The contractor shall drive one Steel test pile at Pier #2 and one Steel test pile at the S. Abutment, in a permanent location, as directed by the Engineer before ordering the remainder of piles. Excavations for portions of structures in the embankments shall not be classified.

**TOTAL BILL OF MATERIAL**

Items	Units	Super	Sub	Total
** Class A Excav. for Structures	Cu. Yds.		187	187
Structural Steel	Lbs.	2570		2570
Furnishing & Erecting Precast & Prestressed Concrete I-Beam #8	Lin. Ft.	1216		1216
Class X Concrete	Cu. Yds.	254.7	271.6	526.3
Alum. Handrail	Lin. Ft.			491
Reinforcement Bars	Lbs.	33600	29680	83280
Steel Pile (108P42)	Lin. Ft.		1748	1748
Test Pile (Steel)	Each		2	2
Name Plates	Each		2	2
Slope Wall (Special)	Sq. Yds.			380
*** Protective Coat	Sq. Yds.			928

\*\* Class A Excav. for Structures includes Excav. for slope wall.  
\*\*\* Includes use on inside vertical face, top & exposed ends of the Abut. Wings.

**GENERAL PLAN & ELEVATION**

**PROJECT F-277(14)**  
**TOWNSHIP RD. 190 OVER**  
**F.A. RT. 196 SEC. 1HB**  
**SANGAMON COUNTY**  
**STA. 460+31.13**

DESIGNED Bobby Chilton	EXAMINED [Signature]	DATE Aug. 31 1965
CHECKED Sam F. Melvin	PASSED [Signature]	
DRAWN W.E. Dickerson	APPROVED [Signature]	
CHECKED SFM		



USER NAME =	DESIGNED - CEH	REVISED
FILE NAME =	CHECKED - CWC	REVISED
PLOT SCALE =	DRAWN - DLH	REVISED
PLOT DATE =	CHECKED - CEH/CWC	REVISED

STATE OF ILLINOIS  
DEPARTMENT OF TRANSPORTATION

EXISTING PLANS  
STRUCTURE NO. 084-0126

SHEET NO. 2 OF 2 SHEETS

F.A.P. RTE.	SECTION	COUNTY	TOTAL SHEETS	SHEET NO.
72		SANGAMON	163	131
ILLINOIS FED. AID PROJECT			CONTRACT NO. 72B54	

(84-9-28)RS-2&MISC STRUC REP