

**Existing Structure:** The existing structure was constructed in 1991 as FAP 408, Section 3VB-1. The structure is a curved six span continuous bridge with a reinforced concrete deck supported on five 42" steel composite (positive moment regions only) welded plate girders with a pile bent abutment (north end), open vaulted abutment (south end) and multicolumn piers. The existing structure is skewed 14°19'20" right forward. The structure measures 543'-6<sup>3</sup>/<sub>4</sub>" along a local tangent from back of north abutment to back of south approach bent and 43'-2" out to out of bridge deck. One lane of traffic shall be maintained on Chatham Road by utilizing stage construction.

No Slavage

**INDEX OF SHEETS**

1. General Plan and Elevation
2. General Data
3. Temporary Concrete Barrier for Stage Construction
4. North Abutment Joint Replacement Details
5. South Abutment Joint Replacement Details
6. North Abutment Preformed Joint Strip Seal
7. South Abutment Preformed Joint Strip Seal
8. Bar Splicer Assembly and Mechanical Splicer Details
9. Abutment Repairs
- 10.-15. Existing Structure Plans (For Information Only)

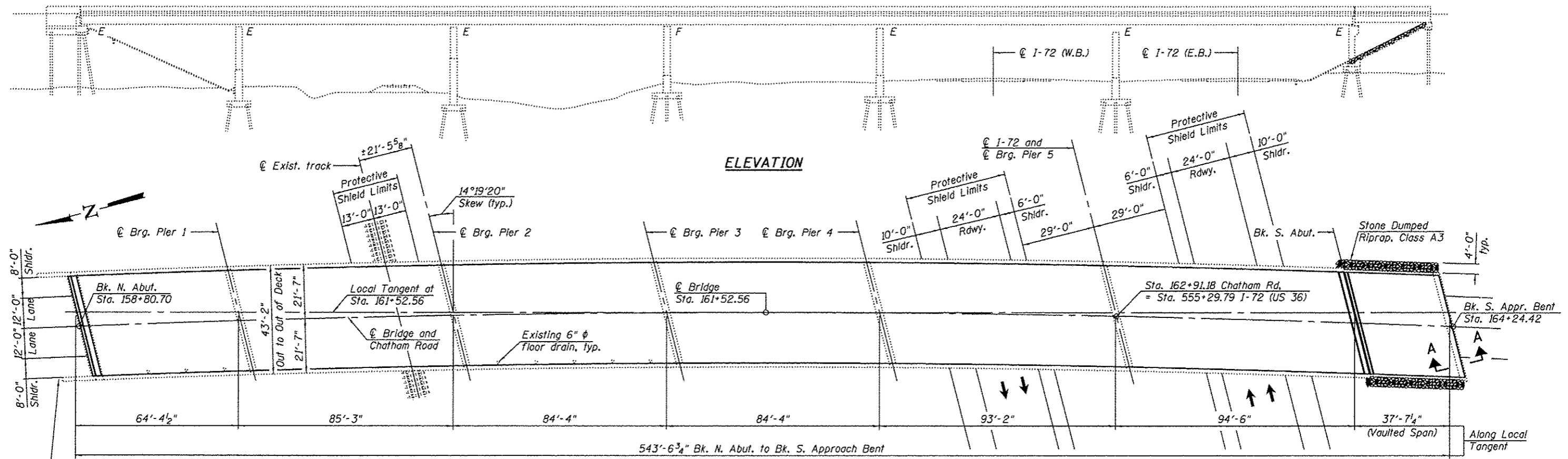

Fill void under approach shoulder with Controlled Low-Strength Material.

**HORIZ. CURVE DATA**

P.I. Sta. = 161+12.74  
 $\Delta = 27^\circ 54' 28.8''$   
 $D_c = 0^\circ 52' 30''$   
 $R = 6548.09'$   
 $L = 3189.49'$   
 $T = 1627.04'$   
 $E = 199.11'$   
 $S.E. = 0.02\%$

**SCOPE OF WORK**

1. Replace existing expansion joints at both abutments.
2. Scarify deck and add microsillca overlay.
3. Deck slab repairs.
4. Clean and paint beam ends.
5. Repair abutments.
6. Place riprap adjacent to south abutment.
7. Replace existing terminal guardrail sections (See Roadway Plans).

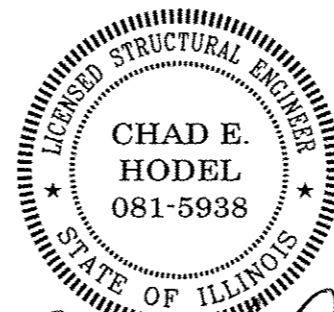

*CHAD E. HODEL*  
 8-21-14  
 Expires: 11/30/2014

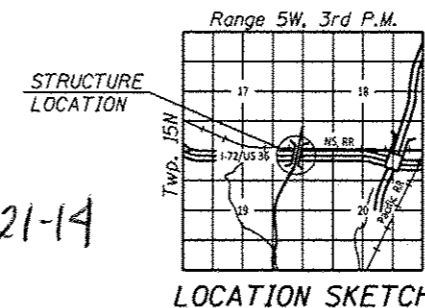

**GENERAL PLAN AND ELEVATION**  
**CHATHAM ROAD OVER I-72/NSRR**  
**F.A.I. 72 SECTION (84-9-2&3)RS-2MISC STRUC REP**  
**SANGAMON COUNTY**  
**STATION 555+29.79**  
**STRUCTURE NO. 084-0185**



|              |                   |         |
|--------------|-------------------|---------|
| USER NAME *  | DESIGNED - CEH    | REVISED |
| FILE NAME *  | CHECKED - CWC     | REVISED |
| PLOT SCALE * | DRAWN - DLH       | REVISED |
| PLOT DATE *  | CHECKED - CEH/CWC | REVISED |

STATE OF ILLINOIS  
 DEPARTMENT OF TRANSPORTATION

GENERAL PLAN AND ELEVATION  
 STRUCTURE NO. 084-0185

SHEET NO. 1 OF 15 SHEETS

|                    |         |          |              |           |
|--------------------|---------|----------|--------------|-----------|
| F.A.I. RTE.        | SECTION | COUNTY   | TOTAL SHEETS | SHEET NO. |
| 72                 | *       | SANGAMON | 163          | 138       |
| CONTRACT NO. 72B54 |         |          |              |           |

ILLINOIS FED. AID PROJECT  
 \* (84-9-2&3)RS-2&MISC STRUC REP