

EXISTING 1' HMA SHOULDERS SHALL BE PAVED MONOLITHICALLY WITH THE LEVELING BINDER AND HMA SURFACE COURSE. SEE TYPICAL SECTIONS.

SEE ENTRANCE DETAIL AND SCHEDULES FOR ADDITIONAL INFORMATION

- PAVEMENT CHANGES FROM 24' TO 26' WIDTH WHERE GUTTER SECTION BEGINS AT EDGE OF TOWN.

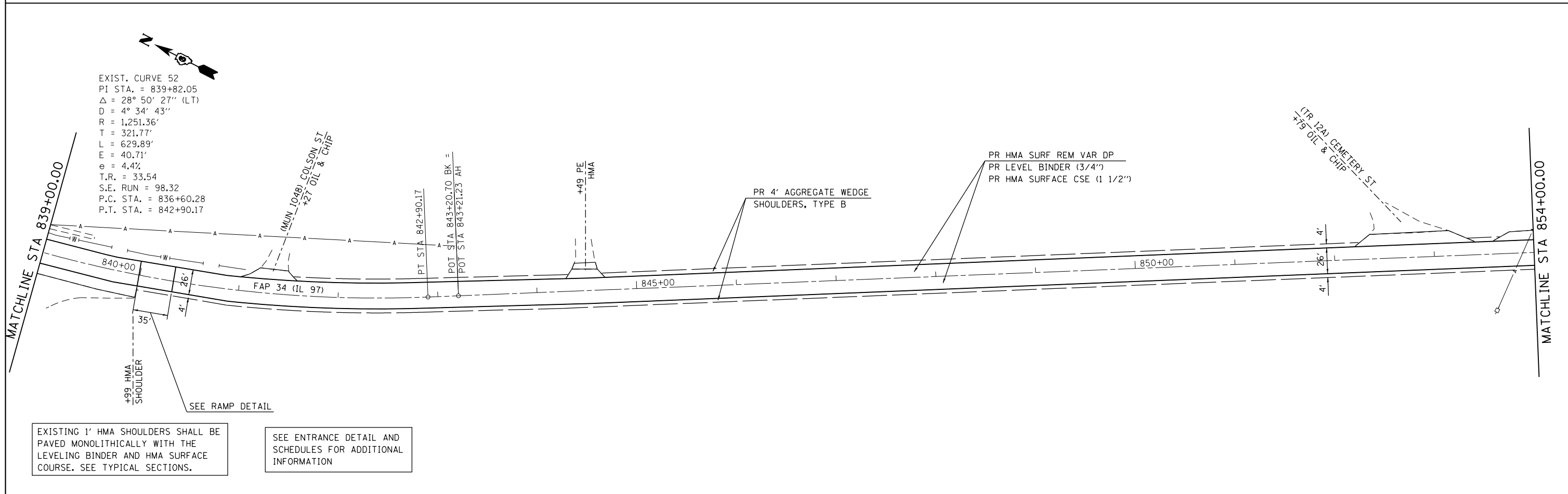

EXISTING 1' HMA SHOULDERS SHALL BE PAVED MONOLITHICALLY WITH THE LEVELING BINDER AND HMA SURFACE COURSE. SEE TYPICAL SECTIONS.

SEE ENTRANCE DETAIL AND SCHEDULES FOR ADDITIONAL INFORMATION

EXIST. CURVE 52
 PI STA. = 839+82.05
 $\Delta = 28^\circ 50' 27''$ (LT)
 $D = 4^\circ 34' 43''$
 $R = 1,251.36'$
 $T = 321.77'$
 $L = 629.89'$
 $E = 40.71'$
 $e = 4.4\%$
 $T.R. = 33.54$
 $S.E. RUN = 98.32$
 $P.C. STA. = 836+60.28$
 $P.T. STA. = 842+90.17$

FILE NAME =	USER NAME = sparksgw	DESIGNED -	REVISED -	STATE OF ILLINOIS DEPARTMENT OF TRANSPORTATION	PLAN SHEETS FAP 34 (IL 97)			F.A.P. RTE.	SECTION	COUNTY	TOTAL SHEETS	SHEET NO.
Default	Plot DATE = Jun-06-2014 02:14:35PM	DRAWN -	REVISED -					34	...	MENARD	45	29
		CHECKED -	REVISED -		CONTRACT NO. 72F 71			ILLINOIS FED. AID PROJECT				
		DATE -	REVISED -		SCALE: 1" = 50'	SHEET	OF 30 SHEETS	STA.	TO STA.	*** D6 SPRING RD REPAIR 2014-20		