

STATE OF ILLINOIS  
DEPARTMENT OF TRANSPORTATION

PROJECT NO.	SECTION	COUNTY	TOTAL SHEETS	SHEET NO.	SHEET NO.
101 BR	SCHUYLER	33	12	11	11

B.M.: Cut S.E. Corner Bridge on top of Wing  
16'0" Rt. Sta. 78+41 Elev. 464.33  
Existing Structure: Built as S.B.I. Route 103  
Section 101-B-C at Station 78+05 in 1926.  
Structure consists of a Steel Truss on R.C.  
Closed Abutments. Existing Superstructure  
shall be removed by the Contractor.

No Salvage.

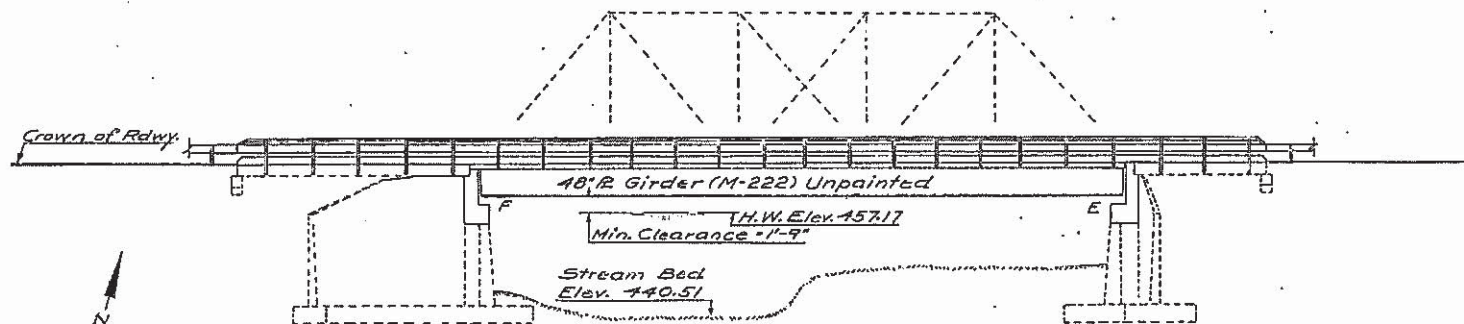

ELEVATION

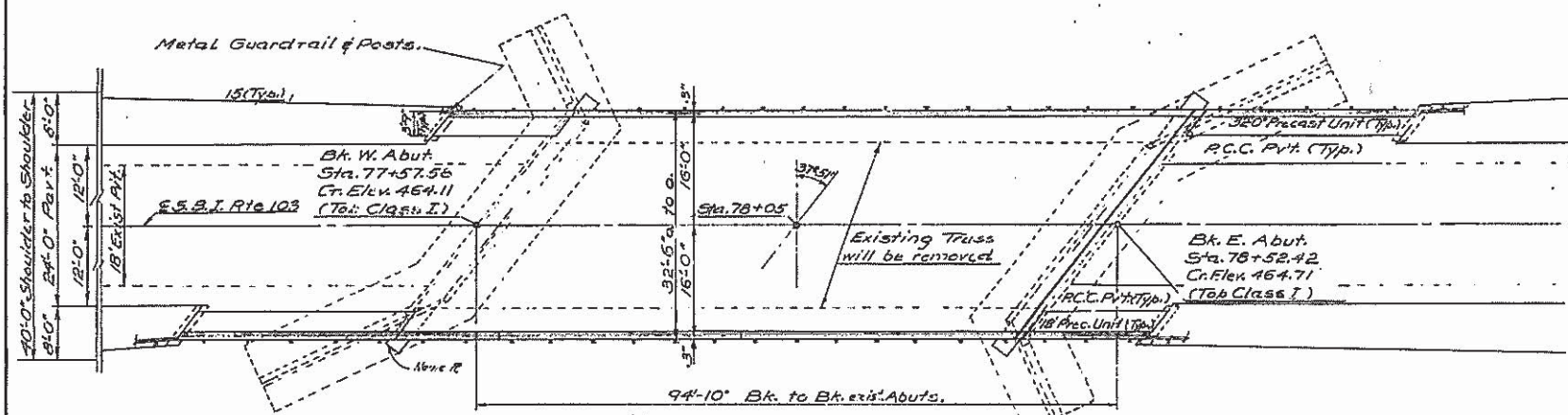

PLAN

STATION 78+05  
REBUILT BY  
STATE OF ILLINOIS  
S.B.I. RTE. 103 SEC. 101 BR  
PROJECT # 101-1216  
LOADING HS20

NAME PLATE  
Sec 514.2113

WATERWAY INFORMATION

Drainage area 9344 ac/cu  
Character: hilly, clay, wooded  
Present opening 819 sq. ft.  
Required opening 819 sq. ft.  
Proposed opening 819 sq. ft.  
H.W.E. 457.17  
Q<sub>100</sub> = 4290 cfs.

DESIGN STRESSES

f<sub>c</sub> = 4200 psi (Deck slab)  
f<sub>c</sub> = 4400 psi (Curb, Parapet, Sub)  
f<sub>s</sub> = 20,000 psi (Reinft)  
f<sub>s</sub> = 27,000 psi (Struct. M-222)  
n = 10

PRECAST UNITS

f<sub>c</sub> = 4500 psi  
f<sub>c</sub> = 1,800 psi  
f<sub>s</sub> = 20,000 psi  
n = 8

Loading HS20-44  
Allow 25#10' for future W.S.  
Design Specifications 1973 AASHTO as applicable.

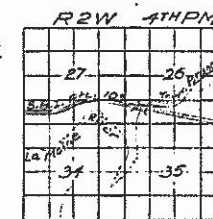

LOCATION SKETCH

GENERAL NOTES

- Reinforcement bars shall be lapped 24 diameters unless otherwise shown.
- It shall be the responsibility of the Contractor to verify all dimensions and conditions existing in the field prior to construction and ordering of materials.
- Protective Coat shall not be applied to surfaces to which Waterproofing Membrane System is applied.
- Calculated weight of Structural Steel = 83,500 lbs.
- Excavation shall consist of soil drilling excavation and 2" x 6" x 12" hooked bolts.
- Iron bolts shall be set before setting diaphragms over supports.
- Bearing seat surfaces shall be constructed or adjusted to the designated elevations within a tolerance of 1/8". Adjustment shall be made either by grinding the surface or by shimming the bearing. Two 1/2" adjusting shims, of the dimensions of the bearing plate, shall be provided for each bearing in addition to all other plates or shims.
- The main load carrying member components subject to the Supplemental Requirements for Hatch Beams are the flanges, ribs, and splice plates of the steel girders.
- Field welding of construction accessories will not be permitted to the bottom flange of beams. Field welding in other areas will be permitted only when approved by the Engineer.
- All structural steel shall be AASHTO M 222 unpainted except expansion joint angles and attached bars which shall be AASHTO M 183 and shop painted with two coats of basic lead zinc chromate paint.

TOTAL BILL OF MATERIAL

Item	Unit	Super	Sub	Total
Bituminous Concrete Surface Course, Class 2	Tons	27		27
Portland Cement Concrete Pavement (10')	Sq. Yds.	39		39
Pavement Fabric	Sq. Yds.	39		39
Concrete Removal	Cu. Yds.		40	40
Expansion Bolts (4" x 6")	Each	62		62
Class 2 Concrete	Cu. Yds.	85.0	73.1	158.1
Structural Steel	L. S.			83.5
Steel Purlins, Type T	Lin. Ft.	286		286
Reinforcement Bars	Lbs.	23,920	6,280	30,200
Protective Coat	Sq. Yds.	48		48
Removal of Existing Superstructures	Each	1		1
Waterproofing Membrane System	Sq. Yds.	321		321
Name Plates	Each	1		1
Stud Shear Connectors	Each	915		915
Preformed Joint Sealer (4")	Lin. Ft.	61		61
Precast Concrete Bridge Slab	Sq. Ft.	373		373

Proposed reconstruction  
GENERAL PLAN & ELEVATION  
S.B.I. RTE. 103 OVER TOWN BRANCH  
S.B.I. RTE. 103 SECTION 101 BR  
SCHUYLER CO.  
STA. 78+05.00

DESIGNED	H. H. Lee
CHECKED	Suresh Desai
DRAWN	V.H. S.S.
CHECKED	S.D. Lee

EXAMINED	DECEMBER 10 1974
PASSED	
APPROVED	