

DIMENSIONS "A" THRU "D"

| Abutment | "A" | "B" | "C" | "D" |
|------------|-----------|-----------|-----------|-----------|
| S.E. Abut. | 3'-2 1/4" | 1'-5 7/8" | 1'-7 1/2" | 1'-9 1/4" |
| S.W. Abut. | 3'-2 3/4" | | | |
| N.E. Abut. | 3'-1 5/8" | 1'-9 3/4" | 1'-8" | 1'-6 1/8" |
| N.W. Abut. | 3'-1 3/8" | | | |

South Abutments shown
North Abutments similar
by rotation.

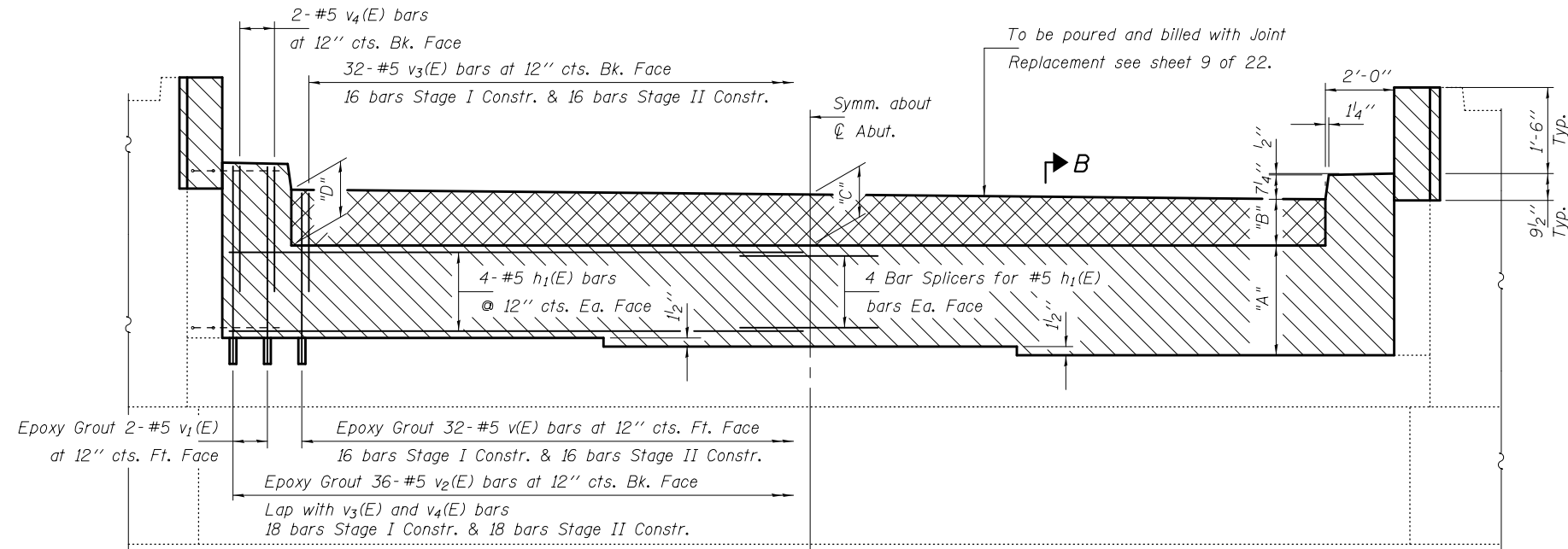

REPLACEMENT ELEVATION

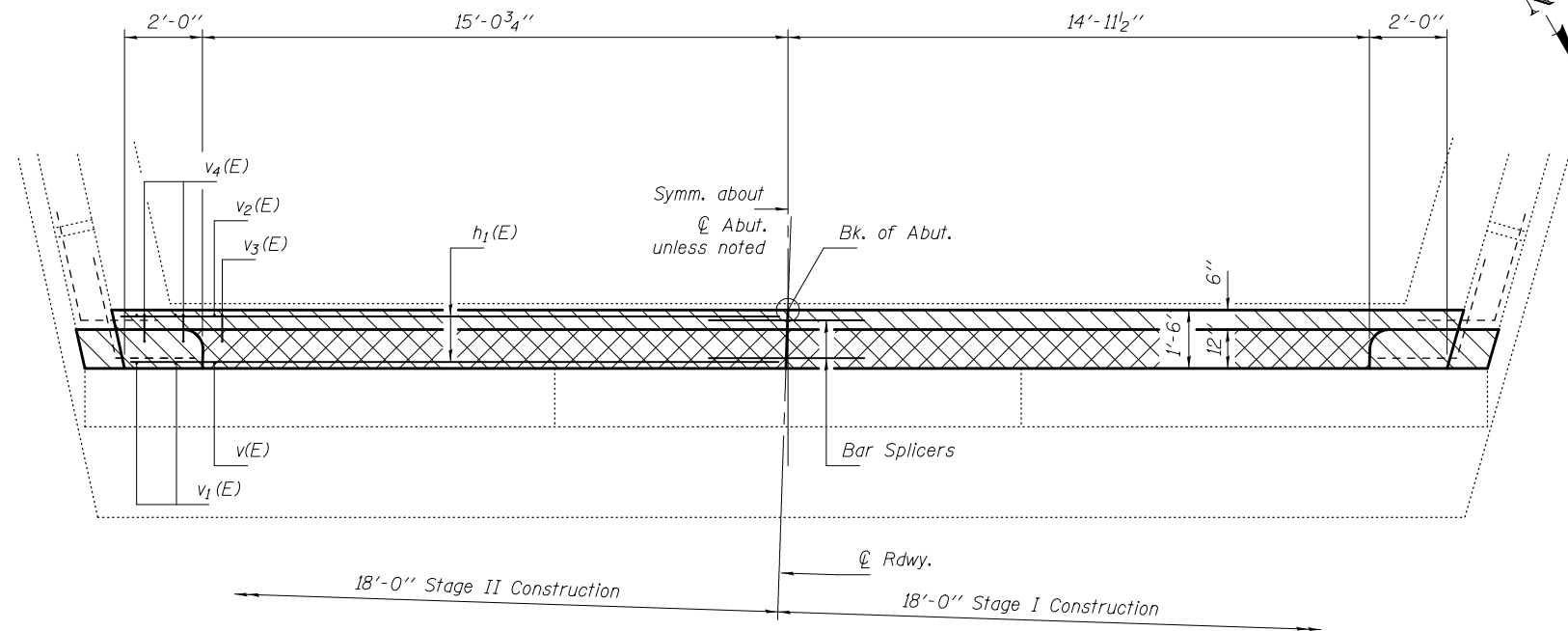

REPLACEMENT PLAN

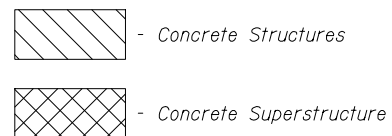

Notes
For Concrete Removal details and
Section B-B see sheet 11 of 22.

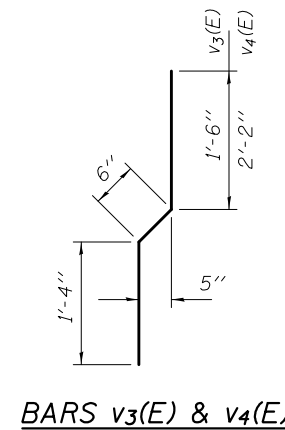

BARS v3(E) & v4(E)

BILL OF MATERIAL

| Bar | No. | Size | Length | Shape |
|----------------------------------|-----|------|---------|-------|
| h ₁ (E) | 64 | #5 | 16'-9" | — |
| v(E) | 128 | #5 | 5'-2" | — |
| v ₁ (E) | 16 | #5 | 5'-9" | — |
| v ₂ (E) | 144 | #5 | 3'-8" | — |
| v ₃ (E) | 128 | #5 | 3'-4" | — |
| v ₄ (E) | 16 | #5 | 4'-0" | — |
| Structure Excavation | | | Cu. Yd. | 60.8 |
| Porous Granular Embankment | | | Cu. Yd. | 60.8 |
| Concrete Structures | | | Cu. Yd. | 24.0 |
| Reinforcement Bars, Epoxy Coated | | | Pound | 2970 |

| | | |
|--------------------|--|-----------------------|
| DESIGNED SMR | EXAMINED <i>Timothy A. Annet</i> | DATE October 15, 2014 |
| CHECKED CCC | PASSED <i>ACTING ENGINEER OF STRUCTURAL SERVICES</i> | REVISED |
| DRAWN J. Schneller | <i>ACTING ENGINEER OF BRIDGES AND STRUCTURES</i> | REVISED |
| CHECKED SMR CCC | | |

**STATE OF ILLINOIS
DEPARTMENT OF TRANSPORTATION**

**ABUTMENT WALL REPAIR DETAILS
SN 025-0071 & 025-0072**

SHEET NO. 10 OF 22 SHEETS

| F.A.I. RTE. | SECTION | COUNTY | TOTAL SHEETS | SHEET NO. |
|--------------------|---------------|-----------|--------------|-----------|
| 57 | (25-6, 7)RS-2 | EFFINGHAM | 63 | 38 |
| CONTRACT NO. 74638 | | | | |

ILLINOIS FED. AID PROJECT