

STATE OF ILLINOIS  
DEPARTMENT OF TRANSPORTATION  
DIVISION OF HIGHWAYS

**PROPOSED  
HIGHWAY PLANS**

FAP ROUTE 42 (IL 127)  
SECTION (111,112)-I

CONCRETE PATCHING  
CLINTON COUNTY

C-98-061-14

F.A.P. RTE.	SECTION	COUNTY	TOTAL SHEETS	SHEET NO.
42	(111,112)-I	BOND & CLINTON	7	1
		ILLINOIS	CONTRACT NO. 76H34	

FOR INDEX OF SHEETS, SEE SHEET NO. 2

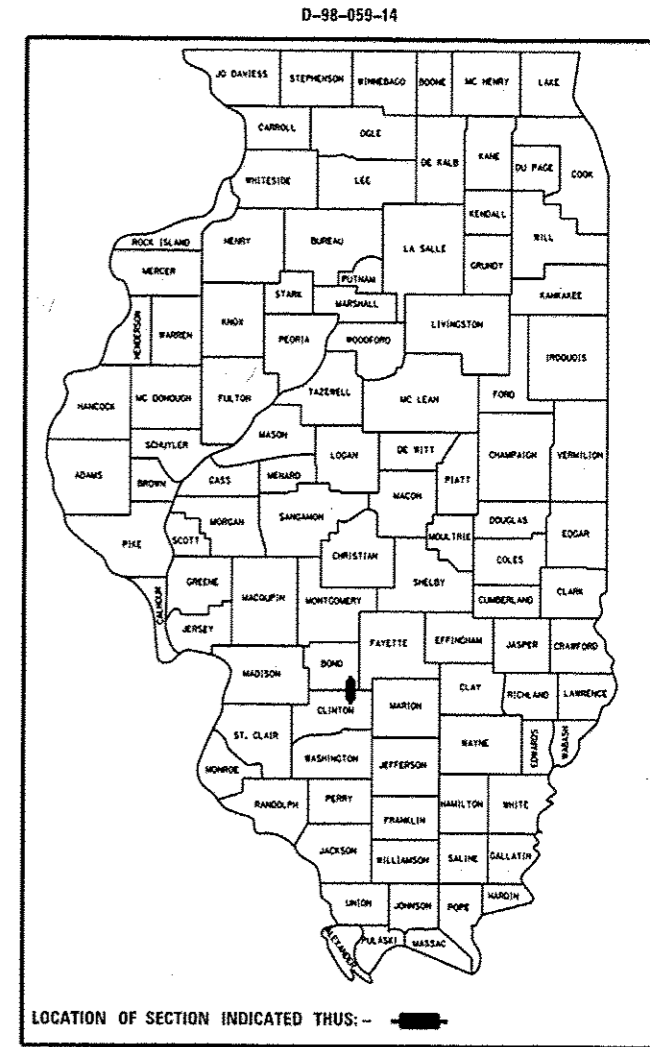

IL 143 TO KEYESPORT RD  
ADT = 2650 (2013)  
ADT = 2700 (2015)  
ADT = 3300 (2035)  
SU = 3.8%  
MU = 12.3%

KEYESPORT RD TO MARYDALE RD  
ADT = 3450 (2013)  
ADT = 3500 (2015)  
ADT = 4300 (2035)  
SU = 4.3%  
MU = 11.6%

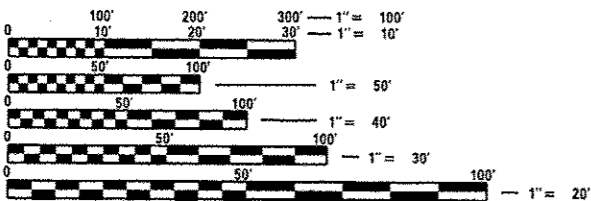
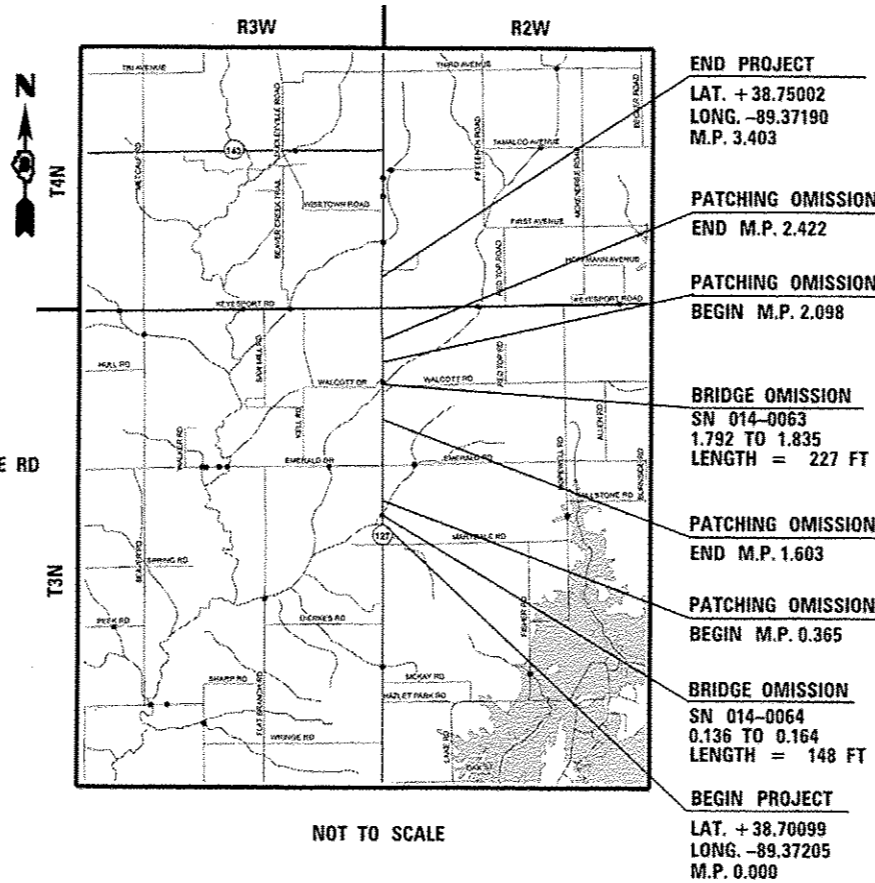

FULL SIZE PLANS HAVE BEEN PREPARED USING STANDARD ENGINEERING SCALES. REDUCED SIZED PLANS WILL NOT CONFORM TO STANDARD SCALES. IN MAKING MEASUREMENTS ON REDUCED PLANS, THE ABOVE SCALES MAY BE USED.

J.U.L.I.E.  
JOINT UTILITY LOCATION INFORMATION FOR EXCAVATION  
1-800-892-0123  
OR 811

DESIGN DESIGNATION  
N/A

GROSS LENGTH = 17968 FT = 3.403 MILE  
NET LENGTH = 9345.6 FT. = 1.770 MILE

STATE OF ILLINOIS  
DEPARTMENT OF TRANSPORTATION  
DIVISION OF HIGHWAYS

SUBMITTED *July 27, 2014*

*Jeffrey Z. Kanas*  
DEPUTY DIRECTOR OF HIGHWAYS, REGION 5 ENGINEER

*Oct 17, 2014*  
*John D. Baranzoni, PE*  
actg ENGINEER OF DESIGN AND ENVIRONMENT

*Oct 17, 2014*  
*Chris Egan, PE*  
DIRECTOR OF HIGHWAYS, CHIEF ENGINEER

PRINTED BY THE AUTHORITY  
OF THE STATE OF ILLINOIS

PROJECT ENGINEER: PATTI LEBEAU (618) 346-3179  
PROJECT MANAGER: REBECCA THARP (618) 346-3323

CONTRACT NO. 76H34