

11-21-14 LETTING ITEM 116

STATE OF ILLINOIS
DEPARTMENT OF TRANSPORTATION
DIVISION OF HIGHWAYS

| F.A.I. RTE. | SECTION | COUNTY | TOTAL SHEETS | SHEET NO. |
|-------------|-------------------|-----------|--------------------|-----------|
| 1-57 | (41-4,41-4-1)RS-2 | JEFFERSON | 26 | 1 |
| ILLINOIS | | | CONTRACT NO. 78437 | |

**PROPOSED
HIGHWAY PLANS**

FAI ROUTE 57 (I-57)
SECTION (41-4,41-4-1)RS-2
PROJECT ACNHPP - 0057 (311)
INTERSTATE RESURFACING
JEFFERSON COUNTY

FOR INDEX OF SHEETS, SEE SHEET NO. 3

TRAFFIC DATA

| | 2014 | 2034 |
|-----|-------|-------|
| PV | 10705 | 14420 |
| SU | 850 | 1160 |
| MU | 6700 | 9160 |
| ADT | 18100 | 24740 |

42% TRUCKS

TOWNSHIPS
ROME

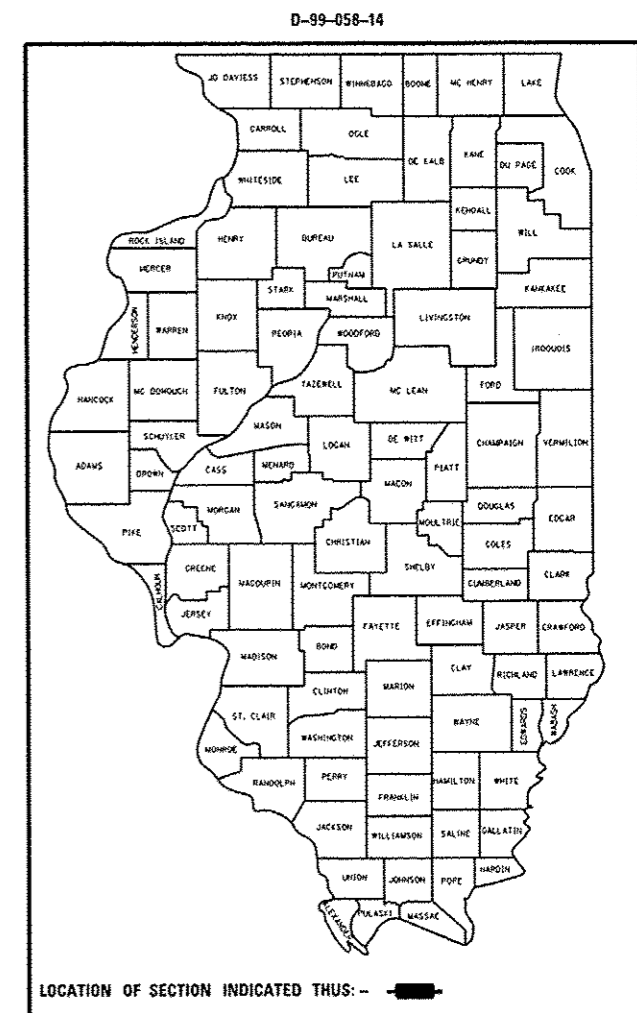

C-99-066-14

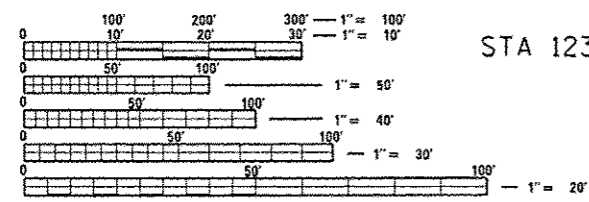
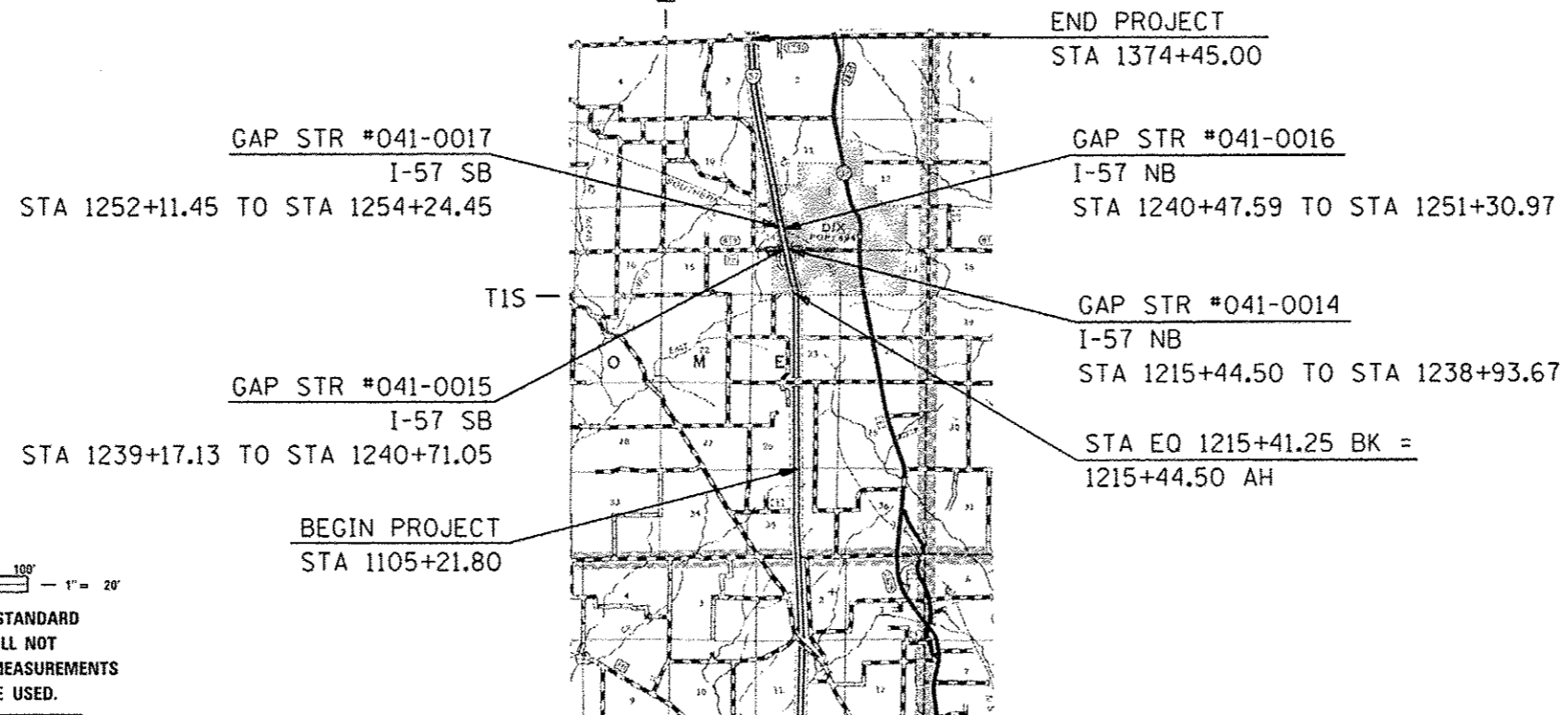

FULL SIZE PLANS HAVE BEEN PREPARED USING STANDARD ENGINEERING SCALES. REDUCED SIZED PLANS WILL NOT CONFORM TO STANDARD SCALES. IN MAKING MEASUREMENTS ON REDUCED PLANS, THE ABOVE SCALES MAY BE USED.

J.U.L.I.E.
JOINT UTILITY LOCATION INFORMATION FOR EXCAVATION
1-800-892-0123
OR 811

DESIGNER: VALERIE ROLLA
PROJECT MANAGER: CHARLES STEIN

GROSS LENGTH = 26919.95 FT. = 5.1 MILE
NET LENGTH = 26553.95 FT. = 5.03 MILE

CONTRACT NO. 78437

STATE OF ILLINOIS
DEPARTMENT OF TRANSPORTATION
DIVISION OF HIGHWAYS

SUBMITTED August 22, 2014
Gregory L. Kuen
DEPUTY DIRECTOR OF HIGHWAYS, REGION ENGINEER

Oct 17, 2014
John D. Baranzelli, P.E.
ENGINEER OF DESIGN AND ENVIRONMENT

Oct 17, 2014
Omer Osman, P.E.
DIRECTOR OF HIGHWAYS, CHIEF ENGINEER

PRINTED BY THE AUTHORITY
OF THE STATE OF ILLINOIS

Prepared By: Joe Zdaniewicz
DISTRICT STUDIES & PLANS ENGINEER

Examined By: J. B. E.
DISTRICT LAND ACQUISITION ENGINEER

Examined By: Carrie Nelson
DISTRICT PROGRAM DEVELOPMENT ENGINEER

Examined By: Kevin Kelly
DISTRICT OPERATIONS ENGINEER

Examined By: K. R.
DISTRICT PROJECT IMPLEMENTATION ENGINEER

Examined By: Daryl J. Russell
DISTRICT CONSTRUCTION ENGINEER

Examined By: Chris Smith
DISTRICT MATERIALS ENGINEER

| | | | | | | | | | | | | | | | | |
|--|------------------------------|------------|-----------|---|---------------------------|------------------|-----------|----|--------|------|---------|-------------|--------------------|--------|--------------|-----------|
| FILE NAME * | USER NAME * | DESIGNED - | REVISED - | STATE OF ILLINOIS DEPARTMENT OF TRANSPORTATION | SCALE: | | SHEET | OF | SHEETS | STA. | TO STA. | F.A.I. RTE. | SECTION | COUNTY | TOTAL SHEETS | SHEET NO. |
| c:\pwwork\update\rollav\ad401951\78437 | whitaker_sqg.indez.dgn | DRAWN - | REVISED - | | 1-57 | (41-4,41-4-URS-2 | JEFFERSON | 26 | 2 | | | | CONTRACT NO. 78437 | | | |
| MODELNAME* | PLOT SCALE = 100,0000 1/ in. | CHECKED - | REVISED - | | ILLINOIS FED. AID PROJECT | | | | | | | | | | | |
| | PLOT DATE = 8/21/2014 | DATE - | REVISED - | | | | | | | | | | | | | |

INDEX OF SHEETS

| SHEET NO. | DESCRIPTION |
|-----------|---|
| 1 | COVER SHEET |
| 2 | SIGNATURE SHEET |
| 3 | INDEX OF SHEETS, STANDARDS, & MIX DESIGN |
| 4 | GENERAL NOTES & MTD CROSSING RESTRICTIONS |
| 5-9 | SUMMARY OF QUANTITIES |
| 10-12 | TYPICAL SECTIONS |
| 13-16 | SCHEDULES |
| 17-21 | PLAN & PROFILE SHEETS |
| 22 | BUTT JOINT DETAILS |
| 23 | MEDIAN CROSSOVER DETAIL |
| 24 | RESURFACING TRANSITION DETAIL |
| 25 | PARAPET DETAIL |
| 26 | DISTRICT DETAILS |

STANDARDS

| | |
|-----------|-----------|
| 000001-06 | 635011-02 |
| 001001-02 | 642001-02 |
| 442001-04 | 701101-04 |
| 442101-07 | 701106-02 |
| 606001-05 | 701400-07 |
| 630001-10 | 701401-08 |
| 630301-06 | 701406-08 |
| 631006-08 | 701411-08 |
| 631011-09 | 701426-06 |
| 631026-05 | 701456-03 |
| 631031-12 | 701901-03 |
| 631033-05 | 780001-04 |
| 635001-01 | 781001-03 |
| 635006-03 | |

MIX DESIGN

| | |
|---|--|
| Locations | Hot-Mix Asphalt Surface Course |
| Mixture Use(s): | Polymerized Hot-Mix Asphalt Surface Course, Mix E, N90 |
| AC/PG: | SBS PG76-22 |
| ABR % (Max): | See Special Provision |
| Design Air Voids: | 4.0 %, 90 Gyration Design |
| Mixture Composition: (Gradation Mixture) | IL-9.5 mm |
| Friction Aggregate: | E Surface |
| Quality Management Program: | PFP |

| | |
|---|---|
| Locations | Hot-Mix Asphalt Binder Course |
| Mixture Use(s): | Polymerized Hot-Mix Asphalt Binder, N90, IL-19.0mm Fine Grade |
| AC/PG: | SBS PG76-22 |
| ABR % (Max): | See Special Provision |
| Design Air Voids: | 4.0 %, 90 Gyration Design |
| Mixture Composition: (Gradation Mixture) | IL-19.0mm Fine Grade |
| Friction Aggregate: | None |
| Quality Management Program: | PFP |

| | |
|---|--|
| Locations | HMA Shoulders & Incidental HMA Surfacing |
| Mixture Use(s): | Hot-Mix Asphalt Surface Course, Mix C, N90 |
| AC/PG: | PG64-22 |
| ABR % (Max): | See Special Provisions |
| Design Air Voids: | 4.0 %, 90 Gyration Design |
| Mixture Composition: (Gradation Mixture) | IL-9.5mm |
| Friction Aggregate: | C Surface |
| Quality Management Program: | OCP (HMA Shoulders) |

GENERAL NOTES

THE THICKNESS OF THE HOT-MIX ASPHALT MIXTURE SHOWN ON THE PLANS IS THE NOMINAL THICKNESS. DEVIATIONS FROM THE NOMINAL THICKNESS WILL BE PERMITTED WHEN SUCH DEVIATIONS OCCUR DUE TO IRREGULARITIES IN THE EXISTING SURFACE OR BASE ON WHICH THE HOT-MIX ASPHALT MIXTURE IS PLACED.

UNLESS OTHERWISE DIRECTED BY THE ENGINEER, RESURFACING SHALL BE PLACED IN A SEQUENCE THAT WILL MINIMIZE THE TIME THE CENTERLINE EDGE IS EXPOSED TO TRAFFIC. WHEN AT THE END OF A DAY'S OPERATION THE EXPOSED CENTERLINE EDGE IS GREATER THAN 2,000 FT., THE CONTRACTOR SHALL BE REQUIRED TO PAVE IN THE ADJACENT LANE ON THE FOLLOWING WORK DAY. PRIOR TO WINTER SHUT DOWN, RESURFACING ON ADJACENT LANES IS TO BE BROUGHT UP TO THE SAME ELEVATION.

FACTORS USED FOR ESTIMATING PLAN QUANTITIES ARE AS FOLLOWS AND SHALL NOT BE USED FOR THE BASIS OF FINAL QUANTITIES:

| | |
|---------------------|------------------|
| ALL HOT-MIX ASPHALT | 2.016 TONS/CU YD |
| ALL AGGREGATE | 2.05 TONS/CU YD |
| RIP RAP | 1.5 TONS/CU YD |

THE QUANTITY OF SHORT TERM PAVEMENT MARKING SHOWN IN THE PLANS IS BASED ON ONE APPLICATION EACH FOR THE HMA SURFACE REMOVAL, SURFACE COURSE, AND BINDER COURSE.

QUANTITIES SHOWN IN THE PLANS FOR PATCHING ARE ESTIMATES. THE ACTUAL AMOUNT OF PATCHING REQUIRED SHALL BE DETERMINED BY THE ENGINEER.

THE CONTRACTOR SHALL STAMP STATIONING IN THE HOT-MIX ASPHALT SURFACE AT 300 FT. INTERVALS ON THE OUTSIDE EDGE OF PAVEMENT AND AS DIRECTED BY THE ENGINEER. THE STATION SYMBOL STAMPS USED SHALL BE FURNISHED BY THE CONTRACTOR. THEY SHALL BE 5 1/2 IN. TALL OF A DESIGN APPROVED BY THE ENGINEER, AND SHALL REMAIN THE PROPERTY OF THE CONTRACTOR.

ATTAINMENT OF PROPER CROWN OR SUPERELEVATION SHALL BE FULLY ACCOMPLISHED WITH THE HOT-MIX ASPHALT SURFACE REMOVAL OR HOT-MIX ASPHALT BINDER COURSE, WHEN SPECIFIED.

IN ADDITION TO THE REQUIREMENTS OF ARTICLE 107.16 THE CONTRACTOR SHALL PROTECT THE SURFACE OF ALL BRIDGE DECKS AND BRIDGE APPROACH PAVEMENTS IN A MANNER SATISFACTORY TO THE ENGINEER BEFORE ANY EQUIPMENT IS ALLOWED TO CROSS THE STRUCTURE. PROTECTION SHALL BE PROVIDED FOR ALL EQUIPMENT AS DEFINED IN ARTICLE 101.16 REGARDLESS IF TRACK MOUNTED OR WHEELED

EXISTING PIPE UNDERDRAIN OUTLETS IN THE FORESLOPES OR MEDIAN SLOPES SHALL BE PRESERVED AND PROTECTED DURING CONSTRUCTION. ANY DAMAGE TO AN UNDERDRAIN OUTLET RESULTING FROM THE CONSTRUCTION ACTIVITY SHALL BE REPAIRED AT THE CONTRACTOR'S EXPENSE.

PRIOR TO PLACEMENT OF THE FINAL PAVEMENT MARKINGS THE RESIDENT ENGINEER SHOULD CONTACT THE BUREAU OF OPERATIONS AND ARRANGE FOR INSPECTION AND APPROVAL OF THE PAVEMENT MARKING LAYOUT.

COMMITMENTS: NONE

MTD CROSSING RESTRICTIONS TABLE

| SN & CENTERLINE STATION ROUTE (I-57) | EXISTING FILL HEIGHT OVER BOX CULVERT | THICKNESS OF EXISTING PAVEMENT OVER BOX CULVERT | MTD CROSSING RESTRICTIONS |
|--------------------------------------|---------------------------------------|---|---------------------------|
| | FOOT | FOOT | |
| SN 041-7047 (STA. 1139+00) | 15.8 | 1' - 1" | PENDING |
| SN 041-7048 (STA. 1217+50) | 4.2 | 1' - 1" | PENDING |
| SN 041-0014 (STA. 1239+78.86) | N/A | N/A | PENDING |
| SN 041-0015 (STA. 1239+78.86) | N/A | N/A | PENDING |
| SN 041-0016 (STA. 1252+77.71) | N/A | N/A | PENDING |
| SN 041-0017 (STA. 1252+77.71) | N/A | N/A | PENDING |
| SN 041-7096 (STA. 1268+20) | 6 | 1' - 1" | PENDING |

SUMMARY OF QUANTITIES

JEFFERSON
FAI 57 (I-57)
90/10 FED/STATE
RURAL
ROADWAY
0005

| CODE NUMBER | ITEM DESCRIPTION | UNIT | QUANTITY |
|-------------|---|-------|----------|
| 25000200 | SEEDING, CLASS 2 | ACRE | 0.75 |
| 25000350 | SEEDING, CLASS 7 | ACRE | 0.75 |
| 25000400 | NITROGEN FERTILIZER NUTRIENT | POUND | 134 |
| 25000500 | PHOSPHORUS FERTILIZER NUTRIENT | POUND | 67 |
| 25000600 | POTASSIUM FERTILIZER NUTRIENT | POUND | 67 |
| 25000700 | AGRICULTURAL GROUND LIMESTONE | TON | 1.5 |
| 25100115 | MULCH, METHOD 2 | ACRE | 1.5 |
| 28000250 | TEMPORARY EROSION CONTROL SEEDING | POUND | 223 |
| 28100207 | STONE RIPRAP, CLASS A4 | TON | 578 |
| 40600275 | BITUMINOUS MATERIALS (PRIME COAT) | POUND | 53,106 |
| 40600285 | POLYMERIZED BITUMINOUS MATERIALS (PRIME COAT) | POUND | 102,062 |
| 40600982 | HOT-MIX ASPHALT SURFACE REMOVAL - BUTT JOINT | SQ YD | 6,166 |
| 40600990 | TEMPORARY RAMP | SQ YD | 1,262 |

SUMMARY OF QUANTITIES - CONT

JEFFERSON
 FAI 57 (I-57)
 90/10 FED/STATE
 RURAL
 ROADWAY
 0005

| CODE NUMBER | ITEM DESCRIPTION | UNIT | QUANTITY |
|-------------|---|-------|----------|
| 40603243 | POLYMERIZED HOT-MIX ASPHALT BINDER COURSE, IL-19.0, FG, N90 | TON | 17,844 |
| 40603570 | POLYMERIZED HOT-MIX ASPHALT SURFACE COURSE, MIX "E", N90 | TON | 13,506 |
| 40800050 | INCIDENTAL HOT-MIX ASPHALT SURFACING | TON | 64 |
| 44000156 | HOT-MIX ASPHALT SURFACE REMOVAL, 1 3/4" | SO YD | 138,611 |
| 44200610 | CLASS A PATCHES, TYPE II, 13 INCH | SO YD | 250 |
| 44200612 | CLASS A PATCHES, TYPE III, 13 INCH | SO YD | 120 |
| 44200614 | CLASS A PATCHES, TYPE IV, 13 INCH | SO YD | 387 |
| 44200994 | CLASS B PATCHES, TYPE II, 12 INCH | SO YD | 196 |
| 44200998 | CLASS B PATCHES, TYPE III, 12 INCH | SO YD | 89 |
| 44201000 | CLASS B PATCHES, TYPE IV, 12 INCH | SO YD | 178 |
| 44201299 | DOWEL BARS 1 1/2" | EACH | 812 |
| 44213000 | PATCHING REINFORCEMENT | SO YD | 757 |
| 44213100 | PAVEMENT FABRIC | SO YD | 267 |

SUMMARY OF QUANTITIES - CONT

JEFFERSON
FAI 57 (I-57)
90/10 FED/STATE
RURAL
ROADWAY
0005

| CODE NUMBER | ITEM DESCRIPTION | UNIT | QUANTITY |
|-------------|--|-------|----------|
| 44213200 | SAW CUTS | FOOT | 4,968 |
| 44213204 | TIE BARS 3/4" | EACH | 151 |
| 48102100 | AGGREGATE WEDGE SHOULDER, TYPE B | TON | 2,526 |
| 48203100 | HOT-MIX ASPHALT SHOULDERS | TON | 14,073 |
| 50300255 | CONCRETE SUPERSTRUCTURE | CU YD | 6 |
| 50800205 | REINFORCEMENT BARS, EPOXY COATED | POUND | 1,615 |
| 60600605 | CONCRETE CURB, TYPE B | FOOT | 90 |
| * 63000001 | STEEL PLATE BEAM GUARDRAIL, TYPE A, 6 FOOT POSTS | FOOT | 5,561 |
| * 63100045 | TRAFFIC BARRIER TERMINAL, TYPE 2 | EACH | 4 |
| * 63100085 | TRAFFIC BARRIER TERMINAL, TYPE 6 | EACH | 6 |
| * 63100089 | TRAFFIC BARRIER TERMINAL, TYPE 6B | EACH | 12 |
| * 63100167 | TRAFFIC BARRIER TERMINAL, TYPE 1 (SPECIAL) TANGENT | EACH | 14 |
| 63200310 | GUARDRAIL REMOVAL | FOOT | 5,966 |

13

* SPECIALTY ITEM

SUMMARY OF QUANTITIES - CONT

| |
|-----------------|
| JEFFERSON |
| FAI 57 (I-57) |
| 90/10 FED/STATE |
| RURAL |
| ROADWAY |
| 0005 |

| CODE NUMBER | ITEM DESCRIPTION | UNIT | QUANTITY |
|-------------|---|--------|----------|
| 63500105 | DELINEATORS | EACH | 222 |
| 64200116 | SHOULDER RUMBLE STRIPS, 16 INCH | FOOT | 103,689 |
| 67000400 | ENGINEER'S FIELD OFFICE, TYPE A | CAL MO | 9 |
| 67100100 | MOBILIZATION | L SUM | 1 |
| 70100420 | TRAFFIC CONTROL AND PROTECTION, STANDARD 701411 | EACH | 4 |
| 70100700 | TRAFFIC CONTROL AND PROTECTION, STANDARD 701406 | L SUM | 1 |
| 70100800 | TRAFFIC CONTROL AND PROTECTION, STANDARD 701401 | L SUM | 1 |
| 70100820 | TRAFFIC CONTROL AND PROTECTION, STANDARD 701451 | L SUM | 1 |
| 70100825 | TRAFFIC CONTROL AND PROTECTION, STANDARD 701456 | L SUM | 1 |
| 70106800 | CHANGEABLE MESSAGE SIGN | CAL MO | 6 |
| 70300100 | SHORT TERM PAVEMENT MARKING | FOOT | 19,756 |
| 70300220 | TEMPORARY PAVEMENT MARKING - LINE 4" | FOOT | 118,558 |
| 70300250 | TEMPORARY PAVEMENT MARKING - LINE 8" | FOOT | 1,818 |

SUMMARY OF QUANTITIES - CONT

| |
|-----------------|
| JEFFERSON |
| FAI 57 (I-57) |
| 90/10 FED/STATE |
| RURAL |
| ROADWAY |
| 0005 |

| CODE NUMBER | ITEM DESCRIPTION | UNIT | QUANTITY |
|-------------|---|-------|----------|
| 70300280 | TEMPORARY PAVEMENT MARKING - LINE 24" | FOOT | 36 |
| 70301000 | WORK ZONE PAVEMENT MARKING REMOVAL | SQ FT | 47,396 |
| * 78000200 | THERMOPLASTIC PAVEMENT MARKING - LINE 4" | FOOT | 118,558 |
| * 78000500 | THERMOPLASTIC PAVEMENT MARKING - LINE 8" | FOOT | 1,818 |
| * 78000650 | THERMOPLASTIC PAVEMENT MARKING - LINE 24" | FOOT | 36 |
| * 78004230 | PREFORMED PLASTIC PAVEMENT MARKING, TYPE B - INLAID - LINE 6" | FOOT | 13,386 |
| * 78100100 | RAISED REFLECTIVE PAVEMENT MARKER | EACH | 794 |
| * 78200410 | GUARDRAIL MARKERS, TYPE A | EACH | 98 |
| * 78201000 | TERMINAL MARKER - DIRECT APPLIED | EACH | 14 |
| 78300200 | RAISED REFLECTIVE PAVEMENT MARKER REMOVAL | EACH | 794 |
| X0322278 | RODENT SHIELDS | EACH | 132 |
| Z0005880 | BRIDGE HANDRAIL REMOVAL | FOOT | 192 |
| ∅ Z0070600 | TRAINEES | Hour | 500 |
| Z0034105 | MATERIAL TRANSFER DEVICE | TON | 31,350 |
| ∅ Z0070604 | TRAINEES TRAINING PROGRAM GRADUATE | Hour | 500 |

13 * SPECIALTY ITEM ∅ 0042

TYPICAL SECTION
 I-57 MAINLINE
 IN DIRECTION OF TRAFFIC
 (NOT TO SCALE)

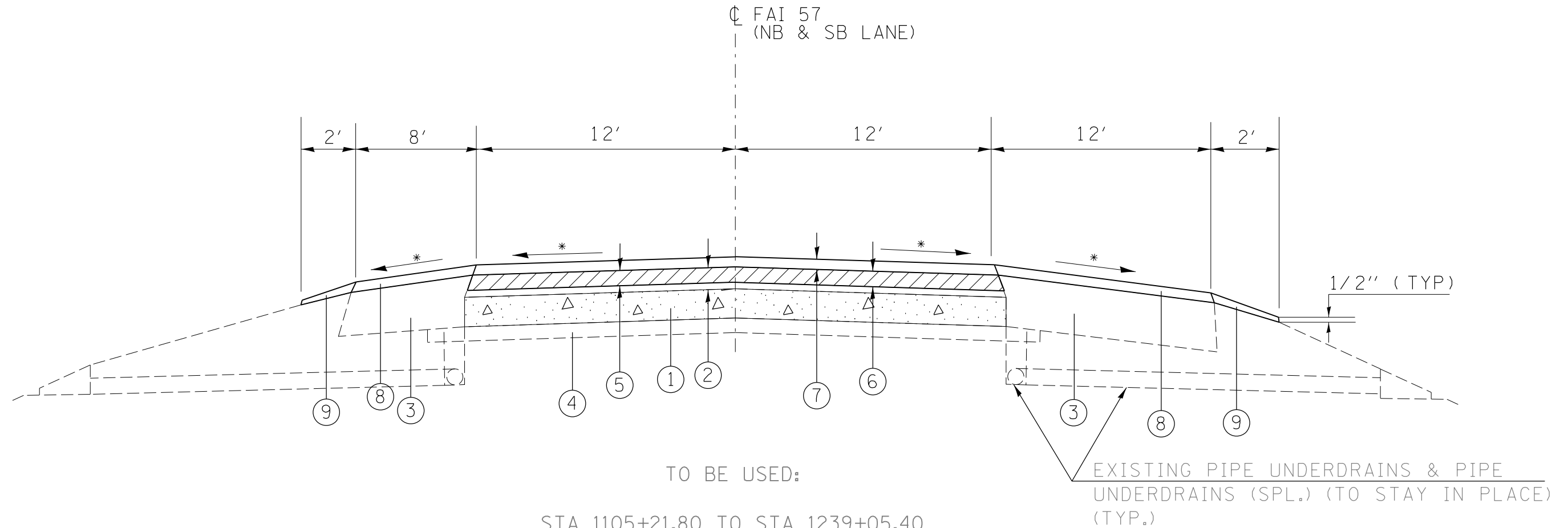

TO BE USED:

STA 1105+21.80 TO STA 1239+05.40
 STA 1240+59.32 TO STA 1251+71.87

* MATCH EXISTING SLOPE

- ① EXISTING CRC PAVEMENT 8"
- ② EXISTING BIT SURFACE AND BINDER (4 1/2")
- ③ EXISTING HMA OVERLAYED BAM SHOULDERS
- ④ EXISTING STABILIZED SUB-BASE (4")
- ⑤ HMA SURFACE REMOVAL, 1 3/4"
- ⑥ POLY. HMA BINDER COURSE, IL-19.0, N90, FG 2 1/4"
- ⑦ POLY. HMA SURFACE COURSE, MIX. E, N90, 1 1/2"
- ⑧ HMA SHOULDERS (2")
- ⑨ AGGREGATE WEDGE SHOULDERS, TY B

| | | | | | | | | | | | | |
|---|------------------------------|------------|-----------|---|---|-------------------|-----------|--------------------|---------|--------|--------------|-----------|
| FILE NAME = | USER NAME = \$USER\$ | DESIGNED - | REVISED - | STATE OF ILLINOIS DEPARTMENT OF TRANSPORTATION | TYPICAL SECTIONS | | | F.A.I. RTE. | SECTION | COUNTY | TOTAL SHEETS | SHEET NO. |
| et:\pw\work\p\idot\rollavr\d0401961\78437 | shite-cvr-soq-index.dgn | DRAWN - | REVISED - | | 1-57 | (41-4,41-4-1)RS-2 | JEFFERSON | 26 | 10 | | | |
| \$MODELNAME\$ | PLOT SCALE = 100.0000' / in. | CHECKED - | REVISED - | | SCALE: SHEET OF SHEETS STA. TO STA. | | | CONTRACT NO. 78437 | | | | |
| | PLOT DATE = 8/22/2014 | DATE - | REVISED - | | ILLINOIS FED. AID PROJECT | | | | | | | |

TYPICAL SECTION
 I-57 MAINLINE
 IN DIRECTION OF TRAFFIC
 (NOT TO SCALE)

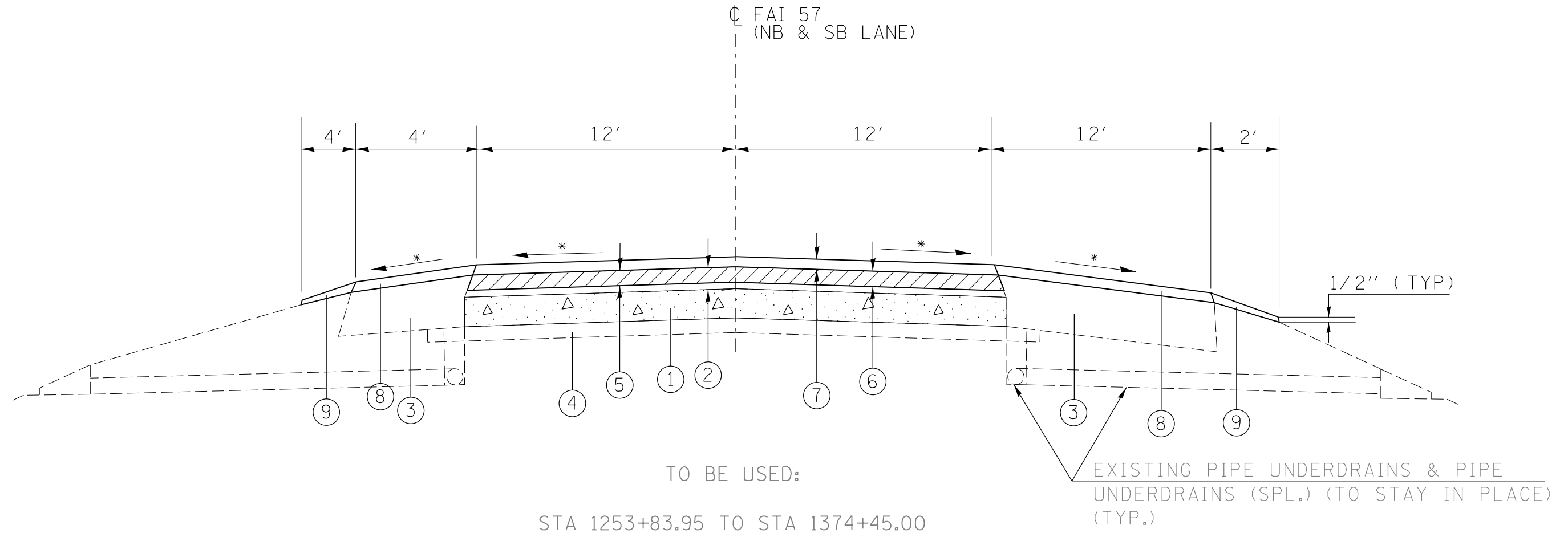

TO BE USED:
 STA 1253+83.95 TO STA 1374+45.00

* MATCH EXISTING SLOPE

- ① EXISTING CRC PAVEMENT 8"
- ② EXISTING BIT SURFACE AND BINDER (4 1/2")
- ③ EXISTING HMA OVERLAYED BAM SHOULDERS
- ④ EXISTING STABILIZED SUB-BASE (4")
- ⑤ HMA SURFACE REMOVAL, 1 3/4"
- ⑥ POLY. HMA BINDER COURSE, IL-19.0, N90, FG 2 1/4"
- ⑦ POLY. HMA SURFACE COURSE, MIX. E, N90, 1 1/2"
- ⑧ HMA SHOULDERS (2")
- ⑨ AGGREGATE WEDGE SHOULDERS, TY B

| | | | | | | | | | | | | | | |
|---|------------------------------|------------|-----------|---|-------------------------|-------|----|--------|---------------------------|---------|----------|--------------|-----------|----|
| FILE NAME = | USER NAME = \$USER\$ | DESIGNED - | REVISED - | STATE OF ILLINOIS DEPARTMENT OF TRANSPORTATION | TYPICAL SECTIONS | | | | F.A.I. RTE. | SECTION | COUNTY | TOTAL SHEETS | SHEET NO. | |
| et:\pw\work\p\idot\rollavr\d0401961\78437 | shite-cvr-soq-index.dgn | DRAWN - | REVISED - | | SCALE: | SHEET | OF | SHEETS | STA. | TO STA. | ILLINOIS | JEFFERSON | 26 | 11 |
| \$MODELNAME\$ | PLOT SCALE = 100.0000' / in. | CHECKED - | REVISED - | | | | | | CONTRACT NO. | 78437 | | | | |
| | PLOT DATE = 8/22/2014 | DATE - | REVISED - | | | | | | ILLINOIS FED. AID PROJECT | | | | | |

TYPICAL SECTION
 I-57 ENTRANCE/EXIT RAMP AT DIX
 IN DIRECTION OF TRAFFIC
 (NOT TO SCALE)

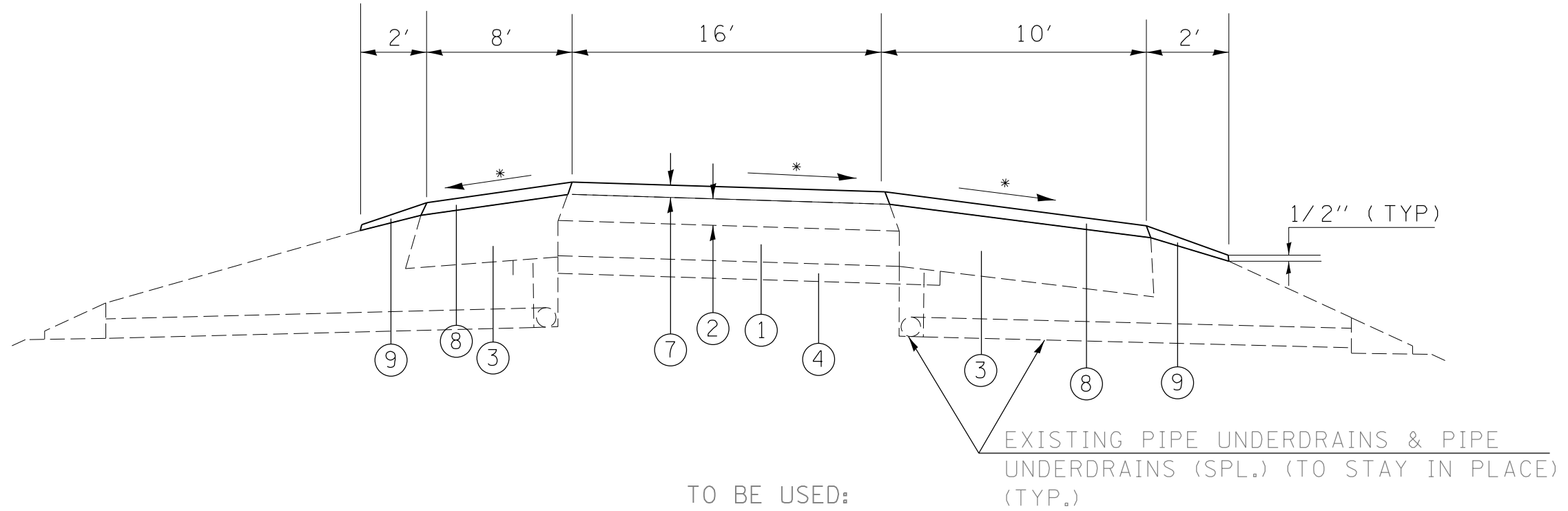

RAMP A STA 88+78.90 TO STA 117+69.93
 RAMP B STA 240+59.82 TO STA 263+84.70
 RAMP C STA 318+83.62 TO STA 338+78.30
 RAMP D STA 427+74.70 TO STA 447+41.44

* MATCH EXISTING SLOPE

- ① EXISTING PCC PAVEMENT 8"
- ② EXISTING HMA SURFACE
- ③ EXISTING STAB. SHOULDERS
- ④ EXISTING STABILIZED SUB-BASE 4"
- ⑤ EXISTING HMA SURFACE COURSE, MIX. E, N90, 2"
- ⑥ HMA SHOULDERS (2")
- ⑦ POLY. HMA SURFACE COURSE, MIX. E, N90, 2"
- ⑧ HMA SHOULDERS (2")
- ⑨ AGGREGATE WEDGE SHOULDERS, TY B

| | | | | | | | | | | | | | | | |
|--|------------------------------|------------|-----------|---|-------------------------|-------|----|----------------|---------|---------|---------------------------|-------------------|-----------|----|----|
| FILE NAME = | USER NAME = \$USER\$ | DESIGNED - | REVISED - | STATE OF ILLINOIS DEPARTMENT OF TRANSPORTATION | TYPICAL SECTIONS | | | F.A.I. RTE. | SECTION | COUNTY | TOTAL SHEETS | SHEET NO. | | | |
| ci:\pw\work\p\idot\rollavr\0401961\78437 | shite-cvr-soq-index.dgn | DRAWN - | REVISED - | | SCALE: | SHEET | OF | SHEETS | STA. | TO STA. | 1-57 | (41-4,41-4-1)RS-2 | JEFFERSON | 26 | 12 |
| \$MODELNAME\$ | PLOT SCALE = 100.0000' / in. | CHECKED - | REVISED - | | | | | | | | CONTRACT NO. 78437 | | | | |
| | PLOT DATE = 8/22/2014 | DATE - | REVISED - | | | | | | | | ILLINOIS FED. AID PROJECT | | | | |

PAVEMENT RESURFACING SCHEDULE

| | | | LENGTH (INFO ONLY) | POLY HMA BINDER COURSE | POLY HMA SURFACE COURSE | HMA SURF REM 1 3/4" | POLY BIT MATLS (PR COAT) | BIT MATLS (PRIME COAT) | TEMP RAMP | HMA SURF REM BUTT JT | HMA SHOULDERS | AGG WEDGE SHLDR, TY B | INCIDENTAL HMA SURFACING |
|--------------------|--------|----------------|------------------------|------------------------------|-------------------------------|---------------------------|---------------------------------|-------------------------------|--------------|----------------------------|------------------|-----------------------------|--------------------------------|
| STA | TO | STA | FEET | TON | TON | SQ YD | LB | LB | SY | SQ YD | TON | TON | TON |
| NB | | | | | | | | | | | | | |
| STA 1105+21.80 | TO STA | 1215+41.25 | 11019.5 | 3702.5 | 2468.4 | 29171.9 | 19835.0 | 11019.5 | 61.1 | 391.1 | 2742.6 | 348.6 | 40.8 |
| EON STA 1215+41.25 | BK = | STA 1215+44.50 | | | | | | | | | | | |
| STA 1215+44.50 | TO STA | 1238+93.67 | 2349.2 | 789.3 | 526.2 | 6041.9 | 4228.5 | 2349.2 | 140.5 | 569.3 | 584.7 | 74.3 | |
| STA 1238+93.67 | TO STA | 1240+47.59 | | | | | | | | | | | |
| STA 1240+47.59 | TO STA | 1251+30.97 | 1083.4 | 364.0 | 242.7 | 2503.3 | 1950.1 | 1083.4 | 237.9 | 876.3 | 269.6 | 34.3 | |
| STA 1251+30.97 | TO STA | 1253+43.97 | | | | | | | | | | | |
| STA 1253+43.97 | TO STA | 1374+45.00 | 12101.0 | 4065.9 | 2710.6 | 31558.3 | 21781.9 | 12101.0 | 157.3 | 711.1 | 2409.4 | 574.2 | 22.8 |
| SB | | | | | | | | | | | | | |
| STA 1105+21.80 | TO STA | 1215+41.25 | 11019.5 | 3702.5 | 2468.4 | 29171.9 | 19835.0 | 11019.5 | 61.1 | 391.1 | 2742.6 | 348.6 | |
| EON STA 1215+41.25 | BK = | STA 1215+44.50 | | | | | | | | | | | |
| STA 1215+44.50 | TO STA | 1239+17.13 | 2372.6 | 797.2 | 531.5 | 6110.0 | 4270.7 | 2372.6 | 125.5 | 524.9 | 590.5 | 75.1 | |
| STA 1239+17.13 | TO STA | 1240+71.05 | | | | | | | | | | | |
| STA 1240+71.05 | TO STA | 1252+11.45 | 1140.4 | 383.2 | 255.4 | 2710.3 | 2052.7 | 1140.4 | 215.7 | 782.2 | 283.8 | 36.1 | |
| STA 1252+11.45 | TO STA | 1254+24.45 | | | | | | | | | | | |
| STA 1254+24.45 | TO STA | 1374+45.00 | 12020.6 | 4038.9 | 2692.6 | 31343.7 | 21637.0 | 12020.6 | 157.2 | 711.1 | 2393.4 | 570.4 | |
| RAMPS | | | | | | | | | | | | | |
| A STA 88+78.90 | TO STA | 117+69.93 | 2891.0 | | 510.9 | | 2052.7 | | 26.4 | 302.2 | 647.6 | 146.3 | |
| B STA 240+59.82 | TO STA | 263+84.70 | 2324.9 | | 427.3 | | 1716.9 | | 26.4 | 302.2 | 520.8 | 117.7 | |
| C STA 318+83.62 | TO STA | 338+78.30 | 1994.7 | | 364.6 | | 1465.0 | | 26.4 | 302.2 | 446.8 | 101.0 | |
| D STA 427+74.70 | TO STA | 447+41.44 | 1966.7 | | 307.8 | | 1236.5 | | 26.4 | 302.2 | 440.5 | 99.6 | |
| TOTALS | | | | | 17844 | 13506 | 138611 | 102062 | 1262 | 6166 | 14073 | 2526 | 64 |

*INCLUDES QUANTITIES OF HMA SURF REM 1 3/4", TEMP RAMP & HMA SURF REM BUTT JT FOR RAMP PAVEMENT AREA THAT CROSSES STR #041-0014 & 0015

GUARDRAIL SCHEDULE

| LT OR RT* | LOCATION STATION TO STATION | | | GUARDRAIL REMOVAL | SPBGR TYPE A | TRAFFIC BARRIER TERMINAL | | | | CONC CURB TY B 6" | BRIDGE HANDRAIL REMOVAL | CONC SUPER | REINF BARS EPOXY | GUARD-RAIL MRKR | TERM MRKR DIRECT APPLIED | COMMENTS |
|---------------------------|-----------------------------|----|------------|-------------------|----------------|--------------------------|------------|------------|-------------|-------------------|-------------------------|-------------|------------------|-----------------|--------------------------|---|
| | | | | | | TY 1, SPL (TAN) | TY 2 | TY 6 | TY 6B | | | | | | | |
| | STA. | TO | STA. | FOOT | FOOT | EACH | EACH | EACH | EACH | FOOT | FOOT | CU YD | POUNDS | EACH | EACH | |
| SOUTHBOUND I57 "A" | | | | | | | | | | | | | | | | |
| RT | 1157+97.50 | TO | 1160+33.77 | 120.5 | 137.5 | 1 | | 1 | | 15.0 | | | | 4 | 1 | APPROACH, PIER |
| RT | 1238+45.63 | TO | 1239+24.57 | 78.3 | 50.0 | | 1 | | 1 | | 16.0 | 0.49 | 134.6 | 4 | | STR #041-0015, SW CORNER, DEPARTURE |
| LT | 1240+64.93 | TO | 1243+36.20 | 179.0 | 175.0 | 1 | | | 1 | | 16.0 | 0.49 | 134.6 | 4 | 1 | STR #041-0015, NE CORNER, APPROACH |
| RT | 1240+74.57 | TO | 1247+20.84 | 646.3 | 600.0 | | | | 1 | | 16.0 | 0.49 | 134.6 | 8 | | STR #041-0015, NW CORNER, APPROACH, TIE INTO STR #041-0017 |
| RT | 1247+20.84 | TO | 1252+32.77 | 511.9 | 495.5 | | | | 1 | | 16.0 | 0.49 | 134.6 | 6 | | STR #041-0017, SW CORNER, DEPARTURE, TIE INTO STR #041-0015 |
| LT | 1254+06.54 | TO | 1257+27.81 | 224.5 | 225.0 | 1 | | | 1 | | 16.0 | 0.49 | 134.6 | 4 | 1 | STR #041-0017, NE CORNER, APPROACH |
| RT | 1254+40.77 | TO | 1256+99.54 | 260.3 | 162.5 | 1 | | | 1 | | 16.0 | 0.49 | 134.6 | 4 | 1 | STR #041-0017, NW CORNER, APPROACH |
| RT | 1268+07.50 | TO | 1270+68.77 | 144.0 | 162.5 | 1 | | 1 | | 15.0 | | | | 4 | 1 | APPROACH, PIER |
| RT | 1318+07.73 | TO | 1324+12.63 | 603.1 | 537.5 | 1 | 1 | | | | | | | 8 | 1 | CULVERT |
| RT | 1373+12.50 | TO | 1376+98.77 | 374.4 | 287.5 | 1 | | 1 | | 15.0 | | | | 5 | 1 | APPROACH, PIER |
| TOTAL SB LANES | | | | 3142.3 | 2,833.0 | 7 | 2 | 3 | 6 | 45 | 96 | 2.94 | 808 | 51 | 7 | |
| NORTHBOUND I57 "B" | | | | | | | | | | | | | | | | |
| RT | 1155+36.23 | TO | 1157+72.50 | 120.5 | 137.5 | 1 | | 1 | | 15 | | | | 4 | 1 | APPROACH, PIER |
| LT | 1236+25.73 | TO | 1238+97.00 | 179.5 | 175.0 | 1 | | | 1 | | 16 | 0.49 | 134.6 | 4 | 1 | STR #041-0014, SW CORNER, APPROACH |
| RT | 1236+34.23 | TO | 1238+93.00 | 84.2 | 162.5 | 1 | | | 1 | | 16 | 0.49 | 134.6 | 4 | 1 | STR #041-0014, SE CORNER, APPROACH |
| RT | 1240+44.25 | TO | 1244+71.42 | 428.9 | 412.5 | | | | 1 | | 16 | 0.49 | 134.6 | 5 | | STR #041-0014, NE CORNER, DEPARTURE, TIE INTO STR #041-0016 |
| RT | 1244+71.42 | TO | 1251+21.00 | 649.6 | 603.3 | | | | 1 | | 16 | 0.49 | 134.6 | 8 | | STR #041-0016, SE CORNER, APPROACH, TIE INTO STR #041-0014 |
| LT | 1248+69.73 | TO | 1251+41.00 | 181.3 | 175.0 | 1 | | | 1 | | 16 | 0.49 | 134.6 | 4 | 1 | STR #041-0016, SW CORNER, APPROACH |
| RT | 1253+29.00 | TO | 1257+07.94 | 372.5 | 350.0 | | 1 | | 1 | | 16 | 0.49 | 134.6 | 5 | | STR #041-0016, NE CORNER, DEPARTURE |
| RT | 1264+99.73 | TO | 1267+61.00 | 131.5 | 162.5 | 1 | | 1 | | 15 | | | | 4 | 1 | APPROACH, PIER |
| RT | 1320+42.38 | TO | 1323+72.27 | 302.2 | 262.5 | 1 | 1 | | | | | | | 4 | 1 | CULVERT |
| RT | 1369+12.23 | TO | 1372+98.50 | 373.2 | 287.5 | 1 | | 1 | | 15 | | | | 5 | 1 | APPROACH, PIER |
| TOTAL NB LANES | | | | 2823.4 | 2728.3 | 7 | 2 | 3 | 6 | 45 | 96 | 3 | 808 | 47 | 7 | |
| TOTAL = | | | | 5965.7 | 5561.3 | 14.0 | 4.0 | 6.0 | 12.0 | 90.0 | 192.0 | 5.9 | 1615.2 | 97.9 | 14.0 | |

*RIGHT OR LEFT IS BASED ON DIRECTION OF TRAVEL

PAVEMENT MARKING SCHEDULE

| STA | TO | STA | THERMOPLASTIC | | | | PREFORMED PLASTIC | SHORT TERM PVMT MARK | TEMP PVMT MARK 4" | TEMP PVMT MARK 8" | TEMP PVMT MARK 24"* | WORK ZONE PVT MK REM SQ FT | RAISED REFL PVT MARK EACH | RAISED REFL PVT MKR REM EACH | DELINEATORS EACH | SHLDR RUMBLE STRIPS 16" FT |
|---------------------|-------------------|-----|----------------|-----------------|----------------|-----------------|-------------------|----------------------|-------------------|-------------------|---------------------|----------------------------|---------------------------|------------------------------|------------------|----------------------------|
| | | | LINE - 4" | | LINE - 8" | LINE-24" | LINE - 6" | | | | | | | | | |
| | | | WHITE SOLID FT | YELLOW SOLID FT | WHITE SOLID FT | WHITE SOLID* FT | WHITE SKIP FT | | | | | | | | | |
| NB | | | | | | | | | | | | | | | | |
| STA 105+21.80 | TO STA 1215+41.25 | | 11020 | 11020 | | 18 | 2755 | 3967 | 22040 | | 18 | 8706 | 138 | 138 | 28 | 22039 |
| EON STA 215+41.25 | BK=STA1215+44.50 | AH | | | | | | | | | | | | | | |
| STA 215+44.50 | TO STA 1238+93.67 | | 1381 | 2350 | 403 | | 587 | 846 | 3731 | 403 | | 1795 | 30 | 30 | 3 | 3731 |
| STA 238+93.67 | TO STA 1240+47.59 | GAP | | | | | | | | | | | | | | |
| STA 240+47.59 | TO STA 1251+30.97 | | 1084 | 1084 | | | 271 | 390 | 2168 | | | 853 | 14 | 14 | 3 | 2167 |
| STA 251+30.97 | TO STA 1253+43.97 | GAP | | | | | | | | | | | | | | |
| STA 253+43.97 | TO STA 1374+45.00 | | 12102 | 12102 | | | 3025 | 4356 | 24204 | | | 9521 | 152 | 152 | 30 | 24202 |
| SB | | | | | | | | | | | | | | | | |
| STA 105+21.80 | TO STA 1215+41.25 | | 11020 | 11020 | | 18 | 2755 | 3967 | 22040 | | 18 | 8706 | 138 | 138 | 28 | 22039 |
| EON STA 215+41.25 | BK=STA1215+44.50 | AH | | | | | | | | | | | | | | |
| STA 215+44.50 | TO STA 1239+17.13 | | 816 | 2373 | 383 | | 593 | 854 | 3189 | 383 | | 1604 | 30 | 30 | 2 | 3189 |
| STA 239+17.13 | TO STA 1240+71.05 | GAP | | | | | | | | | | | | | | |
| STA 240+71.05 | TO STA 1252+11.45 | | 1141 | 1141 | | | 285 | 411 | 2282 | | | 898 | 15 | 15 | 3 | 2281 |
| STA 252+11.45 | TO STA 1254+24.45 | GAP | | | | | | | | | | | | | | |
| STA 254+24.45 | TO STA 1374+45.00 | | 12021 | 12021 | | | 3005 | 4327 | 24042 | | | 9457 | 151 | 151 | 30 | 24041 |
| RAMPS | | | | | | | | | | | | | | | | |
| STA 88+78.90 | TO STA 117+69.93 | A | 2892 | 1784 | 145 | | 70 | 215 | 4676 | 145 | | 1727 | | | 28 | |
| STA 240+59.82 | TO STA 263+84.70 | B | 2325 | 1692 | 383 | | | 161 | 4017 | 383 | | 1648 | 61 | 61 | 27 | |
| STA 318+83.62 | TO STA 338+78.30 | C | 1995 | 1303 | 404 | | | 132 | 3298 | 404 | | 1413 | 65 | 65 | 20 | |
| STA 427+74.70 | TO STA 447+41.44 | D | 1967 | 904 | 100 | | 39 | 130 | 2871 | 100 | | 1068 | | | 21 | |
| RURAL TOTALS | | | 59764 | 58794 | 1818 | 36 | 13386 | 19756 | 118558 | 1818 | 36 | 47396 | 794 | 794 | 222 | 103689 |

118558

*STATE POLICE SPEED MEASUREMENTS MUST BE PLACED EXACT LOCATION OF THE EXISTING MARKINGS

PAVED DITCH REMOVAL SCHEDULE

| LOCATION | | | ACTUAL LENGTH TO BE BROKEN IN PLACE | STONE RIPRAP, CLASS A4 | SEEDING, CLASS 2 | SEEDING, CLASS 7 | NITROGEN | PHOSPHORUS | POTASSIUM | AG GROUND LIMESTONE | MULCH, METHOD 2 | TEMP EROSION CONT SEED | |
|-----------------------|-------|---------|-------------------------------------|------------------------|------------------|------------------|--------------|-------------|-------------|---------------------|-----------------|------------------------|--------------|
| | LT/RT | | FEET | TON | ACRE | ACRE | POUND | POUND | POUND | TON | ACRE | POUND | |
| 1121+14 | TO | 1121+29 | RT | 15 | 8.3 | 0.02 | 0.02 | 3.60 | 1.80 | 1.80 | 0.04 | 0.04 | 6.00 |
| 1121+85 | TO | 1122+90 | LT | 105 | 58.3 | 0.07 | 0.07 | 13.02 | 6.51 | 6.51 | 0.14 | 0.14 | 21.69 |
| 1210+74 | TO | 1210+92 | RT | 19 | 10.6 | 0.02 | 0.02 | 3.60 | 1.80 | 1.80 | 0.04 | 0.04 | 6.00 |
| 1213+44 | TO | 1213+81 | RT | 38 | 21.1 | 0.03 | 0.03 | 4.71 | 2.36 | 2.36 | 0.05 | 0.05 | 7.85 |
| 1215+95 | TO | 1216+56 | LT | 63 | 35.0 | 0.04 | 0.04 | 7.81 | 3.90 | 3.90 | 0.09 | 0.09 | 13.02 |
| 1267+82 | TO | 1268+41 | RT | 62 | 34.4 | 0.04 | 0.04 | 7.69 | 3.84 | 3.84 | 0.09 | 0.09 | 12.81 |
| 1270+81 | TO | 1271+42 | LT | 61 | 33.9 | 0.04 | 0.04 | 7.56 | 3.78 | 3.78 | 0.08 | 0.08 | 12.60 |
| 1272+59 | TO | 1273+74 | RT | 117 | 65.0 | 0.08 | 0.08 | 14.50 | 7.25 | 7.25 | 0.16 | 0.16 | 24.17 |
| 1302+78 | TO | 1303+34 | LT | 57 | 31.7 | 0.04 | 0.04 | 7.07 | 3.53 | 3.53 | 0.08 | 0.08 | 11.78 |
| 1304+35 | TO | 1307+11 | RT | 276 | 153.3 | 0.20 | 0.20 | 36.00 | 18.00 | 18.00 | 0.40 | 0.40 | 60.00 |
| 1325+36 | TO | 1326+19 | RT | 82 | 45.6 | 0.06 | 0.06 | 10.17 | 5.08 | 5.08 | 0.11 | 0.11 | 16.94 |
| 1344+44 | TO | 1345+13 | RT | 69 | 38.3 | 0.05 | 0.05 | 8.55 | 4.28 | 4.28 | 0.10 | 0.10 | 14.26 |
| | | RAMP B | LT | 76 | 42.2 | 0.05 | 0.05 | 9.42 | 4.71 | 4.71 | 0.10 | 0.10 | 15.70 |
| PROJECT TOTALS | | | | 577.8 | 0.75 | 0.75 | 134.0 | 67.0 | 67.0 | 67.0 | 1.5 | 1.5 | 222.9 |

RODENT SHEILD SCHEDULE

| | | | RODENT SHEILDS | |
|--------------------|------|----------------|----------------|---------------|
| STA | TO | STA | EACH | |
| | | | MEDIAN SHLDR | OUTSIDE SHLDR |
| NB | | | | |
| STA 1105+21.80 | TO | STA 1215+41.25 | 19 | 7 |
| EQN STA 1215+41.25 | BK = | STA 1215+44.50 | AH | |
| STA 1215+44.50 | TO | STA 1238+93.67 | 5 | 5 |
| STA 1238+93.67 | TO | STA 1240+47.59 | GAP | |
| STA 1240+47.59 | TO | STA 1251+30.97 | 2 | 1 |
| STA 1251+30.97 | TO | STA 1253+43.97 | GAP | |
| STA 1253+43.97 | TO | STA 1374+45.00 | 15 | 8 |
| SB | | | | |
| STA 1105+21.80 | TO | STA 1215+41.25 | 14 | 7 |
| EQN STA 1215+41.25 | BK = | STA 1215+44.50 | AH | |
| STA 1215+44.50 | TO | STA 1239+17.13 | 5 | 2 |
| STA 1239+17.13 | TO | STA 1240+71.05 | GAP | |
| STA 1240+71.05 | TO | STA 1252+11.45 | 1 | 1 |
| STA 1252+11.45 | TO | STA 1254+24.45 | GAP | |
| STA 1254+24.45 | TO | STA 1374+45.00 | 19 | 12 |
| RAMPS | | | | |
| A STA 88+78.90 | TO | STA 117+69.93 | 1 | 1 |
| B STA 240+59.82 | TO | STA 263+84.70 | 1 | |
| C STA 318+83.62 | TO | STA 338+78.30 | | 1 |
| D STA 427+74.70 | TO | STA 447+41.44 | 1 | 1 |
| TOTAL | | | 129 | |

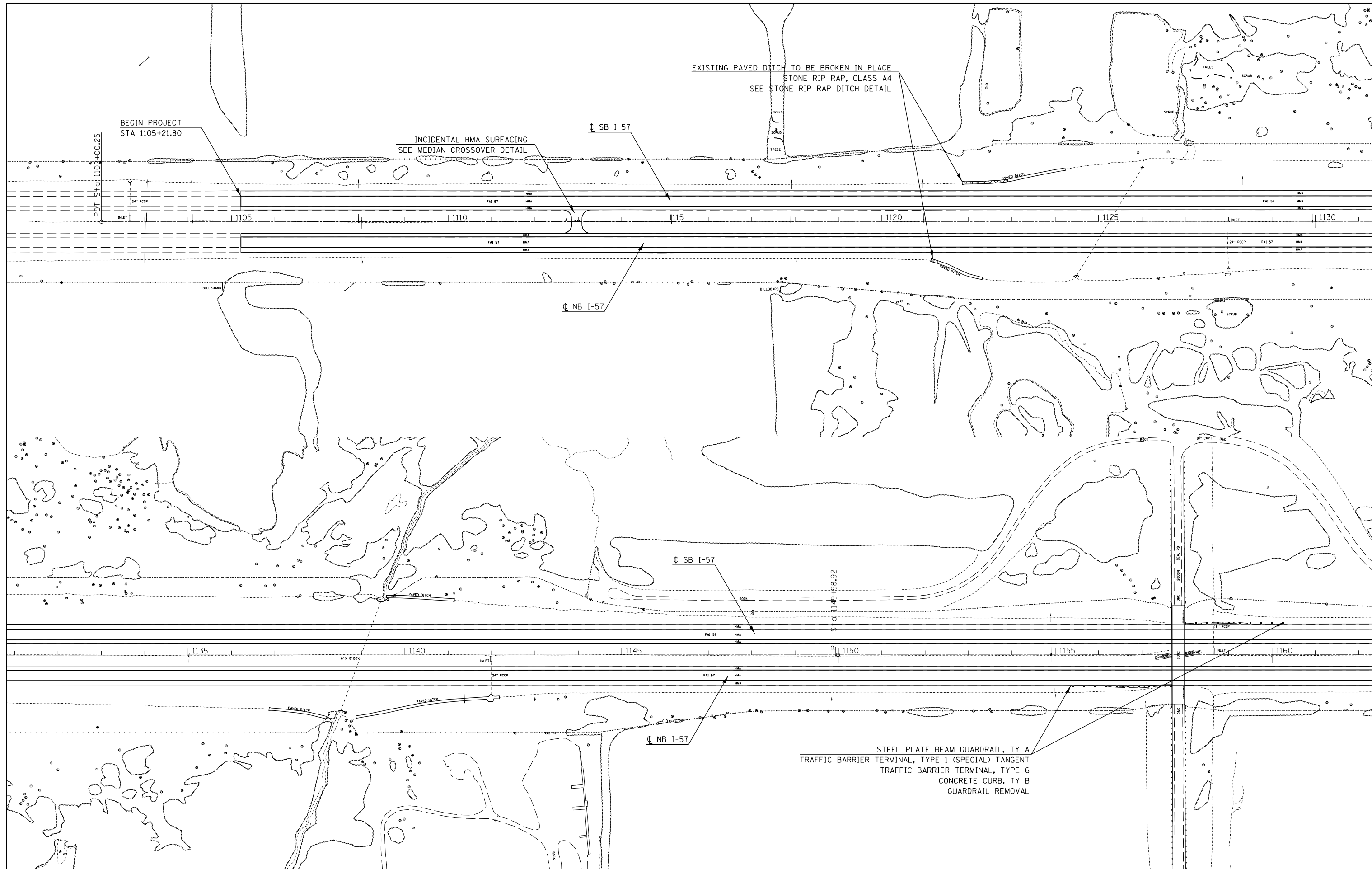

| | | | |
|--|------------------------------|------------|-----------|
| FILE NAME = | USER NAME = \$USER* | DESIGNED - | REVISED - |
| et:\pwork\pwork\rollavr\d0401961\78437 | shc-pln1.dgn | DRAWN - | REVISED - |
| | PLOT SCALE = 200.0000' / in. | CHECKED - | REVISED - |
| #MODELNAME# | PLOT DATE = 8/22/2014 | DATE - | REVISED - |

**STATE OF ILLINOIS
DEPARTMENT OF TRANSPORTATION**

**PLAN I-57
STA 1105+21.80 TO STA 1162+00**

SCALE: SHEET OF SHEETS STA. TO STA.

| | | | | |
|---------------------------|-------------------|-----------|--------------|-----------|
| F.A.I. RTE. | SECTION | COUNTY | TOTAL SHEETS | SHEET NO. |
| I-57 | (41-4,41-4-1)RS-2 | JEFFERSON | 26 | 17 |
| CONTRACT NO. 78437 | | | | |
| ILLINOIS FED. AID PROJECT | | | | |

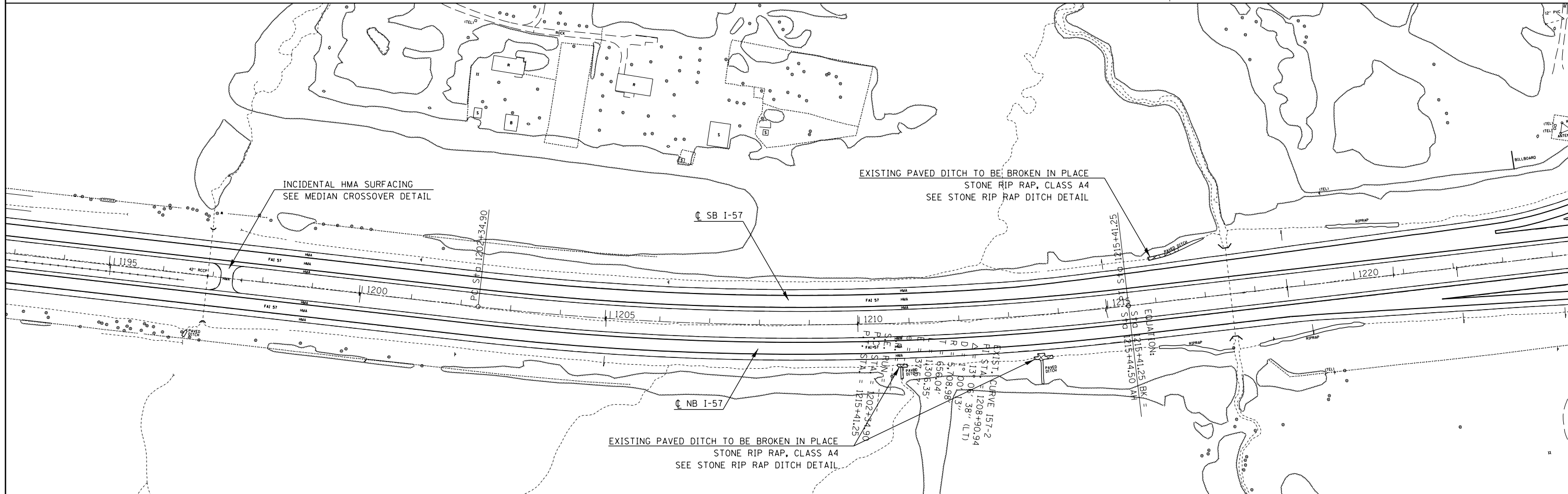
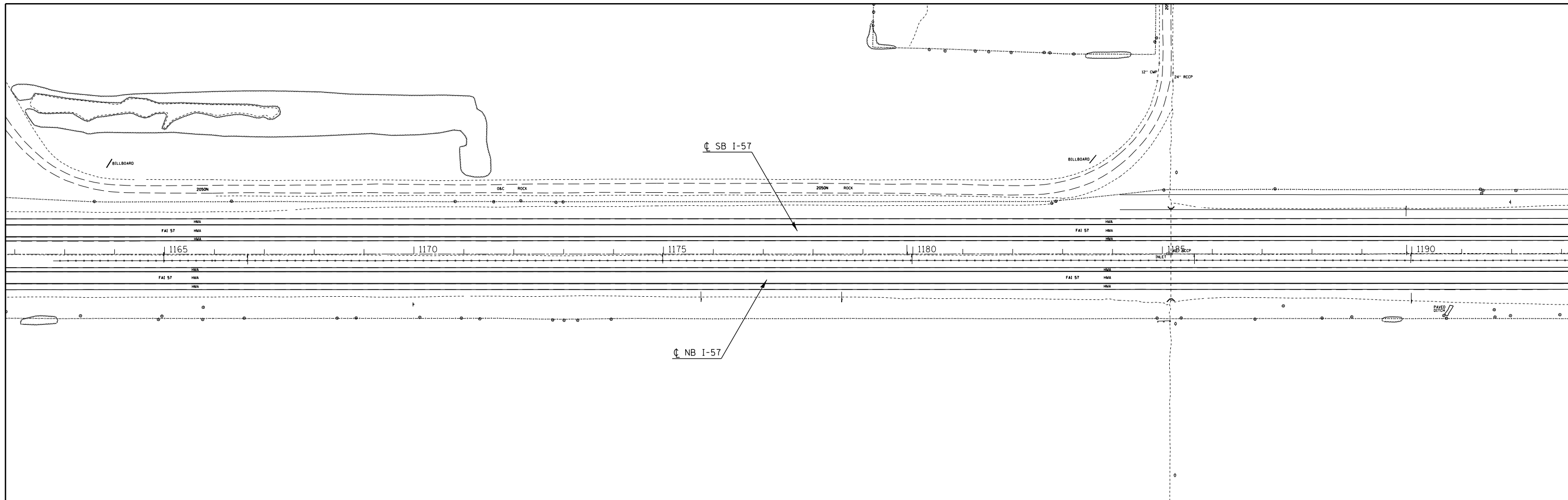

| | | | |
|--|------------------------------|------------|-----------|
| FILE NAME = | USER NAME = \$USER\$ | DESIGNED - | REVISED - |
| ei:\pw_work\p1dot\rollavr\d0401961\78437 | shite.pln1.dgn | DRAWN - | REVISED - |
| | PLOT SCALE = 200.0000' / in. | CHECKED - | REVISED - |
| #MODELNAME# | PLOT DATE = 8/22/2014 | DATE - | REVISED - |

**STATE OF ILLINOIS
DEPARTMENT OF TRANSPORTATION**

**PLAN I-57
STA 1162+00 TO STA 1224+00**

SCALE: SHEET OF SHEETS STA. TO STA.

| F.A.I. RTE. | SECTION | COUNTY | TOTAL SHEETS | SHEET NO. |
|--------------------|-------------------|-----------|---------------------------|-----------|
| I-57 | (41-4,41-4-1)RS-2 | JEFFERSON | 26 | 18 |
| CONTRACT NO. 78437 | | | ILLINOIS FED. AID PROJECT | |

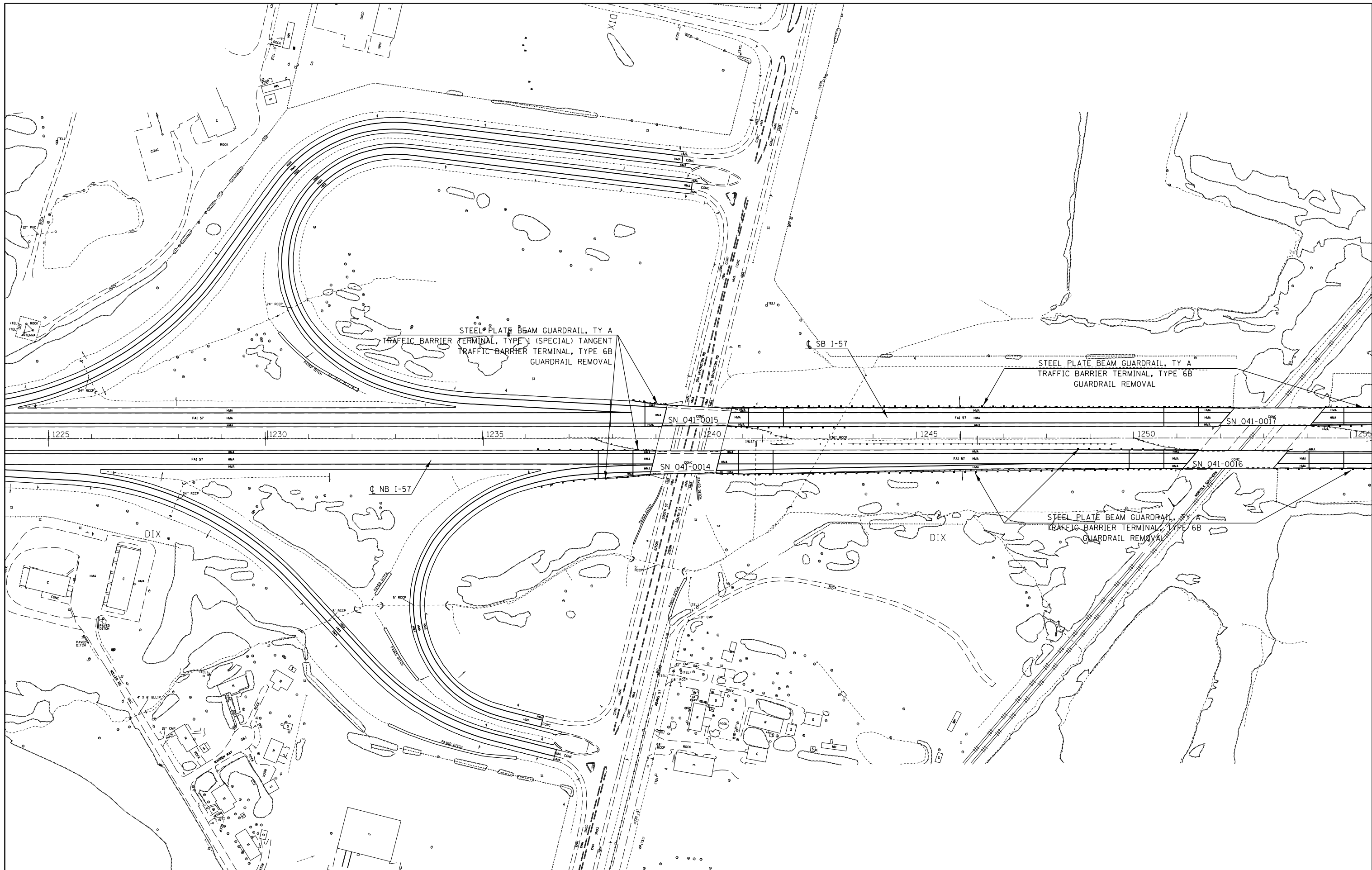

| | | | |
|-------------------------------------|------------------------------|------------|-----------|
| FILE NAME = | USER NAME = \$USER\$ | DESIGNED - | REVISED - |
| ei:\pwork\pwork\11avr\0401961\78437 | shite.pln1.dgn | DRAWN - | REVISED - |
| \$MODELNAME\$ | PLOT SCALE = 200.0000' / in. | CHECKED - | REVISED - |
| | PLOT DATE = 8/22/2014 | DATE - | REVISED - |

**STATE OF ILLINOIS
DEPARTMENT OF TRANSPORTATION**

**PLAN I-57
STA 1224+00 TO STA 1255+00**

SCALE: SHEET OF SHEETS STA. TO STA.

| F.A.I. RTE. | SECTION | COUNTY | TOTAL SHEETS | SHEET NO. |
|---------------------------|-------------------|-----------|--------------------|-----------|
| I-57 | (41-4,41-4-1)RS-2 | JEFFERSON | 26 | 19 |
| | | | CONTRACT NO. 78437 | |
| ILLINOIS FED. AID PROJECT | | | | |

STEEL PLATE BEAM GUARDRAIL, TY A
 TRAFFIC BARRIER TERMINAL, TYPE 1 (SPECIAL) TANGENT
 CONCRETE CURB, TY B
 GUARDRAIL REMOVAL

CL SB I-57

STEEL PLATE BEAM GUARDRAIL, TY A
 TRAFFIC BARRIER TERMINAL, TYPE 1 (SPECIAL) TANGENT
 TRAFFIC BARRIER TERMINAL, TYPE 6B
 GUARDRAIL REMOVAL

CL NB I-57

EXISTING PAVED DITCH TO BE BROKEN IN PLACE
 STONE RIP RAP, CLASS A4
 SEE STONE RIP RAP DITCH DETAIL

EXISTING PAVED DITCH TO BE BROKEN IN PLACE
 STONE RIP RAP, CLASS A4
 SEE STONE RIP RAP DITCH DETAIL

CL SB I-57

EXISTING PAVED DITCH TO BE BROKEN IN PLACE
 STONE RIP RAP, CLASS A4
 SEE STONE RIP RAP DITCH DETAIL

CL NB I-57

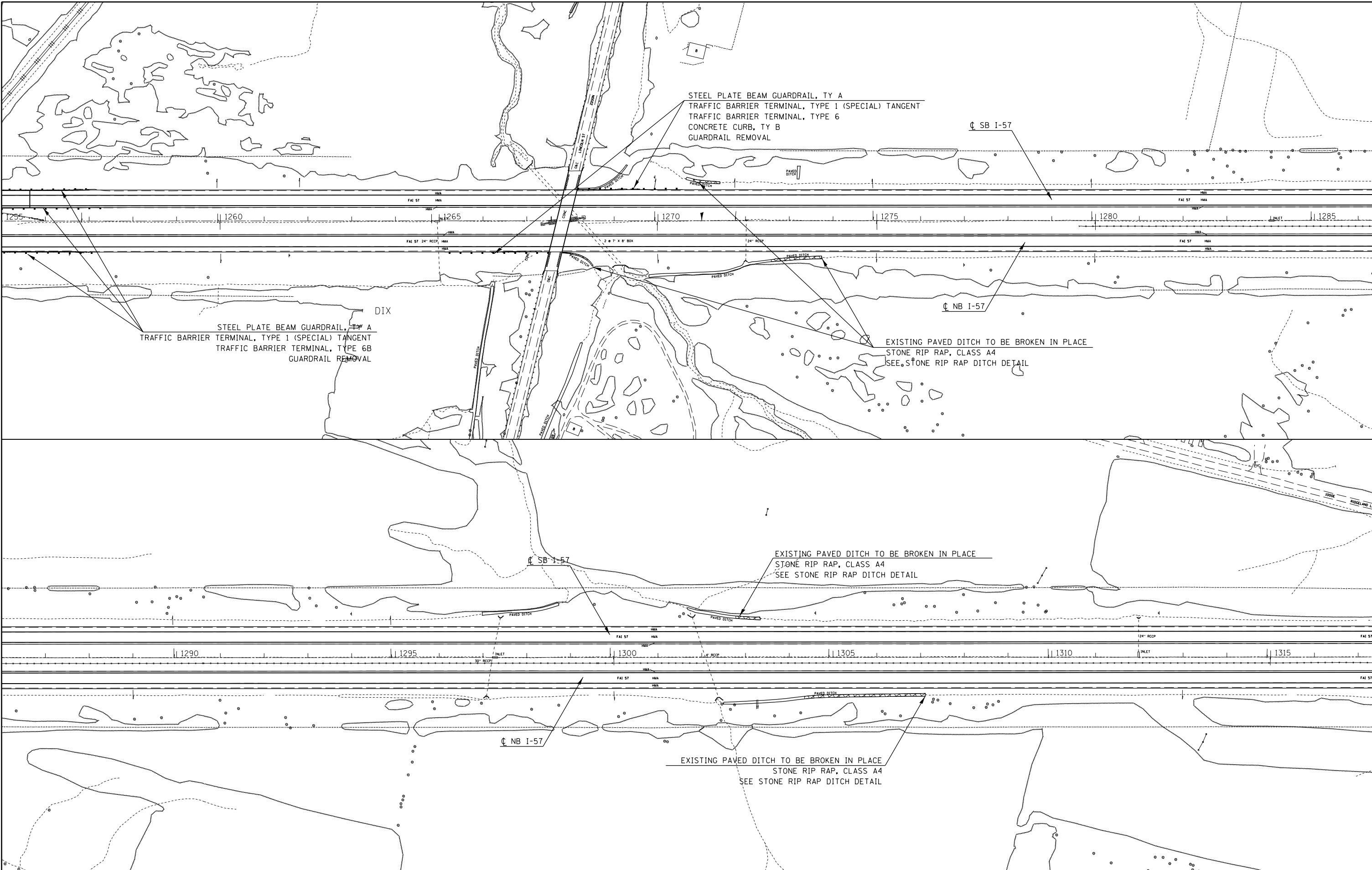

| | | | |
|--------------------------------------|------------------------------|------------|-----------|
| FILE NAME = | USER NAME = \$USER\$ | DESIGNED - | REVISED - |
| ei:\pwork\pwork\11avr\10401961\78437 | shite-pln1.dgn | DRAWN - | REVISED - |
| | PLOT SCALE = 200.0000' / in. | CHECKED - | REVISED - |
| #MODELNAME# | PLOT DATE = 8/22/2014 | DATE - | REVISED - |

**STATE OF ILLINOIS
 DEPARTMENT OF TRANSPORTATION**

**PLAN I-57
 STA 1255+00 TO STA 1317+00**

SCALE: SHEET OF SHEETS STA. TO STA.

| F.A.I. RTE. | SECTION | COUNTY | TOTAL SHEETS | SHEET NO. |
|---------------------------|-------------------|-----------|--------------------|-----------|
| I-57 | (41-4,41-4-1)RS-2 | JEFFERSON | 26 | 20 |
| ILLINOIS FED. AID PROJECT | | | CONTRACT NO. 78437 | |

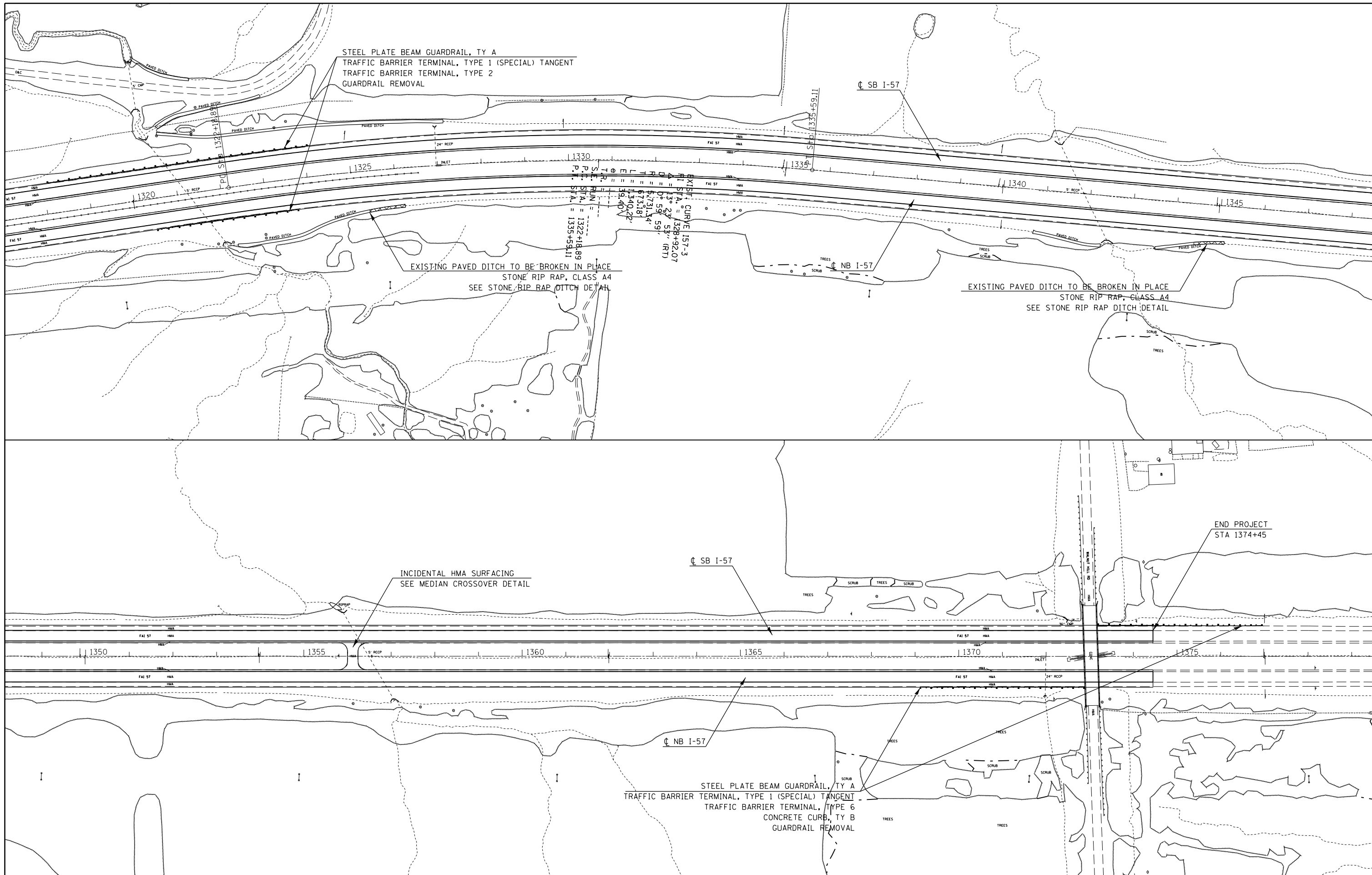

| | | | |
|-------------------------------------|------------------------------|------------|-----------|
| FILE NAME = | USER NAME = \$USER\$ | DESIGNED - | REVISED - |
| ei:\pwork\pwork\11avr\0401961\78437 | shite.pln1.dgn | DRAWN - | REVISED - |
| | PLOT SCALE = 200.0000' / in. | CHECKED - | REVISED - |
| #MODELNAME# | PLOT DATE = 8/22/2014 | DATE - | REVISED - |

**STATE OF ILLINOIS
 DEPARTMENT OF TRANSPORTATION**

**PLAN I-57
 STA 1317+00 TO STA 1374+45**

SCALE: SHEET OF SHEETS STA. TO STA.

| F.A.I. RTE. | SECTION | COUNTY | TOTAL SHEETS | SHEET NO. |
|---------------------------|-------------------|-----------|--------------|-----------|
| I-57 | (41-4,41-4-1)RS-2 | JEFFERSON | 26 | 21 |
| CONTRACT NO. 78437 | | | | |
| ILLINOIS FED. AID PROJECT | | | | |

DETAIL FOR BUTT JOINTS AT
BEGINNING AND ENDING OF PROJECT

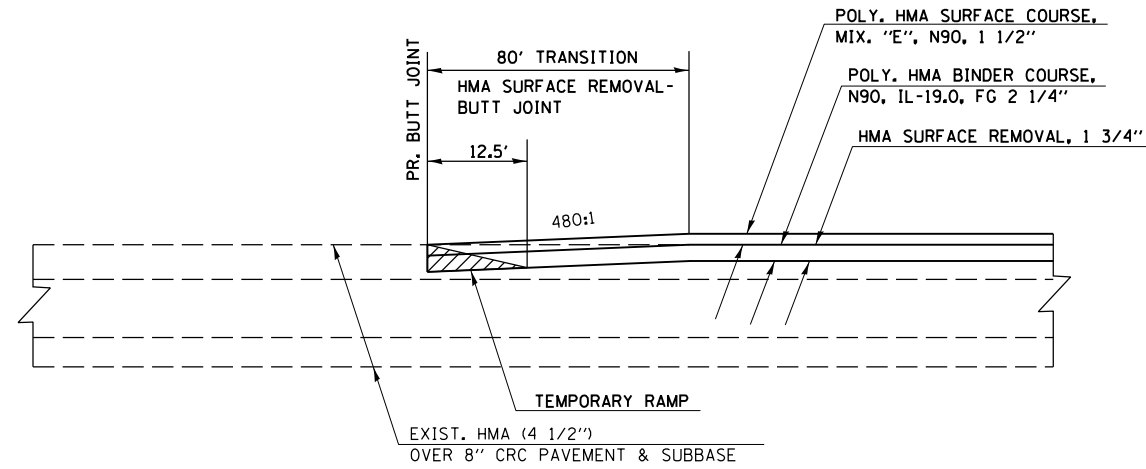

TO BE USED:
STA 1105+21.80 TO STA 1106+01.80 (BEGINNING OF JOB)
STA 1373+65.00 TO STA 1374+45.00 (END OF JOB)

DETAIL FOR BUTT JOINTS AT
END OF RAMPS A, B, C, D

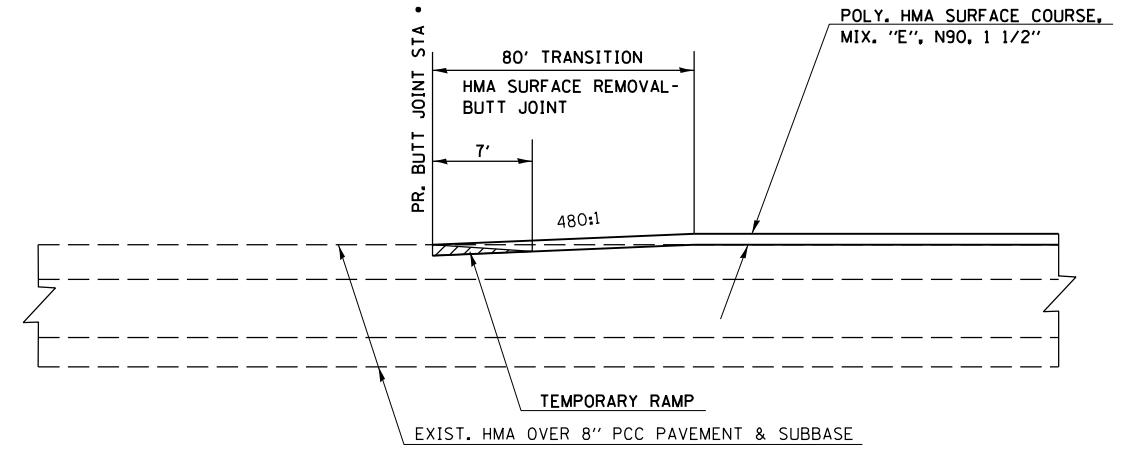

• TO BE USED:
RAMP A STA 88+78.90
RAMP B STA 263+84.70
RAMP C STA 338+78.30
RAMP D STA 427+74.70

DETAIL FOR BUTT JOINTS
AT STRUCTURES (MAINLINE)

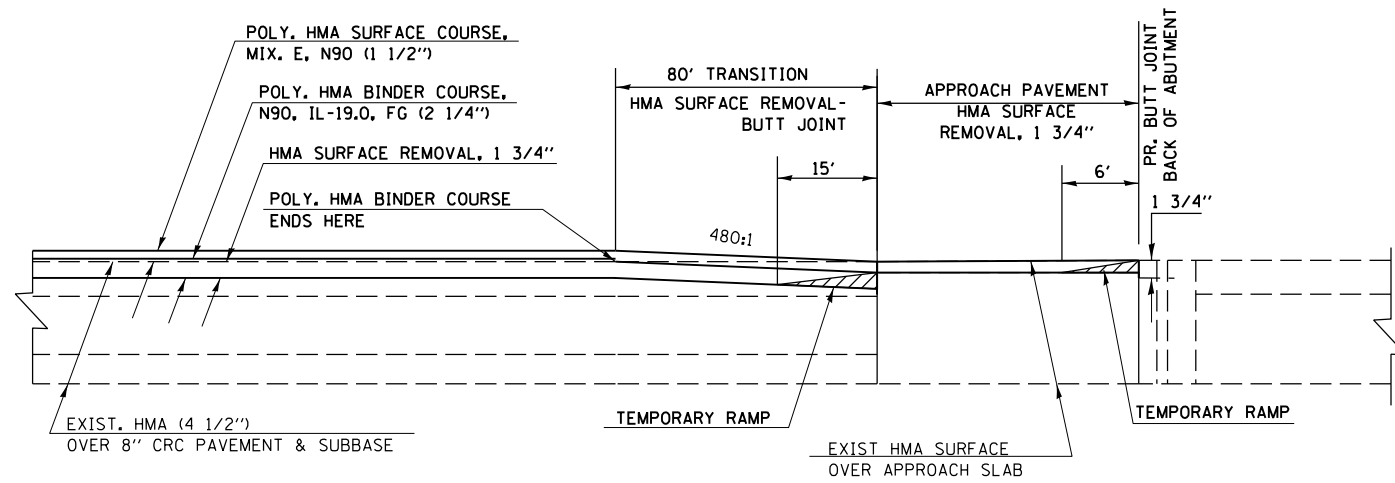

TO BE USED AT
NORTHBOUND AND SOUTHBOUND APPROACHES:
SN 041-0014 & SN 041-0015
SN 041-0016 & SN 041-0017

DETAIL FOR BUTT JOINTS
AT STRUCTURES (RAMPS)

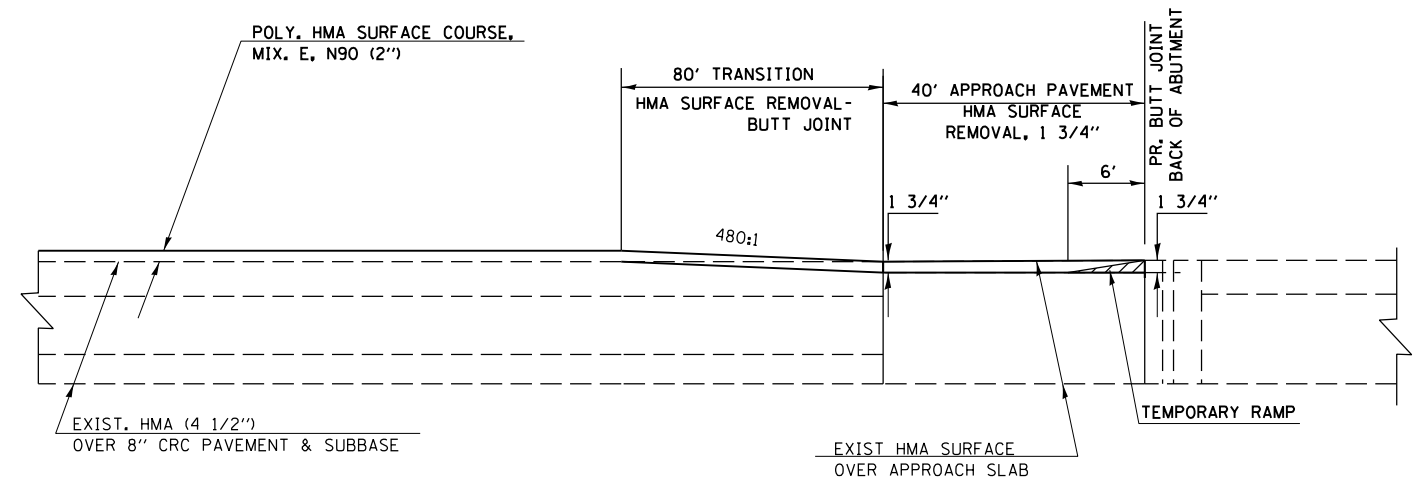

TO BE USED AT
NORTHBOUND AND SOUTHBOUND APPROACHES:
SN 041-0014 & SN 041-0015
SN 041-0016 & SN 041-0017

| | | | |
|--|------------------------------|------------|-----------|
| FILE NAME = | USER NAME = \$USER\$ | DESIGNED - | REVISED - |
| ei:\pw\work\p1dot\rollavr\d0401961\78437 | shite-cvr-soq-index.dgn | DRAWN - | REVISED - |
| \$MODELNAME\$ | PLOT SCALE = 200.0000' / in. | CHECKED - | REVISED - |
| | PLOT DATE = 8/22/2014 | DATE - | REVISED - |

STATE OF ILLINOIS
DEPARTMENT OF TRANSPORTATION

MEDIAN CROSSOVER &
BUTT JOINT DETAILS

SCALE: SHEET OF SHEETS STA. TO STA.

| | | | | |
|---------------------------|-------------------|-----------|--------------------|-----------|
| F.A.I. RTE. | SECTION | COUNTY | TOTAL SHEETS | SHEET NO. |
| 1-57 | (41-4,41-4-1)RS-2 | JEFFERSON | 26 | 22 |
| ILLINOIS FED. AID PROJECT | | | CONTRACT NO. 78437 | |

DETAILS FOR
MEDIAN CROSSOVERS

CROSSECTION
AT MEDIANS

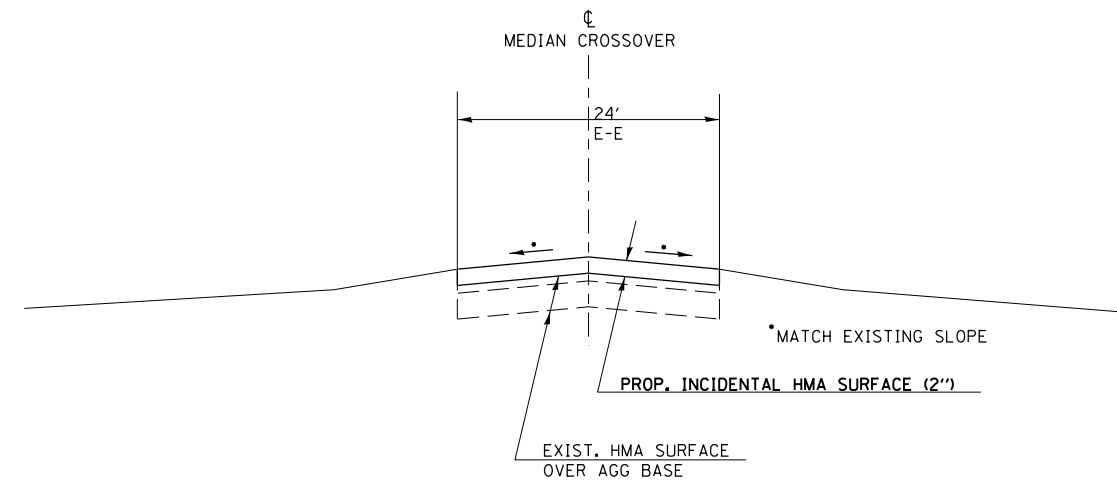

PLAN VIEW
AT MEDIANS

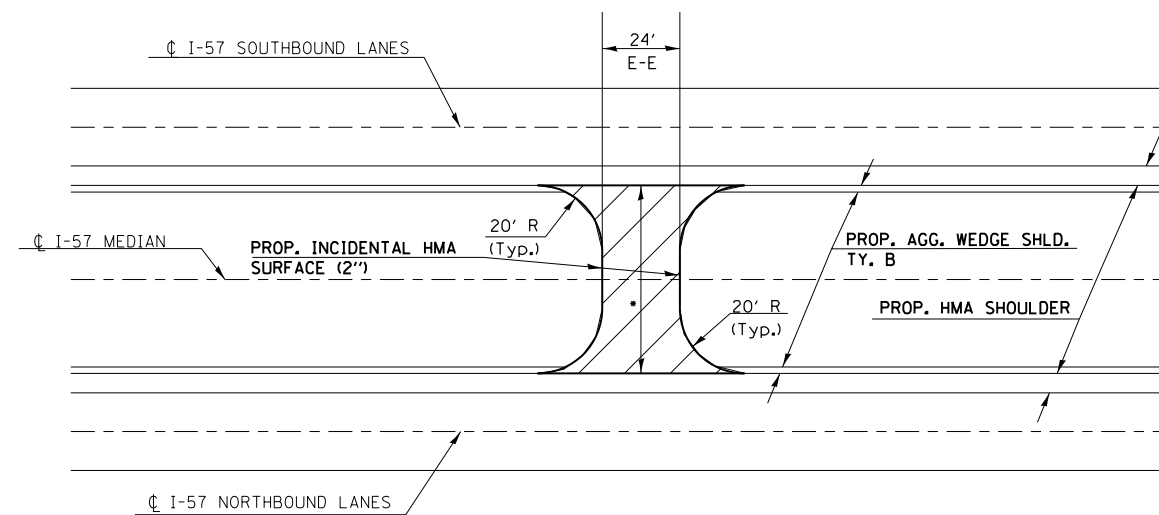

TO BE USED:
STA 1112+95 (•54')
STA 1197+25 (•54')
STA 1356+10 (•62')

| | | | |
|---|------------------------------|------------|-----------|
| FILE NAME = | USER NAME = \$USER\$ | DESIGNED - | REVISED - |
| ct:\pw\work\p1dot\rollavr\0401961\78437 | shite-cvr-soq.index.dgn | DRAWN - | REVISED - |
| \$MODELNAME\$ | PLOT SCALE = 200.0000' / in. | CHECKED - | REVISED - |
| | PLOT DATE = 8/22/2014 | DATE - | REVISED - |

STATE OF ILLINOIS
DEPARTMENT OF TRANSPORTATION

MEDIAN CROSSOVER &
BUTT JOINT DETAILS

SCALE: SHEET OF SHEETS STA. TO STA.

| F.A.I. RTE. | SECTION | COUNTY | TOTAL SHEETS | SHEET NO. |
|--------------------|-------------------|-----------|---------------------------|-----------|
| I-57 | (41-4,41-4-1)RS-2 | JEFFERSON | 26 | 23 |
| CONTRACT NO. 78437 | | | ILLINOIS FED. AID PROJECT | |

**DETAIL FOR HMA TRANSITION
UNDER OVERPASSES
(TO MAINTAIN VERTICAL CLEARANCE)**

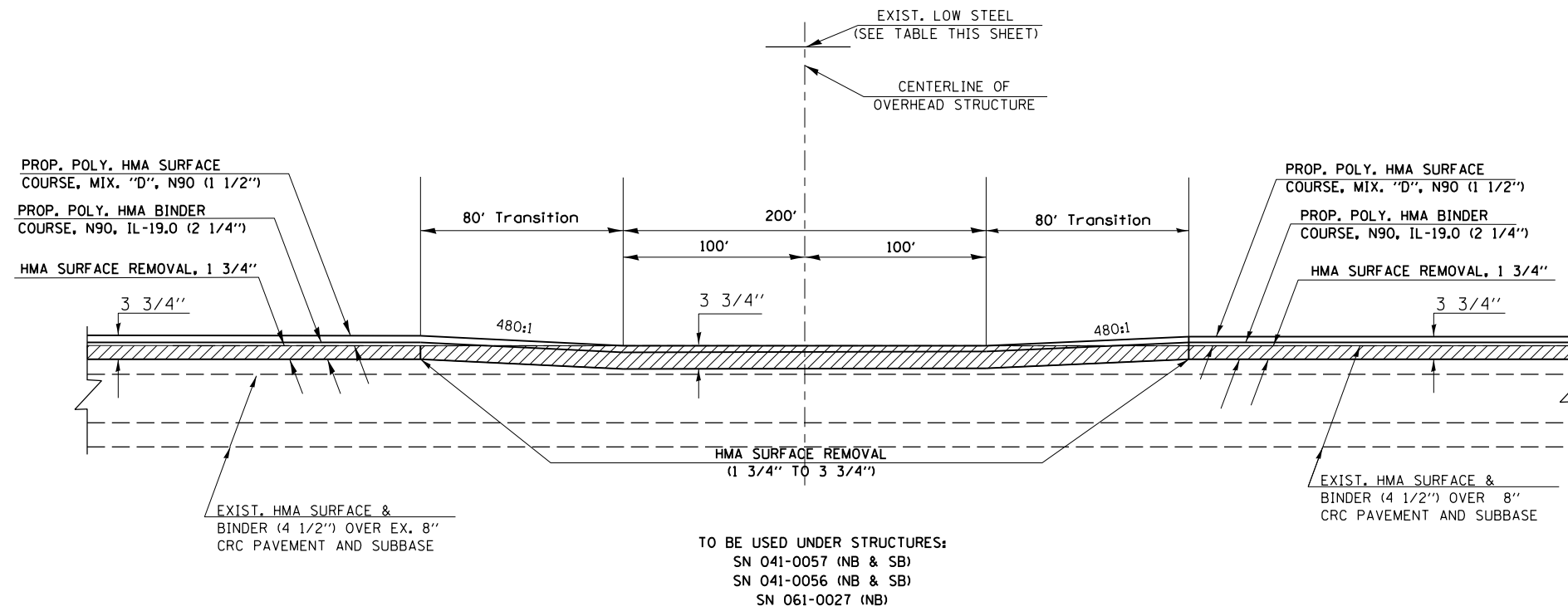

**EXIST. OVERPASS STRUCTURE
CLEARANCE HEIGHTS**

| STRUCTURE NO. | EX. CLEARANCE HEIGHT | |
|---------------|----------------------|-------|
| | NBL | SBL |
| 041-0057 | 16.07' | 16.03 |
| 041-0056 | 16.04' | 16.25 |
| 061-0027 | 16.08' | 16.65 |

**DETAIL OF PROPOSED SHOULDER
TREATMENT UNDER OVERPASSES**

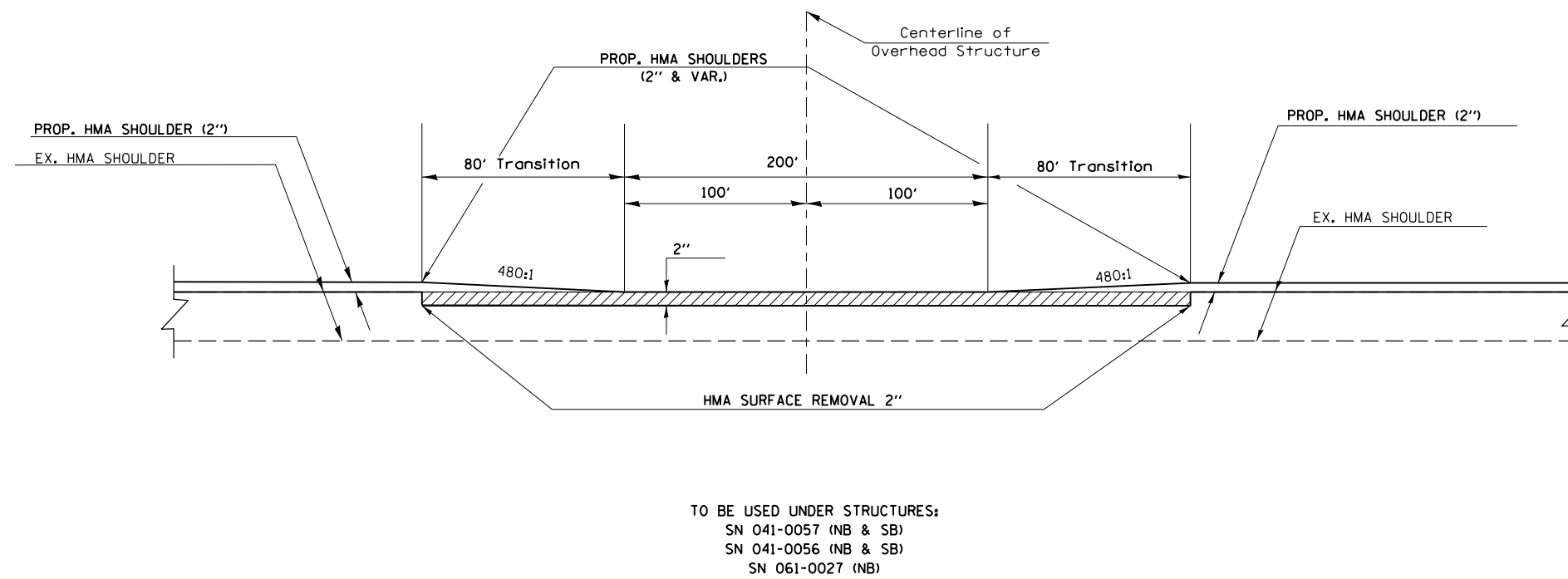

PARAPET DETAILS

SN 041-0014 SN 041-0015 SN 041-0016 SN 041-0017

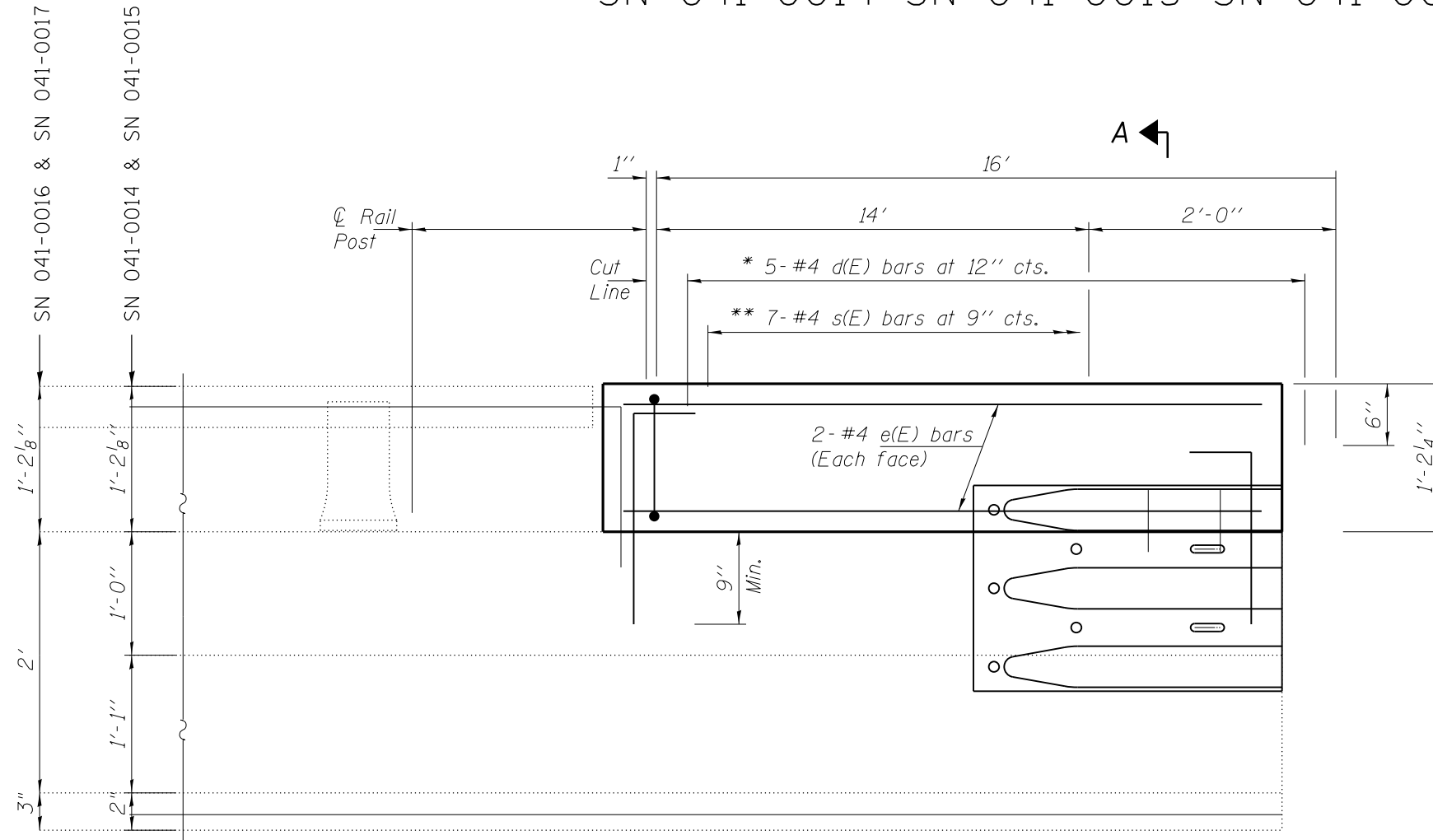

INSIDE ELEVATION OF PARAPET

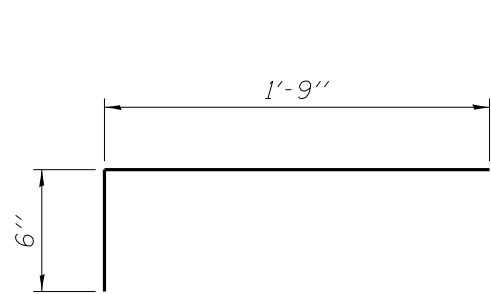

BAR d(E)

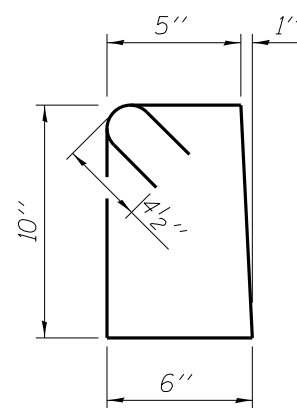

BAR s(E)

* d(E) bars to be epoxy grouted in 7/8"φ x 9" minimum holes. Cut in field as required.

** Tilt s(E) bars as needed to fit.

Note

To be used: All sections where proposed Traffic Barrier Terminal, Type 6B will tie into existing parapet wall (12 locations total). (See Highway Standard 631033-05)

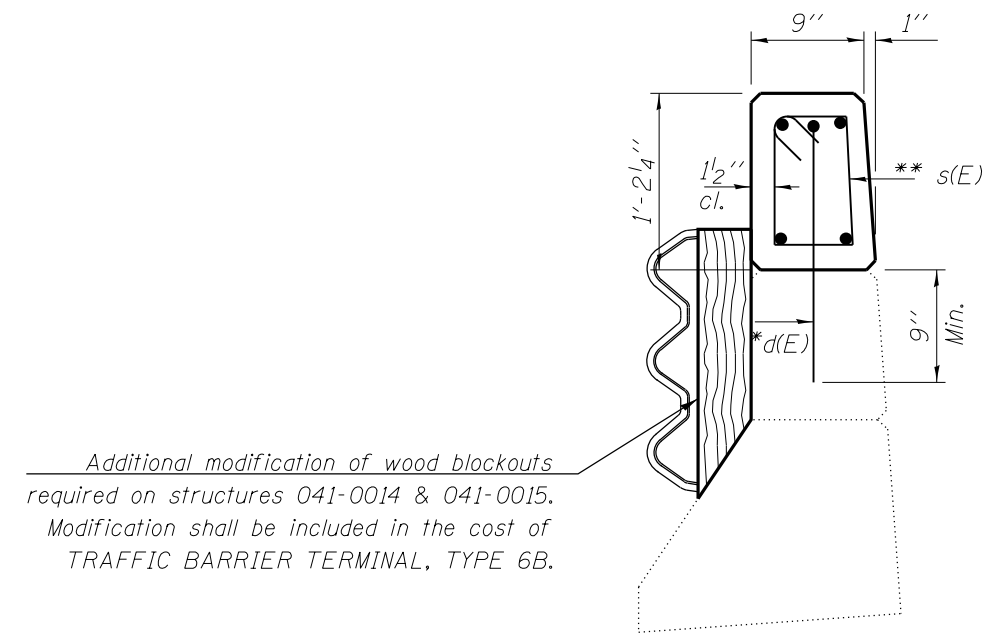

Additional modification of wood blockouts required on structures 041-0014 & 041-0015. Modification shall be included in the cost of TRAFFIC BARRIER TERMINAL, TYPE 6B.

SECTION A-A
(STR #041-0014 & 041-0015)

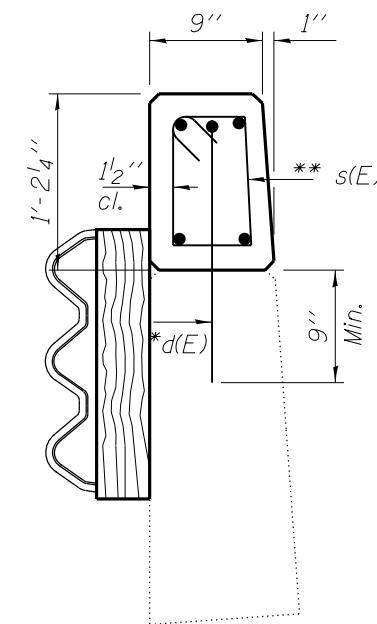

SECTION A-A
(STR # 041-0016 & 041-0017)

BILL OF MATERIAL

| Bar | No. | Size | Length | Shape |
|--------------------|-----|------|---------|-------|
| d | 15 | #5 | 2'-3" | ┌ |
| e | 5 | #4 | 15'-9" | — |
| s | 21 | #4 | 3'-4" | □ |
| Concrete Parapet | | | Cu. Yd. | 0.49 |
| Reinforcement Bars | | | Pound | 134.6 |

TOTAL BILL OF MATERIAL

| Bar | No. | Size | Length | Shape |
|--------------------|-----|------|---------|--------|
| d | 180 | #5 | 2'-3" | ┌ |
| e | 60 | #4 | 15'-9" | — |
| s | 252 | #4 | 3'-4" | □ |
| Concrete Parapet | | | Cu. Yd. | 5.88 |
| Reinforcement Bars | | | Pound | 1615.2 |

| | | | |
|---------------------------------------|------------------------------|------------|-----------|
| FILE NAME = | USER NAME = \$USER* | DESIGNED - | REVISED - |
| c:\pwwork\pwwork\11avr\d0401961\78437 | shite-cvr-soq-index.dgn | DRAWN - | REVISED - |
| | PLOT SCALE = 100.0000' / in. | CHECKED - | REVISED - |
| \$MODELNAME* | PLOT DATE = 8/22/2014 | DATE - | REVISED - |

STATE OF ILLINOIS
DEPARTMENT OF TRANSPORTATION

SCALE: SHEET OF SHEETS STA. TO STA.

| F.A.I. RTE. | SECTION | COUNTY | TOTAL SHEETS | SHEET NO. |
|--------------------|-------------------|-----------|---------------------------|-----------|
| I-57 | (41-4,41-4-1)RS-2 | JEFFERSON | 26 | 25 |
| CONTRACT NO. 78437 | | | ILLINOIS FED. AID PROJECT | |

STONE RIPRAP DITCH DETAIL

(ON EXISTING PAVED DITCH)

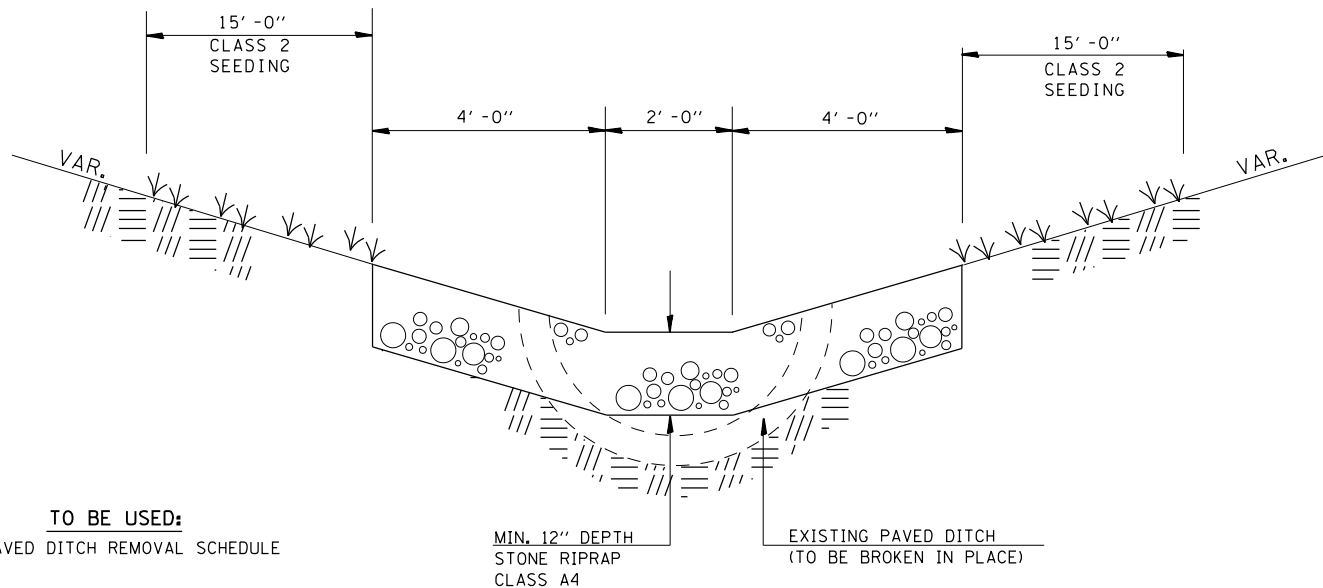

TO BE USED:
SEE PAVED DITCH REMOVAL SCHEDULE

NOTE: THIS WORK SHALL BE PAID FOR AT THE CONTRACT UNIT PRICE PER TON, FOR STONE RIPRAP, CLASS A4, WHICH PRICE SHALL INCLUDE ALL MATERIAL LABOR AND EQUIPMENT TO COMPLETE THE WORK IN PLACE AS SHOWN.

THE FINISHED SIDESLOPES OF THE STONE RIPRAP DITCH SHALL MATCH THE EXISTING GRADE.

UNEVEN LANES SIGN

W8-11 (48" x 48")

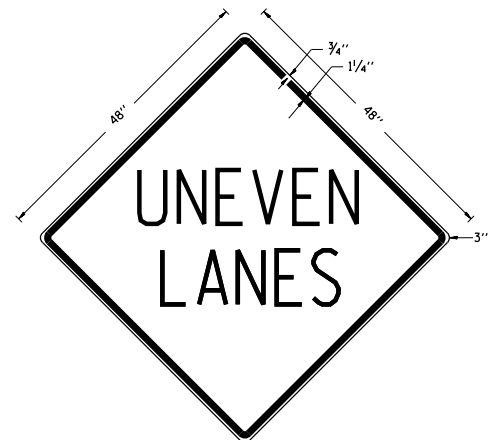

COLORS:
LEGEND AND BORDER - BLACK NON-REFLECTORIZED
BACKGROUND - ORANGE REFLECTORIZED

NOTE: PRIOR TO ALLOWING TRAFFIC ON ANY PORTION OF THE ROADWAY THAT HAS BEEN COLDMILLED OR BEFORE RESURFACING OPERATIONS BEGIN, THE CONTRACTOR SHALL HAVE ERECTED "UNEVEN PAVEMENT" SIGNS THAT CONFORM TO THE ABOVE DETAILS. A MINIMUM OF ONE SIGN AT EACH END OF THE IMPROVEMENT WILL BE REQUIRED. THE CONTRACTOR SHALL MAINTAIN THE "UNEVEN PAVEMENT" SIGNS UNTIL THE RESURFACING OPERATIONS ARE COMPLETED.

IF AT ANY TIME THE SIGNS ARE IN PLACE BUT NOT APPLICABLE, THEY SHALL BE TURNED FROM THE VIEW OF MOTORISTS OR COVERED AS DIRECTED BY THE ENGINEER.

THE COST OF FURNISHING, ERECTING, MAINTAINING, AND REMOVING THE REQUIRED SIGNS SHALL BE INCLUDED IN THE CONTRACT.

| REVISIONS | |
|------------|---------|
| DRAWN | 2-15-89 |
| REVISED | 4-06-93 |
| REDESIGNED | 7-23-04 |
| RESIZED | 5-08-08 |
| REVIEWED | 5-17-13 |

STD. 9-41

TEMPORARY HOT-MIX ASPHALT TRANSITIONS

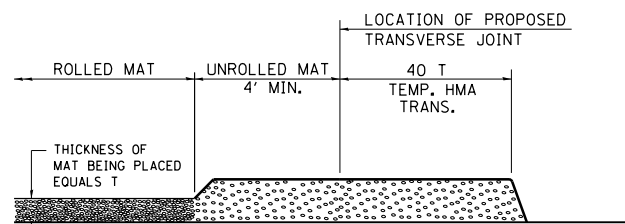

STEP I

- PLACE HOT-MIX ASPHALT MAT, LENGTH 40 TIMES THE THICKNESS OF THE MAT BEING PLACED PAST THE PROPOSED TRANSVERSE JOINT LOCATION USING NORMAL OPERATING PROCEDURES.
- EXTREME CARE SHOULD BE TAKEN TO MAINTAIN ENOUGH MATERIAL IN FRONT OF THE SCREED TO MAINTAIN REQUIRED PAVING DEPTH.

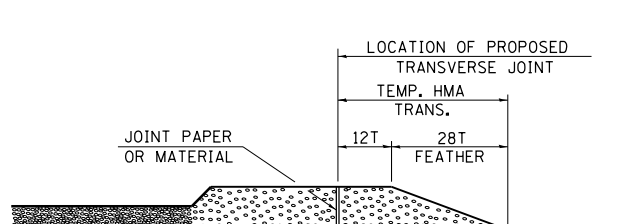

STEP III

- JOINT PAPER OR OTHER PRESELECTED JOINT MATERIAL IS THEN PLACED IN THE CLEARED AREA AND THE EXCESS ASPHALT USED TO HAND FORM A TRANSITION TO THE DIMENSIONS SHOWN ABOVE.
- NOTE THAT IN CONSTRUCTING THE TRANSITION, THE MAT DEPTH IS CONTINUED AS PART OF THE TRANSITION BEFORE FORMING THE FEATHER.

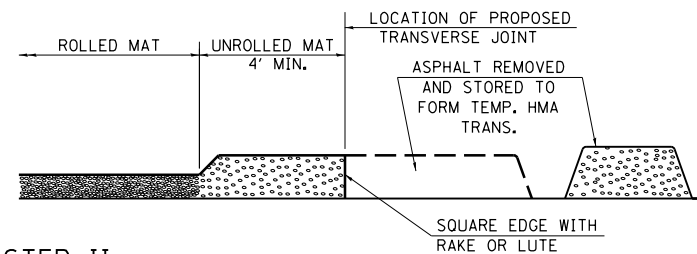

STEP II

- MOVE THE PAVER OUT OF THE WAY AND REMOVE THE ASPHALT FROM THE AREA OF THE PROPOSED TEMPORARY HOT-MIX ASPHALT TRANSITION.
- SQUARE UP THE END OF THE MAT WITH A RAKE OR LUTE.
- NOTE THAT THE MAT WITHIN 4' OF THE END OF JOINT IS NOT TO BE ROLLED AT THIS TIME.

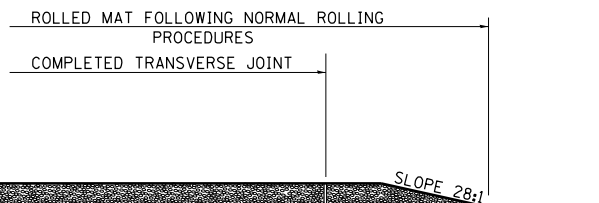

STEP IV

- COMPLETE TEMPORARY TRANSITION BY ROLLING.
- TO RESUME PAVING, AT THE JOINT, REMOVE TEMPORARY TRANSITION AND DISPOSE OF THE MATERIAL ACCORDING TO ART. 202.03 OF THE STD. SPECS. (COST INCLUDED IN THE CONTRACT).
- CONSTRUCTING THE TEMPORARY TRANSITIONS WILL NOT BE PAID FOR SEPARATELY IN ACCORDANCE WITH ARTICLE 406.14 OF THE STANDARD SPECIFICATIONS.

REVISIONS

| | |
|---------|----------|
| REDRAWN | 2-15-89 |
| REVISED | 8-16-94 |
| REVISED | 01-09-07 |
| RESIZED | 05-8-08 |
| REVISED | 05-16-13 |

STD. 9-26

ILLINOIS STANDARD

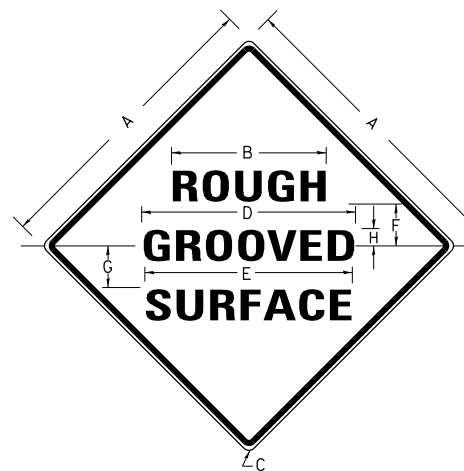

COLORS:

LEGEND AND BORDER- BLACK NON-REFLECTORIZED
BACKGROUND- ORANGE REFLECTORIZED

| SIGN SIZE | DIMENSIONS | | | | | | | |
|-----------|------------|------|-----|------|------|-----|------|-----|
| | A | B | C | D | E | F | G | H |
| 48x48 | 48.0 | 24.1 | 3.0 | 34.0 | 33.0 | 6.0 | 13.0 | 3.5 |

| SIGN SIZE | SERIES LINES | | | MAR-GIN | BOR-DER | BLANK STD. |
|-----------|--------------|----|----|---------|---------|------------|
| | 1 | 2 | 3 | | | |
| 48x48 | 7C | 7C | 7C | 0.8 | 1.2 | B4-48D |

ALL DIMENSIONS IN INCHES

NOTES:

PRIOR TO ALLOWING TRAFFIC ON ANY PORTION OF THE ROADWAY THAT HAS BEEN COLDMILLED, THE CONTRACTOR SHALL HAVE ERECTED "ROUGH GROOVED SURFACE" SIGNS THAT CONFORM TO THE ABOVE DETAILS. A MINIMUM OF ONE SIGN AT EACH END OF THE IMPROVEMENT WILL BE REQUIRED. THE CONTRACTOR SHALL MAINTAIN THE "ROUGH GROOVED SURFACE" SIGNS UNTIL THE COLDMILLED SURFACE IS COVERED WITH LEVELING BINDER OR SURFACE COURSE.

IF AT ANY TIME THE SIGNS ARE IN PLACE BUT NOT APPLICABLE, THEY SHALL BE TURNED FROM THE VIEW OF MOTORISTS OR COVERED AS DIRECTED BY THE ENGINEER.

THE COST OF FURNISHING, ERECTING, MAINTAINING, AND REMOVING THE REQUIRED SIGNS SHALL BE INCLUDED IN THE CONTRACT.

REVISIONS

| | |
|----------|---------|
| REDRAWN | 2-15-89 |
| REVISED | 4-6-93 |
| REVISED | 3-27-08 |
| REVIEWED | 5-17-13 |

STD. 9-39

| | | | |
|--|-------------------------|------------|-----------|
| FILE NAME = | USER NAME = \$USER\$ | DESIGNED - | REVISED - |
| ei:\pw_work\p\midot\rollavr\d0401961\78437 | shite-cvr-soq-index.dgn | DRAWN - | REVISED - |
| \$MODELNAME\$ | PLOT DATE = 8/22/2014 | CHECKED - | REVISED - |
| | | DATE - | REVISED - |

STATE OF ILLINOIS
DEPARTMENT OF TRANSPORTATION

SCALE: SHEET OF SHEETS STA. TO STA.

| F.A.I. RTE. | SECTION | COUNTY | TOTAL SHEETS | SHEET NO. |
|--------------------|-------------------|-----------|---------------------------|-----------|
| 1-57 | (41-4,41-4-1)RS-2 | JEFFERSON | 26 | 26 |
| CONTRACT NO. 78437 | | | ILLINOIS FED. AID PROJECT | |