

\* The truss shall be designed by the manufacturer to withstand a minimum lateral load of 25lb/ft due to debris, ice, etc. This load shall be factored and combined with other loads per the Design Specifications. This load shall be applied along the length of the truss for a distance of at least 45 feet to produce the maximum force effect.

**INDEX OF SHEETS**

1. General Plan and Elevation
2. Abutments
3. Metal Shell piles
4. Boring Logs

**GENERAL NOTES**

Superstructure shall be a Half-Through H-Section truss with a wooden deck. Manufacturer to be approved by the Engineer. See Special Provisions.  
 No field welding is permitted except as specified in the contract documents.  
 Reinforcement bars designated (E) shall be epoxy coated.  
 Layout of the slope protection system may be varied to suit ground conditions in the field as directed by the Engineer.  
 The embankment configuration shown shall be the minimum that must be placed and compacted prior to construction of the abutments.  
 The Organic Zinc Rich Primer / Epoxy / Urethane Paint System shall be used for painting of new structural steel except where otherwise noted. The entire system shall be shop applied, with the exception of the exterior surface and the bottom of the bottom flange of fascia beams, masked off connection surfaces, field installed fasteners and damaged areas shall be touched up in the field. The color of the final finish coat shall be Gray, Munsell No. 5B 7/1. Cost included in Pedestrian Truss Superstructure.  
 The pedestrian truss fabrication will strictly adhere to the low beam, profile, grade and other constraints of the design.  
 Weathering steel shall not be used for the Pedestrian Truss Superstructure.

**REFERENCE STANDARDS**

Illinois Department of Transportation (IDOT)  
 Standard Specifications for Road and Bridge Construction adopted January 1, 2012 and IDOT Supplemental and Recurring Special Provisions adopted January 1, 2014.

**LOADING H-10**

or 90#/sq. ft. pedestrian load

**DESIGN SPECIFICATIONS**

2012 AASHTO Standard Specifications for Highway Bridges with 2013 Interims & 2009 AASHTO Guide Specifications for Design of Pedestrian Bridges

**DESIGN STRESSES**

**FIELD UNITS**

f'c = 3,500 psi  
 fy = 60,000 psi (Reinforcement)

**TOTAL BILL OF MATERIAL**

ITEM	UNIT	SUPER	SUB	TOTAL
Stone Riprap, Class A4	Sq. Yd.			683
Filter Fabric	Sq. Yd.			683
Structure Excavation	Cu. Yd.		47	47
Concrete Structures	Cu. Yd.		20.4	20.4
Reinforcement Bars, Epoxy Coated	Pound		3560	3560
Pedestrian Truss Superstructure	Sq. Ft.	1531		1531
Name Plates	Each			1
Furnishing Metal Shell Piles, 14" x 0.250"	Foot		80	80
Driving Piles	Foot		80	80
Test Pile Metal Shells	Each		2	2

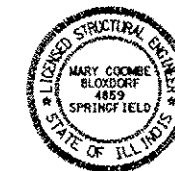

I certify to the best of my knowledge, information and belief, this bridge substructure design is structurally adequate for the Design Loading shown on the plans. The design is an economical one for the style of structure and complies with the requirements of the 2009 AASHTO Guide Specifications for Design of Pedestrian Bridges.

*Mary Coombe Bixdorf*  
 ILLINOIS STRUCTURAL NO. 4859  
 EXPIRES 11/30/14  
 DATE: 08/04/14

**GENERAL PLAN AND ELEVATION  
 PEDESTRIAN/BICYCLE PATH  
 OVER BIG CREEK  
 SECTION 10-P4002-00-BT  
 FULTON COUNTY  
 STATION 231+42.73**

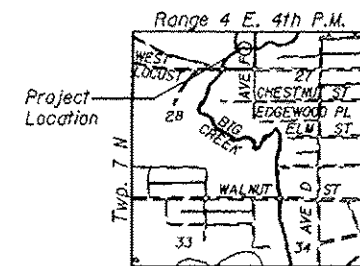

**LOCATION SKETCH**

**BIG CREEK**  
 BUILT 20\_\_ BY  
 CANTON PARK DISTRICT  
 SECTION 10-P4002-00-BT  
 LOADING 90 PSF OR H-10

**NAME PLATE**

See Std. 515001

(Locate Name Plate at SE corner of Bridge. Contractor to coordinate mounting with the bridge manufacturer.)

**WATERWAY DATA**

Character.....	Level & Cultivated
Drainage Area.....	5.36 Sq. Mi.
Design Discharge (30 yr.).....	1705 c.f.s.
Existing Opening.....	None
Required Opening.....	541 Sq. Ft.
Proposed Opening.....	541 Sq. Ft.
Created Head (30 yr. discharge).....	0 Ft.
Created Head (100 yr. flood).....	0 Ft.
100 Year Discharge.....	2198 c.f.s.

\* Less than or equal to created heads caused by existing structures

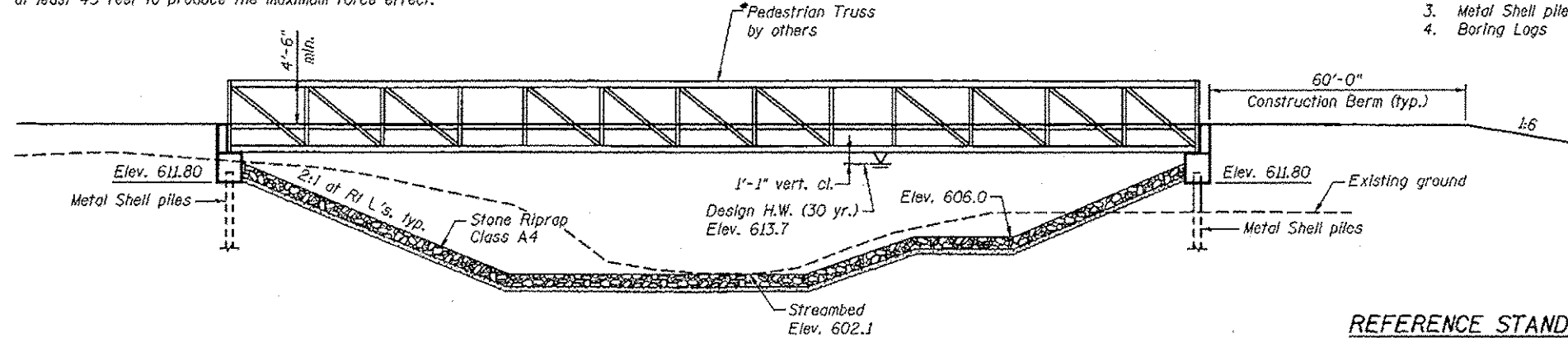

**ELEVATION**

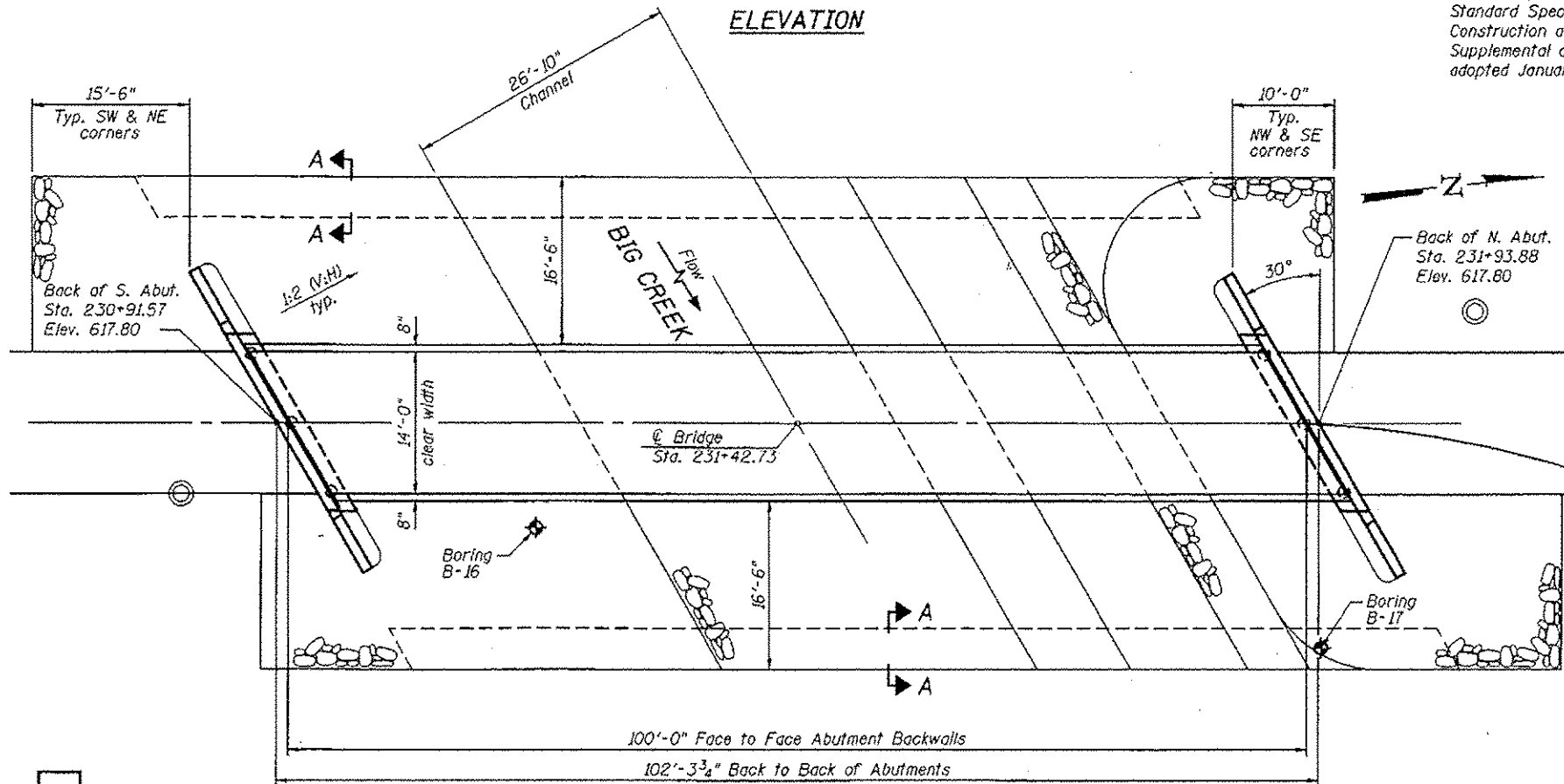

**PLAN**

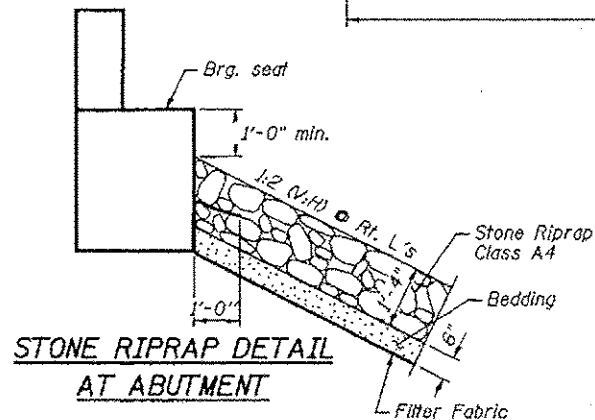

**STONE RIPRAP DETAIL AT ABUTMENT**

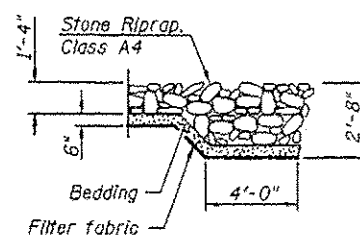

**SECTION A-A**

**STATE OF ILLINOIS  
 DEPARTMENT OF TRANSPORTATION**

**GENERAL PLAN AND ELEVATION**

**BRIDGE 2-3**

SHEET NO. 1 OF 4 SHEETS

F.A. RTE.	SECTION	COUNTY	TOTAL SHEETS	SHEET NO.
	10-P4002-00-BT	FULTON	95	36
				CONTRACT NO. 89603

ILLINOIS FED. AID PROJECT YTD-000151

FILE NAME: 10-081.dwg  
 USER: jml  
 PROJECT NO: 10P2

**Coombe-Bixdorf P.C.**  
 CIVIL ENGINEERS  
 STRUCTURAL ENGINEERS  
 LAND SURVEYORS  
 Design Firm License No. 104-002703

USER NAME: JML  
 DESIGNED: CME  
 CHECKED: MCB  
 DRAWN: NMY  
 CHECKED: MCB

DESIGNED: CME  
 CHECKED: MCB

REVISIONS:  
 11/13/14

PLOT SCALE: 1/8" = 1'-0"  
 PLOT DATE: 8/4/2014