

EXISTING PLAN
SN 022-0080

PLAN

LEGEND

- TEMPORARY PAVEMENT
- CONCRETE REMOVAL

NAME PLATE LOCATION SEE SHEET 2 OF 5 FOR DETAILS (TYPICAL BOTH BRIDGES) EXISTING NAME PLATES TO BE CLEANED AND RELOCATED NEXT TO NEW NAME PLATES. COSTS SHALL BE INCIDENTAL TO CONTRACT PAY ITEM "NAME PLATES".

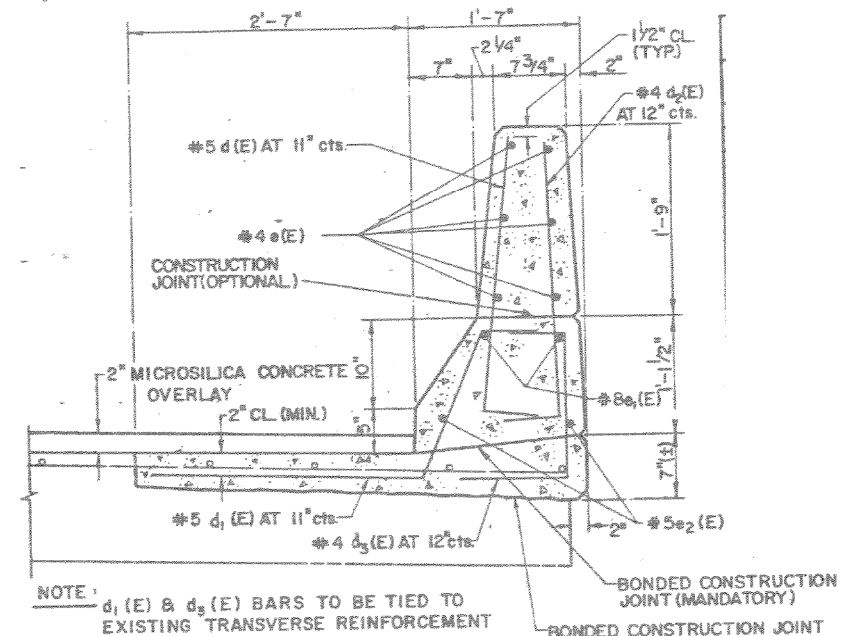

PROPOSED PARAPET SECTION

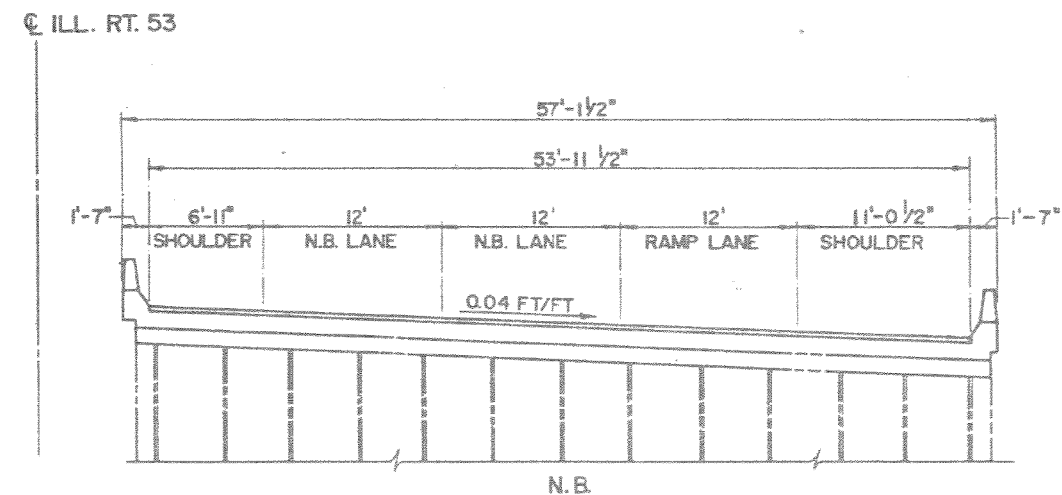

EXISTING TYPICAL SECTION
SN 022-0080

PROPOSED BRIDGE CROSS SECTION
(LOOKING NORTH)

FILE NAME =	USER NAME = gulloumefp	DESIGNED -	REVISED -
ci:\pwork\pwork\gulloumefp\0388342\134814-sh-t-plan.dgn		DRAWN -	REVISED -
Default	PLOT SCALE = 100.0000' / 1in.	CHECKED -	REVISED -
	PLOT DATE = 8/22/2014	DATE -	REVISED -

STATE OF ILLINOIS
DEPARTMENT OF TRANSPORTATION

TYPICAL CROSS SECTION & DECK PLAN VIEW
LOCATON NO. 7 (SN 022-0080)

SCALE: NTS SHEET 1 OF 1 SHEETS STA. TO STA.

ROUTE	SECTION	COUNTY	TOTAL SHEETS	SHEET NO.
VARIOUS	2014-0371	DUPAGE	37	16
CONTRACT NO. 60Y31				
ILLINOIS FED. AID PROJECT				