

BM #2-TOP OF DRILL HOLE  
225; LT. STA. 611+20 (IL 16)  
163' LT. STA. 12+83 (HARRISON AVE.)  
ELEV. = 694.63

BM #3-PK NAIL IN PP  
60' LT. STA. 610+92 (IL 16)  
80' LT. STA. 14+25 (HARRISON AVE.)  
ELEV. = 694.76

WIDENING AND SHOULDERS TO BE CONSTRUCTED  
AFTER EXISTING E. HARRISON AVE. INTERSECTION  
IS REMOVED.

HOT-MIX ASPHALT BASE COURSE, 8 3/4"  
AND HOT-MIX ASPHALT SHOULDERS, 8"  
TO BE COMPLETED IN THIS AREA AFTER  
REMOVAL OF PAVEMENT IN STAGE III

STATION EQUATION:  
STA. 610+28.56 (FAP 91) =  
STA. 14+59.97 (OLD E. HARRISON AVE.)

HOT-MIX ASPHALT SHOULDERS, 8"



LIMITS OF CONSTRUCTION

EXISTING R.O.W.

PLAN	SURVEYED	DATE
	PLOTTED	
	ALIGNED	
	CHECKED	
	FILED	
	NO.	

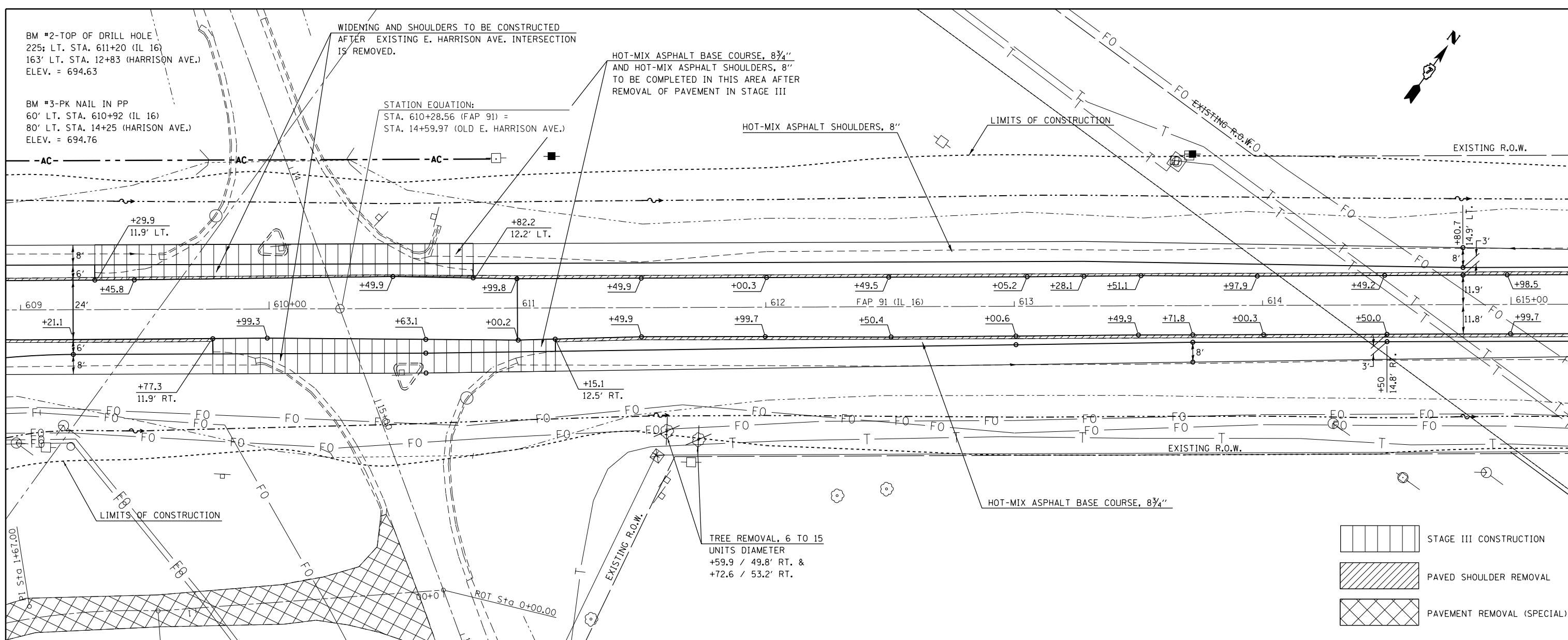
PROFILE	SURVEYED	DATE
	PLOTTED	
	GRADES	
	CHECKED	
	STRUCTURE	
	NOTATIONS	
	CHKD	

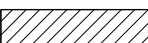

-  STAGE III CONSTRUCTION
-  PAVED SHOULDER REMOVAL
-  PAVEMENT REMOVAL (SPECIAL)

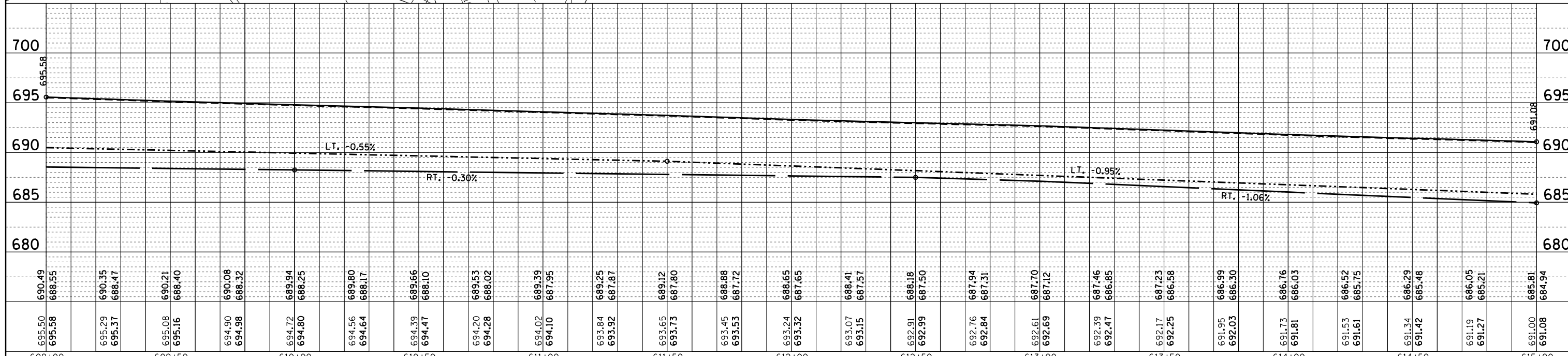

FILE NAME =	USER NAME = steffenk	DESIGNED -	REVISED -	<b>STATE OF ILLINOIS DEPARTMENT OF TRANSPORTATION</b>	<b>PLAN - PROFILE IL. RTE. 16</b>		F.A.P. RTE. 91	SECTION 5N	COUNTY Coles	TOTAL SHEETS 271	SHEET NO. 41	
c:\pwork\pwork\stefjenk\d0158776\077423-sht-plan.dgn		DRAWN -	REVISED -		SCALE: 20	SHEET 4	OF 34 SHEETS	STA.	TO STA.	CONTRACT NO. 74423		
PLOT SCALE = 40.0000' / in.		CHECKED -	REVISED -		ILLINOIS FED. AID PROJECT							
Default		DATE -	REVISED -									