

START PAVEMENT REMOVAL
STA. 24+00.00

BM #4-CHISLED SQUARE IN S. END OF CURB ON E. SIDE.
22' LT. STA. 20+21 (HARRISON AVE.)
ELEV. = 689.17

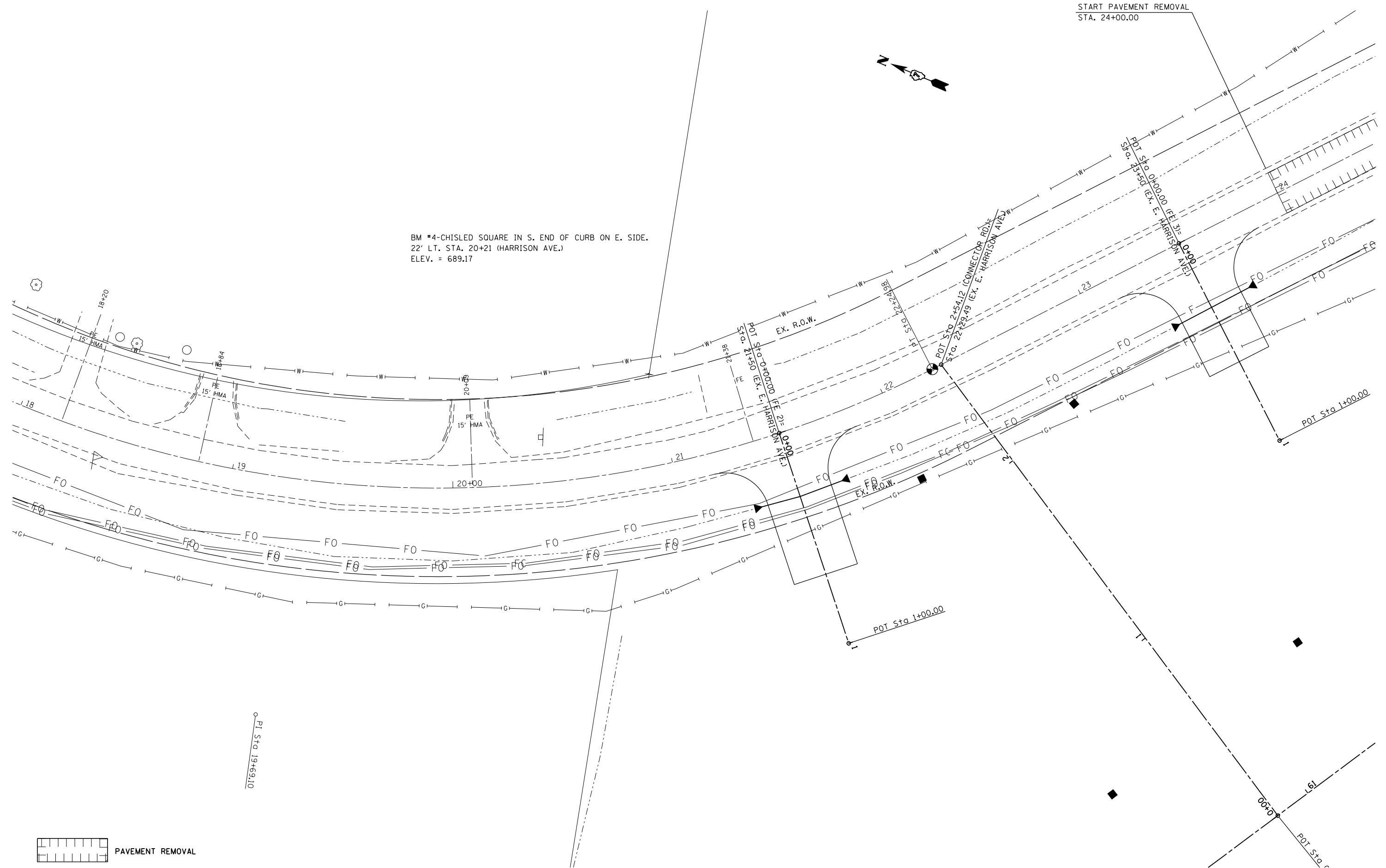

FILE NAME =	USER NAME = steffenmk	DESIGNED -	REVISED -
c:\pw\work\p\dot\stef\enmk\d0158776\074423-sh1-plan.dgn		DRAWN -	REVISED -
	PLOT SCALE = 40.0000' / in.	CHECKED -	REVISED -
	PLOT DATE = 5/7/2014	DATE -	REVISED -

**STATE OF ILLINOIS
DEPARTMENT OF TRANSPORTATION**

**EXISTING E. HARRISON AVE.
STAGE IV PLAN**

SCALE: 20 SHEET 27 OF 34 SHEETS STA. 18+00 TO STA. 24+00

F.A.P. RTE.	SECTION	COUNTY	TOTAL SHEETS	SHEET NO.
91	5N	Coles	271	64
CONTRACT NO. 74423				
ILLINOIS FED. AID PROJECT				