

EXISTING TYPICAL SECTION
FAI 64 WEST BOUND (LOOKING NORTHEAST)

LEGEND:

- (A) EXISTING SUB-BASE GRANULAR MATERIAL, TYPE A (4" MIN.)
- (B) EXISTING LONGITUDINAL SAWED JOINT OR LONGITUDINAL CONSTRUCTION JOINT
- (C) EXISTING COMBINATION CONCRETE CURB & GUTTER, TYPE B-6.24
- (D) EXISTING PORTLAND CEMENT CONCRETE SIDEWALK (5" THICK)
- (E) EXISTING PORTLAND CEMENT CONCRETE PAVEMENT (8" THICK)
- (F) EXISTING STABILIZED SUB-BASE 4"
- (G) EXISTING STABILIZED SHOULDERS (BITUMINOUS AGGREGATE MIXTURE)
- (H) EXISTING CONCRETE GUTTER, TYPE B
- (I) EXISTING CONCRETE GUTTER, TYPE B (SPECIAL)
- (J) EXISTING CONTINUOUSLY REINFORCED PORTLAND CEMENT CONCRETE PAVEMENT (8" THICK)
- (K) EXISTING HMA SURFACE, DEPTH UNKNOWN

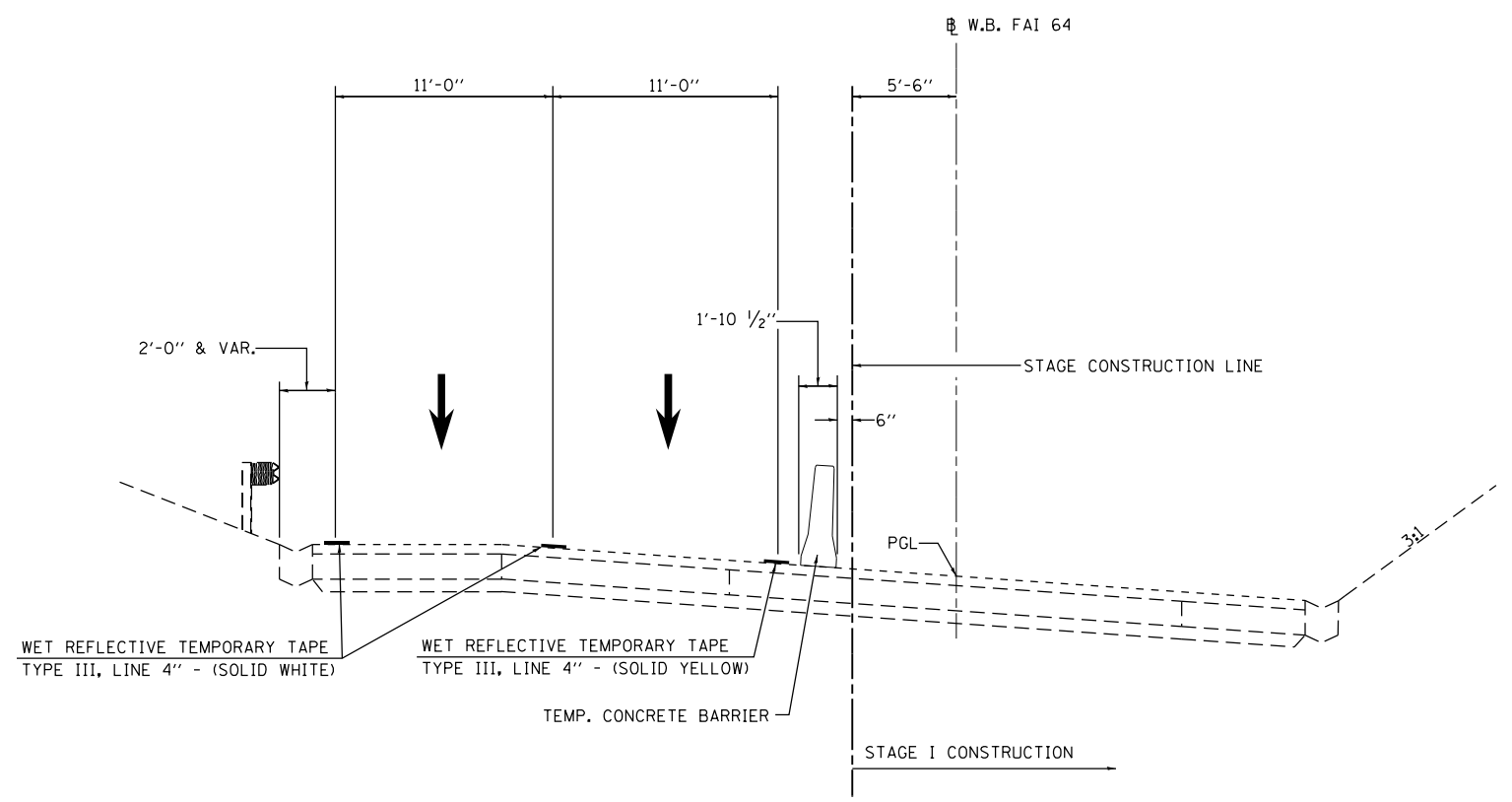

STAGE I CONSTRUCTION
FAI 64 WEST BOUND (LOOKING NORTHEAST)
FROM STA. 121+67 TO STA. 124+67

FILE NAME = G:\11\110223\Work_Drwn_3_M0_Ave_P12\ACD00_Sheets\0876699-ah-typical2.dgn

Lin Engineering, Ltd.
Consulting Engineers
Springfield, Illinois

USER NAME = seb	DESIGNED - RP	REVISED -
	DRAWN - RP	REVISED -
PLOT SCALE = 8.0000' / in.	CHECKED - SGL	REVISED -
PLOT DATE = 8/23/2014	DATE - 7/1/2014	REVISED -

**STATE OF ILLINOIS
DEPARTMENT OF TRANSPORTATION**

TYPICAL SECTIONS		F.A.I. RTE.	SECTION	COUNTY	TOTAL SHEETS	SHEET NO.
		64	82-4T-1	ST. CLAIR	185	15
		SCALE: N.T.S.		SHEET 2 OF 2 SHEETS		STA. N/A TO STA. N/A

		CONTRACT NO. 76C99	
ILLINOIS FED. AID PROJECT			