

F.A.I. RTE	SECTION	COUNTY	TOTAL SHEETS	SHEET NO.
80/94	*	COOK	870	81
STA. 37+700		TO STA. 38+000		
FED ROAD DIST. NO.		ILLINOIS FED. AID PROJECT		

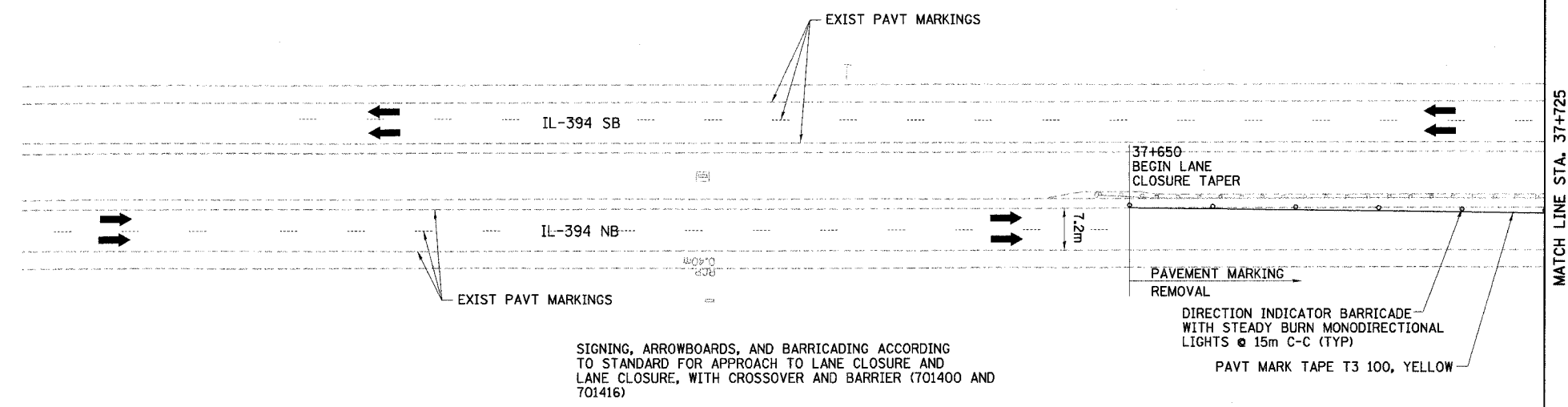

SIGNING, ARROWBOARDS, AND BARRICADING ACCORDING TO STANDARD FOR APPROACH TO LANE CLOSURE AND LANE CLOSURE, WITH CROSSOVER AND BARRIER (701400 AND 701416)

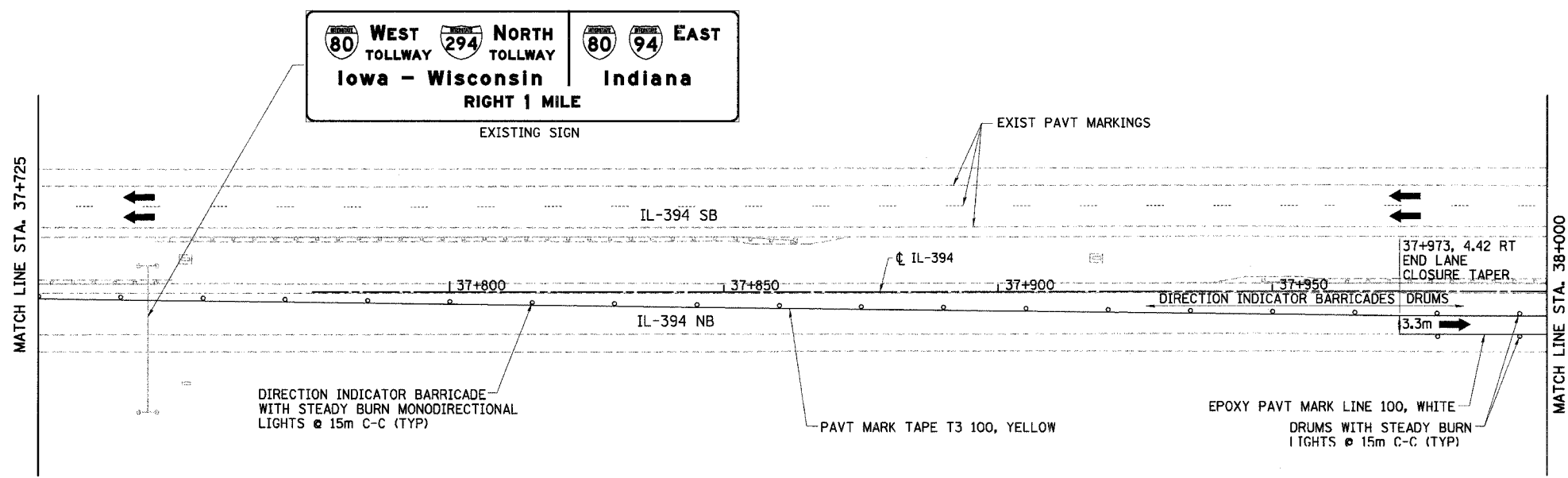

LEGEND

	WORK ZONE		DRUMS WITH STEADY BURN LIGHTS
	TEMPORARY PAVEMENT		VERTICAL PANELS
	TRAFFIC DIRECTION		TYPE III BARRICADE WITH 2 FLASHING LIGHTS
	LANE CLOSURE		

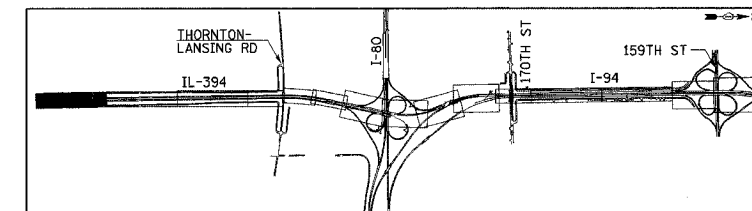

REVISIONS	
NAME	DATE

MT-7

ILLINOIS DEPARTMENT OF TRANSPORTATION
I-94 EAST BOUND / IL 394 SOUTH BOUND

MAINTENANCE OF TRAFFIC
IL-394 - STAGE 1
STA. 37+650 TO STA. 38+000

HORIZ SCALE: 1:500
VERT SCALE: NONE
DATE: JULY 18, 2005

DRAWN BY: STS
CHECKED BY: JES

HNTB